

Oklahoma Corporation Commission
Oil & Gas Conservation Division
Post Office Box 52000
Oklahoma City, Oklahoma 73152-2000
Rule 165: 10-3-25

Form 1002A

API No.: 35137275590000

Completion Report

Spud Date: January 26, 2019

OTC Prod. Unit No.:

Drilling Finished Date: January 27, 2019

1st Prod Date:

Completion Date: January 29, 2019

Drill Type: STRAIGHT HOLE

SERVICE WELL

Well Name: AOSU 3-20I

Purchaser/Measurer:

Location: STEPHENS 22 1S 5W
C S2 NE SW
1650 FSL 1980 FWL of 1/4 SEC
Derrick Elevation: 0 Ground Elevation: 1082

First Sales Date:

Operator: HAYS PRODUCTION LLC 21141
PO BOX 51
116 1ST ST
VELMA, OK 73491-0051

Completion Type		Location Exception		Increased Density	
X	Single Zone	Order No		Order No	
	Multiple Zone	There are no Location Exception records to display.		There are no Increased Density records to display.	
	Commingled				

Casing and Cement							
Type	Size	Weight	Grade	Feet	PSI	SAX	Top of CMT
PRODUCTION	5.5	17	J-55	656		135	SURFACE

Liner								
Type	Size	Weight	Grade	Length	PSI	SAX	Top Depth	Bottom Depth
There are no Liner records to display.								

Total Depth: 680

Packer		Plug	
Depth	Brand & Type	Depth	Plug Type
There are no Packer records to display.		There are no Plug records to display.	

Initial Test Data										
Test Date	Formation	Oil BBL/Day	Oil-Gravity (API)	Gas MCF/Day	Gas-Oil Ratio Cu FT/BBL	Water BBL/Day	Pumpin or Flowing	Initial Shut-In Pressure	Choke Size	Flow Tubing Pressure
There are no Initial Data records to display.										

Completion and Test Data by Producing Formation			
Formation Name: PERMIAN		Code: 459PRMN	Class: INJ
Spacing Orders		Perforated Intervals	
Order No	Unit Size	From	To
There are no Spacing Order records to display.		581	591
Acid Volumes		Fracture Treatments	
N/A		200 BARRELS LEASE WATER	

Formation	Top
------------------	------------

Were open hole logs run? Yes
Date last log run: December 12, 2018

Were unusual drilling circumstances encountered? No
Explanation:

Other Remarks
PERMIT NUMBER 1908620029

FOR COMMISSION USE ONLY	
Status: Accepted	1142830

API NO. 137-27559
OTC PROD.
UNIT NO.

PLEASE TYPE OR USE BLACK INK ONLY
NOTE:

Attach copy of original 1002A
if recompletion or reentry.

OKLAHOMA CORPORATION COMMISSION
Oil & Gas Conservation Division
Post Office Box 52000
Oklahoma City, Oklahoma 73152-2000
Rule 165:10-3-25

RECEIVED

MAR 01 2019

OKLAHOMA CORPORATION
COMMISSION

Form 1002A
Rev. 2009

☒ ORIGINAL
☐ AMENDED (Reason)

COMPLETION REPORT

TYPE OF DRILLING OPERATION

☒ STRAIGHT HOLE ☐ DIRECTIONAL HOLE ☐ HORIZONTAL HOLE
☒ SERVICE WELL
If directional or horizontal, see reverse for bottom hole location.

COUNTY	STEPHENS	SEC	22	TWP	01S	RGE	05W	SPUD DATE	1-26-19
LEASE NAME	AOSU			WELL NO.	3-20i			DRLG FINISHED DATE	1-27-19
C	1/4	S2	1/4	NE	1/4	SW	1/4	DATE OF WELL COMPLETION	1-29-19
FSL OF 1/4 SEC	1650			FWL OF 1/4 SEC	1980			1st PROD DATE	
ELEVATION Derrick FL	Ground 1082			Latitude (if known)				RECOMP DATE	
OPERATOR NAME	HAYS PRODUCTION LLC						OTC/OCC OPERATOR NO.	21141	
ADDRESS	PO BOX 51								
CITY	VELMA			STATE	OK		ZIP	73491	

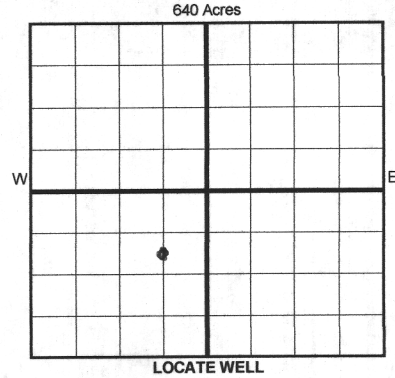

COMPLETION TYPE

<input checked="" type="checkbox"/> SINGLE ZONE
<input type="checkbox"/> MULTIPLE ZONE
Application Date
<input type="checkbox"/> COMMINGLED
Application Date
LOCATION EXCEPTION
ORDER NO.
INCREASED DENSITY
ORDER NO.

CASING & CEMENT (Form 1002C must be attached)

TYPE	SIZE	WEIGHT	GRADE	FEET	PSI	SAX	TOP OF CMT
CONDUCTOR							
SURFACE							
INTERMEDIATE							
PRODUCTION	5.5	17#	J55	656		42T 135	SURFACE
LINER							
TOTAL DEPTH							680

PACKER @ _____ BRAND & TYPE _____ PLUG @ _____ TYPE _____ PLUG @ _____ TYPE _____
PACKER @ _____ BRAND & TYPE _____ PLUG @ _____ TYPE _____ PLUG @ _____ TYPE _____

COMPLETION & TEST DATA BY PRODUCING FORMATION

FORMATION	PERMIAN							
SPACING & SPACING ORDER NUMBER								
CLASS: Oil, Gas, Dry, Inj, Disp, Comm Disp, Svc	INJ							
PERFORATED INTERVALS	581-591 4SPF							
ACID/VOLUME	NA							
FRACTURE TREATMENT (Fluids/Prop Amounts)	200 BBL LEASE WTR							

☐ Min Gas Allowable (165:10-17-7)
OR
☐ Oil Allowable (165:10-13-3)

Gas Purchaser/Measurer
First Sales Date

INITIAL TEST DATA

INITIAL TEST DATE	INJ WELL						
OIL-BBL/DAY							
OIL-GRAVITY (API)							
GAS-MCF/DAY							
GAS-OIL RATIO CU FT/BBL							
WATER-BBL/DAY							
PUMPING OR FLOWING							
INITIAL SHUT-IN PRESSURE							
CHOKE SIZE							
FLOW TUBING PRESSURE							

AS SUBMITTED

A record of the formations drilled through, and pertinent remarks are presented on the reverse. I declare that I have knowledge of the contents of this report and am authorized by my organization to make this report, which was prepared by me or under my supervision and direction, with the data and facts stated herein to be true, correct, and complete to the best of my knowledge and belief.

SIGNATURE	CASEY HAYS	2/19/2019	580-656-8514
PO BOX 51	VELMA OK 73491	DATE	PHONE NUMBER
ADDRESS	CITY STATE ZIP	EMAIL ADDRESS HAYSLANDANDCATTLE@GMAIL.COM	

Give formation names and tops, if available, or descriptions and thickness of formations drilled through. Show intervals cored or drillstem tested.

NAMES OF FORMATIONS	TOP

FOR COMMISSION USE ONLY	
ITD on file	<input type="checkbox"/> YES <input type="checkbox"/> NO
APPROVED	DISAPPROVED
2) Reject Codes	

Were open hole logs run? X yes no

Date Last log was run 12-12-2018

Was CO₂ encountered? yes X no at what depths?

Was H₂S encountered? yes X no at what depths?

Were unusual drilling circumstances encountered? yes X no

If yes, briefly explain below:

Other remarks: Permit 1908620029

640 Acres

A blank 10x10 grid for graphing, consisting of 10 columns and 10 rows of squares. The grid is divided into four quadrants by a vertical line between the 5th and 6th columns and a horizontal line between the 5th and 6th rows.

If more than three drainholes are proposed, attach a separate sheet indicating the necessary information.

Direction must be stated in degrees azimuth.
Please note, the horizontal drainhole and its end
point must be located within the boundaries of the
lease or spacing unit.

Directional surveys are required for all drainholes and directional wells.

640 Acres

A blank 10x10 grid with a bold cross dividing it into four 5x5 quadrants.

BOTTOM HOLE LOCATION FOR DIRECTIONAL HOLE

SEC	TWP	RGE	COUNTY
Spot Location			
1/4	1/4	1/4	1/4
Measured Total Depth		True Vertical Depth	BHL From Lease, Unit, or Property Line:

BOTTOM HOLE LOCATION FOR HORIZONTAL HOLE: (LATERALS)

LATERAL #1

SEC	TWP	RGE	COUNTY			
Spot Location				Feet From 1/4 Sec Lines	FSL	FWL
1/4	1/4	1/4	1/4			
Depth of Deviation		Radius of Turn	Direction	Total Length		
Measured Total Depth		True Vertical Depth	BHL From Lease, Unit, or Property Line:			

LATERAL #2

SEC	TWP	RGE	COUNTY			
Spot Location				Feet From 1/4 Sec Lines	FSL	FWL
1/4	1/4	1/4	1/4			
Depth of Deviation		Radius of Turn	Direction	Total Length		
Measured Total Depth		True Vertical Depth	BHL From Lease, Unit, or Property Line:			

LATERAL #3

SEC	TWP	RGE	COUNTY			
Spot Location				Feet From 1/4 Sec Lines	FSL	FWL
1/4	1/4	1/4	1/4			
Depth of Deviation		Radius of Turn	Direction	Total Length		
Measured Total Depth		True Vertical Depth	BHL From Lease, Unit, or Property Line:			