

Oklahoma Corporation Commission
Oil & Gas Conservation Division
Post Office Box 52000
Oklahoma City, Oklahoma 73152-2000
Rule 165: 10-3-25

Form 1002A

API No.: 35027214980000

Completion Report

Spud Date: July 22, 2018

OTC Prod. Unit No.: 027-224538

Drilling Finished Date: August 06, 2018

1st Prod Date: January 18, 2019

Completion Date: January 27, 2019

Drill Type: DIRECTIONAL HOLE

Well Name: DRAPER 1

Purchaser/Measurer:

Location: CLEVELAND 8 10N 1W
NE NE SW NE
1301 FSL 1613 FEL of 1/4 SEC
Derrick Elevation: 1288 Ground Elevation: 1279

First Sales Date:

Operator: GLB EXPLORATION INC 18634

7716 MELROSE LN
OKLAHOMA CITY, OK 73127-6002

Completion Type		Location Exception		Increased Density	
	Single Zone	Order No		Order No	
	Multiple Zone	683475		There are no Increased Density records to display.	
	Commingled				

Casing and Cement							
Type	Size	Weight	Grade	Feet	PSI	SAX	Top of CMT
CONDUCTOR	16	42		0			SURFACE
SURFACE	8 5/8	24	J-55	1345	800	600	SURFACE
PRODUCTION	5 1/2	17	P-110	7422	1800	175	6540

Liner								
Type	Size	Weight	Grade	Length	PSI	SAX	Top Depth	Bottom Depth
There are no Liner records to display.								

Total Depth: 7457

Packer	
Depth	Brand & Type
There are no Packer records to display.	

Plug	
Depth	Plug Type
6765	RBP
6840	CIBP
7233	CIBP
7310	CIBP

Initial Test Data										
Test Date	Formation	Oil BBL/Day	Oil-Gravity (API)	Gas MCF/Day	Gas-Oil Ratio Cu FT/BBL	Water BBL/Day	Pumpin or Flowing	Initial Shut-In Pressure	Choke Size	Flow Tubing Pressure
Oct 02, 2018	SIMPSON					160	SWAB			
Oct 04, 2018	VIOLA					100	SWAB			
Oct 19, 2018	VIOLA					175	SWAB	20		
Oct 31, 2018	HUNTON					758	SWAB	80		
Nov 29, 2018	BARTLESVILLE					48	SWAB			
Jan 27, 2019	UNCONFORMITY /SD/	5	36			8	PUMPING	100		

Completion and Test Data by Producing Formation										
Formation Name: SIMPSON				Code: 202SMPS				Class: DRY		
Spacing Orders				Perforated Intervals						
Order No		Unit Size		From			To			
188333		320		7319			7323			
Acid Volumes				Fracture Treatments						
NONE				NONE						
Formation Name: VIOLA				Code: 202VIOL				Class: DRY		
Spacing Orders				Perforated Intervals						
Order No		Unit Size		From			To			
188333		320		7239			7246			
Acid Volumes				Fracture Treatments						
1,000 GALLONS 15% NEFE HCL				There are no Fracture Treatments records to display.						
Formation Name: VIOLA				Code: 202VIOL				Class: DRY		
Spacing Orders				Perforated Intervals						
Order No		Unit Size		From			To			
188333		320		7145			7186			
Acid Volumes				Fracture Treatments						
2,500 GALLONS 15% NEFE HCL, 60 BARRELS 20% NEFE HCL				1,813 BARRELS SLICK WATER + 52,918 POUNDS 40/70 AND 20/40 SAND						

Formation Name: HUNTON		Code: 269HNTN	Class: DRY
Spacing Orders		Perforated Intervals	
Order No	Unit Size	From	To
188333	320	6770	6790
Acid Volumes		Fracture Treatments	
2,000 GALLONS 7 1/2 % NEFE HCL AND 5,000 GALLONS 15% NEFE HCL		There are no Fracture Treatments records to display.	

Formation Name: UNCONFORMITY /SD/		Code: 000UCFM	Class: OIL
Spacing Orders		Perforated Intervals	
Order No	Unit Size	From	To
188333	320	6736	6750
Acid Volumes		Fracture Treatments	
2,000 GALLONS 7 1/2% NEFE HCL		914 BARRELS 30 POUNDS X-LINK GEL + 27,500 POUNDS 20/40 SAND + 6,000 POUNDS 20/40 RESIN COATED SAND	

Formation Name: BARTLESVILLE		Code: 404BRVL	Class: DRY
Spacing Orders		Perforated Intervals	
Order No	Unit Size	From	To
188333	320	6665	6675
Acid Volumes		Fracture Treatments	
NONE		NONE	

Formation	Top
CHECKERBOARD	5643
OSWEGO	6472
BARTLESVILLE	6664
UNCONFORMITY	6738
HUNTON	6760
SYLVAN	7008
VIOLA	7122
SIMPSON	7316

Were open hole logs run? Yes

Date last log run: August 22, 2018

Were unusual drilling circumstances encountered? No

Explanation:

Other Remarks
There are no Other Remarks.

Bottom Holes

Sec: 8 TWP: 10N RGE: 1W County: CLEVELAND

SW NW NE SE

2000 FSL 1440 FWL of 1/4 SEC

Depth of Deviation: 0 Radius of Turn: 0 Direction: 0 Total Length: 0

Measured Total Depth: 7457 True Vertical Depth: 7109 End Pt. Location From Release, Unit or Property Line: 640

FOR COMMISSION USE ONLY

1142043

Status: Accepted

RECEIVED

FEB 04 2019

Form 1002A
Rev. 2009

API NO. **027-21498**
OTC PROD. UNIT NO. **027-224538**

PLEASE TYPE OR USE BLACK INK ONLY
NOTE: Attach copy of original 1002A if recompletion or re

OKLAHOMA CORPORATION COMMISSION
Oil & Gas Conservation Division
Post Office Box 52000
Oklahoma City, Oklahoma 73152-2000
Rule 165:10-3-25

Oklahoma Corporation
Commission

☒ ORIGINAL
☐ AMENDED (Reason) _____

COMPLETION REPORT

TYPE OF DRILLING OPERATION

☐ STRAIGHT HOLE ☒ DIRECTIONAL HOLE ☐ HORIZONTAL HOLE
☐ SERVICE WELL

If directional or horizontal, see reverse for bottom hole location.

COUNTY CLEVELAND	SEC 8	TWP 10N	RGE 1W	SPUD DATE 7/22/18
LEASE NAME DRAPER	WELL NO. 1 FEL1613	DATE OF WELL COMPLETION 1/27/19	1st PROD DATE 1/18/19	
NE 1/4, NE 1/4 SW 1/4 NE 1/4	FSL 1301	DATE OF 1/4 SEC 1327	RECOMP DATE	
ELEVATION N Derrick 1288 Ground 1279	Latitude (if known)	Longitude (if known)		
OPERATOR NAME GLB EXPLORATION, INC	OTC/OCC OPERATOR N 18634-0			
ADDRESS 7716 MELROSE LANE				
CITY OKLAHOMA CITY	STATE OK	ZIP 73127		

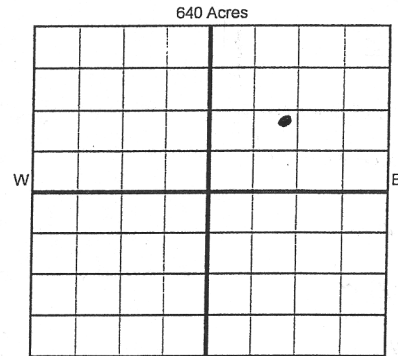

LOCATE WELL

COMPLETION TYPE

<input type="checkbox"/> SINGLE ZONE
<input type="checkbox"/> MULTIPLE ZONE
Application Date
COMINGLED
Application Date
LOCATION 683475
EXCEPTION ORDER
INCREASED DENSITY ORDER NO.

CASING & CEMENT (Form 1002C must be attached)

TYPE	SIZE	WEIGHT	GRADE	FEET	PSI	SAX	TOP OF CMT
CONDUCTOR	16	42	-				SURF
SURFACE	8 5/8	24	J-55	1345	800	600	SURF
INTERMEDIATE							
PRODUCTION	5 1/2	17	P.110	7422	1800	175	6540
LINER							

PACKER @ _____ BRAND & TYPE _____ PLUG @ **7310** TYPE **CIBP** PLUG @ **6840** TYPE **CIBP** TOTAL DEPTH **7457**
 PACKER @ _____ BRAND & TYPE _____ PLUG @ **7227** TYPE **CIBP** PLUG @ **6765** TYPE **RBP**

COMPLETION & TEST DATA BY PRODUCING FORMATION

FORMATION	SPACING & SPACING ORDER NUMBER	CLASS: Oil, Gas, Dry, Inj, Disp, Comm Disp, Svc	PERFORATED INTERVALS	ACID/VOLUME	FRACTURE TREATMENT (Fluids/Prop Amounts)
SIMPSON	320-188333	DRY	7319-23	NONE	NONE
VIOLA	320-188333	DRY	7239-46	1000 gal 15% NE FE HCL	NONE
VIOLA	320-188333	DRY	7145-86	2500 gal 15% NE FE HCL	1813 bbls slick wtr + 52,918 # 40/70 + 20/40 SD
HUNTON	320-188333	DRY	6770-90	2000 gal 7 1/2% NE FE HCL	914 bbls 30 # X-LINK Gel + 27,500 # 20/40 SD + 6000 # 20/40 resin coated SD
UNCONFORMITY	320-188333	OIL	6736-50	2000 gal 7 1/2% NE FE HCL	NONE
BARTLESVILLE	320-188333	DRY	6665-75	NONE	NONE

Reported to Eric Fooks (2 different Dates)

Min Gas Allowable (165:10-17-7)
OR
Oil Allowable (165:10-13-3)

Gas Purchaser/Measurer
First Sales Date

INITIAL TEST DATA

INITIAL TEST DATE	10/2/18	10/4/18	10/19/18	10/31/18	1/27/19	1/29/18
OIL-BBL/DAY	0	0	Trace	Trace	5	0
OIL-GRAVITY (API)	-	-	-	-	36	-
GAS-MCF/DAY	0	0	0	0	0	0
GAS-OIL RATIO CU FT/BBL	-	-	-	-	-	-
WATER-BBL/DAY	160	100	175 BLW	75 BLW	8	48
PUMPING OR FLOWING	SWAB	SWAB	SWAB	SWAB	PUMP	SWAB
INITIAL SHUT-IN PRESSURE	0	0	20	80	100	0
CHOKE SIZE	-	-	-	-	-	-
FLOW TUBING PRESSURE	-	-	-	-	-	-

A record of the formations drilled through and pertinent remarks are presented on the reverse. I declare that I have knowledge of the contents of this report and am authorized by my organization to make this report, which was prepared by me or under my supervision and direction, with the data and facts stated herein to be true, correct, and complete to the best of my knowledge and belief.

SIGNATURE **GLENN BLUMSTEIN** NAME (PRINT OR TYPE)
DATE **1/31/19** PHONE NUMBER **405-787-0049**
ADDRESS **7716 MELROSE LANE** CITY **OKC** STA **OK** ZIP **73127** EMAIL ADDRESS **glb@glbexplorationinc.com**

AS SUBMITTED

FORMATION RECORD

LEASE NAME

WELL NO. _____

Were open hole logs run? X yes no

Date Last log was run 8/22/18

Was CO₂ encountered? yes X no at what depths?

Was H₂S encountered? yes X no at what depths?

Were unusual drilling circumstances encountered? yes X no

If yes, briefly explain below

LATERAL #3						
SEC	TWP	RGE	COUNTY			
Spot Location						
1/4	1/4	1/4	Feet From 1/4 Sec Lines	FSL	FWL	
Depth of Deviation		Radius of Turn	Direction	Total Length		
Measured Total Depth		True Vertical Depth	BHL From Lease, Unit, or Property Line:			