

Oklahoma Corporation Commission
Oil & Gas Conservation Division
Post Office Box 52000
Oklahoma City, Oklahoma 73152-2000
Rule 165: 10-3-25

Form 1002A

API No.: 35051244170000

Completion Report

Spud Date: July 25, 2018

OTC Prod. Unit No.: 051-225401-0-0000

Drilling Finished Date: September 28, 2018

1st Prod Date: April 15, 2019

Completion Date: April 15, 2019

Drill Type: HORIZONTAL HOLE

Well Name: JEANNIE 5-27X34H

Purchaser/Measurer:

Location: GRADY 27 5N 6W
NW SW NW SE
1876 FSL 2381 FEL of 1/4 SEC
Latitude: 34.874683 Longitude: -97.81923
Derrick Elevation: 0 Ground Elevation: 1148

First Sales Date:

Operator: GULFPORT MIDCON LLC 24020

3001 QUAIL SPRINGS PKWY
OKLAHOMA CITY, OK 73134-2640

Completion Type	
X	Single Zone
	Multiple Zone
	Commingled

Location Exception	
Order No	
700539	

Increased Density	
Order No	
680412	
684013	

Casing and Cement							
Type	Size	Weight	Grade	Feet	PSI	SAX	Top of CMT
CONDUCTOR	30			128			
SURFACE	13 5/8		J-55	1513		865	SURFACE
INTERMEDIATE	9 5/8		P-110HC	9655		965	4302
INTERMEDIATE	7 5/8		P-110HC	9395		774	2449
PRODUCTION	5 1/2		P-110	21703		860	8626

Liner								
Type	Size	Weight	Grade	Length	PSI	SAX	Top Depth	Bottom Depth
There are no Liner records to display.								

Total Depth: 21715

Packer	
Depth	Brand & Type
There are no Packer records to display.	

Plug	
Depth	Plug Type
There are no Plug records to display.	

Initial Test Data

Test Date	Formation	Oil BBL/Day	Oil-Gravity (API)	Gas MCF/Day	Gas-Oil Ratio Cu FT/BBL	Water BBL/Day	Pumpin or Flowing	Initial Shut-In Pressure	Choke Size	Flow Tubing Pressure
May 07, 2019	WOODFORD	730	59	16340	22383	5146	FLOWING	4481	32/64	

Completion and Test Data by Producing Formation	
Formation Name: WOODFORD	Code: 319WDFD
Class: GAS	

Spacing Orders	
Order No	Unit Size
446322	640
456941	640
700658	MULTIUNIT

Perforated Intervals	
From	To
15287	21590

Acid Volumes	
991 BARRELS ACID	

Fracture Treatments	
348,008 BARRELS WATER, 13,577,763 POUNDS SAND	

Formation	Top
WOODFORD	14950

Were open hole logs run? No

Date last log run:

Were unusual drilling circumstances encountered? No

Explanation:

Other Remarks
OCC - SURFACE LOCATION FOOTAGES.

Lateral Holes
Sec: 34 TWP: 5N RGE: 6W County: GRADY SW SW SW SE 113 FSL 2337 FEL of 1/4 SEC Depth of Deviation: 14659 Radius of Turn: 769 Direction: 182 Total Length: 6456 Measured Total Depth: 21715 True Vertical Depth: 15259 End Pt. Location From Release, Unit or Property Line: 113

FOR COMMISSION USE ONLY	
Status: Accepted	1143157

API NO. 051-24417
OTC PROD.
UNIT NO. 051225401-0-0000

(PLEASE TYPE OR USE BLACK INK ONLY)

OKLAHOMA CORPORATION COMMISSION
Oil & Gas Conservation Division
Post Office Box 52000
Oklahoma City, Oklahoma 73152-2000
Rule 165:10-3-25

RECEIVED

JUN 1 9 2019

Oklahoma Corporation
Commission

Form 1002A
Rev. 2009

☒ ORIGINAL
☐ AMENDED (Reason)

TYPE OF DRILLING OPERATION

☐ STRAIGHT HOLE ☐ DIRECTIONAL HOLE ☒ HORIZONTAL HOLE
☐ SERVICE WELL

If directional or horizontal, see reverse for bottom hole location.

COUNTY Grady SEC 27 TWP 5N RGE 6W
LEASE NAME Jeannie
WELL NO. 5-27X34H
NW 1/4 SW 1/4 NW 1/4 SE 1/4 FSL OF 1876 (FEL) 2386
ELEVATION Ground 1148
Derrick FL 1148
Latitude (if known) 34.874683
Longitude (if known) -97.81923
OPERATOR NAME Gulfport MidCon OTC / OCC OPERATOR NO. 24020
ADDRESS 3001 Quail Springs Parkway
CITY Oklahoma City STATE OK ZIP 73134

SPUD DATE 7/25/2018
DRLG FINISHED DATE 9/28/2018
DATE OF WELL COMPLETION 4/15/2019
1st PROD DATE 4/15/2019
RECOMP DATE

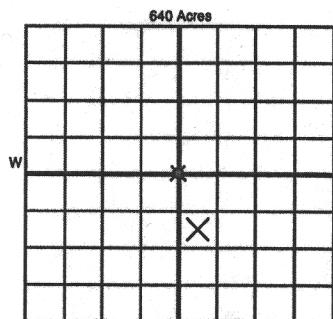

COMPLETION TYPE

☒ SINGLE ZONE
☐ MULTIPLE ZONE
Application Date
COMINGLED
Application Date
LOCATION EXCEPTION
ORDER NO.
INCREASED DENSITY
ORDER NO.

CASING & CEMENT (Attach Form 1002C)

TYPE	SIZE	WEIGHT	GRADE	FEET	PSI	SAX	TOP OF CMT
CONDUCTOR	30			128			
SURFACE	13 5/8		J55	1,513		865	Surface
INTERMEDIATE	9 5/8		P110HC	9,655		965	5,353
PRODUCTION	7 5/8		P110HC	9,395		774	6,946
INNER PRODUCTION	5 1/2		P110	21,703		860	13,977
						TOTAL DEPTH	21,715

PACKER @ BRAND & TYPE PLUG @ TYPE PLUG @ TYPE
PACKER @ BRAND & TYPE PLUG @ TYPE PLUG @ TYPE

COMPLETION & TEST DATA BY PRODUCING FORMATION

FORMATION	Woodford	Woodford					
SPACING & SPACING ORDER NUMBER	446322 (446) 640/#456941	MU#681306	100658				Reported to Frac Focus
CLASS: Oil, Gas, Dry, Inj, Disp, Comm Disp, Svc	GAS						
PERFORATED INTERVALS	15,287-21,590						
ACID/VOLUME	991 bbls Acid						
FRACTURE TREATMENT (Fluids/Prop Amounts)	348,008 bbls Water						
	13,577,763 bbls Sand						

Min Gas Allowable (165:10-17-7) OR Gas Purchaser/Measurer
Oil Allowable (165:10-13-3) First Sales Date

INITIAL TEST DATA

INITIAL TEST DATE	5/7/2019				
OIL-BBL/DAY	730				
OIL-GRAVITY (API)	59				
GAS-MCF/DAY	16,340				
GAS-OIL RATIO CU FT/BBL	22,383				
WATER-BBL/DAY	5,146				
PUMPING OR FLOWING	Flowing				
INITIAL SHUT-IN PRESSURE	4,481				
CHOKE SIZE	32/64				
FLOW TUBING PRESSURE	N/A				

AS SUBMITTED

A record of the formations drilled through, and pertinent remarks are presented on the reverse. I declare that I have knowledge of the contents of this report and am authorized by my organization to make this report, which was prepared by me or under my supervision and direction, with the data and facts stated herein to be true, correct, and complete to the best of my knowledge and belief.

SIGNATURE Monica Pickens 6/14/2019 252-4703
NAME (PRINT OR TYPE) DATE PHONE NUMBER
3001 Quail Springs Parkway OK OK 73134
ADDRESS CITY STATE ZIP
mpickens@gulfportenergy.com
EMAIL ADDRESS

PLEASE TYPE OR USE BLACK INK ONLY
FORMATION RECORD

Give formation names and tops, if available, or descriptions and thickness of formations drilled through. Show intervals cored or drillstem tested.

NAMES OF FORMATIONS	TOP
Woodford	14,950

LEASE NAME Jeannie WELL NO. 5-27X34H

FOR COMMISSION USE ONLY	
ITD on file <input type="checkbox"/> YES <input type="checkbox"/> NO	
APPROVED _____ DISAPPROVED _____	2) Reject Codes _____

Were open hole logs run?	yes	<input checked="" type="checkbox"/> no
Date Last log was run	_____	
Was CO ₂ encountered?	yes	<input checked="" type="checkbox"/> no at what depths? _____
Was H ₂ S encountered?	yes	<input checked="" type="checkbox"/> no at what depths? _____
Were unusual drilling circumstances encountered?	yes	<input checked="" type="checkbox"/> no
If yes, briefly explain below _____		

Other remarks:

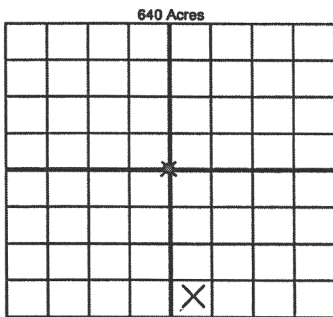

If more than three drainholes are proposed, attach a separate sheet indicating the necessary information.

Direction must be stated in degrees azimuth. Please note, the horizontal drainhole and its end point must be located within the boundaries of the lease or spacing unit.

Directional surveys are required for all drainholes and directional wells.

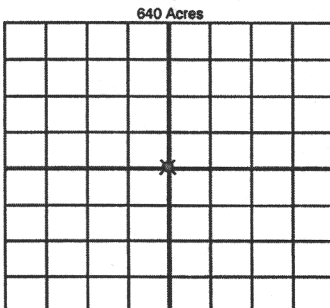

BOTTOM HOLE LOCATION FOR DIRECTIONAL HOLE

SEC	TWP	RGE	COUNTY
Spot Location	1/4	1/4	1/4
Measured Total Depth	True Vertical Depth		BHL From Lease, Unit, or Property Line:

BOTTOM HOLE LOCATION FOR HORIZONTAL HOLE: (LATERALS)

LATERAL #1

SEC	TWP	RGE	COUNTY
34	5N	6W	Grady
Spot Location	SW 1/4	SW 1/4	SE 1/4
Depth of Deviation	14,659	Radius of Turn	769
Measured Total Depth	21,715	True Vertical Depth	15,259
Direction		182-175	Total Length 6,456
BHL From Lease, Unit, or Property Line:		151 113	

Per Exhibit FLEB MU

As Drilled Plot

LATERAL #2

SEC	TWP	RGE	COUNTY
Spot Location	1/4	1/4	1/4
Depth of Deviation	Radius of Turn		Direction
Measured Total Depth	True Vertical Depth		Total Length
BHL From Lease, Unit, or Property Line:			

LATERAL #3

SEC	TWP	RGE	COUNTY
Spot Location	1/4	1/4	1/4
Depth of Deviation	Radius of Turn		Direction
Measured Total Depth	True Vertical Depth		Total Length
BHL From Lease, Unit, or Property Line:			

(PLEASE TYPE OR USE BLACK INK ONLY)

OKLAHOMA CORPORATION COMMISSION
Oil & Gas Conservation Division
Post Office Box 52000
Oklahoma City, Oklahoma 73152-2000
Rule 165:10-3-25

RECEIVED

AUG 14 2019

Form 1002A
Rev. 2009

**Oklahoma Corporation
Commission**

X	ORIGINAL
	AMENDED (Reason)

COMPLETION REPORT

TYPE OF DRILLING OPERATION

☐ STRAIGHT HOLE ☐ DIRECTIONAL HOLE ☒ HORIZONTAL HOLE

Service Well
If directional or horizontal, see reverse for bottom hole location.

COUNTY	Grady	SEC	27	TWP	5N	RGE	6W	DATE	4/15/2019
LEASE NAME	Jeannie				WELL NO.	5-27X34H		DATE OF WELL COMPLETION	4/15/2019
NW 1/4 SW 1/4 NW 1/4 SE 1/4	FSL OF 1/4 SEC		1876		FEL 1/4 SEC	2381		1st PROD DATE	4/15/2019
ELEVATION Derrick FL	Ground	1148	Latitude (if known)		34.874683		Longitude (if known)	-97.81923	
OPERATOR NAME	Gulfport MidCon						OTC / OCC OPERATOR NO.	24020	
ADDRESS 3001 Quail Springs Parkway									
CITY	Oklahoma City				STATE	OK	ZIP	73134	

COMPLETION TYPE

X	SINGLE ZONE	
	MULTIPLE ZONE	
	Application Date	
	COMMINGLED	
	Application Date	
LOCATION EXCEPTION ORDER NO.		681305
INCREASED DENSITY ORDER NO.		680412/684013

CASING & CEMENT (Attach Form 1002C)

TYPE	SIZE	WEIGHT	GRADE	FEET	PSI	SAX	TOP OF CMT
CONDUCTOR	30			128			
SURFACE	13 5/8		J55	1,513		865	Surface
INTERMEDIATE	9 5/8		P110HC	9,655		965	5,353
PRODUCTION	7 5/8		P110HC	9,395		774	6,946
LINER	5 1/2		P110	21,703		860	13,077
PLUG @	TYPE	PLUG @	TYPE	TOTAL DEPTH			21,715

PACKER @	BRAND & TYPE	PLUG @	TYPE	PLUG @	TYPE
PACKER @	BRAND & TYPE	PLUG @	TYPE	PLUG @	TYPE

COMPLETION & TEST DATA BY PRODUCING FORMATION

FORMATION	Woodford	Woodford				
SPACING & SPACING ORDER NUMBER	640/#456941	MU#681306				
CLASS: Oil, Gas, Dry, Inj, Disp, Comm Disp, Svc	GAS					
PERFORATED INTERVALS	15,287-21,590					
ACID/VOLUME	991 bbls Acid					
FRACTURE TREATMENT (Fluids/Prop Amounts)	348,008 bbls Water					
	13,577,763 bbls Sand					

Min Gas Allowable (165:10-17-7)

Gas Purchaser/Measurer
First Sales Date

INITIAL TEST DATA

INITIAL TEST DATE	5/7/2019					
OIL-BBL/DAY	730					
OIL-GRAVITY (API)	59					
GAS-MCF/DAY	16,340					
GAS-OIL RATIO CU FT/BBL	22,383					
WATER-BBL/DAY	5,146					
PUMPING OR FLOWING	Flowing					
INITIAL SHUT-IN PRESSURE	4,481					
CHOKE SIZE	32/64					
FLOW TUBING PRESSURE	N/A					

AS SUBMITTED

A record of the formations drilled through, and pertinent remarks are presented on the reverse. I declare that I have knowledge of the contents of this report and am authorized by my organization to make this report, which was prepared by me or under my supervision and direction, with the data and facts stated herein to be true, correct, and complete to the best of my knowledge and belief.

 SIGNATURE		Monica Pickens NAME (PRINT OR TYPE)		6/14/2019 DATE		252-4703 PHONE NUMBER	
3001 Quail Springs Parkway ADDRESS		OKC CITY	OK STATE	73134 ZIP	mpickens@gulfportenergy.com EMAIL ADDRESS		

PLEASE TYPE OR USE BLACK INK ONLY
FORMATION RECORD

Give formation names and tops, if available, or descriptions and thickness of formations drilled through. Show intervals cored or drillstem tested.

NAMES OF FORMATIONS	TOP
Woodford	14,950

LEASE NAME Jeannie WELL NO. 5-27X34H

FOR COMMISSION USE ONLY	
ITD on file <input type="checkbox"/> YES <input type="checkbox"/> NO	
APPROVED _____	DISAPPROVED _____
2) Reject Codes	

Were open hole logs run?	_____ yes <input checked="" type="checkbox"/> no
Date Last log was run	_____
Was CO ₂ encountered?	_____ yes <input checked="" type="checkbox"/> no at what depths? _____
Was H ₂ S encountered?	_____ yes <input checked="" type="checkbox"/> no at what depths? _____
Were unusual drilling circumstances encountered?	_____ yes <input checked="" type="checkbox"/> no
If yes, briefly explain below	

Other remarks:

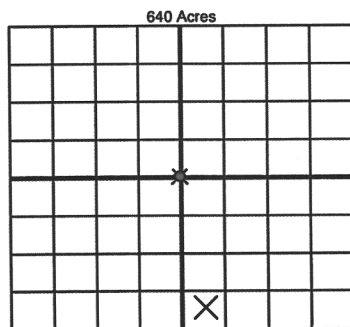

If more than three drainholes are proposed, attach a separate sheet indicating the necessary information.

Direction must be stated in degrees azimuth.
Please note, the horizontal drainhole and its end point must be located within the boundaries of the lease or spacing unit.

Directional surveys are required for all drainholes and directional wells.

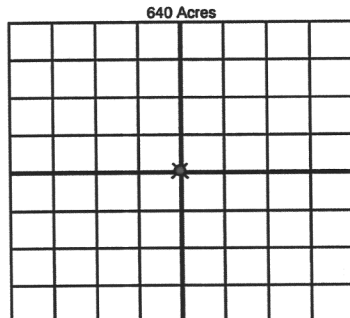

BOTTOM HOLE LOCATION FOR DIRECTIONAL HOLE

SEC	TWP	RGE	COUNTY
Spot Location	1/4	1/4	1/4
Measured Total Depth	True Vertical Depth	BHL From Lease, Unit, or Property Line:	

BOTTOM HOLE LOCATION FOR HORIZONTAL HOLE: (LATERALS)

LATERAL #1			
SEC	TWP	RGE	COUNTY
34	5N	6W	Grady
Spot Location	S2 1/4	SW 1/4	SE 1/4
Depth of Deviation	14,659	Radius of Turn	769
Measured Total Depth	21,715	True Vertical Depth	15,259
Feet From 1/4 Sec Lines	FSL 151	FEL 2336	
Direction	175	Total Length	6,456
BHL From Lease, Unit, or Property Line: 151			

LATERAL #2			
SEC	TWP	RGE	COUNTY
Spot Location	1/4	1/4	1/4
Depth of Deviation	Radius of Turn	Direction	Total Length
Measured Total Depth	True Vertical Depth	BHL From Lease, Unit, or Property Line:	

LATERAL #3			
SEC	TWP	RGE	COUNTY
Spot Location	1/4	1/4	1/4
Depth of Deviation	Radius of Turn	Direction	Total Length
Measured Total Depth	True Vertical Depth	BHL From Lease, Unit, or Property Line:	

4/15/2019
Oklahoma Corporation Commission
Oil & Gas Conservation Division
Post Office Box 52000
Oklahoma City, Oklahoma 73152-2000
Rule 165: 10-3-25
Paper 1002A
Reid 6-19-2019
Completion Report

Form 1002A

1002A
Addendum

API No.: 051244170000

OTC Prod. Unit No.: 051-225401-0-0000 ✓

Spud Date: July 25, 2018

Drilling Finished Date: September 28, 2018

1st Prod Date: April 15, 2019

Completion Date: April 15, 2019

Drill Type: HORIZONTAL HOLE

Well Name: JEANNIE 5-27X34H

Purchaser/Measurer:

Location: GRADY 27 5N 6W
NW SW NW SE
1876 FSL 2381 FEL of 1/4 SEC
Latitude: 34.874683 Longitude: -97.81923
Derrick Elevation: 0 Ground Elevation: 1148

First Sales Date:

Operator: GULFPORT MIDCON LLC 24020

3001 QUAIL SPRINGS PKWY
OKLAHOMA CITY, OK 73134-2640

Multiunit:
Sec. 27 (SL): 19.5 % 225401 I
Sec. 34: 80.5 % 225401A I

Completion Type		Location Exception		Increased Density	
X	Single Zone	Order No		Order No	
	Multiple Zone	700539		680412	
	Commingled			684013	

Casing and Cement							
Type	Size	Weight	Grade	Feet	PSI	SAX	Top of CMT
CONDUCTOR	30			128			
SURFACE	13 5/8		J-55	1513		865	SURFACE
INTERMEDIATE	9 5/8		P-110HC	9655		965	4302
INTERMEDIATE	7 5/8		P-110HC	9395		774	2449
PRODUCTION	5 1/2		P-110	21703		860	8626

Liner								
Type	Size	Weight	Grade	Length	PSI	SAX	Top Depth	Bottom Depth
There are no Liner records to display.								

Total Depth: 21715

Packer	
Depth	Brand & Type
There are no Packer records to display.	

Plug	
Depth	Plug Type
There are no Plug records to display.	

Initial Test Data

September 04, 2019

1 of 2

EC 5-7-19

319WDFD

448 PSI

JR

Test Date	Formation	Oil BBL/Day	Oil-Gravity (API)	Gas MCF/Day	Gas-Oil Ratio Cu FT/BBL	Water BBL/Day	Pumpin or Flowing	Initial Shut-In Pressure	Choke Size	Flow Tubing Pressure
May 07, 2019	WOODFORD	730	59	16340	22383	5146	FLOWING	4481	32/64	

Completion and Test Data by Producing Formation

Formation Name: WOODFORD

Code: 319WDFD

Class: GAS

Spacing Orders

Order No	Unit Size
446322 (27)	640 ✓ ✓
456941 (34)	640 ✓ ✓
700658	MULTIUNIT ✓

Perforated Intervals

From	To
15287	21590

Acid Volumes

991 BARRELS ACID

Fracture Treatments

348,008 BARRELS WATER, 13,577,763 POUNDS SAND

WFT 708769

Formation	Top
WOODFORD	14950

Were open hole logs run? No

Date last log run:

Were unusual drilling circumstances encountered? No

Explanation:

Other Remarks

OCC - SURFACE LOCATION FOOTAGES.

Lateral Holes

Sec: 34 TWP: 5N RGE: 6W County: GRADY

SW SW SW SE

113 FSL 2337 FEL of 1/4 SEC

Depth of Deviation: 14659 Radius of Turn: 769 Direction: 182 Total Length: 6456

Measured Total Depth: 21715 True Vertical Depth: 15259 End Pt. Location From Release, Unit or Property Line: 113

FOR COMMISSION USE ONLY

1143157

Status: Accepted