

Oklahoma Corporation Commission
Oil & Gas Conservation Division
Post Office Box 52000
Oklahoma City, Oklahoma 73152-2000
Rule 165: 10-3-25

Form 1002A

API No.: 35049219600001

Completion Report

Spud Date: December 11, 2018

OTC Prod. Unit No.:

Drilling Finished Date: January 02, 2019

Amended

1st Prod Date: June 12, 2019

Amend Reason: RE-ENTRY / CHANGE WELL NAME

Completion Date: January 16, 2019

Drill Type: STRAIGHT HOLE

Min Gas Allowable: Yes

Well Name: ELK RUN (FERGUSON 10-6) 1-6

Purchaser/Measurer: CIMAREX

Location: GARVIN 6 1N 2W
C SW NW SE
1650 FSL 330 FWL of 1/4 SEC
Derrick Elevation: 0 Ground Elevation: 0

First Sales Date: 06/12/2019

Operator: SHAMROCK WELL OPERATIONS LLC 24071

312 S 16TH ST
FORT SMITH, AR 72901-3834

Completion Type		Location Exception		Increased Density	
X	Single Zone	Order No		Order No	
	Multiple Zone	There are no Location Exception records to display.		There are no Increased Density records to display.	
	Commingled				

Casing and Cement							
Type	Size	Weight	Grade	Feet	PSI	SAX	Top of CMT
SURFACE	9 5/8	36	K-55	1539		690	SURFACE
PRODUCTION	5 1/2	17	N-80	11136	2000	1172	9400

Liner								
Type	Size	Weight	Grade	Length	PSI	SAX	Top Depth	Bottom Depth
There are no Liner records to display.								

Total Depth: 11150

Packer	
Depth	Brand & Type
There are no Packer records to display.	

Plug	
Depth	Plug Type
There are no Plug records to display.	

Initial Test Data										
Test Date	Formation	Oil BBL/Day	Oil-Gravity (API)	Gas MCF/Day	Gas-Oil Ratio Cu FT/BBL	Water BBL/Day	Pumpin or Flowing	Initial Shut-In Pressure	Choke Size	Flow Tubing Pressure
Jun 12, 2019	HUNTON	10	43	75	7500	2	FLOWING	1400	12/64	30

Completion and Test Data by Producing Formation

Formation Name: HUNTON

Code: 269HNTN

Class: OIL

Spacing Orders

Order No	Unit Size
170515	80

Perforated Intervals

From	To
9696	9703

Acid Volumes

4,000 GALLONS 15%

Fracture Treatments

NONE

Formation	Top
GIBSON	7654
SPRINGER	7900
MISSISSIPPI	8722
UPPER SYCAMORE	9010
LOWER SYCAMORE	9069
WOODFORD	9206
HUNTON	9442
SYLVAN	9706
VIOLA	9949
DENSE BROMIDE	10457
SIMPSON GREEN SHALE	10562
FIRST BROMIDE	10580
SECOND BROMIDE	10713
BASAL BROMIDE	10844
UPPER MCLISH SAND	11010

Were open hole logs run? No

Date last log run:

Were unusual drilling circumstances encountered? No

Explanation:

Other Remarks

RE-ENTRY OF CASILLAS PETROLEUM CORPORATION "FERGUSON 10-6 WELL". DRILLED OUT AND LANDED TUBING @ 9,966', SHOT SQUEEZE HOLES @ 9,830' AND 9,450', SQUEEZED WITH 125 SACKS CEMENT. CEMENT BOND LOG SHOWED GOOD BOND FROM 9,800' - 9,520'. DRILLED OUT SQUEEZE AND MOVED AHEAD WITH COMPLETING HUNTON PER INFORMATION ON FORM. ALL SURFACE AND PRODUCTION CASING INFORMATION AND FORMATION TOPS ARE FROM ORIGINAL 1002A.

FOR COMMISSION USE ONLY

1143297

Status: Accepted

API NO. 04921960
OTC PROD. UNIT NO.

(PLEASE TYPE OR USE BLACK INK ONLY)

OKLAHOMA CORPORATION COMMISSION
Oil & Gas Conservation Division
Post Office Box 52000
Oklahoma City, Oklahoma 73152-2000
Rule 165:10-3-25

RECEIVED

Form 1002A
Rev. 2009

JUN 28 2019

OKLAHOMA CORPORATION COMMISSION

ORIGINAL
☒ AMENDED (Reason)

Re-entry/Change Well Name

COMPLETION REPORT

TYPE OF DRILLING OPERATION

☒ STRAIGHT HOLE ☐ DIRECTIONAL HOLE ☐ HORIZONTAL HOLE
☐ SERVICE WELL

If directional or horizontal, see reverse for bottom hole location.

COUNTY Garvin SEC 6 TWP 01N RGE 02W
LEASE NAME Elk Run (Formerly Ferguson 10-6) WELL NO. 1-6
C 1/4 SW 1/4 NW 1/4 SE 1/4 FSL OF 1/4 SEC 1650 FWL OF 1/4 SEC 330
ELEVATION Ground Latitude (if known) Longitude (if known)
OPERATOR NAME Shamrock Well Operations, LLC OTC / OCC OPERATOR NO. 24071
ADDRESS 312 South 16th Street
CITY Fort Smith STATE AR ZIP 72901

SPUD DATE 12/12/18

DRLG FINISHED DATE 1/2/19

DATE OF WELL COMPLETION 1/16/19

1st PROD DATE 6/12/19

RECOMP DATE

W E
LOCATE WELL

COMPLETION TYPE

☒ SINGLE ZONE
☐ MULTIPLE ZONE
Application Date
COMINGLED
Application Date
LOCATION EXCEPTION ORDER NO.
INCREASED DENSITY ORDER NO.

CASING & CEMENT (Attach Form 1002C)

TYPE	SIZE	WEIGHT	GRADE	FEET	PSI	SAX	TOP OF CMT
CONDUCTOR							
SURFACE	9 5/8"	36#	K-55	1,539		690	Surface
INTERMEDIATE							
PRODUCTION	5 1/2"	17#	N-80	11,136	2,000#	1,172	9,964'
LINER							

TOTAL DEPTH 11,150'

PACKER @ BRAND & TYPE PLUG @ TYPE PLUG @ TYPE
PACKER @ BRAND & TYPE PLUG @ TYPE PLUG @ TYPE

COMPLETION & TEST DATA BY PRODUCING FORMATION

FORMATION Hunton
SPACING & SPACING ORDER NUMBER 80 acres, 170515
CLASS: Oil, Gas, Dry, Inj, Disp, Comm Disp, Svc Oil
PERFORATED INTERVALS 9,696' - 9,703'
ACID/VOLUME 4,000 gal 15%
FRACTURE TREATMENT (Fluids/Prop Amounts) NONE

Min Gas Allowable (165:10-17-7)

Gas Purchaser/Measurer

Cimarex



OR

First Sales Date

6/12/2019

INITIAL TEST DATA

Oil Allowable (165:10-13-3)

INITIAL TEST DATE 6/12/2019
OIL-BBL/DAY 10
OIL-GRAVITY (API) 43
GAS-MCF/DAY 75
GAS-OIL RATIO CU FT/BBL 7.54 7500
WATER-BBL/DAY 2
PUMPING OR FLOWING Flowing
INITIAL SHUT-IN PRESSURE 1,400 psi
CHOKE SIZE 12/64"
FLOW TUBING PRESSURE 30 psi

AS SUBMITTED

A record of the formations drilled through, and pertinent remarks are presented on the reverse. I declare that I have knowledge of the contents of this report and am authorized by my organization to make this report which was prepared by me or under my supervision and direction, with the data and facts stated herein to be true, correct, and complete to the best of my knowledge and belief.

Patrick E. Shields

6/26/2019

479-785-1222

SIGNATURE

NAME (PRINT OR TYPE)

DATE

PHONE NUMBER

312 South 16th Street

Fort Smith

AR

72901

pshields@shieldsfs.com

ADDRESS

CITY

STATE

ZIP

EMAIL ADDRESS

PLEASE TYPE OR USE BLACK INK ONLY

FORMATION RECORD

Give formation names and tops, if available, or descriptions and thickness of formations drilled through. Show intervals cored or drillstem tested.

LEASE NAME _____

WELL NO. _____

NAMES OF FORMATIONS	TOP
Gibson	7,654
Springer	7,900
Mississippi	8722
Upper Sycamore	9,010
Lower Sycamore	9,069
Woodford	9,206
Hunton	9,442
Sylvan	9,706
Viola	9,949
Dense Bromide	10,457
Simpson Green Shale	10,562
First Bromide	10,580
2nd Bromide	10,713
Basal Bromide	10,844
Upper McLish Sd	11,010

FOR COMMISSION USE ONLY	
ITD on file <input type="checkbox"/> YES <input type="checkbox"/> NO	
APPROVED _____	DISAPPROVED _____
2) Reject Codes	

Were open hole logs run?	_____ yes <input checked="" type="checkbox"/> no
Date Last log was run	_____
Was CO ₂ encountered?	_____ yes <input checked="" type="checkbox"/> no at what depths? _____
Was H ₂ S encountered?	_____ yes <input checked="" type="checkbox"/> no at what depths? _____
Were unusual drilling circumstances encountered?	_____ yes <input checked="" type="checkbox"/> no
If yes, briefly explain below	

Other remarks: Re-entry of Casillas Petroleum Corporation "Ferguson #10-6 Well". Drilled out & landed tbg @ 9,966', shot squeeze holes @ 9,830' & 9,450', squeezed w/ 125 sks cmt. CBL showed good bond from 9,800-9,520'. Drilled out squeeze & moved ahead w/ completing Hunton per info on form. All surface and production casing information and formation tops are from original 1002A.

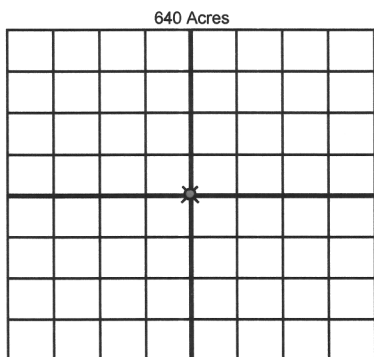

If more than three drainholes are proposed, attach a separate sheet indicating the necessary information.

Direction must be stated in degrees azimuth. Please note, the horizontal drainhole and its end point must be located within the boundaries of the lease or spacing unit.

Directional surveys are required for all drainholes and directional wells.

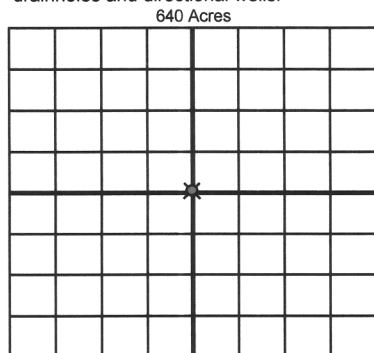

BOTTOM HOLE LOCATION FOR DIRECTIONAL HOLE

SEC	TWP	RGE	COUNTY
Spot Location			
1/4	1/4	1/4	1/4
Measured Total Depth		True Vertical Depth	BHL From Lease, Unit, or Property Line:

BOTTOM HOLE LOCATION FOR HORIZONTAL HOLE: (LATERALS)

LATERAL #1

SEC	TWP	RGE	COUNTY
Spot Location			
1/4	1/4	1/4	1/4
Depth of Deviation		Radius of Turn	Direction
Measured Total Depth		True Vertical Depth	BHL From Lease, Unit, or Property Line:

LATERAL #2

SEC	TWP	RGE	COUNTY
Spot Location			
1/4	1/4	1/4	1/4
Depth of Deviation		Radius of Turn	Direction
Measured Total Depth		True Vertical Depth	BHL From Lease, Unit, or Property Line:

LATERAL #3

SEC	TWP	RGE	COUNTY
Spot Location			
1/4	1/4	1/4	1/4
Depth of Deviation		Radius of Turn	Direction
Measured Total Depth		True Vertical Depth	BHL From Lease, Unit, or Property Line: