

Oklahoma Corporation Commission
Oil & Gas Conservation Division
Post Office Box 52000
Oklahoma City, Oklahoma 73152-2000
Rule 165: 10-3-25

Form 1002A

API No.: 35003219430003

Completion Report

Spud Date: November 14, 2009

OTC Prod. Unit No.: 003-203727-0-0000

Drilling Finished Date: November 22, 2009

Amended

1st Prod Date: February 18, 2010

Amend Reason: RECOMPLETE

Completion Date: February 17, 2010

Recomplete Date: October 19, 2021

Drill Type: STRAIGHT HOLE

Min Gas Allowable: Yes

Well Name: SCOTT DAVID 1-19

Purchaser/Measurer:

Location: ALFALFA 19 28N 9W
C W2 SW NE
1980 FNL 2310 FEL of 1/4 SEC
Latitude: 36.893138889 Longitude: -98.20725
Derrick Elevation: 0 Ground Elevation: 0

First Sales Date:

Operator: SANDRIDGE EXPLORATION & PRODUCTION LLC 22281

1 E SHERIDAN AVE #500
OKLAHOMA CITY, OK 73104-2496

Completion Type		Location Exception		Increased Density	
X	Single Zone	Order No		Order No	
	Multiple Zone	573706		There are no Increased Density records to display.	
	Commingled	719521			

Casing and Cement							
Type	Size	Weight	Grade	Feet	PSI	SAX	Top of CMT
CONDUCTOR	16	65	H-40	48	736	2	SURFACE
SURFACE	8 5/8	24	J-55	315	3810	230	SURFACE
PRODUCTION	4 1/2	11.60	J-55	5081	5350	90	4680

Liner								
Type	Size	Weight	Grade	Length	PSI	SAX	Top Depth	Bottom Depth
There are no Liner records to display.								

Total Depth: 5093

Packer		Plug	
Depth	Brand & Type	Depth	Plug Type
4982.64	MODEL R	4987	CIBP + 5' CEMENT

Initial Test Data

Test Date	Formation	Oil BBL/Day	Oil-Gravity (API)	Gas MCF/Day	Gas-Oil Ratio Cu FT/BBL	Water BBL/Day	Pumpin or Flowing	Initial Shut-In Pressure	Choke Size	Flow Tubing Pressure
Feb 20, 2010	MISSISSIPPIAN	5	35	150	30000	8	FLOWING	230	10/64	50
Oct 05, 2021	CHEROKEE SAND	24	36	20	864	6	PUMPING	475	N/A	30

Completion and Test Data by Producing Formation										
Formation Name: MISSISSIPPIAN				Code: 359MSSP				Class: DRY		
Spacing Orders				Perforated Intervals						
Order No		Unit Size		From			To			
573034		160		4995			5016			
Acid Volumes				Fracture Treatments						
500 GALLONS 15% HCL				N/A						
Formation Name: CHEROKEE SAND				Code: 404CHRKS				Class: OIL		
Spacing Orders				Perforated Intervals						
Order No		Unit Size		From			To			
719351		160		4950			4955			
Acid Volumes				Fracture Treatments						
1,850 GALLONS 7 1/2% NEFE HCL				1,500 BARRELS 15 POUNDS XL GEL, 76,000 POUNDS 20/40						

Formation	Top
-----------	-----

Were open hole logs run? Yes
Date last log run: December 10, 2009

Were unusual drilling circumstances encountered? No
Explanation:

Other Remarks
CIBP SET @ 4,987' KB, 4 1/2" 10K PSI CIBP; CAPPED PLUGGED WITH 5' OF CEMENT

FOR COMMISSION USE ONLY
<div> <div>Status: Accepted</div> <div>1147311</div> </div>

API NO. 35-003-21943
OTC PROD. UNIT NO. 003-203727-0-00

Oil and Gas Conservation Division
P.O. Box 52000
Oklahoma City, OK 73152-2000
405-521-2331
OCC Central Processing @ OCC.OK.GOV



OKLAHOMA
Corporation
Commission

Form 1002A
Rev. 2021

☒ ORIGINAL
☐ AMENDED (Reason) _____ Recomplete

Rule 165:10-3-25

COMPLETION REPORT

TYPE OF DRILLING OPERATION
☒ STRAIGHT HOLE ☐ DIRECTIONAL HOLE ☐ HORIZONTAL HOLE
☐ SERVICE WELL

SPUD DATE 11/14/2009
DRLG FINISHED DATE 11/22/2009

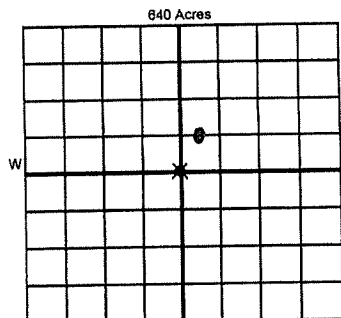

If directional or horizontal, see reverse for bottom hole location.

COUNTY ALFALFA SEC 19 TWP 28N RGE 09W
LEASE NAME SCOTT DAVID WELL NO. 1-19
C 1/4 W2 1/4 SW 1/4 NE 1/4 (FNL) 1980 (FEL) 2310
ELEVATION Derriek FL Ground Latitude Longitude
OPERATOR NAME SANDRIDGE EXPLORATION AND PRODUCTION, LLC OTC / OCC OPERATOR NO. 22281
ADDRESS 1 E. SHERIDAN AVE, SUITE 500
CITY OKLAHOMA CITY STATE OK ZIP 73104

COMPLETION TYPE

☒ SINGLE ZONE
☐ MULTIPLE ZONE
☐ COMMINGLED
LOCATION EXCEPTION ORDER NO. 573706 719521
MULTIUNIT ORDER NO.
INCREASED DENSITY ORDER NO.

CASING & CEMENT (Attach Form 1002C)

TYPE	SIZE	WEIGHT	GRADE	FEET	PSI	SAX	TOP OF CMT
CONDUCTOR	16"	65#	H-40	48'	736#	2 cub yd	surface
SURFACE	8 5/8"	24#	J-55	315.64'	3810#	230	surface
INTERMEDIATE							
PRODUCTION	4 1/2"	11.60#	J-55	5081.28'	5350#	90	4680'
LINER							

PACKER @ 4981.64' BRAND & TYPE Model R PLUG @ 4987 TYPE CIBP PLUG @ 5093
PACKER @ BRAND & TYPE PLUG @ TYPE PLUG @ TYPE
COMPLETION & TEST DATA BY PRODUCING FORMATION 359MSSP 404CHRS

FORMATION	Mississippian	Cherokee Sand					Monitor Report to File 10/20/21
SPACING & SPACING ORDER NUMBER	573034-160ac	719351 (160)					
CLASS: Oil, Gas, Dry, Inj, Disp, Comm Disp, Svc	Gas Dry below CIBP	Oil					
PERFORATED INTERVALS	4,995'-5,016'	4,950'-4,955' KB					RECEIVED NOV 18 2021
ACID/VOLUME	500 gal 15% HCL	1,850 g/7-12% NeFe HCL					OKLAHOMA CORPORATION COMMISSION
FRACTURE TREATMENT (Fluids/Prop Amounts)	N/A	1,500BBLs 15# XL Gel; 76,000 lbs 20/40					

☒ Min Gas Allowable (165:10-17-7)
OR
☐ Oil Allowable (165:10-13-3)

Purchaser/Measurer
First Sales Date

INITIAL TEST DATA

INITIAL TEST DATE	02/20/2010	10/05/2021			
OIL-BBL/DAY	5	24			
OIL-GRAVITY (API)	35	36			
GAS-MCF/DAY	150	20.5			
GAS-OIL RATIO CU FT/BBL	30000	854			
WATER-BBL/DAY	8.35	6			
PUMPING OR FLOWING	Flowing	Pumping			
INITIAL SHUT-IN PRESSURE	230#	475 PSI			
CHOKE SIZE	10/64"	N/A			
FLOW TUBING PRESSURE	50#	30 PSI			

A record of the formations drilled through, and pertinent remarks are presented on the reverse. I declare that I have knowledge of the contents of this report and am authorized by my organization to make this report, which was prepared by me or under my supervision and direction, with the data and facts stated herein to be true, correct, and complete to the best of my knowledge and belief.

Collette Davis
1 E. Sheridan Ave
ADDRESS
CITY STATE ZIP
11-16-2021 405.209.2407
DATE PHONE NUMBER
cdavis@sandrledgeenergy.com
EMAIL ADDRESS

PLEASE TYPE OR USE BLACK INK ONLY
FORMATION RECORD

Give formation names and tops, if available, or descriptions and thickness of formations drilled through. Show intervals cored or drillstem tested.

NAMES OF FORMATIONS	TOP
see original 1002A	

LEASE NAME _____ WELL NO. _____

FOR COMMISSION USE ONLY	
ITD on file <input type="checkbox"/> YES <input type="checkbox"/> NO	
APPROVED _____ DISAPPROVED _____	2) Reject Codes

Were open hole logs run?	<input checked="" type="radio"/> yes <input type="radio"/> no
Date Last log was run	12/10/2009
Was CO ₂ encountered?	<input type="radio"/> yes <input checked="" type="radio"/> no at what depths? _____
Was H ₂ S encountered?	<input type="radio"/> yes <input checked="" type="radio"/> no at what depths? _____
Were unusual drilling circumstances encountered?	<input type="radio"/> yes <input checked="" type="radio"/> no
If yes, briefly explain below	

Other remarks: CIBP set @ 4,987' KB; 4 1/2" 10Kpsi CIBP; capped plugged with 5' of cement.

640 Acres

If more than three drainholes are proposed, attach a separate sheet indicating the necessary information.

Direction must be stated in degrees azimuth.
Please note, the horizontal drainhole and its end point must be located within the boundaries of the lease or spacing unit.

Directional surveys are required for all drainholes and directional wells

640 Acres

BOTTOM HOLE LOCATION FOR DIRECTIONAL HOLE

SEC	TWP	RGE	COUNTY
1/4	1/4	1/4	1/4
Measured Total Depth		True Vertical Depth	Feet From 1/4 Sec Lines
			BHL From Lease, Unit, or Property Line:

BOTTOM HOLE LOCATION FOR HORIZONTAL HOLE: (LATERALS)

LATERAL #1			
SEC	TWP	RGE	COUNTY
1/4	1/4	1/4	1/4
Depth of Deviation		Radius of Turn	Direction
Measured Total Depth		True Vertical Depth	Total Length
			BHL From Lease, Unit, or Property Line:

LATERAL #2			
SEC	TWP	RGE	COUNTY
1/4	1/4	1/4	1/4
Depth of Deviation		Radius of Turn	Direction
Measured Total Depth		True Vertical Depth	Total Length
			BHL From Lease, Unit, or Property Line:

LATERAL #3			
SEC	TWP	RGE	COUNTY
1/4	1/4	1/4	1/4
Depth of Deviation		Radius of Turn	Direction
Measured Total Depth		True Vertical Depth	Total Length
			BHL From Lease, Unit, or Property Line: