

Oklahoma Corporation Commission  
Oil & Gas Conservation Division  
Post Office Box 52000  
Oklahoma City, Oklahoma 73152-2000  
Rule 165: 10-3-25

Form 1002A

API No.: 35071243300002

**Completion Report**

Spud Date: October 27, 2009

OTC Prod. Unit No.: 071-125496

Drilling Finished Date: October 30, 2009

**Amended**

1st Prod Date: December 29, 2009

Amend Reason: FRACTURE TREATED EXISTING ZONES

Completion Date: November 18, 2009

Recomplete Date: October 13, 2021

**Drill Type: STRAIGHT HOLE**

Well Name: REDBUD 2-33

Purchaser/Measurer:

Location: KAY 33 29N 1W  
C N2 N2 SW  
2310 FSL 1320 FWL of 1/4 SEC  
Derrick Elevation: 1104 Ground Elevation: 1091

First Sales Date:

Operator: BARBER OIL LLC 24363

8801 S YALE AVE STE 150  
TULSA, OK 74137-3575

Completion Type	
X	Single Zone
	Multiple Zone
	Commingled

Location Exception	
Order No	
There are no Location Exception records to display.	

Increased Density	
Order No	
There are no Increased Density records to display.	

Casing and Cement							
Type	Size	Weight	Grade	Feet	PSI	SAX	Top of CMT
SURFACE	8 5/8	24		252		160	SURFACE
PRODUCTION	5 1/2	15.5		3278		175	2278

Liner								
Type	Size	Weight	Grade	Length	PSI	SAX	Top Depth	Bottom Depth
There are no Liner records to display.								

**Total Depth: 3280**

Packer	
Depth	Brand & Type
There are no Packer records to display.	

Plug	
Depth	Plug Type
There are no Plug records to display.	

Initial Test Data
-------------------

Test Date	Formation	Oil BBL/Day	Oil-Gravity (API)	Gas MCF/Day	Gas-Oil Ratio Cu FT/BBL	Water BBL/Day	Pumpin or Flowing	Initial Shut-In Pressure	Choke Size	Flow Tubing Pressure
Dec 29, 2009	CLEVELAND	13.47	40			3	PUMPING	680	16/64	78
Jul 15, 2021	CLEVELAND	0.83	40			41	PUMPING			
Nov 10, 2021	CLEVELAND	0.41	40			2	PUMPING			

**Completion and Test Data by Producing Formation**

Formation Name: CLEVELAND

Code: 405CLVD

Class: OIL

**Spacing Orders**

Order No	Unit Size
553295	640

**Perforated Intervals**

From	To
3190	3206

**Acid Volumes**

1,000 GALLONS, 650 BARRELS
----------------------------

**Fracture Treatments**

There are no Fracture Treatments records to display.
--

Formation Name: CLEVELAND

Code: 405CLVD

Class: OIL

**Spacing Orders**

Order No	Unit Size
553295	640

**Perforated Intervals**

From	To
3190	3206

**Acid Volumes**

1,000 GALLONS
---------------

**Fracture Treatments**

NONE
------

Formation Name: CLEVELAND

Code: 405CLVD

Class: OIL

**Spacing Orders**

Order No	Unit Size
553295	640

**Perforated Intervals**

From	To
3190	3206

**Acid Volumes**

There are no Acid Volume records to display.
--

**Fracture Treatments**

70,250 POUNDS SAND, 831 BARRELS
---------------------------------

Formation	Top
TONKAWA	2450
LAYTON	2905
CLEVELAND	3190
BIG LIME / OSWEGO	3274

Were open hole logs run? Yes

Date last log run:

Were unusual drilling circumstances encountered? No

Explanation:

**Other Remarks**

There are no Other Remarks.

Status: Accepted

API NO. 071-24330  
OTC PROD. UNIT NO. 071-125496

Oil and Gas Conservation Division  
P.O. Box 52000  
Oklahoma City, OK 73152-2000  
405-522-0577  
OCCCentralProcessing@OCC.OK.GOV



OKLAHOMA  
Corporation  
Commission

Form 1002A  
Rev. 2020

ORIGINAL AMENDED (Reason) *Fracture Treated*  
*add new existing zone*

Rule 165:10-3-25

COMPLETION REPORT

TYPE OF DRILLING OPERATION  
☒ STRAIGHT HOLE ☐ DIRECTIONAL HOLE ☐ HORIZONTAL HOLE  
☐ SERVICE WELL

SPUD DATE 10/27/2009  
DRLG FINISHED DATE 10/30/2009  
DATE OF WELL COMPLETION 11/18/2009  
1st PROD DATE 12/29/2009  
RECOMP DATE 10/13/2021

COUNTY Key SEC 33 TWP 29N RGE 1W

LEASE NAME Red Bud WELL NO. 2-33

C 1/4 N/2 1/4 N/2 1/4 SW 1/4 FSL 2310' FWL 1320'

ELEVATION Derrick FL 1104 Ground 1091 Latitude Longitude

OPERATOR NAME Barber Oil, LC OTC/OCC OPERATOR NO. 24363

ADDRESS 8801 South Yale Avenue, Suite 150

CITY Tulsa STATE OK ZIP 74137

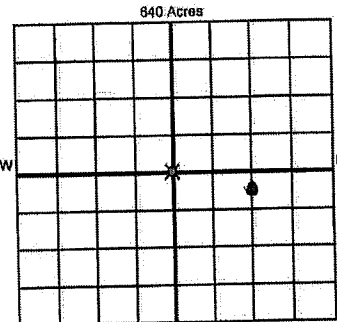

COMPLETION TYPE

☒ SINGLE ZONE  
☐ MULTIPLE ZONE  
☐ COMMINGLED  
LOCATION EXCEPTION ORDER NO.  
MULTIUNIT ORDER NO.  
INCREASED DENSITY ORDER NO.

CASING & CEMENT (Attach Form 1002C)

TYPE	SIZE	WEIGHT	GRADE	FEET	PSI	SAX	TOP OF CMT
CONDUCTOR							
SURFACE	8 5/8	24#		252		160	Surface
INTERMEDIATE							
PRODUCTION	5 1/2	15.5#		3278		175	2278
LINER							

PACKER @ BRAND & TYPE PLUG @ TYPE PLUG @ TYPE PLUG @ TYPE  
PACKER @ BRAND & TYPE PLUG @ TYPE PLUG @ TYPE

TOTAL DEPTH 3280

COMPLETION & TEST DATA BY PRODUCING FORMATION

FORMATION	Cleveland	Cleveland	Cleveland
SPACING & SPACING ORDER NUMBER	553295 - 640 ac	553295 - 640 ac	553295 - 640 ac
CLASS: Oil, Gas, Dry, Inj, Disp, Comm Disp, Svc	Oil	Oil	Oil
PERFORATED INTERVALS	3190'-3206'	3190'-3206'	3190'-3206'
ACID/VOLUME	1000 gals	1000 gals	70,250# sand 831 bbls
FRACTURE TREATMENT (Fluids/Prop Amounts)	yes 650 bbls	no	

RECEIVED

NOV 15 2021

OKLAHOMA CORPORATION COMMISSION

Min Gas Allowable (165:10-17-7)  
OR  
Oil Allowable (165:10-13-3)

Purchaser/Measurer  
First Sales Date

INITIAL TEST DATA

INITIAL TEST DATE	12/29/2009	7/15/2021	11/10/2021
OIL-BBL/DAY	13.47	.83	.41
OIL-GRAVITY (API)	40	40	40
GAS-MCF/DAY	0	0	0
GAS-OIL RATIO CU FT/BBL	0	0	0
WATER-BBL/DAY	3.37	41	2.5
PUMPING OR FLOWING	pump	pump	pump
INITIAL SHUT-IN PRESSURE	680		
CHOKE SIZE	16/64		
FLOW TUBING PRESSURE	78		

A record of the formations drilled through, and pertinent remarks are presented on the reverse. I declare that I have knowledge of the contents of this report and am authorized by my organization to make this report, which was prepared by me or under my supervision and direction, with the data and facts stated herein to be true, correct, and complete to the best of my knowledge and belief.

*Barbara Courtney*

Barbara Courtney  
NAME (PRINT OR TYPE)

11/11/2021 918-638-5951  
DATE PHONE NUMBER

8801 South Yale Ave, Suite 150

Tulsa

OK 74137

bcourtney@barberoilco.com

ADDRESS

CITY

STATE

ZIP

EMAIL ADDRESS

PLEASE TYPE OR USE BLACK INK ONLY  
FORMATION RECORD

Give formation names and tops, if available, or descriptions and thickness of formations drilled through. Show intervals cored or drillstem tested.

NAMES OF FORMATIONS	TOP
Tonkawa	2450
Layton	2905
Cleveland	3190
Big Lime/Oswego	3274

LEASE NAME \_\_\_\_\_ WELL NO. \_\_\_\_\_

FOR COMMISSION USE ONLY	
ITD on file	<input type="checkbox"/> YES <input type="checkbox"/> NO
APPROVED	DISAPPROVED
2) Reject Codes	

Were open hole logs run?	<input checked="" type="radio"/> yes <input type="radio"/> no
Date Last log was run	
Was CO <sub>2</sub> encountered?	<input type="radio"/> yes <input checked="" type="radio"/> no at what depths? <input type="text"/>
Was H <sub>2</sub> S encountered?	<input type="radio"/> yes <input checked="" type="radio"/> no at what depths? <input type="text"/>
Were unusual drilling circumstances encountered?	<input type="radio"/> yes <input checked="" type="radio"/> no
If yes, briefly explain below	

Other remarks:

640 Acres

If more than three drainholes are proposed, attach a separate sheet indicating the necessary information.

Direction must be stated in degrees azimuth. Please note, the horizontal drainhole and its end point must be located within the boundaries of the lease or spacing unit.

Directional surveys are required for all drainholes and directional wells

640 Acres

BOTTOM HOLE LOCATION FOR DIRECTIONAL HOLE

SEC	TWP	RGE	COUNTY
1/4	1/4	1/4	1/4
Measured Total Depth	True Vertical Depth	Feet From 1/4 Sec Lines	
BHL From Lease, Unit, or Property Line:			

BOTTOM HOLE LOCATION FOR HORIZONTAL HOLE: (LATERALS)

LATERAL #1			
SEC	TWP	RGE	COUNTY
1/4	1/4	1/4	1/4
Depth of Deviation	Radius of Turn	Direction	Total Length
Measured Total Depth	True Vertical Depth	BHL From Lease, Unit, or Property Line:	

LATERAL #2			
SEC	TWP	RGE	COUNTY
1/4	1/4	1/4	1/4
Depth of Deviation	Radius of Turn	Direction	Total Length
Measured Total Depth	True Vertical Depth	BHL From Lease, Unit, or Property Line:	

LATERAL #3			
SEC	TWP	RGE	COUNTY
1/4	1/4	1/4	1/4
Depth of Deviation	Radius of Turn	Direction	Total Length
Measured Total Depth	True Vertical Depth	BHL From Lease, Unit, or Property Line:	