

Oklahoma Corporation Commission
Oil & Gas Conservation Division
Post Office Box 52000
Oklahoma City, Oklahoma 73152-2000
Rule 165: 10-3-25

Form 1002A

API No.: 35087221570002

Completion Report

Spud Date: September 05, 2018

OTC Prod. Unit No.:

Drilling Finished Date: September 17, 2018

1st Prod Date:

Completion Date: October 12, 2018

Drill Type: STRAIGHT HOLE

SERVICE WELL

Well Name: COBALT COLE SWD 1

Purchaser/Measurer:

Location: MCCLAIN 19 7N 3W
NE NE NW NW
2507 FSL 1099 FWL of 1/4 SEC
Derrick Elevation: 0 Ground Elevation: 1142

First Sales Date:

Operator: COBALT ENVIRONMENTAL SOLUTIONS LLC 23434
PO BOX 1266
18825 HIGHWAY 32 W
ARDMORE, OK 73402-1266

Completion Type		Location Exception		Increased Density	
	Single Zone	Order No		Order No	
X	Multiple Zone	There are no Location Exception records to display.		There are no Increased Density records to display.	
	Commingled				

Casing and Cement							
Type	Size	Weight	Grade	Feet	PSI	SAX	Top of CMT
SURFACE	9 5/8			322		180	SURFACE
PRODUCTION	7			6605		540	5000

Liner								
Type	Size	Weight	Grade	Length	PSI	SAX	Top Depth	Bottom Depth
There are no Liner records to display.								

Total Depth: 6620

Packer		Plug	
Depth	Brand & Type	Depth	Plug Type
3284	AS-1X	There are no Plug records to display.	

Initial Test Data

Test Date	Formation	Oil BBL/Day	Oil-Gravity (API)	Gas MCF/Day	Gas-Oil Ratio Cu FT/BBL	Water BBL/Day	Pumpin or Flowing	Initial Shut- In Pressure	Choke Size	Flow Tubing Pressure
There are no Initial Data records to display.										
Completion and Test Data by Producing Formation										
Formation Name: PERMIAN			Code: 459PRMN			Class: COMM DISP				
Spacing Orders			Perforated Intervals							
Order No	Unit Size		From				To			
There are no Spacing Order records to display.			3328				3354			
			3358				3378			
			3426				3432			
			3518				3538			
			3654				3662			
			3676				3702			
			3740				3760			
			3884				3902			
Acid Volumes			Fracture Treatments							
4,000 GALLONS ALL PERFORATIONS ALL ZONES.			NONE							

Formation Name: VIRGILIAN

Code: 406VRGN

Class: COMM DISP

Spacing Orders**Order No****Unit Size**

There are no Spacing Order records to display.

Perforated Intervals**From****To**

3994

4006

4078

4098

4124

4137

4188

4198

4302

4328

4446

4458

5102

5110

5116

5122

5267

5279

5702

5716

5744

5800

6170

6202

6206

6218

6278

6306

6342

6354

6360

6384

6494

6522

6528

6536

Acid Volumes

ACIDIZED WITH PERMIAN

Fracture Treatments

NONE

Formation	Top
COUNCIL GROVE	3210
VIRGILIAN (TOP)	3836
HOOVER	4300
ELGIN	5100
ENDICOTT	5700

Were open hole logs run? Yes

Date last log run: September 15, 2018

Were unusual drilling circumstances encountered? No

Explanation:

Other Remarks

OCC - UIC PERMIT NUMBER 1812550088

FOR COMMISSION USE ONLY

1142625

Status: Accepted

API NO. 087-22157
OTC PROD.
UNIT NO.

(PLEASE TYPE OR USE BLACK INK ONLY)

OKLAHOMA CORPORATION COMMISSION

Oil & Gas Conservation Division

Post Office Box 52000

Oklahoma City, Oklahoma 73152-2000

Rule 165:10-3-25

RECEIVED

APR 16 2019

OKLAHOMA CORPORATION COMMISSION

☒ ORIGINAL
☐ AMENDED (Reason)

COMPLETION REPORT

TYPE OF DRILLING OPERATION

☒ STRAIGHT HOLE ☐ DIRECTIONAL HOLE ☐ HORIZONTAL HOLE
☒ SERVICE WELL

If directional or horizontal, see reverse for bottom hole location.

SPUD DATE 9-5-2018

DRLG FINISHED DATE 9-17-2018

DATE OF WELL COMPLETION 10-12-2018

COUNTY McClain SEC 19 TWP 7N RGE 3W

LEASE NAME Cobalt Cole SWD WELL NO. 1

1st PROD DATE

NE 1/4 NE 1/4 NW 1/4 NW 1/4 FSL OF 1/4 SEC 2507 FWL OF 1/4 SEC 1099

RECOMP DATE

ELEVATION Ground 1142 Latitude (if known)

Longitude (if known)

OPERATOR NAME Cobalt Environmental Solutions, LLC

OTC / OCC OPERATOR NO. 23434

ADDRESS P O Box 1266

CITY Ardmore

STATE TX

ZIP 73402-1266

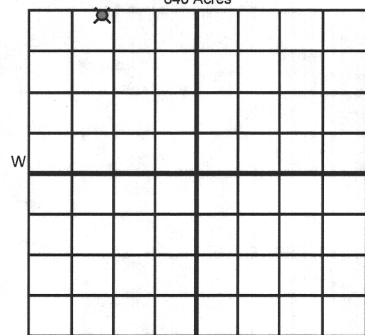

LOCATE WELL

COMPLETION TYPE

☐ SINGLE ZONE
☒ MULTIPLE ZONE
☐ COMMINGLED
☐ LOCATION EXCEPTION
☐ ORDER NO.
☐ INCREASED DENSITY
☐ ORDER NO.

CASING & CEMENT (Attach Form 1002C)

TYPE	SIZE	WEIGHT	GRADE	FEET	PSI	SAX	TOP OF CMT
CONDUCTOR							
SURFACE	9 5/8			322		180	Surface
INTERMEDIATE							
PRODUCTION	7			6,605		540	5000
LINER							

PACKER @ 3,284 BRAND & TYPE AS-1X

PLUG @

TYPE

PLUG @

TYPE

TOTAL DEPTH 6,620

PACKER @ BRAND & TYPE

PLUG @

TYPE

PLUG @

TYPE

COMPLETION & TEST DATA BY PRODUCING FORMATION

459 PRMN 406 VR6N

FORMATION	Permian	Virgilian	Virgilian	Virgilian		
SPACING & SPACING ORDER NUMBER	1812550088	1812550088	1812550088	1812550088	See remarks	
CLASS: Oil, Gas, Dry, Inj, Disp, Comm Disp, Svc	Comm Disp	Comm Disp	Comm Disp	Comm Disp		
PERFORATED INTERVALS	3328-3354, 3358-3378, 3426-3432, 3518-3538, 3654-3662, 3676-3702, 3740-3760, 3884-3902	3994-4006, 4078-4098, 4124-4137, 4188-4198, 4302-4328, 4446-4458, 5102-5110, 5116-5122, 5267-5279	5702-5716, 5744-5800, 6170-6202, 6206-6218, 6278-6306, 6342-6354	6360-6384, 6494-6522, 6528-6536		
ACID/VOLUME	4,000 gals All perfs & All zones					
FRACTURE TREATMENT (Fluids/Prop Amounts)	None		None			

Min Gas Allowable (165:10-17-7)

Gas Purchaser/Measurer



OR

First Sales Date

Oil Allowable (165:10-13-3)

INITIAL TEST DATA

INITIAL TEST DATE					
OIL-BBL/DAY					
OIL-GRAVITY (API)					
GAS-MCF/DAY					
GAS-OIL RATIO CU FT/BBL					
WATER-BBL/DAY					
PUMPING OR FLOWING					
INITIAL SHUT-IN PRESSURE					
CHOKE SIZE					
FLOW TUBING PRESSURE					

AS SUBMITTED

A record of the formations drilled through, and pertinent remarks are presented on the reverse. I declare that I have knowledge of the contents of this report and am authorized by my organization to make this report, which was prepared by me or under my supervision and direction, with the data and facts stated herein to be true, correct, and complete to the best of my knowledge and belief.

SIGNATURE Michael W Schmidt, Agent 3/30/2019 405-919-0555
11609 Randwick Dr Oklahoma City OK 73162 regulatoryolutions@cox.net
ADDRESS CITY STATE ZIP EMAIL ADDRESS

PLEASE TYPE OR USE BLACK INK ONLY
FORMATION RECORD

Give formation names and tops, if available, or descriptions and thickness of formations drilled through. Show intervals cored or drillstem tested.

LEASE NAME Cobalt Cole SWD

WELL NO. 1

NAMES OF FORMATIONS	TOP
Council Grove	3,210
Virgilian (Top)	3,836
Hoover	4,300
Elgin	5,100
Endicott	5,700

FOR COMMISSION USE ONLY

ITD on file ☐ YES ☐ NO

APPROVED _____ DISAPPROVED _____

2) Reject Codes _____

Were open hole logs run? ☒ yes ☐ no

Date Last log was run 9/15/2018

Was CO₂ encountered? ☐ yes ☒ no at what depths? _____

Was H₂S encountered? ☐ yes ☒ no at what depths? _____

Were unusual drilling circumstances encountered? ☐ yes ☒ no
If yes, briefly explain below _____

Other remarks:

OCC-ULC permit 1812550088

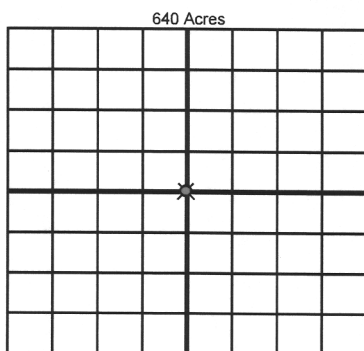

If more than three drainholes are proposed, attach a separate sheet indicating the necessary information.

Direction must be stated in degrees azimuth.
Please note, the horizontal drainhole and its end point must be located within the boundaries of the lease or spacing unit.

Directional surveys are required for all drainholes and directional wells.

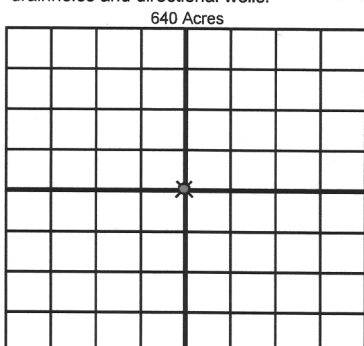

BOTTOM HOLE LOCATION FOR DIRECTIONAL HOLE

SEC	TWP	RGE	COUNTY
Spot Location			
1/4	1/4	1/4	1/4
Measured Total Depth		True Vertical Depth	BHL From Lease, Unit, or Property Line:

BOTTOM HOLE LOCATION FOR HORIZONTAL HOLE: (LATERALS)

LATERAL #1

SEC	TWP	RGE	COUNTY
Spot Location			
1/4	1/4	1/4	1/4
Depth of Deviation		Radius of Turn	Direction
Measured Total Depth		True Vertical Depth	BHL From Lease, Unit, or Property Line:

LATERAL #2

SEC	TWP	RGE	COUNTY
Spot Location			
1/4	1/4	1/4	1/4
Depth of Deviation		Radius of Turn	Direction
Measured Total Depth		True Vertical Depth	BHL From Lease, Unit, or Property Line:

LATERAL #3

SEC	TWP	RGE	COUNTY
Spot Location			
1/4	1/4	1/4	1/4
Depth of Deviation		Radius of Turn	Direction
Measured Total Depth		True Vertical Depth	BHL From Lease, Unit, or Property Line:

API NO. 087-22157
OTC PROD.
UNIT NO.

(PLEASE TYPE OR USE BLACK INK ONLY)

OKLAHOMA CORPORATION COMMISSION

Oil & Gas Conservation Division

Post Office Box 52000

Oklahoma City, Oklahoma 73152-2000

Rule 165:10-3-25

RECEIVED

JUN 07 2019

Oklahoma Corporation
Commission

Form 1002A

Rev. 2009

☐ ORIGINAL
☒ AMENDED (Reason)

To show amount of acid used

COMPLETION REPORT

TYPE OF DRILLING OPERATION

☒ STRAIGHT HOLE ☐ DIRECTIONAL HOLE ☐ HORIZONTAL HOLE
☐ SERVICE WELL

If directional or horizontal, see reverse for bottom hole location.

COUNTY	McClain	SEC	19	TWP	7N	RGE	3W	SPUD DATE	9-5-2018
LEASE NAME	Cobalt Cole SWD				WELL NO.	1	DRLG FINISHED DATE	9-17-2018	
NE 1/4 NE 1/4 NW 1/4 NW 1/4	FSL OF 1/4 SEC		2507	FWL OF 1/4 SEC		1099	DATE OF WELL COMPLETION	10-12-2018	
ELEVATION Derrick FL	Ground	1142	Latitude (if known)		Longitude (if known)			1st PROD DATE	
OPERATOR NAME	Cobalt Environmental Solutions, LLC				OTC / OCC OPERATOR NO.		23434	RECOMP DATE	
ADDRESS	P O Box 1266								
CITY	Ardmore		STATE	TX		ZIP	73402-1266		

640 Acres

W E

LOCATE WELL

COMPLETION TYPE

<input type="checkbox"/>	SINGLE ZONE	
<input checked="" type="checkbox"/>	MULTIPLE ZONE	
	Application Date	
	COMMINGLED	
	Application Date	
	LOCATION EXCEPTION	
	ORDER NO.	
	INCREASED DENSITY	
	ORDER NO.	

CASING & CEMENT (Attach Form 1002C)

TYPE	SIZE	WEIGHT	GRADE	FEET	PSI	SAX	TOP OF CMT
CONDUCTOR							
SURFACE	9 5/8			322		180	Surface
INTERMEDIATE							
PRODUCTION	7			6,605		540	2,760
LINER							
					TOTAL DEPTH		6,620

PACKER @ 3,284 BRAND & TYPE AS-1X PLUG @ TYPE PLUG @ TYPE
PACKER @ BRAND & TYPE PLUG @ TYPE PLUG @ TYPE

COMPLETION & TEST DATA BY PRODUCING FORMATION

FORMATION	Permian	Virgilian	Virgilian	Virgilian		
SPACING & SPACING ORDER NUMBER	1812550088	1812550088	1812550088	1812550088		
CLASS: Oil, Gas, Dry, Inj, Disp, Comm Disp, Svc	Comm Disp	Comm Disp	Comm Disp	Comm Disp		
PERFORATED INTERVALS	3328-3354, 3358-3378, 3426-3432, 3654-3662, 3676-3702, 3740-3760, 3884	3994-4006, 4078-4098, 4124-4137, 4188-4198, 4302-4328, 4446-4458, 5102-5110, 5116-5122, 5267-5279	5702-5716, 5744-5800, 6170-6202, 6206-6218, 6278-6306, 6342-6354	6360-6384, 6494-9522, 6528-6536		
ACID/VOLUME	4,000 gals total all perforations					
FRACTURE TREATMENT (Fluids/Prop Amounts)						

Min Gas Allowable (165:10-17-7)

Gas Purchaser/Measurer

First Sales Date

INITIAL TEST DATA

INITIAL TEST DATE						
OIL-BBL/DAY						
OIL-GRAVITY (API)						
GAS-MCF/DAY						
GAS-OIL RATIO CU FT/BBL						
WATER-BBL/DAY						
PUMPING OR FLOWING						
INITIAL SHUT-IN PRESSURE						
CHOKE SIZE						
FLOW TUBING PRESSURE						

AS SUBMITTED

A record of the formations drilled through, and pertinent remarks are presented on the reverse. I declare that I have knowledge of the contents of this report and am authorized by my organization to make this report, which was prepared by me or under my supervision and direction, with the data and facts stated herein to be true, correct, and complete to the best of my knowledge and belief.

SIGNATURE	Michael W Schmidt, Agent	6/7/2019	405-919-0555
11609 Randwick Dr	Oklahoma City OK 73162	DATE	PHONE NUMBER
ADDRESS	CITY STATE ZIP	EMAIL ADDRESS	

PLEASE TYPE OR USE BLACK INK ONLY

FORMATION RECORD

Give formation names and tops, if available, or descriptions and thickness of formations drilled through. Show intervals cored or drillstem tested.

NAMES OF FORMATIONS	TOP
Council Grove	3,210
Virgilian (Top)	3,836
Hoover	4,300
Elgin	5,100
Endicott	5,700

LEASE NAME Cobalt Cole SWD WELL NO. 1

FOR COMMISSION USE ONLY	
ITD on file <input type="checkbox"/> YES <input type="checkbox"/> NO	
APPROVED _____	DISAPPROVED _____
2) Reject Codes	

Were open hole logs run? ☒ yes ☐ no

Date Last log was run 9/15/2018

Was CO₂ encountered? ☐ yes ☒ no at what depths? _____

Was H₂S encountered? ☐ yes ☒ no at what depths? _____

Were unusual drilling circumstances encountered? ☐ yes ☒ no
If yes, briefly explain below _____

Other remarks:

640 Acres

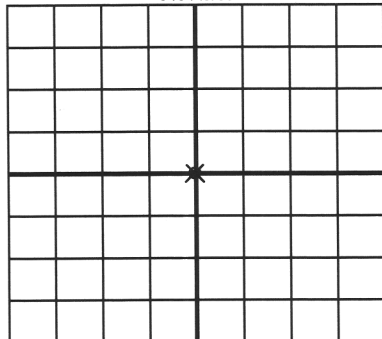

If more than three drainholes are proposed, attach a separate sheet indicating the necessary information.

Direction must be stated in degrees azimuth.
Please note, the horizontal drainhole and its end point must be located within the boundaries of the lease or spacing unit.

Directional surveys are required for all drainholes and directional wells.

640 Acres

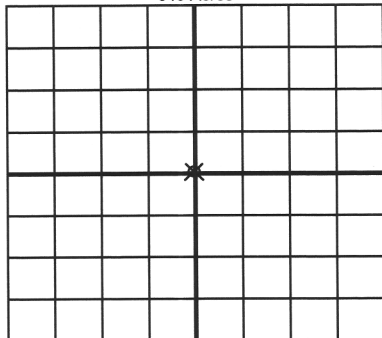

BOTTOM HOLE LOCATION FOR DIRECTIONAL HOLE

SEC	TWP	RGE	COUNTY
Spot Location			
1/4	1/4	1/4	1/4
Measured Total Depth		True Vertical Depth	BHL From Lease, Unit, or Property Line:

BOTTOM HOLE LOCATION FOR HORIZONTAL HOLE: (LATERALS)

LATERAL #1			
SEC	TWP	RGE	COUNTY
Spot Location			
1/4	1/4	1/4	1/4
Depth of Deviation		Radius of Turn	Direction
Measured Total Depth		True Vertical Depth	BHL From Lease, Unit, or Property Line:

LATERAL #2			
SEC	TWP	RGE	COUNTY
Spot Location			
1/4	1/4	1/4	1/4
Depth of Deviation		Radius of Turn	Direction
Measured Total Depth		True Vertical Depth	BHL From Lease, Unit, or Property Line:

LATERAL #3			
SEC	TWP	RGE	COUNTY
Spot Location			
1/4	1/4	1/4	1/4
Depth of Deviation		Radius of Turn	Direction
Measured Total Depth		True Vertical Depth	BHL From Lease, Unit, or Property Line: