

Oklahoma Corporation Commission
Oil & Gas Conservation Division
Post Office Box 52000
Oklahoma City, Oklahoma 73152-2000
Rule 165: 10-3-25

Form 1002A

API No.: 35019263000000

Completion Report

Spud Date: September 30, 2018

OTC Prod. Unit No.:

Drilling Finished Date: October 08, 2018

1st Prod Date: March 22, 2019

Completion Date: March 22, 2019

Drill Type: STRAIGHT HOLE

Well Name: HEWITT UNIT 22-6003

Purchaser/Measurer:

Location: CARTER 22 4S 2W
SW SE SE SW
200 FSL 498 FEL of 1/4 SEC
Latitude: 34.187781 Longitude: -97.397247
Derrick Elevation: 919 Ground Elevation: 904

First Sales Date:

Operator: XTO ENERGY INC 21003

22777 SPRINGWOODS VILLAGE PKWY
SPRING, TX 77389-1425

Completion Type	
X	Single Zone
	Multiple Zone
	Commingled

Location Exception	
Order No	
There are no Location Exception records to display.	

Increased Density	
Order No	
There are no Increased Density records to display.	

Casing and Cement							
Type	Size	Weight	Grade	Feet	PSI	SAX	Top of CMT
CONDUCTOR	16	109	K-55	75			
SURFACE	8 5/8	24	J-55	623		250	SURFACE
PRODUCTION	5 1/2	15.5	K-55	4030		625	SURFACE

Liner								
Type	Size	Weight	Grade	Length	PSI	SAX	Top Depth	Bottom Depth
There are no Liner records to display.								

Total Depth: 4030

Packer	
Depth	Brand & Type
There are no Packer records to display.	

Plug	
Depth	Plug Type
There are no Plug records to display.	

Initial Test Data

Test Date	Formation	Oil BBL/Day	Oil-Gravity (API)	Gas MCF/Day	Gas-Oil Ratio Cu FT/BBL	Water BBL/Day	Pumpin or Flowing	Initial Shut-In Pressure	Choke Size	Flow Tubing Pressure
Mar 22, 2019	HEWITT	210	35	70	330	597	PUMPING		N/A	

Completion and Test Data by Producing Formation

Formation Name: HEWITT

Code: 405HWTT

Class: OIL

Spacing Orders

Order No

Unit Size

67990

UNIT

Perforated Intervals

From

To

1634

3492

Acid Volumes

17,100 GALLONS 15%

Fracture Treatments

7 STAGES - 295,000 30 POUNDS GEL, 259,000 POUNDS 12/20, 37,000 POUNDS 16/30 RC, 21,000 POUNDS 16/30

Formation	Top
LOWER BAYOU	1634
STEARNS	1896
CHUBBEE	1943
1B	2041
1C	2139
2A	2178
2B	2252
3A	2542
3C	2709
UNC	2981
4B	3057
5TH	3294
TUSSY	3464

Were open hole logs run? Yes

Date last log run: October 07, 2018

Were unusual drilling circumstances encountered? No

Explanation:

Other Remarks

IRREGULAR SECTION

FOR COMMISSION USE ONLY

Status: Accepted

1142685

API NO. 019-26300
OTC PROD.
UNIT NO.

PLEASE TYPE OR USE BLACK INK ONLY
NOTE:

Attach copy of original 1002A
if recompletion or reentry.

OKLAHOMA CORPORATION COMMISSION
Oil & Gas Conservation Division
Post Office Box 52000
Oklahoma City, Oklahoma 73152-2000
Rule 165:10-3-25

RECEIVED

APR 18 2019

Oklahoma Corporation
Commission

Form 1002A
Rev. 2009

☒ ORIGINAL
☐ AMENDED (Reason)

COMPLETION REPORT

TYPE OF DRILLING OPERATION

☒ STRAIGHT HOLE ☐ DIRECTIONAL HOLE ☐ HORIZONTAL HOLE
SERVICE WELL

If directional or horizontal, see reverse for bottom hole location.

COUNTY	Carter	SEC	22	TWP	04S	RGE	02W	
LEASE NAME	Hewitt Unit						WELL NO.	22-6003
SW 1/4 SE 1/4 SE 1/4 SW 1/4	FSL 200						FEL OF 1/4 SEC	498
ELEVATION N Derrick	919'	Ground	904'	Latitude (if known)		34.187781		
OPERATOR NAME	XTO Energy Inc.						OTC/OCC OPERATOR NO.	21003
ADDRESS	210 Park Avenue, Suite 2350							
CITY	Oklahoma City	STATE	Oklahoma	ZIP	73102			

SPUD DATE 9/30/2018

DRLG FINISHED DATE 10/08/2018

DATE OF WELL COMPLETION 3/22/2019

1st PROD DATE 3/22/2019

RECOMP DATE

Longitude (if known) -97.397247

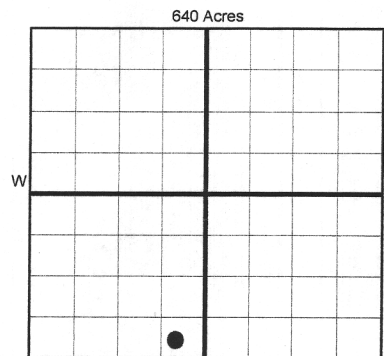

COMPLETION TYPE

<input checked="" type="checkbox"/> SINGLE ZONE
<input type="checkbox"/> MULTIPLE ZONE
Application Date
COMINGLED
Application Date
LOCATION
EXCEPTION ORDER
INCREASED DENSITY
ORDER NO.

CASING & CEMENT (Form 1002C must be attached)

TYPE	SIZE	WEIGHT	GRADE	FEET	PSI	SAX	TOP OF CMT
CONDUCTOR	16"	109	K-55	75			
SURFACE	8 5/8"	24	J-55	623		250	Surface
INTERMEDIATE							
PRODUCTION	5 1/2"	15.5	K-55	4030		625	Surface
LINER							

PACKER @ _____ BRAND & TYPE _____ PLUG @ _____ TYPE _____ PLUG @ _____ TYPE _____
PACKER @ _____ BRAND & TYPE _____ PLUG @ _____ TYPE _____ PLUG @ _____ TYPE _____

TOTAL DEPTH 4030'

COMPLETION & TEST DATA BY PRODUCING FORMATION

FORMATION	Hewitt Sands
SPACING & SPACING ORDER NUMBER	67990 (Unit)
CLASS: Oil, Gas, Dry, Inj, Disp, Comm Disp, Svc	Oil
PERFORATED INTERVALS	7 Stages
	1634-3492' OA
ACID/VOLUME	17,100 gals 15%
FRACTURE TREATMENT (Fluids/Prop Amounts)	295,000 30# gel
	259,000# 12/20
	37000#16/30 RC 21,000# 16/30

Reported to FracFaus

Min Gas Allowable (165:10-17-7)
☐ OR
Oil Allowable (165:10-13-3)

Gas Purchaser/Measurer
First Sales Date

INITIAL TEST DATA

INITIAL TEST DATE	3/22/2019
OIL-BBL/DAY	210
OIL-GRAVITY (API)	35
GAS-MCF/DAY	70
GAS-OIL RATIO CU FT/BBL	330
WATER-BBL/DAY	597
PUMPING OR FLOWING	Pumping
INITIAL SHUT-IN PRESSURE	N/A
CHOKE SIZE	N/A
FLOW TUBING PRESSURE	N/A

AS SUBMITTED

A record of the formations drilled through, and pertinent remarks are presented on the reverse. I declare that I have knowledge of the contents of this report and am authorized by my organization to make this report, which was prepared by me or under my supervision and direction, with the data and facts stated herein to be true, correct, and complete to the best of my knowledge and belief.

Debbie Waggoner

SIGNATURE

Debbie Waggoner

NAME (PRINT OR TYPE)

4/16/2019

DATE

405-319-3243

PHONE NUMBER

210 Park Avenue, Suite 2350

ADDRESS

Oklahoma City

CITY

Ok

STATE

73102

ZIP

debbie_waggoner@xtoenergy.com

EMAIL ADDRESS

Give formation names and tops, if available, or descriptions and thickness of formations drilled through. Show intervals cored or drillstem tested.

WELL NO. 22-6003

FOR COMMISSION USE ONLY	
ITD on file	<input type="checkbox"/> YES <input type="checkbox"/> NO
APPROVED	DISAPPROVED
<div>2) Reject Codes</div> <div> <div></div> <div></div> <div></div> <div></div> <div></div> </div>	

Were open hole logs run? X yes ___ no

Date Last log was run 10/7/2018

Was CO₂ encountered? ___ yes X no at what depths? _____

Was H₂S encountered? ___ yes X no at what depths? _____

Were unusual drilling circumstances encountered? ___ yes X no
If yes, briefly explain below

Other remarks: Irregular Section

A blank 10x10 grid for graphing, with a thick horizontal line across the middle and a thick vertical line down the middle, dividing the grid into four 5x5 quadrants.

If more than three drainholes are proposed, attach a separate sheet indicating the necessary information.

Direction must be stated in degrees azimuth.
Please note, the horizontal drainhole and its end point must be located within the boundaries of the lease or spacing unit.

Directional surveys are required for all drainholes and directional wells.

A blank 10x10 grid for graphing. The grid is composed of 10 columns and 10 rows of squares. A thick horizontal line and a thick vertical line intersect at the center, dividing the grid into four 5x5 quadrants. The top-left and bottom-right quadrants are shaded gray. The top-right and bottom-left quadrants are white. The grid lines are thin and gray, while the central dividing lines are thick and black.

SEC	TWP	RGE	COUNTY
Spot Location			
1/4	1/4	1/4	1/4
Measured Total Depth	True Vertical Depth	Feet From 1/4 Sec Lines	
		FSL	FWL
BHL From Lease, Unit, or Property Line:			

LATERAL #1						
SEC	TWP	RGE	COUNTY			
Spot Location						
	1/4	1/4	1/4	Feet From 1/4 Sec Lines	FNL	FEL
Depth of Deviation		Radius of Turn	Direction		Total Length	
Measured Total Depth		True Vertical Depth	BHL From Lease, Unit, or Property Line:			

SEC	TWP	RGE	COUNTY			
Spot Location				Feet From 1/4 Sec Lines	FSL	FWL
1/4	1/4	1/4	1/4			
Depth of Deviation		Radius of Turn	Direction	Total Length		
Measured Total Depth		True Vertical Depth	BHL From Lease, Unit, or Property Line:			

SEC	TWP	RGE	COUNTY
Spot Location			
1/4	1/4	1/4	1/4
Feet From 1/4 Sec Lines		FSL	FWL
Depth of Deviation		Radius of Turn	Direction
Measured Total Depth		True Vertical Depth	Total Length
BHL From Lease, Unit, or Property Line:			