

Oklahoma Corporation Commission  
Oil & Gas Conservation Division  
Post Office Box 52000  
Oklahoma City, Oklahoma 73152-2000  
Rule 165: 10-3-25

Form 1002A

API No.: 35133253410000

**Completion Report**

Spud Date: July 18, 2019

OTC Prod. Unit No.: 133-226256-0-0000

Drilling Finished Date: July 27, 2019

1st Prod Date: September 13, 2019

Completion Date: September 13, 2019

**Drill Type: STRAIGHT HOLE**

Well Name: BLASTER 1-28

Purchaser/Measurer:

Location: SEMINOLE 28 9N 7E  
C NW SE NW  
1650 FNL 1650 FWL of 1/4 SEC  
Derrick Elevation: 944 Ground Elevation: 939

First Sales Date:

Operator: PRESLEY OPERATING LLC 23803

101 PARK AVE STE 670  
OKLAHOMA CITY, OK 73102-7220

Completion Type		Location Exception		Increased Density	
X	Single Zone	Order No		Order No	
	Multiple Zone	There are no Location Exception records to display.		There are no Increased Density records to display.	
	Commingled				

Casing and Cement							
Type	Size	Weight	Grade	Feet	PSI	SAX	Top of CMT
SURFACE	8 5/8	24	J-55	880	2000	435	SURFACE
PRODUCTION	5 1/2	15.5	J-55	3625	2000	135	2755

Liner								
Type	Size	Weight	Grade	Length	PSI	SAX	Top Depth	Bottom Depth
There are no Liner records to display.								

**Total Depth: 3660**

Packer		Plug	
Depth	Brand & Type	Depth	Plug Type
There are no Packer records to display.		There are no Plug records to display.	

Initial Test Data										
Test Date	Formation	Oil BBL/Day	Oil-Gravity (API)	Gas MCF/Day	Gas-Oil Ratio Cu FT/BBL	Water BBL/Day	Pumpin or Flowing	Initial Shut-In Pressure	Choke Size	Flow Tubing Pressure
Sep 13, 2019	GILCREASE	5	42			90	PUMPING	200	NONE	

Completion and Test Data by Producing Formation			
Formation Name: GILCREASE		Code: 403GLCR	Class: OIL
<b>Spacing Orders</b>		<b>Perforated Intervals</b>	
<b>Order No</b>	<b>Unit Size</b>	<b>From</b>	<b>To</b>
576421	40	3432	3236
<b>Acid Volumes</b>		<b>Fracture Treatments</b>	
NONE		NONE	

Formation	Top
CALVIN	2023
SENORA	2476
EARLSBORO	2920
BOOCH	3360
GILCREASE	3432
CROMWELL	3514

Were open hole logs run? Yes  
Date last log run: July 26, 2019

Were unusual drilling circumstances encountered? No  
Explanation:

Other Remarks
There are no Other Remarks.

FOR COMMISSION USE ONLY	
Status: Accepted	1143860

API NO. 133-25341  
OTC PROD. UNIT NO. 133-226256-0-0000

(PLEASE TYPE OR USE BLACK INK ONLY)

OKLAHOMA CORPORATION COMMISSION  
Oil & Gas Conservation Division  
Post Office Box 52000  
Oklahoma City, Oklahoma 73152-2000  
Rule 165:10-3-25

RECEIVED

Form 1002A  
Rev. 2009

OCT 18 2019

OKLAHOMA CORPORATION  
COMMISSION

☒ ORIGINAL  
☐ AMENDED (Reason) \_\_\_\_\_

COMPLETION REPORT

TYPE OF DRILLING OPERATION  
☒ STRAIGHT HOLE ☐ DIRECTIONAL HOLE ☐ HORIZONTAL HOLE  
☐ SERVICE WELL

If directional or horizontal, see reverse for bottom hole location.

COUNTY SEMINOLE SEC 28 TWP 09N RGE 07E  
LEASE NAME Blaster FNL  
C 1/4 NW 1/4 SE 1/4 NW 1/4 1650  
ELEVATION 944 Ground 939  
OPERATOR NAME PRESLEY OPERATING LLC  
ADDRESS 101 PARK AVE, STE 670  
CITY OKLAHOMA CITY STATE OK ZIP 73102-7220

SPUD DATE 7/18/19  
DRLG FINISHED DATE 7/27/19  
DATE OF WELL COMPLETION 9/13/19  
1st PROD DATE 9/13/19  
RECOMP DATE  
Longitude (if known)  
OTC / OCC OPERATOR NO. 23803

640 Acres  
W E  
LOCATE WELL

COMPLETION TYPE

☒ SINGLE ZONE  
☐ MULTIPLE ZONE  
☐ COMMINGLED  
LOCATION EXCEPTION ORDER NO.  
INCREASED DENSITY ORDER NO.

CASING & CEMENT (Attach Form 1002C)

TYPE	SIZE	WEIGHT	GRADE	FEET	PSI	SAX	TOP OF CMT
CONDUCTOR							
SURFACE	8 5/8"	24#	J55	880	2,000	435	SURFACE
INTERMEDIATE							
PRODUCTION	5 1/2"	15.5#	J55	3625	2000	135	2755
LINER							

PACKER @ \_\_\_\_\_ BRAND & TYPE \_\_\_\_\_ PLUG @ \_\_\_\_\_ TYPE \_\_\_\_\_ PLUG @ \_\_\_\_\_ TYPE \_\_\_\_\_  
PACKER @ \_\_\_\_\_ BRAND & TYPE \_\_\_\_\_ PLUG @ \_\_\_\_\_ TYPE \_\_\_\_\_ PLUG @ \_\_\_\_\_ TYPE \_\_\_\_\_

TOTAL DEPTH 3,660

COMPLETION & TEST DATA BY PRODUCING FORMATION

FORMATION	GILCREASE						No Frac
SPACING & SPACING ORDER NUMBER	576421 - 40 ACRE						
CLASS: Oil, Gas, Dry, Inj, Disp, Comm Disp, Svc	OIL						
PERFORATED INTERVALS	3432' - 3236'						
ACID/VOLUME	NONE						
FRACTURE TREATMENT (Fluids/Prop Amounts)	NONE						

☐ Min Gas Allowable (165:10-17-7)  
OR  
☐ Oil Allowable (165:10-13-3)

Gas Purchaser/Measurer  
First Sales Date

INITIAL TEST DATA

INITIAL TEST DATE	9/13/2019					
OIL-BBL/DAY	5					
OIL-GRAVITY (API)	42					
GAS-MCF/DAY	TSTM					
GAS-OIL RATIO CU FT/BBL						
WATER-BBL/DAY	90					
PUMPING OR FLOWING	PUMPING					
INITIAL SHUT-IN PRESSURE	200 PSI					
CHOKE SIZE	NONE					
FLOW TUBING PRESSURE	N/A					

AS SUBMITTED

A record of the formations drilled through, and pertinent remarks are presented on the reverse. I declare that I have knowledge of the contents of this report and am authorized by my organization to make this report, which was prepared by me or under my supervision and direction, with the data and facts stated herein to be true, correct, and complete to the best of my knowledge and belief.

Travers Boughdady 10/15/2019 405-526-3000  
SIGNATURE NAME (PRINT OR TYPE) DATE PHONE NUMBER  
101 Park Ave, Ste 670 Oklahoma City OK 73102 BO@PRESLEYPETROLEUM.COM  
ADDRESS CITY STATE ZIP EMAIL ADDRESS

PLEASE TYPE OR USE BLACK INK ONLY  
FORMATION RECORD

Give formation names and tops, if available, or descriptions and thickness of formations drilled through. Show intervals cored or drillstem tested.

NAMES OF FORMATIONS	TOP
CALVIN	2,023
SENORA	2,476
EARLSBORO	2920
BOOCH	3,360
GILCREASE	3,432
CROMWELL	3,514

LEASE NAME BLASTER

WELL NO. 1-28

FOR COMMISSION USE ONLY	
ITD on file <input type="checkbox"/> YES <input type="checkbox"/> NO	
APPROVED _____	DISAPPROVED _____
2) Reject Codes	
_____	
_____	
_____	
_____	

Were open hole logs run?	<u>X</u> yes <u>  </u> no
Date Last log was run	<u>7/26/2019</u>
Was CO <sub>2</sub> encountered?	<u>  </u> yes <u>X</u> no at what depths? _____
Was H <sub>2</sub> S encountered?	<u>  </u> yes <u>X</u> no at what depths? _____
Were unusual drilling circumstances encountered?	<u>  </u> yes <u>X</u> no
If yes, briefly explain below	

Other remarks:

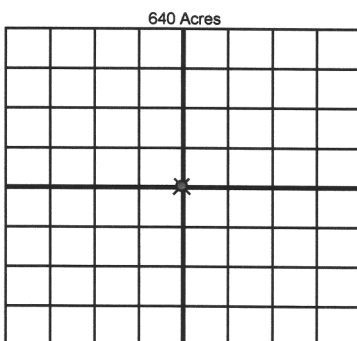

If more than three drainholes are proposed, attach a separate sheet indicating the necessary information.

Direction must be stated in degrees azimuth. Please note, the horizontal drainhole and its end point must be located within the boundaries of the lease or spacing unit.

Directional surveys are required for all drainholes and directional wells.

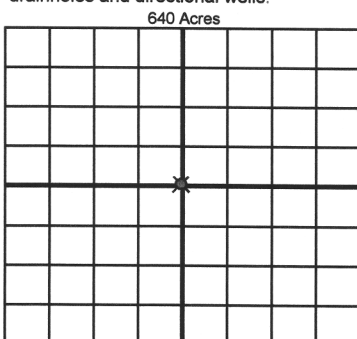

BOTTOM HOLE LOCATION FOR DIRECTIONAL HOLE

SEC	TWP	RGE	COUNTY
Spot Location			
1/4	1/4	1/4	1/4
Measured Total Depth		True Vertical Depth	Feet From 1/4 Sec Lines FSL _____ FWL _____
BHL From Lease, Unit, or Property Line: _____			

BOTTOM HOLE LOCATION FOR HORIZONTAL HOLE: (LATERALS)

LATERAL #1

SEC	TWP	RGE	COUNTY
Spot Location			
1/4	1/4	1/4	1/4
Depth of Deviation		Radius of Turn	Direction
Measured Total Depth		True Vertical Depth	Total Length
BHL From Lease, Unit, or Property Line: _____			

LATERAL #2

SEC	TWP	RGE	COUNTY
Spot Location			
1/4	1/4	1/4	1/4
Depth of Deviation		Radius of Turn	Direction
Measured Total Depth		True Vertical Depth	Total Length
BHL From Lease, Unit, or Property Line: _____			

LATERAL #3

SEC	TWP	RGE	COUNTY
Spot Location			
1/4	1/4	1/4	1/4
Depth of Deviation		Radius of Turn	Direction
Measured Total Depth		True Vertical Depth	Total Length
BHL From Lease, Unit, or Property Line: _____			