

Oklahoma Corporation Commission
Oil & Gas Conservation Division
Post Office Box 52000
Oklahoma City, Oklahoma 73152-2000
Rule 165: 10-3-25

Form 1002A

API No.: 35111275290000

Completion Report

Spud Date: July 25, 2019

OTC Prod. Unit No.:

Drilling Finished Date: July 26, 2019

1st Prod Date:

Completion Date: July 30, 2019

Drill Type: STRAIGHT HOLE

Well Name: DILLINGHAM RANCH 5-2

Purchaser/Measurer:

Location: OKMULGEE 2 14N 13E
W2 SE SW SW
330 FSL 825 FWL of 1/4 SEC
Latitude: 35.71242 Longitude: -95.90559
Derrick Elevation: 0 Ground Elevation: 759

First Sales Date:

Operator: MONARCH ENERGY COMPANY LLC 20789
PO BOX 70
346 CEDAR RIDGE RD
EUFAULA, OK 74432-0070

Completion Type		Location Exception		Increased Density	
	Single Zone		Order No		Order No
	Multiple Zone		N/A		N/A
	Commingled				

Casing and Cement							
Type	Size	Weight	Grade	Feet	PSI	SAX	Top of CMT
SURFACE	7	26	J-55	127	2000	30	SURFACE

Liner								
Type	Size	Weight	Grade	Length	PSI	SAX	Top Depth	Bottom Depth
There are no Liner records to display.								

Total Depth: 1223

Packer	
Depth	Brand & Type
There are no Packer records to display.	

Plug	
Depth	Plug Type
There are no Plug records to display.	

Initial Test Data										
Test Date	Formation	Oil BBL/Day	Oil-Gravity (API)	Gas MCF/Day	Gas-Oil Ratio Cu FT/BBL	Water BBL/Day	Pumpin or Flowing	Initial Shut-In Pressure	Choke Size	Flow Tubing Pressure
There are no Initial Data records to display.										

Completion and Test Data by Producing Formation

Formation Name: NONE	Code:	Class: PLUG AND ABANDON
----------------------	-------	-------------------------

Formation	Top
-----------	-----

Were open hole logs run? No

Date last log run:

Were unusual drilling circumstances encountered? No

Explanation:

Other Remarks
There are no Other Remarks.

FOR COMMISSION USE ONLY	
Status: Accepted	1143769

RECEIVED

Form 1002A
Rev. 2009

AUG 21 2019

OKLAHOMA CORPORATION
COMMISSION

API
NO. 111-27529
OTC PROD.
UNIT NO.

PLEASE TYPE OR USE BLACK INK ONLY
NOTE:

Attach copy of original 1002A
if recompletion or reentry.

OKLAHOMA CORPORATION COMMISSION
Oil & Gas Conservation Division
Post Office Box 52000
Oklahoma City, Oklahoma 73152-2000
Rule 165:10-3-25

COMPLETION REPORT

☒ ORIGINAL
☐ AMENDED (Reason) _____

TYPE OF DRILLING OPERATION

☒ STRAIGHT HOLE ☐ DIRECTIONAL HOLE ☐ HORIZONTAL HOLE
☐ SERVICE WELL

If directional or horizontal, see reverse for bottom hole location.

COUNTY	Okmulgee	SEC	02	TWP	14N	RGE	13E
LEASE NAME	Dillingham Ranch			WELL NO.	5-2		
W2 1/4	SE 1/4	SW 1/4	SW 1/4	FSL OF 1/4 SEC	330'	FWL OF 1/4 SEC	825'
ELEVATION	Ground 759'			Latitude (if known)	35.71242		
OPERATOR NAME	Monarch Energy Co., LLC			OTC/OCC OPERATOR NO.	20789-0		
ADDRESS	PO Box 70						
CITY	Eufaula			STATE	OK		ZIP
							74432

SPUD DATE 7-25-19
DRLG FINISHED DATE 7-26-19
DATE OF WELL COMPLETION Plugged 7-30-19
1st PROD DATE n/a
RECOMP DATE

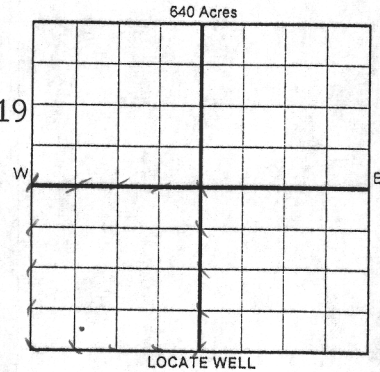

COMPLETION TYPE

SINGLE ZONE	
MULTIPLE ZONE	
Application Date	
COMMINGLED	
Application Date	
LOCATION	N/A
EXCEPTION ORDER	
INCREASED DENSITY	n/a
ORDER NO.	

CASING & CEMENT (Form 1002C must be attached)

TYPE	SIZE	WEIGHT	GRADE	FEET	PSI	SAX	TOP OF CMT
CONDUCTOR							
SURFACE	7"	26#	J55	127'	2000	30	Surface
INTERMEDIATE							
PRODUCTION							
LINER							

PACKER @ _____ BRAND & TYPE _____ PLUG @ _____ TYPE _____ PLUG @ _____ TYPE _____ TOTAL DEPTH 1223'

COMPLETION & TEST DATA BY PRODUCING FORMATION

FORMATION	Bartlesville
SPACING & SPACING ORDER NUMBER	Not Spaced
CLASS: Oil, Gas, Dry, Inj. Disp, Comm Disp, Svc	Dry Hole P&A
PERFORATED INTERVALS	
ACID/VOLUME	
FRACTURE TREATMENT (Fluids/Prop Amounts)	

☐ Min Gas Allowable (165:10-17-7) OR ☐ Oil Allowable (165:10-13-3) Gas Purchaser/Measurer _____ First Sales Date _____

INITIAL TEST DATA

INITIAL TEST DATE	
OIL-BBL/DAY	
OIL-GRAVITY (API)	
GAS-MCF/DAY	
GAS-OIL RATIO CU FT/BBL	
WATER-BBL/DAY	
PUMPING OR FLOWING	
INITIAL SHUT-IN PRESSURE	
CHOKE SIZE	
FLOW TUBING PRESSURE	

AS SUBMITTED

A record of the formations drilled through, and pertinent remarks are presented on the reverse. I declare that I have knowledge of the contents of this report and am authorized by my organization to make this report, which was prepared by me or under my supervision and direction, with the data and facts stated herein to be true, correct, and complete to the best of my knowledge and belief.

SIGNATURE David A. Roberson, II, Agent DATE 8-19-19 PHONE NUMBER 580-332-6170
NAME (PRINT OR TYPE)
ADDRESS PO Box 8, CITY Ada, STATE OK ZIP 74821 EMAIL ADDRESS ROIL11@yahoo.com

FORMATION RECORD

LEASE NAME Dillingham Ranch

WELL NO. 5-2

NAMES OF FORMATIONS	TOP

FOR COMMISSION USE ONLY	
ITD on file <input type="checkbox"/> YES <input type="checkbox"/> NO	
APPROVED DISAPPROVED	2) Reject Codes

Were open hole logs run? ☐ yes ☐ no

Date Last log was run _____

Was CO₂ encountered? ☐ yes ☐ no at what depths? _____

Was H₂S encountered? ☐ yes ☐ no at what depths? _____

Were unusual drilling circumstances encountered? ☐ yes ☐ no

If yes, briefly explain below _____

Other remarks:

[illegible]

A large, empty grid consisting of 10 columns and 10 rows of squares, intended for drawing a picture.

Directional surveys are required for all drainholes and directional wells.

A large, empty 10x10 grid of squares, intended for drawing a picture.

SEC	TWP	RGE	COUNTY
Spot Location			
1/4	1/4	1/4	1/4
Measured Total Depth		True Vertical Depth	Feet From 1/4 Sec Lines
			FSL
		FWL	
BHL From Lease, Unit, or Property Line:			

LATERAL #1							
SEC	TWP	RGE	COUNTY				
Spot Location		1/4	1/4	1/4	Feet From 1/4 Sec Lines	FSL	FWL
Depth of Deviation		Radius of Turn		Direction		Total Length	
Measured Total Depth		True Vertical Depth		BHL From Lease, Unit, or Property Line:			

SEC	TWP	RGE	COUNTY
Spot Location			
1/4	1/4	1/4	1/4
Feet From 1/4 Sec Lines		FSL	FWL
Depth of Deviation	Radius of Turn	Direction	Total Length
Measured Total Depth	True Vertical Depth	BHL From Lease, Unit, or Property Line:	

LATERAL #3						
SEC		TWP		RGE		COUNTY
Spot Location						
1/4		1/4		1/4		1/4
Feet From 1/4 Sec Lines				FSL		FWL
Depth of Deviation				Radius of Turn		Direction
Measured Total Depth				True Vertical Depth		BHL From Lease, Unit, or Property Line: