

Oklahoma Corporation Commission  
Oil & Gas Conservation Division  
Post Office Box 52000  
Oklahoma City, Oklahoma 73152-2000  
Rule 165: 10-3-25

Form 1002A

API No.: 35153236380000

**Completion Report**

Spud Date: November 24, 2018

OTC Prod. Unit No.: 153-224888-0-0000

Drilling Finished Date: December 06, 2018

1st Prod Date: March 01, 2019

Completion Date: April 29, 2019

**Drill Type: STRAIGHT HOLE**

Well Name: DALE 1

Purchaser/Measurer:

Location: WOODWARD 23 21N 17W  
C SE SW  
660 FSL 1980 FWL of 1/4 SEC  
Derrick Elevation: 1848 Ground Elevation: 1835

First Sales Date:

Operator: GLB EXPLORATION INC 18634

7716 MELROSE LN  
OKLAHOMA CITY, OK 73127-6002

Completion Type		Location Exception		Increased Density	
X	Single Zone	Order No		Order No	
	Multiple Zone	696135		683809	
	Commingled				

Casing and Cement							
Type	Size	Weight	Grade	Feet	PSI	SAX	Top of CMT
CONDUCTOR	16	42		63		6	SURFACE
SURFACE	8 5/8	24	J-55	1018	800	550	SURFACE
PRODUCTION	5 1/2	17 & 20	N-80	7680	1400	125	6676

Liner								
Type	Size	Weight	Grade	Length	PSI	SAX	Top Depth	Bottom Depth
There are no Liner records to display.								

**Total Depth: 7714**

Packer	
Depth	Brand & Type
There are no Packer records to display.	

Plug	
Depth	Plug Type
There are no Plug records to display.	

Initial Test Data
-------------------

Test Date	Formation	Oil BBL/Day	Oil-Gravity (API)	Gas MCF/Day	Gas-Oil Ratio Cu FT/BBL	Water BBL/Day	Pumpin or Flowing	Initial Shut-In Pressure	Choke Size	Flow Tubing Pressure
Apr 29, 2019	CHEROKEE SAND	5		15	3000		PUMPING	1600		

#### Completion and Test Data by Producing Formation

Formation Name: CHEROKEE SAND

Code: 404CHRKS

Class: OIL

#### Spacing Orders

Order No	Unit Size
161098	640

#### Perforated Intervals

From	To
7496	7504

#### Acid Volumes

2,000 GALLONS 4% NEFE HCL
---------------------------

#### Fracture Treatments

712 BARRELS 90 QUALITY GEL DIESEL + 23,250 POUNDS 20/40 SAND + 9,125 POUNDS 20/40 RESIN COATED SAND
-----------------------------------------------------------------------------------------------------

Formation	Top
TONKAWA	6178
COTTAGE GROVE	6699
HOGSHOOTER	6853
BIG LIME	7139
CHEROKEE	7500

Were open hole logs run? Yes

Date last log run: December 07, 2018

Were unusual drilling circumstances encountered? No

Explanation:

#### Other Remarks

RFT TEST @ 7503 - 2901 PSIG  
7501 - 3093 PSIG  
7499 - 3440 PSIG  
7497 - 2830 PSIG

INITIAL RFT SHOWED VIRGIN PRESSURES, SUBSEQUENT COMPLETION INDICATED POSSIBLE DEPLETION FROM OFFSET WELLS.

#### FOR COMMISSION USE ONLY

1142843

Status: Accepted

API NO. **153-23638**  
OTC PROD. UNIT NO. **153-22488**

PLEASE TYPE OR USE BLACK INK ONLY  
NOTE: Attach copy of original 1002A if recompletion or ree

OKLAHOMA CORPORATION COMMISSION  
Oil & Gas Conservation Division  
Post Office Box 52000  
Oklahoma City, Oklahoma 73152-2000  
Rule 165:10-3-25

RECEIVED

Form 1002A  
Rev. 2009

MAY 10 2019

Oklahoma Corporation  
Commission

640 Acres

☒ ORIGINAL  
☐ AMENDED (Reason) \_\_\_\_\_

COMPLETION REPORT

TYPE OF DRILLING OPERATION

☒ STRAIGHT HOLE ☐ DIRECTIONAL HOLE ☐ HORIZONTAL HOLE  
☐ SERVICE WELL

If directional or horizontal, see reverse for bottom hole location.

COUNTY	WOODWARD	SEC	23	TWP	21N	RGE	17W	SPUD DATE	11/24/18	
LEASE NAME	DALE	WELL NO.	1	DATE OF WELL COMPLETION	4/29/19	1st PROD DATE	3/1/19	DRLG FINISHED DATE	12/6/18	
C 1/4 SE 1/4 SW 1/4	1/4	FSL	660	FWL OF 1/4 SEC	1980	RECOMP DATE				
ELEVATION N Derrick	1848	Ground	1935	Latitude (if known)		Longitude (if known)				
OPERATOR NAME	GLB EXPLORATION, INC.			OTC/OCC OPERATOR N						18634-0
ADDRESS	7716 MELROSE LANE									
CITY	OKLAHOMA CITY			STATE	OK	ZIP	73127			

LOCATE WELL

COMPLETION TYPE

<input checked="" type="checkbox"/> SINGLE ZONE
<input type="checkbox"/> MULTIPLE ZONE
Application Date
COMINGLED
Application Date
LOCATION
EXCEPTION ORDER
INCREASED DENSITY
ORDER NO.

CASING & CEMENT (Form 1002C must be attached)

TYPE	SIZE	WEIGHT	GRADE	FEET	PSI	SAX	TOP OF CMT
CONDUCTOR	16	42	-	63	-	6 1/2 IN	SURFACE
SURFACE	8 5/8	24	J-55	1018	800	300 550	SURFACE
INTERMEDIATE							
PRODUCTION	5 1/2	17+20	N-80	7680	1400	125	6676
LINER							
TOTAL DEPTH							7,714

Per 1002C

PACKER @ \_\_\_\_\_ BRAND & TYPE \_\_\_\_\_ PLUG @ \_\_\_\_\_ TYPE \_\_\_\_\_ PLUG @ \_\_\_\_\_ TYPE \_\_\_\_\_  
PACKER @ \_\_\_\_\_ BRAND & TYPE \_\_\_\_\_ PLUG @ \_\_\_\_\_ TYPE \_\_\_\_\_ PLUG @ \_\_\_\_\_ TYPE \_\_\_\_\_

COMPLETION & TEST DATA BY PRODUCING FORMATION **404CHRS**

FORMATION	CHEROKEE Sand								
SPACING & SPACING ORDER NUMBER	640-161098								
CLASS: Oil, Gas, Dry, Inj, Disp, Comm Disp, Svc	OIL								
PERFORATED INTERVALS	7,496'-7504'								
ACID/VOLUME	2000 gal 4% NE FE HCL								
FRACTURE TREATMENT (Fluids/Prop Amounts)	712 bbls 70 quality gel DIESEL + 23,250# 20/40 SD + 9,125# 20/40 RESIN COATED SAND								

Reported to Free Fours

Min Gas Allowable (165:10-17-7) \_\_\_\_\_ Gas Purchaser/Measurer \_\_\_\_\_  
OR \_\_\_\_\_ First Sales Date \_\_\_\_\_  
Oil Allowable (165:10-13-3) \_\_\_\_\_

INITIAL TEST DATA

INITIAL TEST DATE	4/29/19								
OIL-BBL/DAY	5								
OIL-GRAVITY (API)									
GAS-MCF/DAY	15								
GAS-OIL RATIO CU FT/BBL	3,000 : 1								
WATER-BBL/DAY	0								
PUMPING OR FLOWING	Pumping								
INITIAL SHUT-IN PRESSURE	1600								
CHOKE SIZE									
FLOW TUBING PRESSURE									

AS SUBMITTED

A record of the formations drilled through, and pertinent remarks are presented on the reverse. I declare that I have knowledge of the contents of this report and am authorized by my organization to make this report, which was prepared by me or under my supervision and direction, with the data and facts stated herein to be true, correct, and complete to the best of my knowledge and belief.

SIGNATURE **GLENN BLUMSTEIN** NAME (PRINT OR TYPE) **5/8/19** DATE **405-757-0049** PHONE NUMBER  
**7716 MELROSE LANE** ADDRESS **OKC OK 73127** CITY STA ZIP **glb@glbexplorationinc.com** EMAIL ADDRESS

PLEASE TYPE OR USE BLACK INK ONLY

FORMATION RECORD

Give formation names and tops, if available, or descriptions and thickness of formations drilled through. Show intervals cored or drillstem tested.

LEASE NAME DALE

WELL NO. 1

NAMES OF FORMATIONS	TOP
Tonkawa	6178
CoHage Grove	6699
HOGSHOOTER	6853
BIO LIME	7139
CHEROKEE	7500
MUD LOG TOPS	

FOR COMMISSION USE ONLY	
ITD on file <input type="checkbox"/> YES <input type="checkbox"/> NO	
APPROVED _____	DISAPPROVED _____
2) Reject Codes	

Were open hole logs run?	<input checked="" type="checkbox"/> yes <input type="checkbox"/> no
Date Last log was run	<u>12/7/18</u>
Was CO <sub>2</sub> encountered?	<input type="checkbox"/> yes <input checked="" type="checkbox"/> no at what depths? _____
Was H <sub>2</sub> S encountered?	<input type="checkbox"/> yes <input checked="" type="checkbox"/> no at what depths? _____
Were unusual drilling circumstances encountered?	<input type="checkbox"/> yes <input checked="" type="checkbox"/> no
If yes, briefly explain below	

Other remarks: RFT TEST @ 7503 - 2901 psig  
7501 - 3093 psig  
7499 - 3440 "  
7497 - 2830 "  
Initial RFT SHOWED VIRGIN PRESSURES. Subsequent completion indicated possible depletion from offset wells.

640 Acres

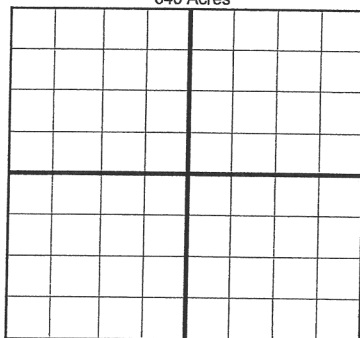

If more than three drainholes are proposed, attach a separate sheet indicating the necessary information.

Direction must be stated in degrees azimuth. Please note, the horizontal drainhole and its end point must be located within the boundaries of the lease or spacing unit.

Directional surveys are required for all drainholes and directional wells.

640 Acres

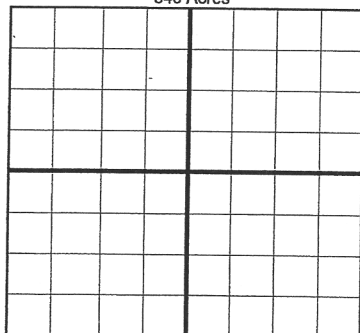

BOTTOM HOLE LOCATION FOR DIRECTIONAL HOLE

SEC	TWP	RGE	COUNTY
Spot Location			
1/4	1/4	1/4	1/4
Measured Total Depth		True Vertical Depth	BHL From Lease, Unit, or Property Line:

BOTTOM HOLE LOCATION FOR HORIZONTAL HOLE: (LATERALS)

LATERAL #1			
SEC	TWP	RGE	COUNTY
Spot Location			
1/4	1/4	1/4	1/4
Depth of Deviation		Radius of Turn	Direction
Measured Total Depth		True Vertical Depth	Total Length
			BHL From Lease, Unit, or Property Line:

LATERAL #2			
SEC	TWP	RGE	COUNTY
Spot Location			
1/4	1/4	1/4	1/4
Depth of Deviation		Radius of Turn	Direction
Measured Total Depth		True Vertical Depth	Total Length
			BHL From Lease, Unit, or Property Line:

LATERAL #3			
SEC	TWP	RGE	COUNTY
Spot Location			
1/4	1/4	1/4	1/4
Depth of Deviation		Radius of Turn	Direction
Measured Total Depth		True Vertical Depth	Total Length
			BHL From Lease, Unit, or Property Line: