

Oklahoma Corporation Commission  
Oil & Gas Conservation Division  
Post Office Box 52000  
Oklahoma City, Oklahoma 73152-2000  
Rule 165: 10-3-25

Form 1002A

API No.: 35117236970000

**Completion Report**

Spud Date: August 02, 2018

OTC Prod. Unit No.:

Drilling Finished Date: August 06, 2018

1st Prod Date:

Completion Date: April 02, 2019

**Drill Type: STRAIGHT HOLE**

Well Name: HICKSON 1-19

Purchaser/Measurer:

Location: PAWNEE 19 20N 8E  
S2 NE SE NE  
1825 FNL 330 FEL of 1/4 SEC  
Derrick Elevation: 0 Ground Elevation: 845

First Sales Date:

Operator: HALL GREG OIL & GAS LLC 21902

2940 NW 156TH ST  
EDMOND, OK 73013-2102

Completion Type		Location Exception		Increased Density	
	Single Zone	Order No		Order No	
	Multiple Zone	There are no Location Exception records to display.		There are no Increased Density records to display.	
	Commingled				

Casing and Cement								
Type		Size	Weight	Grade	Feet	PSI	SAX	Top of CMT
SURFACE		8 5/8	24	8RD	265		180	SURFACE
PRODUCTION		5 1/2	14	8RD	2750		180	1400

Liner								
Type	Size	Weight	Grade	Length	PSI	SAX	Top Depth	Bottom Depth
There are no Liner records to display.								

**Total Depth: 2758**

Packer		Plug	
Depth	Brand & Type	Depth	Plug Type
There are no Packer records to display.		There are no Plug records to display.	

Initial Test Data										
Test Date	Formation	Oil BBL/Day	Oil-Gravity (API)	Gas MCF/Day	Gas-Oil Ratio Cu FT/BBL	Water BBL/Day	Pumpin or Flowing	Initial Shut-In Pressure	Choke Size	Flow Tubing Pressure
Jul 28, 2018	BARTLESVILLE					50	N/A	150	N/A	
Apr 02, 2019	CLEVELAND					60	N/A	480	N/A	

**Completion and Test Data by Producing Formation**

Formation Name: BARTLESVILLE

Code: 404BRVL

Class: DRY

**Spacing Orders**

Order No	Unit Size
UNSPACED	

**Perforated Intervals**

From	To
2645	2649

**Acid Volumes**

750 GALLONS 7 1/2%
--------------------

**Fracture Treatments**

There are no Fracture Treatments records to display.
--

Formation Name: CLEVELAND

Code: 405CLVD

Class: DRY

**Spacing Orders**

Order No	Unit Size
UNSPACED	

**Perforated Intervals**

From	To
1828	1848

**Acid Volumes**

1,000 GALLONS 7 1/2%
----------------------

**Fracture Treatments**

There are no Fracture Treatments records to display.
--

Formation	Top
CHECKERBOARD LIME	1752
CLEVELAND	1827
PINK LIME	2495
RED FORK	2522
BARTLESVILLE	2638

Were open hole logs run? Yes

Date last log run: August 06, 2018

Were unusual drilling circumstances encountered? No

Explanation:

**Other Remarks**

There are no Other Remarks.

**FOR COMMISSION USE ONLY**

1142867

Status: Accepted

API NO. 3511723697  
OTC PROD.  
UNIT NO.

(PLEASE TYPE OR USE BLACK INK ONLY)

OKLAHOMA CORPORATION COMMISSION  
Oil & Gas Conservation Division  
Post Office Box 52000  
Oklahoma City, Oklahoma 73152-2000  
Rule 165:10-3-25

RECEIVED

Form 1002A  
Rev. 2009

MAY 13 2019

OKLAHOMA CORPORATION  
COMMISSION

☒ ORIGINAL  
☐ AMENDED (Reason)

TYPE OF DRILLING OPERATION

☒ STRAIGHT HOLE ☐ DIRECTIONAL HOLE ☐ HORIZONTAL HOLE  
☐ SERVICE WELL

If directional or horizontal, see reverse for bottom hole location.

COUNTY	Pawnee	SEC	19	TWP	20N	RGE	8E
LEASE NAME	Hickson	WELL NO.	1_19	DATE OF WELL COMPLETION	4/2/2019	1st PROD DATE	N/A
S2 1/4 NE 1/4 SE 1/4 NE 1/4	FNL OF 1/4 SEC 1825	FEL OF 1/4 SEC 330	RECOMP DATE				
ELEVATION	Ground 845	Latitude (if known)	Longitude (if known)				
OPERATOR NAME	Greg Hall Oil & Gas, LLC	OTC / OCC OPERATOR NO.	21902				
ADDRESS	2940 NW 156th St						
CITY	Edmond	STATE	OK	ZIP	73013		

LOCATE WELL

COMPLETION TYPE

<input type="checkbox"/> SINGLE ZONE	
<input type="checkbox"/> MULTIPLE ZONE	
Application Date	
<input type="checkbox"/> COMMINGLED	
Application Date	
LOCATION EXCEPTION ORDER NO.	
INCREASED DENSITY ORDER NO.	

CASING & CEMENT (Attach Form 1002C)

TYPE	SIZE	WEIGHT	GRADE	FEET	PSI	SAX	TOP OF CMT
CONDUCTOR							
SURFACE	8 5/8	24#	8rd	265		180	Surface
INTERMEDIATE							
PRODUCTION	5 1/2	14#	8rd	2750		180	1400
LINER							

PACKER @ \_\_\_\_\_ BRAND & TYPE \_\_\_\_\_ PLUG @ \_\_\_\_\_ TYPE \_\_\_\_\_ PLUG @ \_\_\_\_\_ TYPE \_\_\_\_\_  
PACKER @ \_\_\_\_\_ BRAND & TYPE \_\_\_\_\_ PLUG @ \_\_\_\_\_ TYPE \_\_\_\_\_ PLUG @ \_\_\_\_\_ TYPE \_\_\_\_\_

TOTAL DEPTH 2,758

COMPLETION & TEST DATA BY PRODUCING FORMATION

FORMATION	Bartlesville	Cleveland					No Frac
SPACING & SPACING	Unspaced	Unspaced					
ORDER NUMBER							
CLASS: Oil, Gas, Dry, Inj, Disp, Comm Disp, Svc	Dry	Dry					
PERFORATED INTERVALS	2645-2649	1828-1836					
		1844-1848					
ACID/VOLUME	750 Gal 7 1/2%	1000 Gal 7 1/2%					
FRACTURE TREATMENT (Fluids/Prop Amounts)							

Min Gas Allowable (165:10-17-7)

Gas Purchaser/Measurer

☐

OR

First Sales Date

INITIAL TEST DATA

Oil Allowable (165:10-13-3)

INITIAL TEST DATE	7/28/2018	4/2/2019				
OIL-BBL/DAY	0	0				
OIL-GRAVITY (API)	N/A	N/A				
GAS-MCF/DAY	0	0				
GAS-OIL RATIO CU FT/BBL	0	0				
WATER-BBL/DAY	50	60				
PUMPING OR FLOWING	N/A	N/A				
INITIAL SHUT-IN PRESSURE	150	480				
CHOKE SIZE	N/A	N/A				
FLOW TUBING PRESSURE	N/A	N/A				

AS SUBMITTED

A record of the formations drilled through, and pertinent remarks are presented on the reverse. I declare that I have knowledge of the contents of this report and am authorized by my organization to make this report, which was prepared by me or under my supervision and direction, with the data and facts stated herein to be true, correct, and complete to the best of my knowledge and belief.

  
SIGNATURE  
2940 NW 156th St  
Edmond OK 73013  
Russell Forsander  
NAME (PRINT OR TYPE)  
5/2/2019  
DATE  
405-285-2588  
PHONE NUMBER  
russell.forsander@gmail.com

PLEASE TYPE OR USE BLACK INK ONLY  
FORMATION RECORD

Give formation names and tops, if available, or descriptions and thickness of formations drilled through. Show intervals cored or drillstem tested.

NAMES OF FORMATIONS	TOP
Checkerboard Lime	1,752
Cleveland	1,827
Pink Lime	2495
Red Fork	2,522
Bartlesville	2,638

LEASE NAME Hickson

WELL NO. 1\_19

FOR COMMISSION USE ONLY	
ITD on file <input type="checkbox"/> YES <input type="checkbox"/> NO	
APPROVED _____	DISAPPROVED _____
2) Reject Codes	
_____	
_____	
_____	
_____	

Were open hole logs run?	<input checked="" type="checkbox"/> yes	<input type="checkbox"/> no
Date Last log was run	<u>8/6/2018</u>	
Was CO <sub>2</sub> encountered?	<input type="checkbox"/> yes	<input checked="" type="checkbox"/> no at what depths? _____
Was H <sub>2</sub> S encountered?	<input type="checkbox"/> yes	<input checked="" type="checkbox"/> no at what depths? _____
Were unusual drilling circumstances encountered?	<input type="checkbox"/> yes	<input checked="" type="checkbox"/> no
If yes, briefly explain below		

Other remarks:

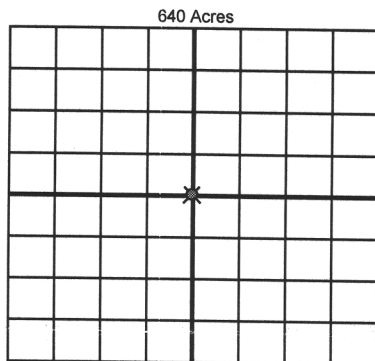
If more than three drainholes are proposed, attach a separate sheet indicating the necessary information.

Direction must be stated in degrees azimuth.  
Please note, the horizontal drainhole and its end point must be located within the boundaries of the lease or spacing unit.

Directional surveys are required for all drainholes and directional wells.

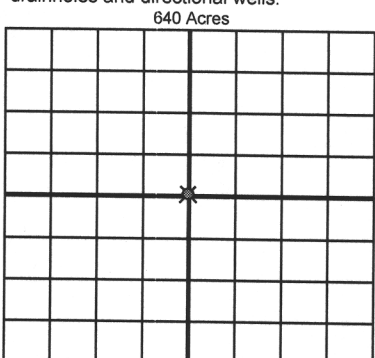

BOTTOM HOLE LOCATION FOR DIRECTIONAL HOLE

SEC	TWP	RGE	COUNTY
Spot Location			
1/4	1/4	1/4	1/4
Measured Total Depth		True Vertical Depth	BHL From Lease, Unit, or Property Line:

BOTTOM HOLE LOCATION FOR HORIZONTAL HOLE: (LATERALS)

LATERAL #1			
SEC	TWP	RGE	COUNTY
Spot Location			
1/4	1/4	1/4	1/4
Depth of Deviation		Radius of Turn	Direction
Measured Total Depth		True Vertical Depth	BHL From Lease, Unit, or Property Line:

LATERAL #2			
SEC	TWP	RGE	COUNTY
Spot Location			
1/4	1/4	1/4	1/4
Depth of Deviation		Radius of Turn	Direction
Measured Total Depth		True Vertical Depth	BHL From Lease, Unit, or Property Line:

LATERAL #3			
SEC	TWP	RGE	COUNTY
Spot Location			
1/4	1/4	1/4	1/4
Depth of Deviation		Radius of Turn	Direction
Measured Total Depth		True Vertical Depth	BHL From Lease, Unit, or Property Line: