

Oklahoma Corporation Commission  
Oil & Gas Conservation Division  
Post Office Box 52000  
Oklahoma City, Oklahoma 73152-2000  
Rule 165: 10-3-25

Form 1002A

API No.: 35033208720001

**Completion Report**

Spud Date: March 27, 1984

OTC Prod. Unit No.:

Drilling Finished Date: April 02, 1984

**Amended**

1st Prod Date: April 29, 1984

Amend Reason: CONVERT TO SALTWATER DISPOSAL

Completion Date: April 28, 1984

Recomplete Date: April 20, 2022

**Drill Type:** SERVICE WELL

Well Name: C E PETTY 10

Purchaser/Measurer:

Location: COTTON 35 1S 10W  
C SW SE NE  
330 FSL 1650 FWL of 1/4 SEC  
Latitude: 34.42835 Longitude: -98.2113  
Derrick Elevation: 0 Ground Elevation: 0

First Sales Date:

Operator: INMAN OIL LLC 19800  
PO BOX 7205  
211 EXCALIBUR RD  
RUIDOSO, NM 88355-7205

Completion Type		Location Exception		Increased Density	
X	Single Zone	Order No		Order No	
	Multiple Zone	There are no Location Exception records to display.		There are no Increased Density records to display.	
	Commingled				

Casing and Cement							
Type	Size	Weight	Grade	Feet	PSI	SAX	Top of CMT
SURFACE	8 5/8			160		70	SURFACE
PRODUCTION	4 1/2			2220		138	1410

Liner								
Type	Size	Weight	Grade	Length	PSI	SAX	Top Depth	Bottom Depth
There are no Liner records to display.								

**Total Depth: 2232**

Packer		Plug	
Depth	Brand & Type	Depth	Plug Type
2030	TENSION	There are no Plug records to display.	

Initial Test Data
-------------------

Test Date	Formation	Oil BBL/Day	Oil-Gravity (API)	Gas MCF/Day	Gas-Oil Ratio Cu FT/BBL	Water BBL/Day	Pumpin or Flowing	Initial Shut- In Pressure	Choke Size	Flow Tubing Pressure
-----------	-----------	----------------	----------------------	----------------	----------------------------	------------------	----------------------	---------------------------------	---------------	-------------------------

There are no Initial Data records to display.

Completion and Test Data by Producing Formation

Formation Name: PRIDDY

Code: 406PRDD

Class: DISP

Spacing Orders		Perforated Intervals	
Order No	Unit Size	From	To
There are no Spacing Order records to display.		2146	2173
Acid Volumes		Fracture Treatments	
There are no Acid Volume records to display.		There are no Fracture Treatments records to display.	

Formation	Top
SHALE	160
SHALE	300
SHALE	980
SHALE	1345
WATER SAND	2064
SHALE	2082
SAND	2086
SHALE	2096
SAND	2146
SHALE	2172
SAND	2186
SHALE	2192

Were open hole logs run? Yes  
Date last log run: April 01, 1984  
  
Were unusual drilling circumstances encountered? No  
Explanation:

Other Remarks
OCC - UIC PERMIT NUMBER 2200102601

FOR COMMISSION USE ONLY

1148074

Status: Accepted

API NO. 35-03320872  
OTC PROD.  
UNIT NO.

Oil and Gas Conservation Division  
P.O. Box 52000  
Oklahoma City, OK 73152-2000  
405-521-2331  
OCCCentralProcessing@OCC.OK.GOV



OKLAHOMA  
Corporation  
Commission

Form 1002A  
Rev. 2020

ORIGINAL  
AMENDED (Reason)

CONVERT TO SWD

Rule 165:10-3-25

COMPLETION REPORT

TYPE OF DRILLING OPERATION

☒ STRAIGHT HOLE ☐ DIRECTIONAL HOLE ☐ HORIZONTAL HOLE  
☒ SERVICE WELL

If directional or horizontal, see reverse for bottom hole location.

COUNTY COTTON SEC 35 TWP 1S RGE 10W

LEASE NAME CE PETTY

WELL NO. 10

SPUD DATE 3/27/84

DRILLING FINISHED DATE 4/2/84

DATE OF WELL COMPLETION 4/28/84

1st PROD DATE 4/29/84

RECOMP DATE 4/20/22

ELEVATION  
Derrick FL Ground

Latitude

Longitude

OPERATOR NAME INMAN OIL LLC

OTC/OCC OPERATOR NO. 19800

ADDRESS PO BOX 7205

CITY RUIDOSO

STATE NM

ZIP 88355

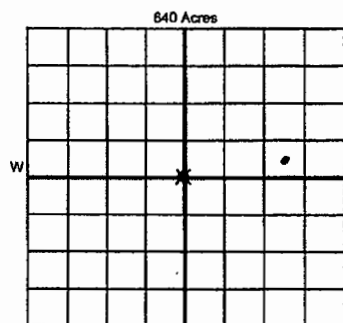

COMPLETION TYPE

☒ SINGLE ZONE  
☐ MULTIPLE ZONE  
☐ COMMINGLED  
☐ LOCATION EXCEPTION  
☐ ORDER NO.  
☐ MULTIUNIT ORDER NO.  
☐ INCREASED DENSITY  
☐ ORDER NO.

CASING & CEMENT (Attach Form 1002C)

TYPE	SIZE	WEIGHT	GRADE	FEET	PSI	SAX	TOP OF CMT
CONDUCTOR							
SURFACE	8 5/8			160		70	SURFACE
INTERMEDIATE							
PRODUCTION	4 1/2			2220		138	1410
LINER							

PACKER @ 2030 BRAND & TYPE TENSION  
PACKER @ BRAND & TYPE

PLUG @ TYPE PLUG @ TYPE  
PLUG @ TYPE PLUG @ TYPE

TOTAL DEPTH 2232

COMPLETION & TEST DATA BY PRODUCING FORMATION 406 PRDD

FORMATION	PRIDDY						
SPACING & SPACING							
ORDER NUMBER							
CLASS: Oil, Gas, Dry, Inj, Disp, Comm Disp, Svc	Disp						
PERFORATED INTERVALS	PERMIT # 2200102601 2146-2173	see remarks					
ACID/VOLUME							
FRACTURE TREATMENT (Fluids/Prop Amounts)							

RECEIVED

MAY 02 2022

OKLAHOMA CORPORATION  
COMMISSION

Min Gas Allowable (165:10-17-7)

OR

Oil Allowable (165:10-13-3)

Purchaser/Measurer

First Sales Date

INITIAL TEST DATA

INITIAL TEST DATE	NA						
OIL-BBL/DAY							
OIL-GRAVITY (API)							
GAS-MCF/DAY							
GAS-OIL RATIO CU FT/BBL							
WATER-BBL/DAY							
PUMPING OR FLOWING							
INITIAL SHUT-IN PRESSURE							
CHOKE SIZE							
FLOW TUBING PRESSURE							

A record of the formations drilled through, and pertinent remarks are presented on the reverse. I declare that I have knowledge of the contents of this report and am authorized by my organization to make this report, which was prepared by me or under my supervision and direction, with the data and facts stated herein to be true, correct, and complete to the best of my knowledge and belief.

DAVID K MOORE  
SIGNATURE

DAVID K MOORE

5802551674

PO BOX 2150

DUNCAN

NAME (PRINT OR TYPE)

OK 73534

DATE PHONE NUMBER

latigodrilling@yahoo.com

ADDRESS

CITY

STATE

ZIP

EMAIL ADDRESS

PLEASE TYPE OR USE BLACK INK ONLY  
FORMATION RECORD

Give formation names and tops, if available, or descriptions and thickness of formations drilled through. Show intervals cored or drillstem tested.

NAMES OF FORMATIONS	TOP
NO RECORD	0-160
CLAY AND SHALE	160-300
SANDY SHALE AND SHALE	300-980
WATER SANDS AND SHALE	980-1345
SHALY SANDS AND SHALE	1345-2064
WATER SAND	2064-2082
SHALE	2082-2086
TITE SAND	2086-2096
SHALE	2096-2146
OIL AND WATER SAND	2146-2172

LEASE NAME CE PETTY WELL NO. 10

FOR COMMISSION USE ONLY	
ITD on file <input type="checkbox"/> YES <input type="checkbox"/> NO	
APPROVED <input type="checkbox"/> DISAPPROVED <input type="checkbox"/>	2) Reject Codes

Were open hole logs run?	<input checked="" type="radio"/> yes <input type="radio"/> no
Date Last log was run	<u>4/84</u>
Was CO <sub>2</sub> encountered?	<input type="radio"/> yes <input checked="" type="radio"/> no at what depths? <u></u>
Was H <sub>2</sub> S encountered?	<input type="radio"/> yes <input checked="" type="radio"/> no at what depths? <u></u>
Were unusual drilling circumstances encountered?	<input type="radio"/> yes <input checked="" type="radio"/> no
If yes, briefly explain below.	

Other remarks: SHALE 2172-2186  
TITE SAND 2186-2192  
SHALE 2192-2232  
TOTAL DEPTH 2232'  
OCC-ULC permit 2200102601

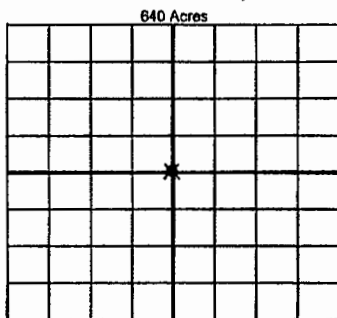

If more than three drainholes are proposed, attach a separate sheet indicating the necessary information.

Direction must be stated in degrees azimuth. Please note, the horizontal drainhole and its end point must be located within the boundaries of the lease or spacing unit.

Directional surveys are required for all drainholes and directional wells

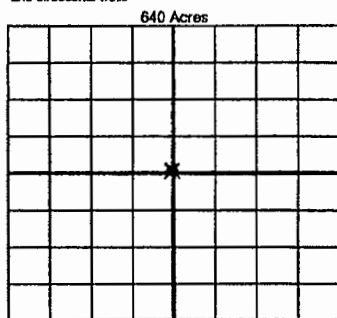

BOTTOM HOLE LOCATION FOR DIRECTIONAL HOLE

SEC	TWP	RGE	COUNTY
1/4	1/4	1/4	1/4
Measured Total Depth		True Vertical Depth	
		BHL From Lease, Unit, or Property Line:	

BOTTOM HOLE LOCATION FOR HORIZONTAL HOLE: (LATERALS)

LATERAL #1			
SEC	TWP	RGE	COUNTY
1/4	1/4	1/4	1/4
Depth of Deviation		Radius of Turn	
Measured Total Depth		True Vertical Depth	
		BHL From Lease, Unit, or Property Line:	

LATERAL #2

SEC	TWP	RGE	COUNTY
1/4	1/4	1/4	1/4
Depth of Deviation		Radius of Turn	
Measured Total Depth		True Vertical Depth	
		BHL From Lease, Unit, or Property Line:	

LATERAL #3

SEC	TWP	RGE	COUNTY
1/4	1/4	1/4	1/4
Depth of Deviation		Radius of Turn	
Measured Total Depth		True Vertical Depth	
		BHL From Lease, Unit, or Property Line:	