

Oklahoma Corporation Commission
Oil & Gas Conservation Division
Post Office Box 52000
Oklahoma City, Oklahoma 73152-2000
Rule 165: 10-3-25

Form 1002A

API No.: 35149210500001

Completion Report

Spud Date: August 22, 2003

OTC Prod. Unit No.: 149-112154-0-0000

Drilling Finished Date: October 17, 2003

Amended

1st Prod Date: December 09, 2003

Amend Reason: RECOMPLETION

Completion Date: December 19, 2003

Recomplete Date: November 14, 2020

Drill Type: STRAIGHT HOLE

Min Gas Allowable: Yes

Well Name: WALTERS 1-13

Purchaser/Measurer: N/A

Location: WASHITA 13 11N 20W
NE SW NW NE
1890 FSL 450 FWL of 1/4 SEC
Latitude: 35.43436389 Longitude: -99.26564167
Derrick Elevation: 1840 Ground Elevation: 1820

First Sales Date: N/A

Operator: ATALAYA RESOURCES LLC 23658

15 E 5TH ST STE 1100
TULSA, OK 74103-4361

Completion Type		Location Exception		Increased Density	
X	Single Zone	Order No		Order No	
	Multiple Zone	476057		There are no Increased Density records to display.	
	Commingled	718717			

Casing and Cement							
Type	Size	Weight	Grade	Feet	PSI	SAX	Top of CMT
CONDUCTOR	20			41		10	SURFACE
SURFACE	13 3/8	48	H-40	668		610	SURFACE
INTERMEDIATE	9 5/8	40	J-55	5245		590	SURFACE
PRODUCTION	7	29	P-110	13445		550	11100

Liner								
Type	Size	Weight	Grade	Length	PSI	SAX	Top Depth	Bottom Depth
LINER	4 1/2	15.5	P-110	1346	0	150	13253	14599

Total Depth: 12988

Packer		Plug	
Depth	Brand & Type	Depth	Plug Type
There are no Packer records to display.		12988	PACKER WITH PLUG

Initial Test Data

Test Date	Formation	Oil BBL/Day	Oil-Gravity (API)	Gas MCF/Day	Gas-Oil Ratio Cu FT/BBL	Water BBL/Day	Pumpin or Flowing	Initial Shut-In Pressure	Choke Size	Flow Tubing Pressure
Nov 15, 2020	HOXBAR					150	SWABBIN	50	26/64	

Completion and Test Data by Producing Formation

Formation Name: HOXBAR

Code: 405HXBR

Class: DRY

Spacing Orders

Order No	Unit Size
130975	640

Perforated Intervals

From	To
10248	10250
10268	10273
10281	10283
10300	10305
10318	10320
10336	10348
10345	10350
10378	10383
10416	10424
10435	10440

Acid Volumes

N/A

Fracture Treatments

SLICKWATER, STAGE 1 - 238,000 POUNDS, 3,578 BARRELS; STAGE 2 - 88,000 POUNDS, 1,983 BARRELS

Formation	Top
DOUGLAS	9555
HOXBAR	9970
UPPER DES MOINES	13662
LOWER DES MOINES	14195

Were open hole logs run? No

Date last log run: October 17, 2003

Were unusual drilling circumstances encountered? No

Explanation:

Other Remarks

There are no Other Remarks.

FOR COMMISSION USE ONLY

1146053

Status: Accepted

API NO. 35-149-21050
OTC PROD. UNIT NO. 14A-112154

Oil and Gas Conservation Division
P.O. Box 52000
Oklahoma City, OK 73152-2000
405-522-0577
OCCCentralProcessing@OCC.OK.GOV



OKLAHOMA
Corporation
Commission

Form 1002A
Rev. 2020

ORIGINAL AMENDED (Reason) Recompletion

Rule 165:10-3-25

COMPLETION REPORT

TYPE OF DRILLING OPERATION

☒ STRAIGHT HOLE ☐ DIRECTIONAL HOLE ☐ HORIZONTAL HOLE
☐ SERVICE WELL

If directional or horizontal, see reverse for bottom hole location.

COUNTY	Washita	SEC	13	TWP	11N	RGE	20W		
LEASE NAME	Walters			WELL NO.	1-13				
NE 1/4 SW 1/4 NW 1/4 NE 1/4	FSL		1,890'	FEL	2,190'		RECOMP DATE	11-14-2020	
ELEVATION	Derrick FL		1,840'	Ground	1,820'		Latitude	35.43436389	
OPERATOR NAME				Atalaya Resources LLC				OTC / OCC OPERATOR NO.	23658
ADDRESS									15 E. 5th Street; Suite 1100
CITY			Tulsa		STATE	OK		ZIP	74103

SPUD DATE 08-22-2003

DRLG FINISHED DATE 10-17-2003

DATE OF WELL COMPLETION 12-19-2003

1st PROD DATE 12-09-2003

RECOMP DATE 11-14-2020

Longitude -99.26564167

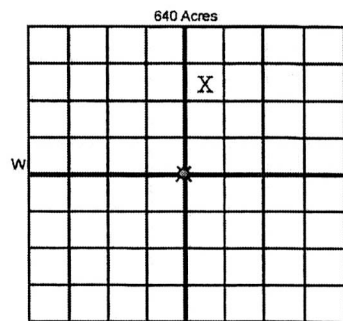

LOCATE WELL

COMPLETION TYPE

<input checked="" type="radio"/> SINGLE ZONE	
<input type="radio"/> MULTIPLE ZONE	
<input type="radio"/> Application Date	
<input type="radio"/> COMINGLED	
<input type="radio"/> Application Date	
LOCATION EXCEPTION ORDER NO.	476057/718/17
MULTIUNIT ORDER NO.	
INCREASED DENSITY ORDER NO.	476047

CASING & CEMENT (Attach Form 1002C)

TYPE	SIZE	WEIGHT	GRADE	FEET	PSI	SAX	TOP OF CMT
CONDUCTOR	20"			41'		10	Surface
SURFACE	9 5/8"	40#	J-55	5,245'		590	Surface
INTERMEDIATE	7"	29#	P-110	13,445'		550	11,100'
PRODUCTION	13 3/8"	48	H40	668		610	surface
LINER	4 1/2"	15.1#	P-110	13,253'		150	13,253'

PACKER @ BRAND & TYPE PLUG @ 12,988' TYPE Packerw/Plug PLUG @ TYPE TOTAL DEPTH 12,988'

COMPLETION & TEST DATA BY PRODUCING FORMATION

FORMATION	Hoxbar			
SPACING & SPACING ORDER NUMBER	640-130975			
CLASS: Oil, Gas, Dry, Inj. Disp, Comm Disp, Svc	Dry			
PERFORATED INTERVALS	10,250'-10,248'	10,305'-10,300'	10,350'-10,345'	10,440'-10,435'
	10,273'-10,268'	10,320'-10,318'	10,383'-10,378'	
	10,283'-10,281'	10,348'-10,336'	10,424'-10,416'	
ACID/VOLUME	N/A			
FRACTURE TREATMENT (Fluids/Prop Amounts)	Slickwater Stage 1 - 238K#/3,578bbl Stage 2 - 88K#/1,983bbl			

RECEIVED

JAN 11 2021

Oklahoma Corporation Commission



Min Gas Allowable (165:10-17-7)

OR

Oil Allowable (165:10-13-3)

Purchaser/Measurer

N/A

First Sales Date

N/A

INITIAL TEST DATA

INITIAL TEST DATE	11-15-2020
OIL-BBL/DAY	0
OIL-GRAVITY (API)	0
GAS-MCF/DAY	0
GAS-OIL RATIO CU FT/BBL	0
WATER-BBL/DAY	150
PUMPING OR FLOWING	Swabbing
INITIAL SHUT-IN PRESSURE	50#
CHOKE SIZE	26/64
FLOW TUBING PRESSURE	0

A record of the formations drilled through, and pertinent remarks are presented on the reverse. I declare that I have knowledge of the contents of this report and am authorized by my organization to make this report, which was prepared by me or under my supervision and direction, with the data and facts stated herein to be true, correct, and complete to the best of my knowledge and belief.

SIGNATURE	Ashley Lastinger	NAME (PRINT OR TYPE)	1/7/2021	DATE	918-986-9006	PHONE NUMBER
15 E. 5th Street; Suite 1100	Tulsa	OK	74103	EMAIL ADDRESS	alasting@atalres.com	
ADDRESS	CITY	STATE	ZIP			

PLEASE TYPE OR USE BLACK INK ONLY
FORMATION RECORD

Give formation names and tops, if available, or descriptions and thickness of formations drilled through. Show intervals cored or drillstem tested.

NAMES OF FORMATIONS	TOP
Douglas	9,555'
Hoxbar	9,970'
Upper Des Moines	13,662'
Lower Des Moines	14,195'

LEASE NAME Wakarusa WELL NO. 1-13

FOR COMMISSION USE ONLY	
ITD on file <input type="checkbox"/> YES <input type="checkbox"/> NO	
APPROVED _____	DISAPPROVED _____
2) Reject Codes	

Were open hole logs run?	<input type="radio"/> yes <input checked="" type="radio"/> no
Date Last log was run	10-17-2003
Was CO ₂ encountered?	<input type="radio"/> yes <input checked="" type="radio"/> no at what depths? _____
Was H ₂ S encountered?	<input type="radio"/> yes <input checked="" type="radio"/> no at what depths? _____
Were unusual drilling circumstances encountered?	<input type="radio"/> yes <input checked="" type="radio"/> no
If yes, briefly explain below	

Other remarks:

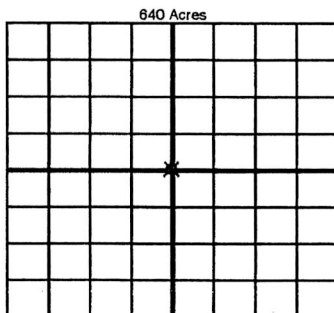

If more than three drainholes are proposed, attach a separate sheet indicating the necessary information.

Direction must be stated in degrees azimuth. Please note, the horizontal drainhole and its end point must be located within the boundaries of the lease or spacing unit.

Directional surveys are required for all drainholes and directional wells

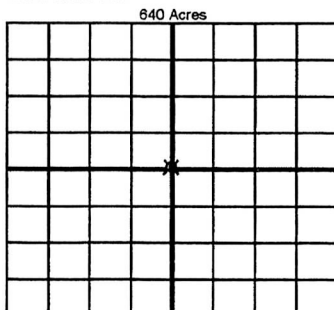

BOTTOM HOLE LOCATION FOR DIRECTIONAL HOLE

SEC	TWP	RGE	COUNTY
1/4	1/4	1/4	1/4
Measured Total Depth		True Vertical Depth	BHL From Lease, Unit, or Property Line:

BOTTOM HOLE LOCATION FOR HORIZONTAL HOLE: (LATERALS)

LATERAL #1			
SEC	TWP	RGE	COUNTY
1/4	1/4	1/4	1/4
Depth of Deviation		Radius of Turn	Direction
Measured Total Depth		True Vertical Depth	BHL From Lease, Unit, or Property Line:

LATERAL #2			
SEC	TWP	RGE	COUNTY
1/4	1/4	1/4	1/4
Depth of Deviation		Radius of Turn	Direction
Measured Total Depth		True Vertical Depth	BHL From Lease, Unit, or Property Line:

LATERAL #3			
SEC	TWP	RGE	COUNTY
1/4	1/4	1/4	1/4
Depth of Deviation		Radius of Turn	Direction
Measured Total Depth		True Vertical Depth	BHL From Lease, Unit, or Property Line: