

Oklahoma Corporation Commission  
Oil & Gas Conservation Division  
Post Office Box 52000  
Oklahoma City, Oklahoma 73152-2000  
Rule 165: 10-3-25

Form 1002A

API No.: 35087221330000

**Completion Report**

Spud Date: May 31, 2018

OTC Prod. Unit No.: 087-224429

Drilling Finished Date: July 30, 2018

1st Prod Date: September 18, 2018

Completion Date: September 18, 2018

**Drill Type: HORIZONTAL HOLE**

Well Name: LYNN 7N 2W 35 1HX

Purchaser/Measurer:

Location: MCCLAIN 35 7N 2W  
NW NW NW NE  
243 FNL 2554 FEL of 1/4 SEC  
Latitude: 35.04356389 Longitude: -97.3796  
Derrick Elevation: 1186 Ground Elevation: 30

First Sales Date:

Operator: BP AMERICA PRODUCTION COMPANY 1640

1100 N BROADWAY AVE STE 200  
OKLAHOMA CITY, OK 73103-4937

Completion Type		Location Exception		Increased Density	
X	Single Zone	Order No		Order No	
	Multiple Zone	683027		There are no Increased Density records to display.	
	Commingled				

Casing and Cement							
Type	Size	Weight	Grade	Feet	PSI	SAX	Top of CMT
SURFACE	13 3/8	J-55	54.5	668		670	SURFACE
PRODUCTION	9 5/8	HCP-110	40	6321		375	4242

Liner								
Type	Size	Weight	Grade	Length	PSI	SAX	Top Depth	Bottom Depth
LINER	5 1/2	P-110	20	11087	0	2050	6095	17182

**Total Depth: 17182**

Packer	
Depth	Brand & Type
There are no Packer records to display.	

Plug	
Depth	Plug Type
There are no Plug records to display.	

Initial Test Data										
Test Date	Formation	Oil BBL/Day	Oil-Gravity (API)	Gas MCF/Day	Gas-Oil Ratio Cu FT/BBL	Water BBL/Day	Pumpin or Flowing	Initial Shut-In Pressure	Choke Size	Flow Tubing Pressure
Sep 19, 2018	WOODFORD	238	44	225	945	2129	FLOWING	1000	36	446

**Completion and Test Data by Producing Formation**

Formation Name: WOODFORD

Code: 319WDFD

Class: OIL

**Spacing Orders**

Order No	Unit Size
659503	640
683028	MULTIUNIT

**Perforated Intervals**

From	To
7556	17060

**Acid Volumes**

78,750 GALLONS
----------------

**Fracture Treatments**

479,719 GALLONS, 21,003,682 POUNDS PROPPANT
---

Formation	Top
WOODFORD	7500

Were open hole logs run? No

Date last log run:

Were unusual drilling circumstances encountered? No

Explanation:

**Other Remarks**

OCC - CORRECTION SHOW CORRECT MULTIUNIT ORDER. OCC - THIS DOCUMENT IS ACCEPTED BASED ON THE DATA SUBMITTED NEITHER THE FINAL LOCATION EXCEPTION NOR THE FINAL MULTIUNIT ORDERS HAVE BEEN ISSUED.

**Lateral Holes**

Sec: 2 TWP: 6N RGE: 2W County: MCCLAIN

SW SW SW SE

66 FSL 2612 FEL of 1/4 SEC

Depth of Deviation: 6721 Radius of Turn: 382 Direction: 180 Total Length: 10178

Measured Total Depth: 17182 True Vertical Depth: 7384 End Pt. Location From Release, Unit or Property Line: 66

**FOR COMMISSION USE ONLY**

1141405

Status: Accepted

API NO. 087-22133  
OTC PROD. UNIT NO. 087-224429

(PLEASE TYPE OR USE BLACK INK ONLY)

OKLAHOMA CORPORATION COMMISSION

Oil & Gas Conservation Division

Post Office Box 52000

Oklahoma City, Oklahoma 73152-2000

Rule 165:10-3-25

COMPLETION REPORT

RECEIVED  
NOV 30 2018  
Oklahoma Corporation  
Commission

Form 1002A

Rev. 2009

☒ ORIGINAL  
☐ AMENDED (Reason)

TYPE OF DRILLING OPERATION

☐ STRAIGHT HOLE ☐ DIRECTIONAL HOLE ☒ HORIZONTAL HOLE  
☐ SERVICE WELL

If directional or horizontal, see reverse for bottom hole location.

COUNTY MCCLAIN SEC 35 TWP 7N RGE 2W  
LEASE NAME LYNN 7N 2W 35 WELL NO. 1HX  
NW 1/4 NW 1/4 NW 1/4 NE 1/4 FNL OF 1/4 SEC 243 FEL OF 1/4 SEC 2,554  
ELEVATION 1,186 Ground 30 Latitude (if known) 35.04356389 Longitude (if known) 97.3796  
OPERATOR NAME BP AMERICA PRODUCTION COMPANY OTC/OCC OPERATOR NO. 1640  
ADDRESS 1100 N BROADWAY AVE, STE 200  
CITY OKLAHOMA CITY STATE OK ZIP 73103

SPUD DATE 05/31/2018  
DRLG FINISHED DATE 7/30/2018  
DATE OF WELL COMPLETION 9/18/18  
1st PROD DATE 9/18/18  
RECOMP DATE  
Longitude (if known) 97.3796

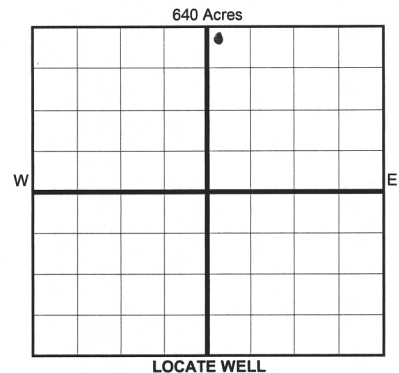

COMPLETION TYPE

☒ SINGLE ZONE  
☐ MULTIPLE ZONE  
Application Date  
COMINGLED  
Application Date  
LOCATION EXCEPTION ORDER NO. 683027  
INCREASED DENSITY ORDER NO. 683028 (MU)

CASING & CEMENT (Form 1002C must be attached)

TYPE	SIZE	WEIGHT	GRADE	FEET	PSI	SAX	TOP OF CMT
CONDUCTOR							
SURFACE	13 3/8	J-55	54.5	668		670	SURFACE
INTERMEDIATE	9 5/8	HCP-110	40	6,321		375	4,242
PRODUCTION							
LINER	5 1/2	P-110	20	6095	11,087	2,050	6,095
						TOTAL DEPTH	17,182

PACKER @ BRAND & TYPE  
PACKER @ BRAND & TYPE

PLUG @ TYPE  
PLUG @ TYPE  
PLUG @ TYPE

COMPLETION & TEST DATA BY PRODUCING FORMATION

FORMATION	WOODFORD	319 WDFD	
SPACING & SPACING ORDER NUMBER	659503 (640)	683028 (Multunit)	Reported to FracFocus
CLASS: Oil, Gas, Dry, Inj, Disp, Comm Disp, Svc	OIL		
	7,556		
PERFORATED INTERVALS	17,060		
ACID/VOLUME	78,750 GALS		
	479,719 GALS		
FRACTURE TREATMENT (Fluids/Prop Amounts)	21,003,682 LBS	PROPPANT	

Min Gas Allowable (165:10-17-7)

Gas Purchaser/Measurer

☐

OR

First Sales Date

Oil Allowable (165:10-13-3)

INITIAL TEST DATA

INITIAL TEST DATE	9/19/2018
OIL-BBL/DAY	238
OIL-GRAVITY ( API)	44
GAS-MCF/DAY	225 MCFDD
GAS-OIL RATIO CU FT/BBL	945
WATER-BBL/DAY	2,129 BPD
PUMPING OR FLOWING	FLOWING
INITIAL SHUT-IN PRESSURE	1,000
CHOKE SIZE	36
FLOW TUBING PRESSURE	446 PSI

AS SUBMITTED

A record of the formations drilled through, and pertinent remarks are presented on the reverse. I declare that I have knowledge of the contents of this report and am authorized by my organization to make this report, which was prepared by me or under my supervision and direction, with the data and facts stated herein to be true, correct, and complete to the best of my knowledge and belief.

HEATHER HUBER

11/28/2018

405-401-0927

SIGNATURE

NAME (PRINT OR TYPE)

DATE

PHONE NUMBER

1100 N BROADWAY AVE, STE 200

OKLAHOMA CITY

OK

73103

HEATHER.HUBER@BPX.COM

ADDRESS

CITY

STATE

ZIP

EMAIL ADDRESS

Give formation names and tops, if available, or descriptions and thickness of formations drilled through. Show intervals cored or drillstem tested.

WELL NO. \_\_\_\_\_

Were open hole logs run?           yes    X no

Date Last log was run      \_\_\_\_\_

Was CO<sub>2</sub> encountered?           yes    X no    at what depths? \_\_\_\_\_

Was H<sub>2</sub>S encountered?           yes    X no    at what depths? \_\_\_\_\_

Were unusual drilling circumstances encountered?           yes    X no

If yes, briefly explain below

Other remarks:	

LATERAL #3						
SEC	TWP	RGE	COUNTY			
Spot Location						
1/4	1/4	1/4	Feet From 1/4 Sec Lines	FSL	FWL	
Depth of Deviation		Radius of Turn	Direction	Total Length		
Measured Total Depth		True Vertical Depth	BHL From Lease, Unit, or Property Line:			

640 Acres