

Oklahoma Corporation Commission
Oil & Gas Conservation Division
Post Office Box 52000
Oklahoma City, Oklahoma 73152-2000
Rule 165: 10-3-25

Form 1002A

API No.: 35043237040000

Completion Report

Spud Date: June 22, 2019

OTC Prod. Unit No.: 043-227297-0-0000

Drilling Finished Date: August 21, 2019

1st Prod Date: June 13, 2021

Completion Date: June 13, 2021

Drill Type: HORIZONTAL HOLE

Min Gas Allowable: Yes

Well Name: ALVADEAN 14-23-1XH

Purchaser/Measurer:

Location: DEWEY 14 18N 14W
SE NE NE NW
650 FNL 2350 FWL of 1/4 SEC
Latitude: 36.04172458 Longitude: -98.66392989
Derrick Elevation: 0 Ground Elevation: 0

First Sales Date: 06/13/2021

Operator: DERBY EXPLORATION LLC 24143
PO BOX 779
100 PARK AVE STE 400
OKLAHOMA CITY, OK 73101-0779

Completion Type	
X	Single Zone
	Multiple Zone
	Commingled

Location Exception
Order No
720010

Increased Density
Order No
There are no Increased Density records to display.

Casing and Cement							
Type	Size	Weight	Grade	Feet	PSI	SAX	Top of CMT
SURFACE	13.375	54.5	J-55	560		535	SURFACE
INTERMEDIATE	9.625	42	HCP P-110	8660		830	5616
PRODUCTION	5.5	23	P-110 ICY	19656		2685	8456

Liner								
Type	Size	Weight	Grade	Length	PSI	SAX	Top Depth	Bottom Depth
There are no Liner records to display.								

Total Depth: 19656

Packer	
Depth	Brand & Type
There are no Packer records to display.	

Plug	
Depth	Plug Type
There are no Plug records to display.	

Initial Test Data

Test Date	Formation	Oil BBL/Day	Oil-Gravity (API)	Gas MCF/Day	Gas-Oil Ratio Cu FT/BBL	Water BBL/Day	Pumpin or Flowing	Initial Shut-In Pressure	Choke Size	Flow Tubing Pressure
Jun 28, 2021	MISSISSIPPIAN	116	51	1923	16578	1371	FLOWING	1900	30/64	1170

Completion and Test Data by Producing Formation	
Formation Name: MISSISSIPPIAN	Code: 359MSSP
Class: GAS	

Spacing Orders	
Order No	Unit Size
685492	640
687568	640
720009	MULTIUNIT

Perforated Intervals	
From	To
10267	14411
14447	19469

Acid Volumes
287,872 GALLONS 7.5%
3,948 GALLONS 15.0%

Fracture Treatments
3,406,459 POUNDS 30/50 SAND
15,046,911 POUNDS 40/70 SAND
17,091,102 GALLONS SLICKWATER

Formation	Top
VERDIGRIS	8361
PINK LIME	8467
INOLA	8635
CHESTER	9156

Were open hole logs run? No

Date last log run:

Were unusual drilling circumstances encountered? No

Explanation:

Other Remarks
There are no Other Remarks.

Lateral Holes
Sec: 23 TWP: 18N RGE: 14W County: DEWEY SW SE SE SW 50 FSL 1996 FWL of 1/4 SEC Depth of Deviation: 9650 Radius of Turn: 14 Direction: 179 Total Length: 9356 Measured Total Depth: 19656 True Vertical Depth: 10242 End Pt. Location From Release, Unit or Property Line: 50

FOR COMMISSION USE ONLY	
Status: Accepted	1146666

API NO. 35-043-23704
OTC PROD. UNIT NO. 043-227297

Oil and Gas Conservation Division
P.O. Box 52000
Oklahoma City, OK 73152-2000
405-522-0577
OCCCentralProcessing@OCC.OK.GOV



OKLAHOMA
Corporation
Commission

RECEIVED

Form 1002A
Rev. 2020

JUL 19 2021

ORIGINAL
AMENDED (Reason)

Rule 165:10-3-25

COMPLETION REPORT

OKLAHOMA CORPORATION
COMMISSION

TYPE OF DRILLING OPERATION

☐ STRAIGHT HOLE ☐ DIRECTIONAL HOLE ☒ HORIZONTAL HOLE

If directional or horizontal, see reverse for bottom hole location.

COUNTY	Dewey	SEC	14	TWP	18N	RGE	14W
LEASE NAME	Alvadean			WELL NO.	14-23-1XH		
SE 1/4 NE 1/4 NE 1/4 NW 1/4	FNL	650	FWL	2350	1st PROD DATE	6/13/21	
ELEVATION	Ground	Latitude	36.0472458		Longitude	-98.66392889	
OPERATOR NAME	Derby Exploration, LLC			OTC / OCC OPERATOR NO.	24143 0		
ADDRESS	PO BOX 779						
CITY	OKC	STATE	OK	ZIP	73101		

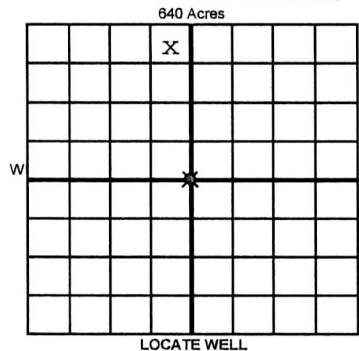

COMPLETION TYPE

<input checked="" type="radio"/> SINGLE ZONE	
<input type="radio"/> MULTIPLE ZONE	
<input type="radio"/> COMMINGLED	
LOCATION EXCEPTION ORDER NO.	720010FO
MULTIUNIT ORDER NO.	201901379 688431 FO
INCREASED DENSITY ORDER NO.	720009 FO

CASING & CEMENT (Attach Form 1002C)

TYPE	SIZE	WEIGHT	GRADE	FEET	PSI	SAX	TOP OF CMT
CONDUCTOR							
SURFACE	13.375	54.5	J-55	560		535	Surface
INTERMEDIATE	9.625	40	HCP P-110	8660		830	5616
PRODUCTION	5.5	23	P-110 ICY	19656		2685	8456
LINER							

PACKER @ BRAND & TYPE PLUG @ TYPE PLUG @ TYPE TOTAL DEPTH 19656

COMPLETION & TEST DATA BY PRODUCING FORMATION

FORMATION	Mississippian						
SPACING & SPACING ORDER NUMBER	(640)685492, (640)687568			720009 (Multiunit)			Reported to Fine Focus
CLASS: Oil, Gas, Dry, Inj, Disp, Comm Disp, Svc	Gas						
PERFORATED INTERVALS	10267	14411					
	14447	19469					
ACID/VOLUME	7.5% 287872 GAL	15.0% 3948 GAL					
FRACTURE TREATMENT (Fluids/Prop Amounts)	30/50 (lb): 3406459	40/70 (lb): 15046911	Slickwater: 17091102 (gal)				

☒ Min Gas Allowable (165:10-17-7)
OR
☐ Oil Allowable (165:10-13-3)

Purchaser/Measurer
First Sales Date 6/13/21

INITIAL TEST DATA

INITIAL TEST DATE	6/28/21					
OIL-BBL/DAY	116					
OIL-GRAVITY (API)	51					
GAS-MCF/DAY	1923					
GAS-OIL RATIO CU FT/BBL	16578					
WATER-BBL/DAY	1371					
PUMPING OR FLOWING	Flowing					
INITIAL SHUT-IN PRESSURE	1900					
CHOKE SIZE	30/64					
FLOW TUBING PRESSURE	1170					

A record of the formations drilled through, and pertinent remarks are presented on the reverse. I declare that I have knowledge of the contents of this report and am authorized by my organization to make this report, which was prepared by me or under my supervision and direction, with the data and facts stated herein to be true, correct, and complete to the best of my knowledge and belief.

SIGNATURE	Shellee Kennedy	DATE	7/19/21	PHONE NUMBER	405-202-4535
PO BOX 779	OKC	OK	73101	skennedy@derbyenergy.com	
ADDRESS	CITY	STATE	ZIP	EMAIL ADDRESS	

PLEASE TYPE OR USE BLACK INK ONLY
FORMATION RECORD

Give formation names and tops, if available, or descriptions and thickness of formations drilled through. Show intervals cored or drillstem tested.

NAMES OF FORMATIONS	TOP
Verdigris	8361
Pink Lime	8467
Inola	8635
Chester	9156

LEASE NAME _____ WELL NO. _____

FOR COMMISSION USE ONLY	
ITD on file	<input type="checkbox"/> YES <input type="checkbox"/> NO
APPROVED	DISAPPROVED
2) Reject Codes	

Were open hole logs run?	<input type="radio"/> yes <input checked="" type="radio"/> no
Date Last log was run	_____
Was CO ₂ encountered?	<input type="radio"/> yes <input checked="" type="radio"/> no at what depths? _____
Was H ₂ S encountered?	<input type="radio"/> yes <input checked="" type="radio"/> no at what depths? _____
Were unusual drilling circumstances encountered? If yes, briefly explain below	<input type="radio"/> yes <input checked="" type="radio"/> no

Other remarks: _____

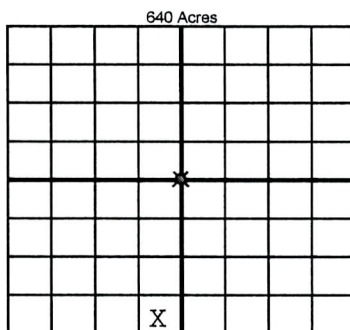

If more than three drainholes are proposed, attach a separate sheet indicating the necessary information.

Direction must be stated in degrees azimuth.
Please note, the horizontal drainhole and its end point must be located within the boundaries of the lease or spacing unit.

Directional surveys are required for all drainholes and directional wells

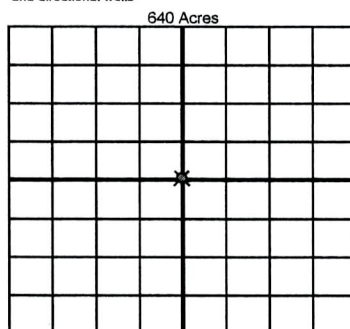

BOTTOM HOLE LOCATION FOR DIRECTIONAL HOLE

SEC	TWP	RGE	COUNTY
1/4	1/4	1/4	1/4
Measured Total Depth		True Vertical Depth	BHL From Lease, Unit, or Property Line:

BOTTOM HOLE LOCATION FOR HORIZONTAL HOLE: (LATERALS)

LATERAL #1			
SEC	TWP	RGE	COUNTY
23	18N	14W	Dewey
SW 1/4	SE 1/4	SE 1/4	SW 1/4
Depth of Deviation 9650		Radius of Turn 14.15/100'	Direction 179.180
Measured Total Depth 19656		True Vertical Depth 10242	Total Length 9356
		BHL From Lease, Unit, or Property Line: 50 FSL	

LATERAL #2			
SEC	TWP	RGE	COUNTY
1/4	1/4	1/4	1/4
Depth of Deviation		Radius of Turn	Direction
Measured Total Depth		True Vertical Depth	Total Length
		BHL From Lease, Unit, or Property Line:	

LATERAL #3			
SEC	TWP	RGE	COUNTY
1/4	1/4	1/4	1/4
Depth of Deviation		Radius of Turn	Direction
Measured Total Depth		True Vertical Depth	Total Length
		BHL From Lease, Unit, or Property Line:	