

Oklahoma Corporation Commission
Oil & Gas Conservation Division
Post Office Box 52000
Oklahoma City, Oklahoma 73152-2000
Rule 165: 10-3-25

Form 1002A

API No.: 35087223010001

Completion Report

Spud Date: November 27, 2020

OTC Prod. Unit No.: 087-227121-0-0000

Drilling Finished Date: February 08, 2021

1st Prod Date: March 30, 2021

Completion Date: March 30, 2021

Drill Type: HORIZONTAL HOLE

Min Gas Allowable: Yes

Well Name: COLE FARMS 0916 6H

Purchaser/Measurer: ENABLE GATHERING AND
PROCESSING

First Sales Date: 03/30/2021

Location: MCCLAIN 16 7N 4W
SE NE SW SE
717 FSL 1500 FEL of 1/4 SEC
Latitude: 35.075228 Longitude: -97.622431
Derrick Elevation: 0 Ground Elevation: 1265

Operator: EOG RESOURCES INC 16231

14701 HERTZ QUAIL SPRINGS PKWY
OKLAHOMA CITY, OK 73134-2646

Completion Type		Location Exception		Increased Density	
X	Single Zone	Order No		Order No	
	Multiple Zone	719923		707887	
	Commingled			715436	
				707888	
				715304	

Casing and Cement							
Type	Size	Weight	Grade	Feet	PSI	SAX	Top of CMT
SURFACE	9 5/8	36	J-55	993		350	SURFACE
PRODUCTION	5 1/2	20	P-110	20365		2060	SURFACE

Liner								
Type	Size	Weight	Grade	Length	PSI	SAX	Top Depth	Bottom Depth
There are no Liner records to display.								

Total Depth: 20375

Packer		Plug	
Depth	Brand & Type	Depth	Plug Type
There are no Packer records to display.		There are no Plug records to display.	

Initial Test Data

Test Date	Formation	Oil BBL/Day	Oil-Gravity (API)	Gas MCF/Day	Gas-Oil Ratio Cu FT/BBL	Water BBL/Day	Pumpin or Flowing	Initial Shut- In Pressure	Choke Size	Flow Tubing Pressure
May 14, 2021	WOODFORD	353	40	599	1697	477	FLOWING	1470	128	244

Completion and Test Data by Producing Formation										
Formation Name: WOODFORD				Code: 319WDFD			Class: OIL			
Spacing Orders				Perforated Intervals						
Order No		Unit Size		From			To			
673630		640		11262			16423			
676420		640		16434			19171			
719976		MULTIUNIT								
Acid Volumes				Fracture Treatments						
2,000 GALLONS 7.5% HCL				17,586,954 GALLONS TOTAL FLUID, 19,807,440 POUNDS TOTAL PROPPANT						

Formation	Top
WOODFORD	10533

Were open hole logs run? No
Date last log run:

Were unusual drilling circumstances encountered? No
Explanation:

Other Remarks
There are no Other Remarks.

Lateral Holes
Sec: 9 TWP: 7N RGE: 4W County: MCCLAIN NW NW SW NE 1349 FNL 2369 FEL of 1/4 SEC Depth of Deviation: 9850 Radius of Turn: 1393 Direction: 355 Total Length: 9132 Measured Total Depth: 20375 True Vertical Depth: 10140 End Pt. Location From Release, Unit or Property Line: 1349

FOR COMMISSION USE ONLY
<div>Status: Accepted</div> <div>1146509</div>

API NO. 087-22301
OTC PROD. UNIT NO. 087-227121

Oil and Gas Conservation Division
P.O. Box 52000
Oklahoma City, OK 73152-2000
405-522-0577
OCCCentralProcessing@OCC.OK.GOV



OKLAHOMA
Corporation
Commission

Form 1002A
Rev. 2020

ORIGINAL
AMENDED (Reason)

Rule 165:10-3-25

COMPLETION REPORT

TYPE OF DRILLING OPERATION

☐ STRAIGHT HOLE ☐ DIRECTIONAL HOLE ☒ HORIZONTAL HOLE
☐ SERVICE WELL

If directional or horizontal, see reverse for bottom hole location.

COUNTY	MCCLAIR	SEC	16	TWP	7N	RGE	4W
LEASE NAME	COLE FARMS 0916			WELL NO.	6H		
SE 1/4 NE 1/4 SW 1/4 SE 1/4	FSL 717			FEL	1500		
ELEVATION	Ground	1265	Latitude	35.075228		Longitude	-97.622431
OPERATOR NAME	EOG RESOURCES, INC.			OTC / OCC OPERATOR NO.	16231		
ADDRESS	14701 HERTZ QUAIL SPRINGS PARKWAY						
CITY	OKLAHOMA CITY		STATE	OKLAHOMA		ZIP	73134

SPUD DATE 11/27/2020

DRLG FINISHED DATE 2/8/2021

DATE OF WELL COMPLETION 3/30/2021

1st PROD DATE 3/30/2021

RECOMP DATE

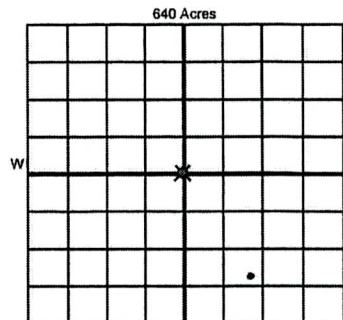

LOCATE WELL

COMPLETION TYPE

<input checked="" type="radio"/> SINGLE ZONE	
<input type="radio"/> MULTIPLE ZONE	
<input type="radio"/> COMINGLED	
LOCATION EXCEPTION ORDER NO.	707888, 715312
MULTIUNIT ORDER NO.	708060, 715706
INCREASED DENSITY ORDER NO.	707887, 715436, 707888, 715304

CASING & CEMENT (Attach Form 1002C)

TYPE	SIZE	WEIGHT	GRADE	FEET	PSI	SAX	TOP OF CMT
CONDUCTOR							
SURFACE	9-5/8	36	J55	993		350	SURFACE
INTERMEDIATE							
PRODUCTION	5-1/2	20	P110	20365		2060	SURFACE
LINER							20375

PACKER @ BRAND & TYPE PLUG @ TYPE PLUG @ TYPE PLUG @ TYPE TOTAL DEPTH

COMPLETION & TEST DATA BY PRODUCING FORMATION

FORMATION	WOODFORD
SPACING & SPACING ORDER NUMBER	640/673630, 676420
CLASS: Oil, Gas, Dry, Inj, Disp, Comm Disp, Svc	Oil
PERFORATED INTERVALS	11262 - 19171
ACID/VOLUME	2000 GALS 7.5% HCL
FRACTURE TREATMENT (Fluids/Prop Amounts)	TOTAL FLUID - 17,586,954 GALS TOTAL PROP - 19,807,440 LBS

Min Gas Allowable (165:10-17-7)



OR

Oil Allowable (165:10-13-3)

Purchaser/Measurer

First Sales Date

Enable Gathering and Processing

03/30/2021

INITIAL TEST DATA

INITIAL TEST DATE	5/14/2021
OIL-BBL/DAY	353
OIL-GRAVITY (API)	40
GAS-MCF/DAY	599
GAS-OIL RATIO CU FT/BBL	1697
WATER-BBL/DAY	477
PUMPING OR FLOWING	FLOWING
INITIAL SHUT-IN PRESSURE	1470
CHOKE SIZE	128
FLOW TUBING PRESSURE	244

RECEIVED

JUN 02 2021

OKLAHOMA CORPORATION
COMMISSION

A record of the formations drilled through, and pertinent remarks are presented on the reverse. I declare that I have knowledge of the contents of this report and am authorized by my organization to make this report, which was prepared by me or under my supervision and direction, with the data and facts stated herein to be true, correct, and complete to the best of my knowledge and belief.

Joni Reeder
SIGNATURE
14701 Hertz Quail Springs Pkwy
ADDRESS
Oklahoma City
CITY
OK
STATE
73134
ZIP
5/28/2021
DATE
405-246-3100
PHONE NUMBER
joni_reeder@eogresources.com
EMAIL ADDRESS

PLEASE TYPE OR USE BLACK INK ONLY
FORMATION RECORD

Give formation names and tops, if available, or descriptions and thickness of formations drilled through. Show intervals cored or drillstem tested.

NAMES OF FORMATIONS	TOP
WOODFORD	10533

LEASE NAME COLE FARMS 0916 WELL NO. 6H

FOR COMMISSION USE ONLY	
ITD on file	<input type="checkbox"/> YES <input type="checkbox"/> NO
APPROVED	DISAPPROVED
2) Reject Codes	

Were open hole logs run?	<input type="radio"/> yes <input checked="" type="radio"/> no
Date Last log was run	
Was CO ₂ encountered?	<input type="radio"/> yes <input checked="" type="radio"/> no at what depths? <u> </u>
Was H ₂ S encountered?	<input type="radio"/> yes <input checked="" type="radio"/> no at what depths? <u> </u>
Were unusual drilling circumstances encountered?	<input type="radio"/> yes <input checked="" type="radio"/> no
If yes, briefly explain below	

Other remarks:

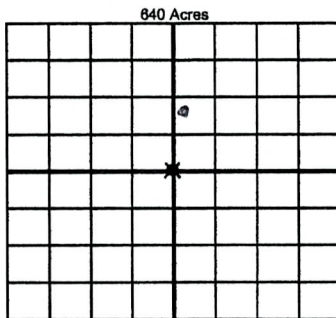

If more than three drainholes are proposed, attach a separate sheet indicating the necessary information.

Direction must be stated in degrees azimuth. Please note, the horizontal drainhole and its end point must be located within the boundaries of the lease or spacing unit.

Directional surveys are required for all drainholes and directional wells

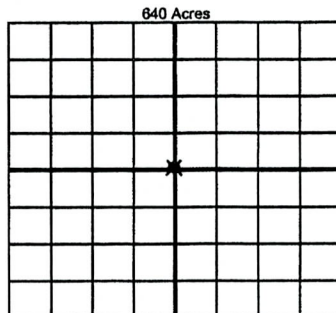

BOTTOM HOLE LOCATION FOR DIRECTIONAL HOLE

SEC	TWP	RGE	COUNTY
1/4	1/4	1/4	1/4
Measured Total Depth		True Vertical Depth	
BHL From Lease, Unit, or Property Line:			

BOTTOM HOLE LOCATION FOR HORIZONTAL HOLE: (LATERALS)

LATERAL #1			
SEC	TWP	RGE	COUNTY
9	7N	4W	MCCLAIN <u>B349</u>
NW 1/4	NW 1/4	SW 1/4	NE 1/4
Depth of Deviation		Radius of Turn	
Measured Total Depth		True Vertical Depth	
20375		10140	
Feet From 1/4 Sec Lines		FNL 1351 FEL 2369	
Direction 355 <u>OK</u>		Total Length 9132	
BHL From Lease, Unit, or Property Line:		1349 1351	

LATERAL #2			
SEC	TWP	RGE	COUNTY
1/4	1/4	1/4	1/4
Depth of Deviation		Radius of Turn	
Measured Total Depth		True Vertical Depth	
Feet From 1/4 Sec Lines		Total Length	
BHL From Lease, Unit, or Property Line:			

LATERAL #3			
SEC	TWP	RGE	COUNTY
1/4	1/4	1/4	1/4
Depth of Deviation		Radius of Turn	
Measured Total Depth		True Vertical Depth	
Feet From 1/4 Sec Lines		Total Length	
BHL From Lease, Unit, or Property Line:			