

Oklahoma Corporation Commission
Oil & Gas Conservation Division
Post Office Box 52000
Oklahoma City, Oklahoma 73152-2000
Rule 165: 10-3-25

Form 1002A

API No.: 35083244500000

Completion Report

Spud Date: April 28, 2019

OTC Prod. Unit No.: 083-225678 & 109-225678

Drilling Finished Date: May 13, 2019

1st Prod Date: June 30, 2019

Completion Date: June 19, 2019

Drill Type: HORIZONTAL HOLE

Min Gas Allowable: Yes

Well Name: THE MOUNTAIN 1504 33-04 2BH

Purchaser/Measurer: SUPERIOR PIPELINE

Location: LOGAN 33 15N 4W
NW SW NW SW
1705 FSL 282 FWL of 1/4 SEC
Latitude: 35.73053978 Longitude: -97.6372357
Derrick Elevation: 1130 Ground Elevation: 1112

First Sales Date: 07/06/2019

Operator: REVOLUTION RESOURCES LLC 24162

14301 CALIBER DR STE 110
OKLAHOMA CITY, OK 73134-1016

Completion Type		Location Exception		Increased Density	
X	Single Zone	Order No		Order No	
	Multiple Zone	There are no Location Exception records to display.		There are no Increased Density records to display.	
	Commingled				

Casing and Cement							
Type	Size	Weight	Grade	Feet	PSI	SAX	Top of CMT
CONDUCTOR	20	94	J-55	98			SURFACE
SURFACE	9.625	36	J-55	822		370	SURFACE
PRODUCTION	7	29	P-110	7252		584	2775

Liner								
Type	Size	Weight	Grade	Length	PSI	SAX	Top Depth	Bottom Depth
LINER	4.5	13.5	P-110	7824	0	0	7181	15005

Total Depth: 15445

Packer	
Depth	Brand & Type
There are no Packer records to display.	

Plug	
Depth	Plug Type
There are no Plug records to display.	

Initial Test Data

Test Date	Formation	Oil BBL/Day	Oil-Gravity (API)	Gas MCF/Day	Gas-Oil Ratio Cu FT/BBL	Water BBL/Day	Pumpin or Flowing	Initial Shut-In Pressure	Choke Size	Flow Tubing Pressure
Jul 03, 2019	HUNTON	305	40	560	1836	620	PUMPING			

Completion and Test Data by Producing Formation

Formation Name: HUNTON

Code: 269HNTN

Class: OIL

Spacing Orders

Order No	Unit Size
20212	UNIT

Perforated Intervals

From	To
There are no Perf. Intervals records to display.	

Acid Volumes

174,720 GALLONS ACID, 55,312 BARRELS WATER
--

Fracture Treatments

There are no Fracture Treatments records to display.
--

Formation	Top
OSWEGO	6233
BARTLESVILLE	6479
WOODFORD	6645
HUNTON	6695

Were open hole logs run? No

Date last log run:

Were unusual drilling circumstances encountered? No

Explanation:

Other Remarks

OCC - CORRECTION SHOW 2ND PUN #. THIS WELL IS AN OPEN HOLE COMPLETION FROM THE BOTTOM OF THE 7" CASING AT 7,252' TO TOTAL DEPTH AT 15,445'. THE 4-1/2" LINER IS NOT CEMENTED.

Lateral Holes

Sec: 9 TWP: 14N RGE: 4W County: OKLAHOMA

SW SW NE NW

1470 FSL 1450 FWL of 1/4 SEC

Depth of Deviation: 6188 Radius of Turn: 1093 Direction: 175 Total Length: 8261

Measured Total Depth: 15445 True Vertical Depth: 6739 End Pt. Location From Release, Unit or Property Line: 6670

FOR COMMISSION USE ONLY

Status: Accepted

1143663

API NO. 083-24450
OTC PROD. UNIT NO. 24162

(PLEASE TYPE OR USE BLACK INK ONLY)

OKLAHOMA CORPORATION COMMISSION
Oil & Gas Conservation Division
Post Office Box 52000
Oklahoma City, Oklahoma 73152-2000
Rule 165-10-3-25

RECEIVED
AUG 8 2019
Oklahoma Corporation
Commission

Form 1002A
Rev. 2009

☒ ORIGINAL
☐ AMENDED (Reason)

COMPLETION REPORT

TYPE OF DRILLING OPERATION

☐ STRAIGHT HOLE ☐ DIRECTIONAL HOLE ☒ HORIZONTAL HOLE
☐ SERVICE WELL

If directional or horizontal, see reverse for bottom hole location.

COUNTY LOGAN SEC 33 TWP 15N RGE 4W
LEASE NAME THE MOUNTAIN 1504 33-04 WELL NO. 2BH
NW 1/4 SW 1/4 NW 1/4 SW 1/4 FSL OF 1/4 SEC 1705' FWL OF 1/4 SEC 282'
ELEVATION Derrick FL 1130' Ground 1112' Latitude (if known) 35.73053978 Longitude (if known) -97.6372357
OPERATOR NAME REVOLUTION RESOURCES LLC OTC/OCC OPERATOR NO. 24162
ADDRESS 14301 CALIBER DR SUITE 110
CITY OKLAHOMA CITY STATE OK ZIP 73134

SPUD DATE 4/28/2019
DRLG FINISHED DATE 5/13/2019
DATE OF WELL COMPLETION 6/19/2019
1st PROD DATE 6/30/2019
RECOMP DATE

640 Acres
LOCATE WELL

COMPLETION TYPE

☒ SINGLE ZONE
☐ MULTIPLE ZONE
Application Date
COMINGLED
Application Date
LOCATION EXCEPTION
ORDER NO.
INCREASED DENSITY
ORDER NO.

CASING & CEMENT (Form 1002C must be attached)

TYPE	SIZE	WEIGHT	GRADE	FEET	PSI	SAX	TOP OF CMT
CONDUCTOR	20	94	J-55	98'			SURF
SURFACE	9.625	36	J-55	822'		370	SURF
INTERMEDIATE	7	29	P-110	7252'		280 584	2775 CALC
PRODUCTION							
LINER	4.5	13.5	P-110	7181'-15005'	OPEN	HOLE	NA
TOTAL DEPTH							15445'

PACKER @ BRAND & TYPE

PACKER @ BRAND & TYPE

PLUG @

TYPE

PLUG @

TYPE

TOTAL DEPTH

COMPLETION & TEST DATA BY PRODUCING FORMATION

FORMATION HUNTON
SPACING & SPACING ORDER NUMBER 20212 (unit)
CLASS: Oil, Gas, Dry, Inj, Disp, Comm Disp, Svc OIL
PERFORATED INTERVALS OPENHOLE
COMPLETION
ACID/VOLUME 174,720 GAL ACID
55,312 BBLS WATER
FRACTURE TREATMENT (Fluids/Prop Amounts)

Min Gas Allowable (165-10-17-7)

☒

OR

Oil Allowable (165-10-13-3)

Gas Purchaser/Measurer
First Sales Date

Superior Pipeline
7/6/2019

INITIAL TEST DATA

INITIAL TEST DATE 7/3/2019
OIL-BBL/DAY 305
OIL-GRAVITY (API) 40
GAS-MCF/DAY 560
GAS-OIL RATIO CU FT/BBL 1836
WATER-BBL/DAY 620
PUMPING OR FLOWING PUMPING
INITIAL SHUT-IN PRESSURE
CHOKE SIZE
FLOW TUBING PRESSURE

AS SUBMITTED

A record of the formations drilled through, and pertinent remarks are presented on the reverse. I declare that I have knowledge of the contents of this report and am authorized by my organization to make this report, which was prepared by me or under my supervision and direction, with the data and facts stated herein to be true, correct, and complete to the best of my knowledge and belief.

JUSTIN LUNDQUIST

7/25/2019

405-256-4393

SIGNATURE

NAME (PRINT OR TYPE)

DATE

PHONE NUMBER

14301 Caliber Dr. Suite 110

Oklahoma City

OK

73134

JustinL@revolutionresources.com

ADDRESS

CITY

STATE

ZIP

EMAIL ADDRESS

Give formation names and tops, if available, or descriptions and thickness of formations drilled through. Show intervals cored or drillstem tested.

WELL NO. 33-04 2BH

FOR COMMISSION USE ONLY	
ITD on file	<input type="checkbox"/> YES <input type="checkbox"/> NO
APPROVED	DISAPPROVED
	2) Reject Codes <hr/> <hr/> <hr/> <hr/> <hr/>

Were open hole logs run? yes X no

Date Last log was run _____

Was CO₂ encountered? yes X no at what depths? _____

Was H₂S encountered? yes X no at what depths? _____

Were unusual drilling circumstances encountered? yes X no

If yes, briefly explain below

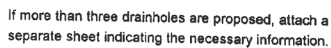

Direction must be stated in degrees azimuth.
Please note, the horizontal drainhole and its end point must be located within the boundaries of the lease or spacing unit.

Directional surveys are required for all drainholes and directional wells.

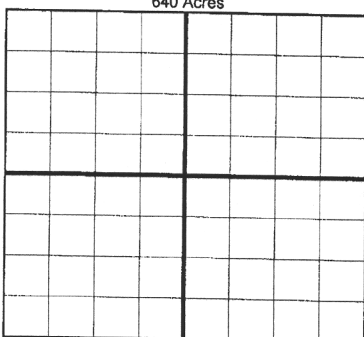

SEC	TWP	RGE	COUNTY			
Spot Location			Feet From 1/4 Sec Lines		FSL	FWL
1/4	1/4	1/4	1/4			
Measured Total Depth		True Vertical Depth		BHL From Lease, Unit, or Property Line:		

LATERAL #1											
SEC	09	TWP	14N	RGE	04W	COUNTY OKLAHOMA					
Spot Location						Feet From 1/4 Sec Lines		FSL	1470'	FWL	1450'
SW 1/4		SW 1/4		NE 1/4		NW 1/4					
Depth of Deviation				Radius of Turn		Direction		Total Length			
1618'				1093'		175 AZM		8261'			
Measured Total Depth				True Vertical Depth		BHL From Lease, Unit, or Property Line:					
15,445'				6739'		6670' FROM UNIT BOUNDARY					

SEC	TWP	RGE	COUNTY			
Spot Location						
1/4	1/4	1/4	1/4	Feet From 1/4 Sec Lines	FSL	FWL
Depth of Deviation		Radius of Turn		Direction	Total Length	
Measured Total Depth		True Vertical Depth		BHL From Lease, Unit, or Property Line:		

SEC	TWP	RGE	COUNTY			
Spot Location						
1/4	1/4	1/4	1/4	Feet From 1/4 Sec Lines	FSL	FWL
Depth of Deviation		Radius of Turn		Direction	Total Length	
Measured Total Depth		True Vertical Depth		BHL From Lease, Unit, or Property Line:		