

Oklahoma Corporation Commission
Oil & Gas Conservation Division
Post Office Box 52000
Oklahoma City, Oklahoma 73152-2000
Rule 165: 10-3-25

Form 1002A

API No.: 35109224630000

Completion Report

Spud Date: April 07, 2019

OTC Prod. Unit No.: 109-225734-0-0000

Drilling Finished Date: April 26, 2019

1st Prod Date: June 04, 2019

Completion Date: May 06, 2019

Drill Type: HORIZONTAL HOLE

Min Gas Allowable: Yes

Well Name: THE HOUND 1404 32-08 2BH

Purchaser/Measurer: SUPERIOR PIPELINE

Location: OKLAHOMA 32 14N 4W
NE NW NW SW
2380 FSL 590 FWL of 1/4 SEC
Latitude: 35.645019054 Longitude: -97.6539967
Derrick Elevation: 1089 Ground Elevation: 1071

First Sales Date: 06/05/2019

Operator: REVOLUTION RESOURCES LLC 24162

14301 CALIBER DR STE 110
OKLAHOMA CITY, OK 73134-1016

Completion Type		Location Exception		Increased Density	
X	Single Zone	Order No		Order No	
	Multiple Zone	There are no Location Exception records to display.		There are no Increased Density records to display.	
	Commingled				

Casing and Cement							
Type	Size	Weight	Grade	Feet	PSI	SAX	Top of CMT
CONDUCTOR	20	94	J-55	98			SURFACE
SURFACE	9.625	36	J-55	844		370	SURFACE
PRODUCTION	7	29	P-110	7453		435	2530

Liner								
Type	Size	Weight	Grade	Length	PSI	SAX	Top Depth	Bottom Depth
LINER	4.5	13.5	P-110	9853	0	0	7387	17240

Total Depth: 17323

Packer	
Depth	Brand & Type
There are no Packer records to display.	

Plug	
Depth	Plug Type
There are no Plug records to display.	

Initial Test Data

Test Date	Formation	Oil BBL/Day	Oil-Gravity (API)	Gas MCF/Day	Gas-Oil Ratio Cu FT/BBL	Water BBL/Day	Pumpin or Flowing	Initial Shut-In Pressure	Choke Size	Flow Tubing Pressure
Jun 06, 2019	HUNTON	602	38	485	805	736	PUMPING			

Completion and Test Data by Producing Formation									
Formation Name: HUNTON				Code: 269HNTN			Class: OIL		
Spacing Orders				Perforated Intervals					
Order No		Unit Size		From			To		
20212		UNIT		There are no Perf. Intervals records to display.					
Acid Volumes				Fracture Treatments					
197,064 GALLONS ACID				66,162 BARRELS WATER					

Formation	Top
OSWEGO	6474
BARTLESVILLE	6730
WOODFORD	6806
HUNTON	6858

Were open hole logs run? No
Date last log run:

Were unusual drilling circumstances encountered? No
Explanation:

Other Remarks
THIS WELL IS AN OPEN HOLE COMPLETION FROM THE BOTTOM OF THE 7" CASING AT 7,453' TO TOTAL DEPTH AT 17,323'. THE 4-1/2" LINER IS NOT CEMENTED.

Lateral Holes
Sec: 8 TWP: 13N RGE: 4W County: OKLAHOMA NE SE SE NW 500 FSL 2410 FWL of 1/4 SEC Depth of Deviation: 6415 Radius of Turn: 1290 Direction: 174 Total Length: 9900 Measured Total Depth: 17323 True Vertical Depth: 7004 End Pt. Location From Release, Unit or Property Line: 1085

FOR COMMISSION USE ONLY
<div>Status: Accepted</div> <div>1143133</div>

API NO. 109-22463
OTC PROD. UNIT NO. ~~24162~~

(PLEASE TYPE OR USE BLACK INK ONLY)

OKLAHOMA CORPORATION COMMISSION

Oil & Gas Conservation Division

Post Office Box 52000

Oklahoma City, Oklahoma 73152-2000

Rule 165:10-3-25

RECEIVED

JUN 17 2019

OKLAHOMA CORPORATION COMMISSION

Form 1002A

Rev. 2009

☒ ORIGINAL
☐ AMENDED (Reason) _____

COMPLETION REPORT

TYPE OF DRILLING OPERATION

☐ STRAIGHT HOLE ☐ DIRECTIONAL HOLE ☒ HORIZONTAL HOLE
☐ SERVICE WELL

If directional or horizontal, see reverse for bottom hole location.

COUNTY OKLAHOMA SEC 32 TWP 14N RGE 4W
LEASE NAME THE HOUND 1404 32-08 WELL NO. 2BH
NE 1/4 NW 1/4 NW 1/4 SW 1/4 FSL OF 1/4 SEC 2380' FWL OF 1/4 SEC 590'
ELEVATION 1089' Ground 1071' Latitude (if known) 35.64501905 Longitude (if known) -97.6539967
OPERATOR NAME REVOLUTION RESOURCES LLC OTC/OCC OPERATOR NO. 24162
ADDRESS 14301 CALIBER DR SUITE 110
CITY OKLAHOMA CITY STATE OK ZIP 73134

SPUD DATE 4/7/2019
DRLG FINISHED DATE 4/26/2019
DATE OF WELL COMPLETION 5/6/2019
1st PROD DATE 6/4/2019
RECOMP DATE

640 Acres
W E
X
LOCATE WELL

COMPLETION TYPE

☒ SINGLE ZONE
☐ MULTIPLE ZONE
Application Date
COMINGLED
Application Date
LOCATION EXCEPTION
ORDER NO.
INCREASED DENSITY
ORDER NO.

CASING & CEMENT (Form 1002C must be attached)

TYPE	SIZE	WEIGHT	GRADE	FEET	PSI	SAX	TOP OF CMT
CONDUCTOR	20	94	J-55	98'			SURF
SURFACE	9.625	36	J-55	844'		370	SURF
INTERMEDIATE	7	29	P-110	7453'		435	2530 CALC
PRODUCTION							
LINER	4.5	13.5	P-110	7387'-17240'	OPEN	HOLE	NA
TOTAL DEPTH							17323'

PACKER @ _____ BRAND & TYPE _____

PACKER @ _____ BRAND & TYPE _____

PLUG @ _____

PLUG @ _____

TYPE _____

TYPE _____

PLUG @ _____

PLUG @ _____

TYPE _____

TYPE _____

TOTAL DEPTH

COMPLETION & TEST DATA BY PRODUCING FORMATION

FORMATION HUNTON
SPACING & SPACING ORDER NUMBER 20212 (unit)
CLASS: Oil, Gas, Dry, Inj, Disp, Comm Disp, Svc
OIL
PERFORATED INTERVALS OPENHOLE
COMPLETION
ACID/VOLUME 197,064 GAL ACID
FRACTURE TREATMENT (Fluids/Prop Amounts) 66,162 BBLS WATER

Min Gas Allowable

(165:10-17-7)

Gas Purchaser/Measurer

Superior Pipeline

☒

OR

First Sales Date

6/5/2019

INITIAL TEST DATA

Oil Allowable

(165:10-13-3)

INITIAL TEST DATE	6/6/2019
OIL-BBL/DAY	602
OIL-GRAVITY (API)	38
GAS-MCF/DAY	485
GAS-OIL RATIO CU FT/BBL	805
WATER-BBL/DAY	736
PUMPING OR FLOWING	PUMPING
INITIAL SHUT-IN PRESSURE	
CHOKE SIZE	
FLOW TUBING PRESSURE	

AS SUBMITTED

A record of the formations drilled through, and pertinent remarks are presented on the reverse. I declare that I have knowledge of the contents of this report and am authorized by my organization to make this report, which was prepared by me or under my supervision and direction, with the data and facts stated herein to be true, correct, and complete to the best of my knowledge and belief.

SIGNATURE JUSTIN LUNDQUIST 6/12/2019 405-256-4393
14301 Caliber Dr. Suite 110 Oklahoma City OK 73134
ADDRESS CITY STATE ZIP
JustinL@revolutionresources.com
EMAIL ADDRESS

PLEASE TYPE OR USE BLACK INK ONLY
FORMATION RECORD

Give formation names and tops, if available, or descriptions and thickness of formations drilled through. Show intervals cored or drillstem tested.

NAMES OF FORMATIONS	TOP
OSWEGO	6474'
BARTLESVILLE	6730'
WOODFORD	6806'
HUNTON	6858'

LEASE NAME THE HOUND 1404 32-08 WELL NO. 2BH

FOR COMMISSION USE ONLY

ITD on file ☐ YES ☐ NO

APPROVED _____ DISAPPROVED _____

2) Reject Codes

Were open hole logs run? _____ yes ☒ no

Date Last log was run _____

Was CO₂ encountered? _____ yes ☒ no at what depths? _____

Was H₂S encountered? _____ yes ☒ no at what depths? _____

Were unusual drilling circumstances encountered? _____ yes ☒ no

If yes, briefly explain below _____

Other remarks: This well is an openhole completion from the bottom of the 7" casing at ~~7387~~ ⁷⁴⁵³ to TD at 17,323'. The 4-1/2" liner is not cemented.

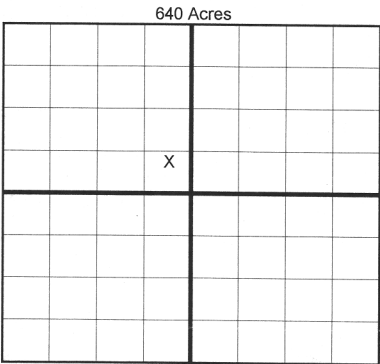

If more than three drainholes are proposed, attach a separate sheet indicating the necessary information.

Direction must be stated in degrees azimuth. Please note, the horizontal drainhole and its end point must be located within the boundaries of the lease or spacing unit.

Directional surveys are required for all drainholes and directional wells.

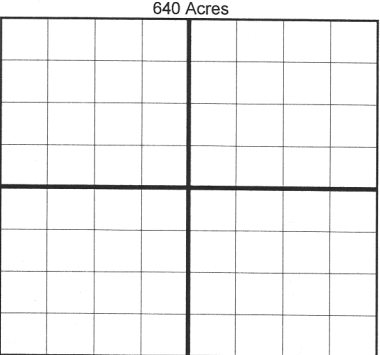

BOTTOM HOLE LOCATION FOR DIRECTIONAL HOLE

SEC	TWP	RGE	COUNTY
Spot Location	1/4	1/4	1/4
Measured Total Depth	True Vertical Depth	Feet From 1/4 Sec Lines	FSL FWL
BHL From Lease, Unit, or Property Line:			

BOTTOM HOLE LOCATION FOR HORIZONTAL HOLE: (LATERALS)

LATERAL #1

SEC	TWP	RGE	COUNTY
08	13N	04W	OKLAHOMA
Spot Location	NE 1/4	SE 1/4	SE 1/4 NW 1/4
Depth of Deviation	6415'	Radius of Turn	1290'
Measured Total Depth	17323'	Direction	174 AZM
True Vertical Depth		Total Length	9900'
BHL From Lease, Unit, or Property Line: 1085' FROM UNIT BOUNDARY			

LATERAL #2

SEC	TWP	RGE	COUNTY
Spot Location	1/4	1/4	1/4
Depth of Deviation	Radius of Turn	Direction	Total Length
Measured Total Depth	True Vertical Depth	BHL From Lease, Unit, or Property Line:	

LATERAL #3

SEC	TWP	RGE	COUNTY
Spot Location	1/4	1/4	1/4
Depth of Deviation	Radius of Turn	Direction	Total Length
Measured Total Depth	True Vertical Depth	BHL From Lease, Unit, or Property Line:	