

Oklahoma Corporation Commission
Oil & Gas Conservation Division
Post Office Box 52000
Oklahoma City, Oklahoma 73152-2000
Rule 165: 10-3-25

Form 1002A

API No.: 35019254690001

Completion Report

Spud Date: December 20, 2010

OTC Prod. Unit No.: 019-205624-0-0000

Drilling Finished Date: January 16, 2011

Amended

1st Prod Date: July 12, 2011

Amend Reason: RECOMPLETE / ADD PERFORATIONS

Completion Date: February 28, 2011

Recomplete Date: July 22, 2021

Drill Type: STRAIGHT HOLE

Min Gas Allowable: Yes

Well Name: CHATHAM 1-19

Purchaser/Measurer: TARGA

Location: CARTER 19 1S 2W
E2 W2 E2 SW
1320 FSL 1880 FWL of 1/4 SEC
Derrick Elevation: 997 Ground Elevation: 984

First Sales Date: 07/12/2011

Operator: TIGER OIL COMPANY LLC 24454

5713 NW 132ND ST
OKLAHOMA CITY, OK 73142-4437

Completion Type		Location Exception		Increased Density	
X	Single Zone	Order No		Order No	
	Multiple Zone	There are no Location Exception records to display.		There are no Increased Density records to display.	
	Commingled				

Casing and Cement							
Type	Size	Weight	Grade	Feet	PSI	SAX	Top of CMT
SURFACE	9 5/8	36	J-55	956		1170	SURFACE
PRODUCTION	5 1/2	17 & 15.5	N-80	8900		350	7420

Liner								
Type	Size	Weight	Grade	Length	PSI	SAX	Top Depth	Bottom Depth
There are no Liner records to display.								

Total Depth: 8704

Packer	
Depth	Brand & Type
7400	MODEL R
7401	MODEL R

Plug	
Depth	Plug Type
7510	BRP
8550	CIBP

Initial Test Data

Test Date	Formation	Oil BBL/Day	Oil-Gravity (API)	Gas MCF/Day	Gas-Oil Ratio Cu FT/BBL	Water BBL/Day	Pumpin or Flowing	Initial Shut-In Pressure	Choke Size	Flow Tubing Pressure
Jul 20, 2011	SYCAMORE	24	38	231	9625	14	FLOWING	650	18/64	210
Jul 22, 2021	SYCAMORE	0.1	36			55	PUMPING	800	OPEN	

Completion and Test Data by Producing Formation

Formation Name: SYCAMORE

Code: 352SCMR

Class: OIL

Spacing Orders

Order No	Unit Size
580767	640

Perforated Intervals

From	To
7471	7481
7520	7536
7550	7556
7598	7615

Acid Volumes

2,500 GALLONS 15% HCL

Fracture Treatments

SLICKWATER, 40/70, 5 POUNDS 100 MESH

Formation Name: SYCAMORE

Code: 352SCMR

Class: OIL

Spacing Orders

Order No	Unit Size
580767	640

Perforated Intervals

From	To
7453	7456
7466	7470

Acid Volumes

1,000 GALLONS RET 15% ACID, 150 BARRELS 2% KCL
--

Fracture Treatments

There are no Fracture Treatments records to display.
--

Formation	Top
SPRINGER SHALE	2506
FALSE CANEY	6806
CANEY	7000
SYCAMORE	7442
WOODFORD	7778
HUNTON	8132
SYLVAN	8560

Were open hole logs run? Yes

Date last log run: January 12, 2011

Were unusual drilling circumstances encountered? No

Explanation:

Other Remarks

There are no Other Remarks.

FOR COMMISSION USE ONLY

Status: Accepted

API NO. 35-019-25467
OTC PROD. UNIT NO. 019-205623

OCC Central Processing Division
P.O. Box 52000
Oklahoma City, OK 73152-2000
405-521-2331
OCCCentralProcessing@OCC.OK.GOV



OKLAHOMA
Corporation
Commission

Form 1002A
Rev. 2020

ORIGINAL
AMENDED (Reason) Recomplete Add Perforations Rule 165:10-3-25 COMPLETION REPORT

TYPE OF DRILLING OPERATION

☒ STRAIGHT HOLE ☐ DIRECTIONAL HOLE ☐ HORIZONTAL HOLE

☐ SERVICE WELL

If directional or horizontal, see reverse for bottom hole location.

COUNTY Carter SEC 19 TWP 15 RGE 2W
LEASE NAME Chatnam WELL NO. 1-19
ELEVATION 997' Ground 984' FSL 1320 FWL 1800
Derrick FL 997' Ground 984' Latitude Longitude
OPERATOR NAME Tiger Oil Company OTC / OCC OPERATOR NO. 244584
ADDRESS 16224 Mainfield Pl. Edmond OK 73013
CITY Edmond STATE OK ZIP 73013

SPUD DATE 12-20-2010

DRLG FINISHED

DATE 1-16-2011

DATE OF WELL COMPLETION 2-28-2011

1st PROD DATE 7-12-2011

RECOMP DATE 7-22-2011

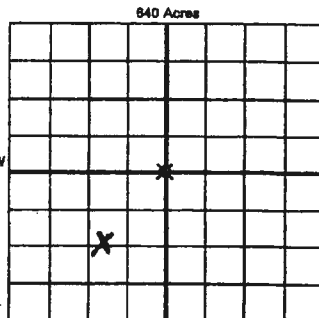

COMPLETION TYPE

☒ SINGLE ZONE
☐ MULTIPLE ZONE
☐ COMMINGLED
LOCATION EXCEPTION ORDER NO.
MULTIUNIT ORDER NO.
INCREASED DENSITY ORDER NO.

CASING & CEMENT (Attach Form 1002C)

TYPE	SIZE	WEIGHT	GRADE	FEET	PSI	SAX	TOP OF CMT
CONDUCTOR							
SURFACE	9 5/8	26#	J-55	956.73'		1170	Surf
INTERMEDIATE							
PRODUCTION	5 1/2	17.5#	N-80	8700.91'		350	7420'
LINER							

PACKER @ 7401' BRAND & TYPE Model R PLUG @ 8350' TYPE CIBP PLUG @ 7510' TYPE BPP
PACKER @ 7400' BRAND & TYPE Model R PLUG @ 7510' TYPE BPP PLUG @ 7510' TYPE BPP
COMPLETION & TEST DATA BY PRODUCING FORMATION

FORMATION	<u>3525 cmr</u> <u>Sy camore</u>	<u>(Recomplete)</u> <u>3525 cmr</u>					
SPACING & SPACING ORDER NUMBER	<u>580 767 (600)</u>	<u>580 767 (600)</u>					<u>No New Frac</u>
CLASS: Oil, Gas, Dry, Inj, Disp, Comm Disp, Svc	<u>oil</u>	<u>oil</u>					
PERFORATED INTERVALS	<u>7471-81; 7520-36</u> <u>7550-56; 7598-765</u> <u>7680-94'</u>	<u>(Recomplete)</u> <u>7466'-7470' (ASPP)</u> <u>7453-7456'</u>					
ACID/VOLUME	<u>2500 gals 15% HCl</u>	<u>1000 gal 15% HCl</u>					
FRACTURE TREATMENT (Fluids/Prop Amounts)	<u>Sil. dk water</u> <u>40/70</u> <u>5# 100 mesh</u>	<u>150 brts</u> <u>2% KCl</u>					

RECEIVED

OCT 20 2021

OKLAHOMA CORPORATION COMMISSION

INITIAL TEST DATA
☒ Min Gas Allowable (165:10-17-7) OR ☐ Oil Allowable (165:10-13-3) Purchaser/Measurer Tiger First Sales Date 7-12-2011

INITIAL TEST DATE	<u>7-20-2011</u>	<u>7-22-2011</u>			
OIL-BBL/DAY	<u>24</u>	<u>Shut in</u>			
OIL-GRAVITY (API)	<u>38</u>	<u>36</u>			
GAS-MCF/DAY	<u>231</u>	<u>Shut in</u>			
GAS-OIL RATIO CU FT/BBL	<u>9625</u>	<u>Testing</u>			
WATER-BBL/DAY	<u>14</u>	<u>55</u>			
PUMPING OR FLOWING	<u>Flowing</u>	<u>Pumping</u>			
INITIAL SHUT-IN PRESSURE	<u>650</u>	<u>800</u>			
CHOKE SIZE	<u>18/64"</u>	<u>Open</u>			
FLOW TUBING PRESSURE	<u>210</u>	<u>Testing</u>			

A record of the formations drilled through, and pertinent remarks are presented on the reverse. I declare that I have knowledge of the contents of this report and am authorized by my organization to make this report, which was prepared by me or under my supervision and direction, with the data and facts stated herein to be true, correct, and complete to the best of my knowledge and belief.

SIGNATURE Derek B. Williamson NAME (PRINT OR TYPE) Derek B. Williamson DATE 7-25-21 PHONE NUMBER 580-819-1516
ADDRESS 16224 Mainfield Pl. Edmond OK 73013 CITY Edmond STATE OK ZIP 73013 EMAIL ADDRESS derek.8678@yahoo.com

PLEASE TYPE OR USE BLACK INK ONLY
FORMATION RECORD

Give formation names and logs, if available, or descriptions and thickness of formations drilled through. Show intervals cored or drilled and tested.

LEASE NAME Chatham

WELL NO. 1-19

NAMES OF FORMATIONS	TOP
Springer Scale	2506'
False Caney	6806'
Caney	7000'
Sycamore	7442'
Woodford	7779'
Hunter	8132'
Sylvan	8860'

FOR COMMISSION USE ONLY

ITD on file ☐ YES ☐ NO

APPROVED _____ DISAPPROVED _____

2) Reject Codes _____

Were open hole logs run? ☒ yes ☐ no

Date Last log was run 1-12-2011 (Comp)

Was CO₂ encountered? ☐ yes ☒ no at what depths? _____

Was H₂S encountered? ☐ yes ☒ no at what depths? _____

Were unusual drilling circumstances encountered? ☐ yes ☒ no

If yes, briefly explain below _____

Other remarks:

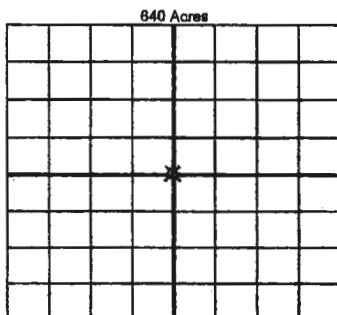

If more than three drainholes are proposed, attach a separate sheet indicating the necessary information.

Direction must be stated in degrees azimuth. Please note, the horizontal drainhole and its end point must be located within the boundaries of the lease or spacing unit.

Directional surveys are required for all drainholes and directional wells.

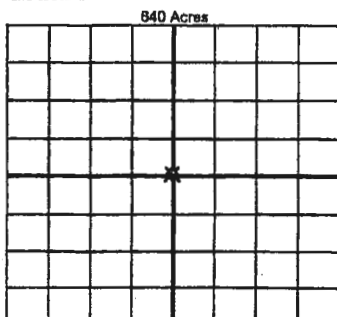

BOTTOM HOLE LOCATION FOR DIRECTIONAL HOLE

SEC	TWP	RGE	COUNTY
1/4	1/4	1/4	1/4
Measured Total Depth		True Vertical Depth	
Feet From 1/4 Sec Lines		BHL From Lease, Unit, or Property Line:	

BOTTOM HOLE LOCATION FOR HORIZONTAL HOLE: (LATERALS)

LATERAL #1

SEC	TWP	RGE	COUNTY
1/4	1/4	1/4	1/4
Depth of Deviation		Radius of Turn	
Measured Total Depth		True Vertical Depth	
Feet From 1/4 Sec Lines		Total Length	
Direction		BHL From Lease, Unit, or Property Line:	

LATERAL #2

SEC	TWP	RGE	COUNTY
1/4	1/4	1/4	1/4
Depth of Deviation		Radius of Turn	
Measured Total Depth		True Vertical Depth	
Feet From 1/4 Sec Lines		Total Length	
Direction		BHL From Lease, Unit, or Property Line:	

LATERAL #3

SEC	TWP	RGE	COUNTY
1/4	1/4	1/4	1/4
Depth of Deviation		Radius of Turn	
Measured Total Depth		True Vertical Depth	
Feet From 1/4 Sec Lines		Total Length	
Direction		BHL From Lease, Unit, or Property Line:	