

Oklahoma Corporation Commission
Oil & Gas Conservation Division
Post Office Box 52000
Oklahoma City, Oklahoma 73152-2000
Rule 165: 10-3-25

Form 1002A

API No.: 35093252430000

Completion Report

Spud Date: February 26, 2020

OTC Prod. Unit No.: 093-226639-0-0000

Drilling Finished Date: March 10, 2020

1st Prod Date: April 06, 2020

Completion Date: March 27, 2020

Drill Type: STRAIGHT HOLE

Min Gas Allowable: Yes

Well Name: CHEVAL 20-4

Purchaser/Measurer: DCP MIDSTREAM

Location: MAJOR 7 21N 14W
SE NE NW SE
2095 FSL 1448 FEL of 1/4 SEC
Derrick Elevation: 0 Ground Elevation: 1475

First Sales Date: 04/08/2020

Operator: KIRKPATRICK OIL COMPANY INC 19792

1001 W WILSHIRE BLVD STE 202
OKLAHOMA CITY, OK 73116-7017

Completion Type		Location Exception		Increased Density	
X	Single Zone	Order No		Order No	
	Multiple Zone	N/A		N/A	
	Commingle				

Casing and Cement							
Type	Size	Weight	Grade	Feet	PSI	SAX	Top of CMT
SURFACE	8 5/8	24	J-55	674		400	SURFACE
PRODUCTION	5 1/2	17	N-80	7208		760	2938

Liner								
Type	Size	Weight	Grade	Length	PSI	SAX	Top Depth	Bottom Depth
There are no Liner records to display.								

Total Depth: 7216

Packer	
Depth	Brand & Type
There are no Packer records to display.	

Plug	
Depth	Plug Type
There are no Plug records to display.	

Initial Test Data										
Test Date	Formation	Oil BBL/Day	Oil-Gravity (API)	Gas MCF/Day	Gas-Oil Ratio Cu FT/BBL	Water BBL/Day	Pumpin or Flowing	Initial Shut-In Pressure	Choke Size	Flow Tubing Pressure
May 04, 2020	CHEROKEE SAND	35		27	771	39	PUMPING			

Completion and Test Data by Producing Formation

Formation Name: CHEROKEE SAND

Code: 404CHRKS

Class: OIL

Spacing Orders

Order No	Unit Size
64660	UNIT

Perforated Intervals

From	To
7052	7054
7060	7090

Acid Volumes

NONE

Fracture Treatments

1,634 BARRELS 25 POUNDS LINEAR GEL, 73,400
POUNDS 20/40 PREMIUM WHITE SAND

Formation	Top
CHEROKEE SAND	7000

Were open hole logs run? Yes

Date last log run:

Were unusual drilling circumstances encountered? No

Explanation:

Other Remarks

OCC - OPERATOR SET A D-V TOOL AT 5,806', USED 600 SACKS OF CEMENT, LIFTED CEMENT TO 2,938'. OCC - THE FRAC FOCUS REPORT IS UNAVAILABLE, BUT IS IN THE PROCESS OF BEING RESOLVED WITH THE OPERATOR.

FOR COMMISSION USE ONLY

1145258

Status: Accepted

API NO. 093-25243
OTC PROD. UNIT NO. 093226639

PLEASE TYPE OR USE BLACK INK ONLY
NOTE:
Attach copy of original 1002A if recompletion or reent

OKLAHOMA CORPORATION COMMISSION
Oil & Gas Conservation Division
Post Office Box 52000
Oklahoma City, Oklahoma 73152-2000

Form 1002A
Rev. 2009

☒ ORIGINAL
☐ AMENDED (Reason)

Rule 165:10-3-25

COMPLETION REPORT

TYPE OF DRILLING OPERATION

☒ STRAIGHT HOLE ☐ DIRECTIONAL HOLE ☐ HORIZONTAL HOLE
☐ SERVICE WELL

If directional or horizontal, see reverse for bottom hole location.

COUNTY	Major	SEC	7	TWP	21N	RGE	14W
LEASE NAME	Cheval		WELL NO.	20-4			
SE 1/4 NE 1/4 NW 1/4 SE 1/4	FSL 2095'		FWC OF 1/4 SEC	FEL 3832' 1448'			
ELEVATION	Ground	1475	Latitude (if known)	Longitude (if known)			
OPERATOR NAME	Kirkpatrick Oil Company, Inc.			OTC/OCC OPERATOR NO	19792		
ADDRESS	1001 W. Wilshire Blvd. #202						
CITY	Oklahoma City	STATE	OK	ZIP	73116		

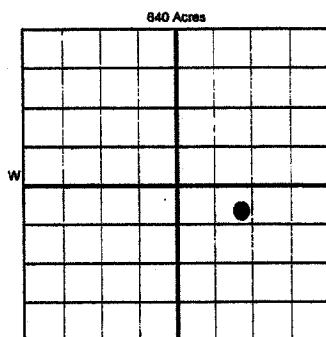

COMPLETION TYPE

<input checked="" type="checkbox"/> SINGLE ZONE	
<input type="checkbox"/> MULTIPLE ZONE	
Application Date	
COMINGLED	
Application Date	
LOCATION EXCEPTION ORDER NO.	n/a
INCREASED DENSITY ORDER NO.	n/a

CASING & CEMENT (Form 1002C must be attached)

TYPE	SIZE	WEIGHT	GRADE	FEET	PSI	SAX	TOP OF CMT
CONDUCTOR							
SURFACE	8-5/8"	24	J55	674'		400	Surface
INTERMEDIATE							
PRODUCTION	5-1/2"	17	N80	7208'		768 406	2938'
LINER							
TOTAL DEPTH							7216'

see remarks to 1002C's

PACKER @ _____ BRAND & TYPE _____ PLUG @ _____ TYPE _____ PLUG @ _____ TYPE _____
PACKER @ _____ BRAND & TYPE _____ PLUG @ _____ TYPE _____ PLUG @ _____ TYPE _____

COMPLETION & TEST DATA BY PRODUCING FORMATION

FORMATION	Cherokee Sand						
SPACING & SPACING	64660 (unit)						
ORDER NUMBER							
CLASS: Oil, Gas, Dry, Inj, Disp, Comm Disp, Svc	OIL						
PERFORATED INTERVALS	7052'-7054'						
	7060'-7090'						
ACID VOLUME	none						
FRACTURE TREATMENT (Fluids/Prop Amounts)	1634 bbls 25# linear gel						
	73,400 lbs 20/40 premium white sand						

Monitor Report to FracFocus

☒

Min Gas Allowable (165:10-17-7)

Gas Purchaser/Measurer

DCP Midstream

OR

First Sales Date

4/8/2020

INITIAL TEST DATA

Oil Allowable (165:10-13-3)

INITIAL TEST DATE	5/4/2020						
OIL-BBL/DAY	35						
OIL-GRAVITY (API)							
GAS-MCF/DAY	27						
GAS-OIL RATIO CU FT/BBL	771						
WATER-BBL/DAY	39						
PUMPING OR FLOWING	PUMPING						
INITIAL SHUT-IN PRESSURE							
CHOKE SIZE							
FLOW TUBING PRESSURE							

A record of the formations drilled through, and pertinent remarks are presented on the reverse. I declare that I have knowledge of the contents of this report and am authorized by my organization to make this report, which was prepared by me or under my supervision and direction, with the data and facts stated herein to be true, correct, and complete to the best of my knowledge and belief.

Mike McGinnis
SIGNATURE

Mike McGinnis

5-19-2020 405-767-3653

1001 W. Wilshire Blvd. #202

Oklahoma City

NAME (PRINT OR TYPE)

OK 73116

DATE

PHONE NUMBER

mmcginnis@kirkpatrickoil.com

ADDRESS

CITY

STA

ZIP

EMAIL ADDRESS

PLEASE TYPE OR USE BLACK INK ONLY

Give formation names and tops, if available, or descriptions and thickness of formations drilled through. Show intervals cored or drillstem tested.

Cheval

WELL NO. 20-4

NAMES OF FORMATIONS	TOP
Cherokee Sand	7000'
Total depth	7216'

		FOR COMMISSION USE ONLY	
ITD on file	<input type="checkbox"/> YES	<input type="checkbox"/> NO	
APPROVED	DISAPPROVED		2) Reject Codes
<hr/>		<hr/>	
<hr/>		<hr/>	
<hr/>		<hr/>	
<hr/>		<hr/>	
<hr/>		<hr/>	

Were open hole logs run? X yes no

Date Last log was run _____

Was CO₂ encountered? yes X no at what depths? _____

Was H₂S encountered? yes X no at what depths? _____

Were unusual drilling circumstances encountered? yes X no

If yes, briefly explain below:

Other remarks:

Other remarks: DCC - Operator set a DV tool at 5006 used 600 sacks of cement lifted cement to 2938

640 Acres

If more than three drainholes are proposed, attach a separate sheet indicating the necessary information.

Direction must be stated in degrees azimuth.

Please note, the horizontal drainhole and its end point must be located within the boundaries of the lease or pooling unit.

Directional surveys are required for all drainholes and directional wells.

640 Acres

SEC	TWP	RGE	COUNTY
Spot Location			
1/4	1/4	1/4	1/4
Measured Total Depth		True Vertical Depth	Feet From 1/4 Sec Lines FSL FWL
			BHL From Lease, Unit, or Property Line:

LATERAL #1						
SEC	TWP	RGE	COUNTY			
Spot Location						
1/4	1/4	1/4	Feet From 1/4 Sec Lines		FSL	FWL
Depth of Deviation		Radius of Turn		Direction		Total Length
Measured Total Depth		True Vertical Depth		BHL From Lease, Unit, or Property Line:		

SEC	TWP	RGE	COUNTY
Spot Location			
1/4	1/4	1/4	1/4
Feet From 1/4 Sec Lines		FSL	FWL
Depth of Deviation	Radius of Turn	Direction	Total Length
Measured Total Depth		True Vertical Depth	
BHL From Lease, Unit, or Property Line:			

SEC	TWP	RGE	COUNTY
Spot Location			
1/4	1/4	1/4	1/4
Depth of Deviation	Radius of Turn	Direction	FSL
Measured Total Depth	True Vertical Depth	FWL	
		BHL From Lease, Unit, or Property Line:	