

Oklahoma Corporation Commission  
Oil & Gas Conservation Division  
Post Office Box 52000  
Oklahoma City, Oklahoma 73152-2000  
Rule 165: 10-3-25

Form 1002A

API No.: 35137249300001

**Completion Report**

Spud Date: October 18, 1990

OTC Prod. Unit No.:

Drilling Finished Date: October 21, 1990

**Amended**

1st Prod Date: November 02, 1990

Amend Reason: CONVERT TO INJECTION

Completion Date: October 24, 1990

Recomplete Date: January 06, 2020

**Drill Type: STRAIGHT HOLE**

**SERVICE WELL**

Well Name: HARLEY A-46

Purchaser/Measurer:

Location: STEPHENS 24 2S 4W  
SE SE SW NE  
165 FSL 1155 FWL of 1/4 SEC  
Derrick Elevation: 1124 Ground Elevation: 1120

First Sales Date:

Operator: O'NEAL OIL & GAS CO 1622

675 N HENDERSON ST  
FORT WORTH, TX 76107-1479

Completion Type		Location Exception		Increased Density	
X	Single Zone	Order No		Order No	
	Multiple Zone	There are no Location Exception records to display.		There are no Increased Density records to display.	
	Commingled				

Casing and Cement							
Type	Size	Weight	Grade	Feet	PSI	SAX	Top of CMT
PRODUCTION	4 1/2	11.6	8RD	1240		350	SURFACE

Liner								
Type	Size	Weight	Grade	Length	PSI	SAX	Top Depth	Bottom Depth
There are no Liner records to display.								

**Total Depth: 1250**

Packer		Plug	
Depth	Brand & Type	Depth	Plug Type
690	4-1/2" X 2-3/8" AD-1	1126	CIBP

Initial Test Data										
Test Date	Formation	Oil BBL/Day	Oil-Gravity (API)	Gas MCF/Day	Gas-Oil Ratio Cu FT/BBL	Water BBL/Day	Pumpin or Flowing	Initial Shut-In Pressure	Choke Size	Flow Tubing Pressure
There are no Initial Data records to display.										

Completion and Test Data by Producing Formation			
Formation Name: PERMIAN		Code: 459PRMN	Class: INJ
<b>Spacing Orders</b>		<b>Perforated Intervals</b>	
<b>Order No</b>	<b>Unit Size</b>	<b>From</b>	<b>To</b>
N/A		730	1094
<b>Acid Volumes</b>		<b>Fracture Treatments</b>	
1,000 GALLONS HCL WITH 330 BARRELS WATER		NONE	

Formation	Top
PERMIAN SANDS	594
PERMIAN SANDS	656
PERMIAN SANDS	730
PERMIAN SANDS	788
PERMIAN SANDS	870
PERMIAN SANDS	1000
PERMIAN SANDS	1076
PERMIAN SANDS	1132
PERMIAN SANDS	1148
PERMIAN SANDS	1196

Were open hole logs run? Yes  
Date last log run: October 21, 1990

Were unusual drilling circumstances encountered? No  
Explanation:

Other Remarks
UIC PERMIT NUMBER 2002920016

FOR COMMISSION USE ONLY	
Status: Accepted	1144901

RECEIVED

Form 1002A  
Rev. 2009API NO. 35-137-24930  
OTC PROD.  
UNIT NO.

(PLEASE TYPE OR USE BLACK INK ONLY)

## OKLAHOMA CORPORATION COMMISSION

Oil & Gas Conservation Division  
Post Office Box 52000Oklahoma City, Oklahoma 73152-2000  
Rule 165:10-3-25

MAR 11 2020

OKLAHOMA CORPORATION  
COMMISSION☒ ORIGINAL  
☒ AMENDED (Reason)*Convert to Injection*  
*Conversion to SWDW*

## COMPLETION REPORT

## TYPE OF DRILLING OPERATION

☒ STRAIGHT HOLE ☐ DIRECTIONAL HOLE ☐ HORIZONTAL HOLE  
☒ SERVICE WELL

If directional or horizontal, see reverse for bottom hole location.

COUNTY	Stephens	SEC	24	TWP	2S	RGE	4W
LEASE NAME	Harley (A)			WELL NO.	46		
1/4 SE 1/4 SW 1/4 NE 1/4	FSL OF 1/4 SEC		165	FWL OF 1/4 SEC		1155	
ELEVATION	1124	Ground	1120	Latitude (if known)		Longitude (if known)	
OPERATOR NAME	O'Neal Oil & Gas Company			OTC / OCC OPERATOR NO.	1622		
ADDRESS	675 N. Henderson St.						
CITY	Fort Worth		STATE	TX	ZIP	76107	

SPUD DATE	10-18-1990
DRLG FINISHED DATE	10-21-1990
DATE OF WELL COMPLETION	10-24-1990
1st PROD DATE	11-2-1990
RECOMP DATE	1-6-2020

640 Acres

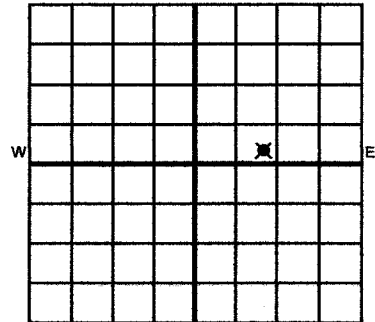

LOCATE WELL

## COMPLETION TYPE

<input checked="" type="checkbox"/> SINGLE ZONE	
<input type="checkbox"/> MULTIPLE ZONE	
Application Date	
<input type="checkbox"/> COMMINGLED	
Application Date	
LOCATION EXCEPTION ORDER NO.	
INCREASED DENSITY ORDER NO.	

## CASING &amp; CEMENT (Attach Form 1002C)

TYPE	SIZE	WEIGHT	GRADE	FEET	PSI	SAX	TOP OF CMT
CONDUCTOR							
SURFACE							
INTERMEDIATE							
PRODUCTION	4-1/2"	11.6	8RD	1240		350	SURF
LINER							

 PACKER @ 690' BRAND & TYPE 4-1/2"x2-3/8" AD-1 PLUG @ 1126' TYPE CIBP PLUG @ TYPE  
 PACKER @ BRAND & TYPE PLUG @ TYPE PLUG @ TYPE

TOTAL DEPTH 1250'

## COMPLETION &amp; TEST DATA BY PRODUCING FORMATION

FORMATION	Permian						No Frac
SPACING & SPACING ORDER NUMBER	N/A						
CLASS: Oil, Gas, Dry, Inj, Disp, Comm Disp, Svc	INJ.						
PERFORATED INTERVALS	730-1094'						
ACID/VOLUME	NO 1000 gals HCL with 330 bbls water						
FRACTURE TREATMENT (Fluids/Prop Amounts)	NO						

Per Original 1002A

Min Gas Allowable (165:10-17-7)

Gas Purchaser/Measurer

☐ OR  
Oil Allowable (165:10-13-3)

First Sales Date

## INITIAL TEST DATA

INITIAL TEST DATE	11/2/1990					
OIL-BBL/DAY	10					
OIL-GRAVITY (API)	28					
GAS-MCF/DAY	0					
GAS-OIL RATIO CU FT/BBL	N/A					
WATER-BBL/DAY	20					
PUMPING OR FLOWING	PUMPING					
INITIAL SHUT-IN PRESSURE	N/A					
CHOKE SIZE	N/A					
FLOW TUBING PRESSURE	N/A					

A record of the formations drilled through, and pertinent remarks are presented on the reverse. I declare that I have knowledge of the contents of this report and am authorized by my organization to make this report which was prepared by me or under my supervision and direction, with the data and facts stated herein to be true, correct, and complete to the best of my knowledge and belief.

Eric Diment

Eric Diment

3/5/2020

817-625-8246

SIGNATURE

NAME (PRINT OR TYPE)

DATE

PHONE NUMBER

675 N. Henderson St.

Fort Worth

TX

76107

EDIMENT@ONEALOIL.COM

ADDRESS

CITY

STATE

ZIP

EMAIL ADDRESS

PLEASE TYPE OR USE BLACK INK ONLY

FORMATION RECORD

Give formation names and tops, if available, or descriptions and thickness of formations drilled through. Show intervals cored or drillstem tested.

NAMES OF FORMATIONS	TOP
PERMIAN SANDS	594
	656
	730
	788
	870
	1,000
	1,076
	1,132
	1,148
	1,196

LEASE NAME \_\_\_\_\_ WELL NO. \_\_\_\_\_

FOR COMMISSION USE ONLY

ITD on file ☐ YES ☐ NO

APPROVED \_\_\_\_\_ DISAPPROVED \_\_\_\_\_

2) Reject Codes

Were open hole logs run? ☒ yes ☐ no

Date Last log was run 10/21/1990

Was CO<sub>2</sub> encountered? ☐ yes ☒ no at what depths? \_\_\_\_\_

Was H<sub>2</sub>S encountered? ☐ yes ☒ no at what depths? \_\_\_\_\_

Were unusual drilling circumstances encountered? ☐ yes ☒ no  
If yes, briefly explain below

Other remarks:

UIC-Permit 2007920016

640 Acres

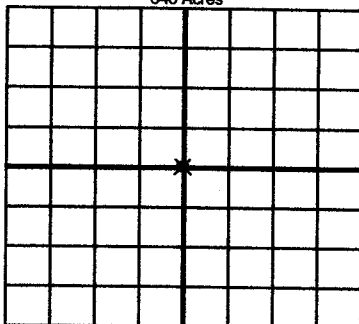

If more than three drainholes are proposed, attach a separate sheet indicating the necessary information.

Direction must be stated in degrees azimuth. Please note, the horizontal drainhole and its end point must be located within the boundaries of the lease or spacing unit.

Directional surveys are required for all drainholes and directional wells.

640 Acres

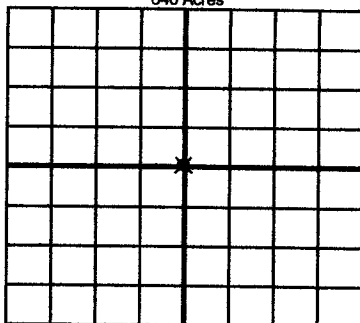

BOTTOM HOLE LOCATION FOR DIRECTIONAL HOLE

SEC	TWP	RGE	COUNTY
Spot Location			
1/4	1/4	1/4	1/4
Measured Total Depth		True Vertical Depth	BHL From Lease, Unit, or Property Line:

BOTTOM HOLE LOCATION FOR HORIZONTAL HOLE: (LATERALS)

LATERAL #1

SEC	TWP	RGE	COUNTY
Spot Location			
1/4	1/4	1/4	1/4
Depth of Deviation		Radius of Turn	Direction
Measured Total Depth		True Vertical Depth	BHL From Lease, Unit, or Property Line:

LATERAL #2

SEC	TWP	RGE	COUNTY
Spot Location			
1/4	1/4	1/4	1/4
Depth of Deviation		Radius of Turn	Direction
Measured Total Depth		True Vertical Depth	BHL From Lease, Unit, or Property Line:

LATERAL #3

SEC	TWP	RGE	COUNTY
Spot Location			
1/4	1/4	1/4	1/4
Depth of Deviation		Radius of Turn	Direction
Measured Total Depth		True Vertical Depth	BHL From Lease, Unit, or Property Line:

FD-302 (Rev. 1-25-60)

To be filed within 30 days after drilling is completed

**OKLAHOMA CORPORATION COMMISSION**

Jim Thorpe Building / Oklahoma City, Oklahoma 73105-4993  
ON USE BLACK INK ONLY

PLEASE TYPE OR USE BLACK INK ONLY

640 Acres



9. Elevation: Derrick Floor 1127 Ground 1120

10. COMPANY OPERATING O'NEAL DELIVERING

Address P.O. Box 7660

City Fort Worth State Tx Zip 76106

11. Drilling Started	<u>10-11</u> , 19 <u>70</u>	Drilling Finished	<u>10-21</u> , 19 <u>70</u>
12. Well Completed	<u>10-27</u> , 19 <u>70</u>	Date-First Prod.	<u>11-2</u> , 19 <u>70</u>

## 6. Locate Well And Outline Lease

### 13. TYPE COMPLETION

Single Zone X

Multiple Zone NA Order No. NA

Commenced 1/4 Order No. 141

LOCATION	EXCEPTION	Order No.	Penalty
	N/A	N/A	

INCREASED DENSITY 118 Order No. 114

### 15. OIL OR GAS ZONES

Name	From	To	Name	From	To
Pleasant Sands	1000	1010		1178	1158
	1075	1084		1195	1200
	1132	1136			

## 16. CASING & CEMENT

Type	Size	Weight	Grade	Feet	Cog Test		Cement	
					PSI	Sax	Fillup	Top
Conductor								
Surface								
Intermediate								
Production	4 1/2	11.60	8K2	1240		350	1250	0
Liner								

## 18. PACKERS SET

Depth 114 Type 114

17. TOTAL DEPTH 1250

**(over)**

### 19. COMPLETION & TEST DATA BY PRODUCING FORMATION

FORMATION	SPACING & SPACING ORDER NUMBER	CLASSIFICATION (Oil, Gas, Dry, Inf. Well)	PERFORATED INTERVALS	ACID/VOLUME FLUORE TREATED?	Fluids Amounts
Permian	N/A	OIL	1000-1010 1076-1084 1133-1138 1148-1154 1196-1200	1000 gal. Yes	330 BBL
			1212-1218	15% HCL	

INITIAL TEST DATA:

Date	11-2		
Oil-bbl/day	10-		
Oil-Gravity (°API)	28°		
Gas-MCF/day	0		
Gas-Oil Ratio Cu. Ft./bbl	-		
Water-bbl/day	20-		
Pumping or Flowing	Flowing		
Initial Shut-In Pressure	-		
CHOKED SIZE	-		
FLOW TUBING PRESSURE	-		

A record of the formations drilled through, and pertinent remarks are presented on the reverse.

I declare that I have knowledge of the contents of this report and am authorized by my organization to make this report, which was prepared by me or under my supervision and direction, with the data and facts stated herein to be true, correct and complete to the best of my knowledge and belief.

Donald L. Bares  
Signature

Accountant  
Title

PO. Box 4660 Fort Worth TX 76106

Date 11-19-90 Phone 817-625-8846

22. LEASE NAME

HARLEY A

23. WELL NO. 46

PLEASE TYPE OR USE BLACK INK ONL

**(RULE 3-205) FORMATION RECORD**

Give formation names and tops, if available, or descriptions and thickness of formations drilled through. Show intervals cored or drillstem tested.

NAMES OF FORMATIONS	TOP	BOTTOM	FOR COMMISSION USE ONLY																																																																								
SANDS	594	608		<p>Well Completion Report Checklist</p> <table border="0"> <tr> <td><u>APPROVED</u></td> <td><u>DISAPPROVED</u></td> <td>1) ITD Section</td> </tr> <tr> <td>_____</td> <td>_____</td> <td>a) No Intent to Drill on file</td> </tr> <tr> <td></td> <td></td> <td>(1) Send warning letter <input type="checkbox"/></td> </tr> <tr> <td></td> <td></td> <td>(2) Recommend for contempt <input type="checkbox"/></td> </tr> <tr> <td>_____</td> <td>_____</td> <td>2) Authorized Surety</td> </tr> <tr> <td></td> <td></td> <td>a) No Surety filed _____</td> </tr> <tr> <td></td> <td></td> <td>b) Expired Surety _____</td> </tr> <tr> <td></td> <td></td> <td>Financial Statement/Letter of Credit/Bond</td> </tr> <tr> <td>_____</td> <td>_____</td> <td>3) Spacing and Pooling _____</td> </tr> <tr> <td>_____</td> <td>_____</td> <td>4) Well Spudded prior to approval _____</td> </tr> <tr> <td></td> <td></td> <td>5) Insufficient surface casing _____</td> </tr> <tr> <td></td> <td></td> <td>_____ required _____ set</td> </tr> <tr> <td></td> <td></td> <td>6) No test data _____</td> </tr> <tr> <td></td> <td></td> <td>7) Change of location _____</td> </tr> <tr> <td></td> <td></td> <td>8) Well location "off pattern"</td> </tr> <tr> <td></td> <td></td> <td>Spacing Order No. _____</td> </tr> <tr> <td></td> <td></td> <td>Size Unit/pattern _____</td> </tr> <tr> <td></td> <td></td> <td>Formation(s) _____</td> </tr> <tr> <td></td> <td></td> <td>9) No record found _____</td> </tr> <tr> <td></td> <td></td> <td>10) Other: _____</td> </tr> <tr> <td></td> <td></td> <td>(Please specify appropriate number from initial rejection letter or other problem found)</td> </tr> <tr> <td></td> <td></td> <td>11) Status: _____</td> </tr> <tr> <td></td> <td></td> <td>_____</td> </tr> <tr> <td></td> <td></td> <td>_____</td> </tr> </table>	<u>APPROVED</u>	<u>DISAPPROVED</u>	1) ITD Section	_____	_____	a) No Intent to Drill on file			(1) Send warning letter <input type="checkbox"/>			(2) Recommend for contempt <input type="checkbox"/>	_____	_____	2) Authorized Surety			a) No Surety filed _____			b) Expired Surety _____			Financial Statement/Letter of Credit/Bond	_____	_____	3) Spacing and Pooling _____	_____	_____	4) Well Spudded prior to approval _____			5) Insufficient surface casing _____			_____ required _____ set			6) No test data _____			7) Change of location _____			8) Well location "off pattern"			Spacing Order No. _____			Size Unit/pattern _____			Formation(s) _____			9) No record found _____			10) Other: _____			(Please specify appropriate number from initial rejection letter or other problem found)			11) Status: _____			_____		
<u>APPROVED</u>	<u>DISAPPROVED</u>	1) ITD Section																																																																									
_____	_____	a) No Intent to Drill on file																																																																									
		(1) Send warning letter <input type="checkbox"/>																																																																									
		(2) Recommend for contempt <input type="checkbox"/>																																																																									
_____	_____	2) Authorized Surety																																																																									
		a) No Surety filed _____																																																																									
		b) Expired Surety _____																																																																									
		Financial Statement/Letter of Credit/Bond																																																																									
_____	_____	3) Spacing and Pooling _____																																																																									
_____	_____	4) Well Spudded prior to approval _____																																																																									
		5) Insufficient surface casing _____																																																																									
		_____ required _____ set																																																																									
		6) No test data _____																																																																									
		7) Change of location _____																																																																									
		8) Well location "off pattern"																																																																									
		Spacing Order No. _____																																																																									
		Size Unit/pattern _____																																																																									
		Formation(s) _____																																																																									
		9) No record found _____																																																																									
		10) Other: _____																																																																									
		(Please specify appropriate number from initial rejection letter or other problem found)																																																																									
		11) Status: _____																																																																									
		_____																																																																									
		_____																																																																									
	656	672																																																																									
	730	708																																																																									
	788	796																																																																									
	870	882																																																																									
	1000	1010																																																																									
	1076	1084																																																																									
	1132	1138																																																																									
	1148	1158																																																																									
	1196	1200																																																																									
TOTAL DEPTH																																																																											

Was an electrical survey run? ☒ YES ☐ NO. Date last log was run 10-21-90

Was CO<sub>2</sub> encountered? ☒ YES ☐ NO. If so, at what depth(s) \_\_\_\_\_

Was H<sub>2</sub>S encountered? ☒ YES ☐ NO. If so, at what depth(s) \_\_\_\_\_

25. Direct. Survey: True Vertical Depth: NA Horizontal Projections: NA (N/S) NA (E/W)

27. Were unusual drilling circumstances encountered? Yes ☐ No ☒ If yes, briefly explain: \_\_\_\_\_

Other Remarks \_\_\_\_\_

RECEIVED

MAR 11 2020

RE: Harley A #46 Conversion to SWDW

OKLAHOMA CORPORATION  
COMMISSION

To whom it may concern,

The enclosed documents include: new 1002A, original 1002A, and the approved disposal permit for O'Neal Oil & Gas Company's Harley A #46 [API #: 35-137-24930]. This is being sent in order to satisfy the request of section 14 F in the Disposal Well Permit. If any further documentation is needed, please do not hesitate to contact me.

Best Regards,

**Eric Diment, M.S.**

**Vice President**

O'Neal Oil & Gas Company

675 N. Henderson Street

Fort Worth, Texas 76107

Office: (817) 625-8246

Cell: (479) 650-8950

E-mail: [ediment@onealoil.com](mailto:ediment@onealoil.com)

