

Oklahoma Corporation Commission
Oil & Gas Conservation Division
Post Office Box 52000
Oklahoma City, Oklahoma 73152-2000
Rule 165: 10-3-25

Form 1002A

API No.: 35095206850000

Completion Report

Spud Date: December 09, 2019

OTC Prod. Unit No.: 095-226642-0-0000

Drilling Finished Date: December 24, 2019

1st Prod Date: February 01, 2020

Completion Date: January 24, 2020

Drill Type: STRAIGHT HOLE

Well Name: CAMALOT A 6

Purchaser/Measurer:

Location: MARSHALL 1 8S 4E
SW NW NE SW
2050 FSL 1596 FWL of 1/4 SEC
Derrick Elevation: 702 Ground Elevation: 690

First Sales Date:

Operator: FIRST ASCENT OPERATING LLC 24437

15455 DALLAS PKWY STE 1050
ADDISON, TX 75001-6721

Completion Type		Location Exception		Increased Density	
X	Single Zone	Order No		Order No	
	Multiple Zone	There are no Location Exception records to display.		There are no Increased Density records to display.	
	Commingled				

Casing and Cement							
Type	Size	Weight	Grade	Feet	PSI	SAX	Top of CMT
CONDUCTOR	16	42		48		100	SURFACE
SURFACE	9 5/8	45	L-80	330	700	250	SURFACE
PRODUCTION	5 1/2	17	N-80	6075	1700	855	2960

Liner								
Type	Size	Weight	Grade	Length	PSI	SAX	Top Depth	Bottom Depth
There are no Liner records to display.								

Total Depth: 6214

Packer		Plug	
Depth	Brand & Type	Depth	Plug Type
There are no Packer records to display.		There are no Plug records to display.	

Initial Test Data

Test Date	Formation	Oil BBL/Day	Oil-Gravity (API)	Gas MCF/Day	Gas-Oil Ratio Cu FT/BBL	Water BBL/Day	Pumpin or Flowing	Initial Shut-In Pressure	Choke Size	Flow Tubing Pressure
Feb 03, 2020	ATOKA	22	35	50	2200	28	PUMPING	400		

Completion and Test Data by Producing Formation									
Formation Name: ATOKA				Code: 403ATOK			Class: OIL		
Spacing Orders				Perforated Intervals					
Order No		Unit Size		From			To		
UNSPACED				5244			5251		
				5268			5272		
				5282			5284		
				5289			5307		
Acid Volumes				Fracture Treatments					
2,250 GALLONS				420 BARRELS GEL, 25,100 POUNDS BRADY SAND					

Formation	Top
LOWER GRAY STRAWN	4845
HANDY SAND	4933
"K" SAND	5016
"P" SAND	5219

Were open hole logs run? Yes
 Date last log run: December 22, 2019

 Were unusual drilling circumstances encountered? No
 Explanation:

Other Remarks
There are no Other Remarks.

FOR COMMISSION USE ONLY
<div>Status: Accepted</div> <div>1144903</div>

RECEIVED

Form 1002A
Rev. 2009

MAR 13 2020

OKLAHOMA CORPORATION
COMMISSION

COMPLETION REPORT

API
NO. 095-20685
OTC PROD.
UNIT NO. 095226642

(PLEASE TYPE OR USE BLACK INK ONLY)

OKLAHOMA CORPORATION COMMISSION

Oil & Gas Conservation Division

Post Office Box 52000

Oklahoma City, Oklahoma 73152-2000

Rule 165:10-3-25

ORIGINAL
AMENDED (Reason)

TYPE OF DRILLING OPERATION

☒ STRAIGHT HOLE ☐ DIRECTIONAL HOLE ☐ HORIZONTAL HOLE
☐ SERVICE WELL

If directional or horizontal, see reverse for bottom hole location.

COUNTY	Marshall	SEC	1	TWP	8S	RGE	4E	SPUD DATE	12/9/19
LEASE NAME	Camalot 'A'	WELL NO.	6	DATE OF WELL COMPLETION	1-24-20	1st PROD DATE	2-1-20	DRLG FINISHED DATE	12-24-19
SW 1/4 NW 1/4 NE 1/4 SW 1/4	SW 1/4 NW 1/4 NE 1/4 SW 1/4	FSL OF 1/4 SEC	2050	FWL OF 1/4 SEC	1596	RECOMP DATE			
ELEVATION Derrick FL	702	Ground	690	Latitude (if known)	33°53'15.7"N	Longitude (if known)	96°50'32.8"W		
OPERATOR NAME	First Ascent Operating, LLC	OTC / OCC OPERATOR NO.	24437-0						
ADDRESS	15455 Dallas Parkway Suite 1050								
CITY	Addison	STATE	TX	ZIP	75001				

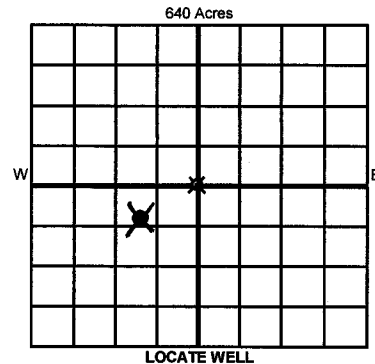

COMPLETION TYPE

<input checked="" type="checkbox"/> SINGLE ZONE	
<input type="checkbox"/> MULTIPLE ZONE	
Application Date	
<input type="checkbox"/> COMMINGLED	
Application Date	
LOCATION EXCEPTION ORDER NO.	
INCREASED DENSITY ORDER NO.	

CASING & CEMENT (Attach Form 1002C)

TYPE	SIZE	WEIGHT	GRADE	FEET	PSI	SAX	TOP OF CMT
CONDUCTOR	16"	42		48'		100	Surf
SURFACE	9 5/8"	45	L80	330'	700	250	Surf
INTERMEDIATE	—						
PRODUCTION	5 1/2"	17	N80	6075'	1700	855	2960'
LINER	—						
TOTAL DEPTH							6214'

PACKER @ N/A BRAND & TYPE

PACKER @ BRAND & TYPE

PLUG @ TYPE

PLUG @ TYPE

TOTAL DEPTH

COMPLETION & TEST DATA BY PRODUCING FORMATION

FORMATION	(P-Sand) ATOKA							Reported to Frac Focus
SPACING & SPACING ORDER NUMBER	Unspaced							
CLASS: Oil, Gas, Dry, Inj, Disp, Comm Disp, Svc	Oil							
PERFORATED INTERVALS	5244-51' (5268-72')(82-84) 5289-5307							
ACID/VOLUME	2250 gal							
FRACTURE TREATMENT (Fluids/Prop Amounts)	420 bbl gel 25,100# Brady Sand							

Min Gas Allowable (165:10-17-7)

Gas Purchaser/Measurer

☐ OR

First Sales Date

Oil Allowable (165:10-13-3)

INITIAL TEST DATA

INITIAL TEST DATE	2-3-2020						
OIL-BBL/DAY	22						
OIL-GRAVITY (API)	35						
GAS-MCF/DAY	50						
GAS-OIL RATIO CU FT/BBL	2200						
WATER-BBL/DAY	28						
PUMPING OR FLOWING	Pump						
INITIAL SHUT-IN PRESSURE	400						
CHOKE SIZE	—						
FLOW TUBING PRESSURE	—						

A record of the formations drilled through, and pertinent remarks are presented on the reverse. I declare that I have knowledge of the contents of this report and am authorized by my organization to make this report, which was prepared by me or under my supervision and direction, with the data and facts stated herein to be true, correct, and complete to the best of my knowledge and belief.

SIGNATURE: *Jason Long* NAME (PRINT OR TYPE): JASON LONG DATE: 3-5-20 PHONE NUMBER: 432-242-4694
 ADDRESS: 15455 Dallas Parkway Suite 1050 - Addison TX 75001 EMAIL ADDRESS: JASON@EnduranceResourcesLLC.com

PLEASE TYPE OR USE BLACK INK ONLY
FORMATION RECORD

Give formation names and tops, if available, or descriptions and thickness of formations drilled through. Show intervals cored or drillstem tested.

LEASE NAME Camelot 'A' WELL NO. 6

NAMES OF FORMATIONS	TOP
Lower Gray Strawn	4845'
Handy Sand	4933'
"k" Sand	5016'
"p" Sand	5219'

FOR COMMISSION USE ONLY	
ITD on file <input type="checkbox"/> YES <input type="checkbox"/> NO	
APPROVED _____ DISAPPROVED _____	2) Reject Codes _____

Were open hole logs run?	<input checked="" type="checkbox"/> yes <input type="checkbox"/> no
Date Last log was run	<u>12-22-2019</u>
Was CO ₂ encountered?	<input type="checkbox"/> yes <input checked="" type="checkbox"/> no at what depths? _____
Was H ₂ S encountered?	<input type="checkbox"/> yes <input checked="" type="checkbox"/> no at what depths? _____
Were unusual drilling circumstances encountered?	<input type="checkbox"/> yes <input checked="" type="checkbox"/> no
If yes, briefly explain below _____	

Other remarks: _____

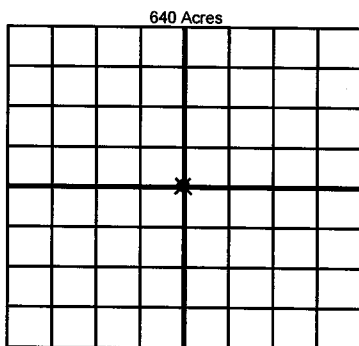

If more than three drainholes are proposed, attach a separate sheet indicating the necessary information.

Direction must be stated in degrees azimuth.
Please note, the horizontal drainhole and its end point must be located within the boundaries of the lease or spacing unit.

Directional surveys are required for all drainholes and directional wells.

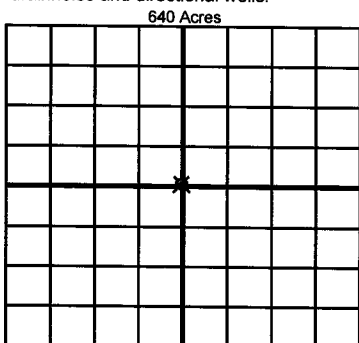

BOTTOM HOLE LOCATION FOR DIRECTIONAL HOLE

SEC	TWP	RGE	COUNTY
Spot Location			
1/4	1/4	1/4	1/4
Measured Total Depth		True Vertical Depth	BHL From Lease, Unit, or Property Line:

BOTTOM HOLE LOCATION FOR HORIZONTAL HOLE: (LATERALS)

LATERAL #1			
SEC	TWP	RGE	COUNTY
Spot Location			
1/4	1/4	1/4	1/4
Depth of Deviation		Radius of Turn	Direction
Measured Total Depth		True Vertical Depth	BHL From Lease, Unit, or Property Line:

LATERAL #2			
SEC	TWP	RGE	COUNTY
Spot Location			
1/4	1/4	1/4	1/4
Depth of Deviation		Radius of Turn	Direction
Measured Total Depth		True Vertical Depth	BHL From Lease, Unit, or Property Line:

LATERAL #3			
SEC	TWP	RGE	COUNTY
Spot Location			
1/4	1/4	1/4	1/4
Depth of Deviation		Radius of Turn	Direction
Measured Total Depth		True Vertical Depth	BHL From Lease, Unit, or Property Line: