

Oklahoma Corporation Commission
Oil & Gas Conservation Division
Post Office Box 52000
Oklahoma City, Oklahoma 73152-2000
Rule 165: 10-3-25

Form 1002A

API No.: 35107236240000

Completion Report

Spud Date: December 10, 2019

OTC Prod. Unit No.: 107-226479-0-0000

Drilling Finished Date: December 18, 2019

1st Prod Date: February 01, 2020

Completion Date: January 22, 2020

Drill Type: STRAIGHT HOLE

Well Name: MARZETT 1-6

Purchaser/Measurer:

Location: OKFUSKEE 6 12N 9E
C SE SE
660 FSL 660 FEL of 1/4 SEC
Latitude: 35.53904 Longitude: -96.390421
Derrick Elevation: 824 Ground Elevation: 820

First Sales Date:

Operator: 3FEARNS LLC 24129
PO BOX 1315
100 S RIVERFRONT DR STE 414
JENKS, OK 74037-1315

Completion Type		Location Exception		Increased Density	
X	Single Zone	Order No		Order No	
	Multiple Zone	There are no Location Exception records to display.		There are no Increased Density records to display.	
	Commingled				

Casing and Cement							
Type	Size	Weight	Grade	Feet	PSI	SAX	Top of CMT
SURFACE	8 5/8	24	J-55	496		130	SURFACE
PRODUCTION	4 1/2	11.6	J-55	4099		370	1340

Liner								
Type	Size	Weight	Grade	Length	PSI	SAX	Top Depth	Bottom Depth
There are no Liner records to display.								

Total Depth: 4099

Packer		Plug	
Depth	Brand & Type	Depth	Plug Type
There are no Packer records to display.		There are no Plug records to display.	

Initial Test Data										
Test Date	Formation	Oil BBL/Day	Oil-Gravity (API)	Gas MCF/Day	Gas-Oil Ratio Cu FT/BBL	Water BBL/Day	Pumpin or Flowing	Initial Shut-In Pressure	Choke Size	Flow Tubing Pressure
Feb 01, 2020	GILCREASE	15	33	1	66.6	4	PUMPING			

Completion and Test Data by Producing Formation			
Formation Name: GILCREASE		Code: 403GLCR	Class: OIL
Spacing Orders		Perforated Intervals	
Order No	Unit Size	From	To
130050	160	3346	3360
Acid Volumes		Fracture Treatments	
3,000 GALLONS 15% HCL		NONE	

Formation	Top
BOOCH	3135
GILCREASE	3210
UNION VALLEY	3470
MISSISSIPPIAN	3586
WOODFORD	3968
HUNTON	3997

Were open hole logs run? Yes
Date last log run: December 17, 2019

Were unusual drilling circumstances encountered? No
Explanation:

Other Remarks
There are no Other Remarks.

FOR COMMISSION USE ONLY	
Status: Accepted	1144904

API NO. 107-23624
OTC PROD. UNIT NO. 107226479

(PLEASE TYPE OR USE BLACK INK ONLY)

OKLAHOMA CORPORATION COMMISSION
Oil & Gas Conservation Division
Post Office Box 52000
Oklahoma City, Oklahoma 73152-2000
Rule 165:10-3-25

RECEIVED

MAR 16 2020

Form 1002A
Rev. 2009

☒ ORIGINAL
☐ AMENDED (Reason)

COMPLETION REPORT

TYPE OF DRILLING OPERATION
☒ STRAIGHT HOLE ☐ DIRECTIONAL HOLE ☐ HORIZONTAL HOLE
☐ SERVICE WELL
If directional or horizontal, see reverse for bottom hole location.

COUNTY Okfuskee SEC 6 TWP 12N RGE 09E
LEASE NAME Marzett
WELL NO. 1-6
FSL OF 1/4 SEC 660
ELEVATION Derrick FL 824 Ground 820
Latitude (if known) 35.53904
Longitude (if known) -96.390421
OPERATOR NAME 3Fearn LLC
ADDRESS P.O. Box 1315
CITY Jenks STATE OK ZIP 74037

SPUD DATE 12/10/19
DRLG FINISHED DATE 12/18/19
DATE OF WELL COMPLETION 1/22/20
1st PROD DATE 2-1-20
RECOMP DATE
OTC / OCC OPERATOR NO. 24129

640 Acres
LOCATE WELL

COMPLETION TYPE
☒ SINGLE ZONE
☐ MULTIPLE ZONE
Application Date
COMMINGLED
Application Date
LOCATION EXCEPTION ORDER NO.
INCREASED DENSITY ORDER NO.

TYPE	SIZE	WEIGHT	GRADE	FEET	PSI	SAX	TOP OF CMT
CONDUCTOR							
SURFACE	8 5/8	24	J-55	496		130	Surface
INTERMEDIATE							
PRODUCTION	4 1/2	11.6	J-55	4099		370	1,340 ft
LINER							
				TOTAL DEPTH	4099		

PACKER @ BRAND & TYPE PLUG @ TYPE PLUG @ TYPE
PACKER @ BRAND & TYPE PLUG @ TYPE PLUG @ TYPE

COMPLETION & TEST DATA BY PRODUCING FORMATION

FORMATION	Gilcrease					No Frac
SPACING & SPACING ORDER NUMBER	160 acres - 130050					
CLASS: Oil, Gas, Dry, Inj, Disp, Comm Disp, Svc	Oil					
PERFORATED INTERVALS	3,346' - 3,360'					
ACID/VOLUME	15% HCL - 3,000 gal					
FRACTURE TREATMENT (Fluids/Prop Amounts)	none					

☐ Min Gas Allowable (165:10-17-7)
OR
☐ Oil Allowable (165:10-13-3)

Gas Purchaser/Measurer
First Sales Date

INITIAL TEST DATA

INITIAL TEST DATE	2/1/2020					
OIL-BBL/DAY	15					
OIL-GRAVITY (API)	33					
GAS-MCF/DAY	1					
GAS-OIL RATIO CU FT/BBL	66.6					
WATER-BBL/DAY	4					
PUMPING OR FLOWING	Pumping					
INITIAL SHUT-IN PRESSURE						
CHOKE SIZE						
FLOW TUBING PRESSURE						

A record of the formations drilled through, and pertinent remarks are presented on the reverse. I declare that I have knowledge of the contents of this report and am authorized by my organization to make this report, which was prepared by me or under my supervision and direction, with the data and facts stated herein to be true, correct, and complete to the best of my knowledge and belief.

SIGNATURE Adam Seibel
P.O. Box 1315
ADDRESS
CITY Jenks STATE OK ZIP 74037
NAME (PRINT OR TYPE)
DATE 3/12/2020
PHONE NUMBER 918-901-9308
EMAIL ADDRESS aseibel@3fearn.com

PLEASE TYPE OR USE BLACK INK ONLY
FORMATION RECORD

Give formation names and tops, if available, or descriptions and thickness of formations drilled through. Show intervals cored or drillstem tested.

NAMES OF FORMATIONS	TOP
Booch	3,135
Gilcrease	3,210
Union Valley	3470
Mississippian	3,586
Woodford	3,968
Hunton	3,997

LEASE NAME Marzett

WELL NO. 1-6
6 Jan

FOR COMMISSION USE ONLY

ITD on file ☐ YES ☐ NO

APPROVED _____ DISAPPROVED _____

2) Reject Codes

Were open hole logs run? ☒ yes ☐ no

Date Last log was run 12/17/2019

Was CO₂ encountered? ☐ yes ☒ no at what depths? _____

Was H₂S encountered? ☐ yes ☒ no at what depths? _____

Were unusual drilling circumstances encountered? ☐ yes ☒ no
If yes, briefly explain below

Other remarks:

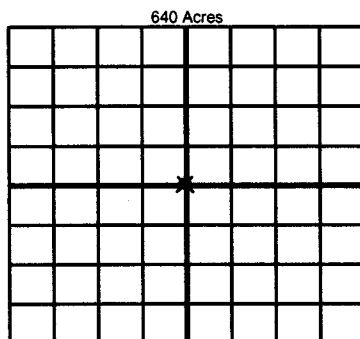

If more than three drainholes are proposed, attach a separate sheet indicating the necessary information.

Direction must be stated in degrees azimuth.
Please note, the horizontal drainhole and its end point must be located within the boundaries of the lease or spacing unit.

Directional surveys are required for all drainholes and directional wells.

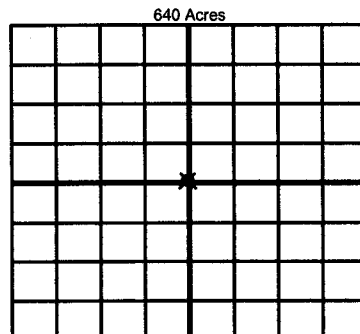

BOTTOM HOLE LOCATION FOR DIRECTIONAL HOLE

SEC	TWP	RGE	COUNTY
Spot Location	1/4	1/4	1/4
Measured Total Depth	True Vertical Depth	Feet From 1/4 Sec Lines	FSL FWL
BHL From Lease, Unit, or Property Line:			

BOTTOM HOLE LOCATION FOR HORIZONTAL HOLE: (LATERALS)

SEC	TWP	RGE	COUNTY
Spot Location	1/4	1/4	1/4
Depth of Deviation	Radius of Turn	Direction	Total Length
Measured Total Depth	True Vertical Depth	BHL From Lease, Unit, or Property Line:	

SEC	TWP	RGE	COUNTY
Spot Location	1/4	1/4	1/4
Depth of Deviation	Radius of Turn	Direction	Total Length
Measured Total Depth	True Vertical Depth	BHL From Lease, Unit, or Property Line:	

SEC	TWP	RGE	COUNTY
Spot Location	1/4	1/4	1/4
Depth of Deviation	Radius of Turn	Direction	Total Length
Measured Total Depth	True Vertical Depth	BHL From Lease, Unit, or Property Line:	