

Oklahoma Corporation Commission  
Oil & Gas Conservation Division  
Post Office Box 52000  
Oklahoma City, Oklahoma 73152-2000  
Rule 165: 10-3-25

Form 1002A

API No.: 35045237730001

**Completion Report**

Spud Date: November 21, 2018

OTC Prod. Unit No.:

Drilling Finished Date: November 22, 2018

1st Prod Date:

Completion Date: November 22, 2018

**Drill Type: STRAIGHT HOLE**

Well Name: JOHNSON TRUST 3205 3H

Purchaser/Measurer:

Location: ELLIS 32 18N 24W  
NE NE NW NE  
188 FNL 1629 FEL of 1/4 SEC  
Derrick Elevation: 0 Ground Elevation: 2364

First Sales Date:

Operator: EOG RESOURCES INC 16231

14701 HERTZ QUAIL SPRINGS PKWY  
OKLAHOMA CITY, OK 73134-2646

Completion Type		Location Exception		Increased Density	
	Single Zone	Order No		Order No	
	Multiple Zone	There are no Location Exception records to display.		There are no Increased Density records to display.	
	Commingled				

Casing and Cement							
Type	Size	Weight	Grade	Feet	PSI	SAX	Top of CMT
SURFACE	9 5/8	36	J-55	1054		555	SURFACE

Liner								
Type	Size	Weight	Grade	Length	PSI	SAX	Top Depth	Bottom Depth
There are no Liner records to display.								

**Total Depth: 1055**

Packer		Plug	
Depth	Brand & Type	Depth	Plug Type
There are no Packer records to display.		There are no Plug records to display.	

Initial Test Data										
Test Date	Formation	Oil BBL/Day	Oil-Gravity (API)	Gas MCF/Day	Gas-Oil Ratio Cu FT/BBL	Water BBL/Day	Pumpin or Flowing	Initial Shut-In Pressure	Choke Size	Flow Tubing Pressure
There are no Initial Data records to display.										
Completion and Test Data by Producing Formation										

Formation Name: NONE		Code:	Class: DRY
<b>Spacing Orders</b>		<b>Perforated Intervals</b>	
<b>Order No</b>	<b>Unit Size</b>	<b>From</b>	<b>To</b>
There are no Spacing Order records to display.		There are no Perf. Intervals records to display.	
<b>Acid Volumes</b>		<b>Fracture Treatments</b>	
NONE		NONE	

<b>Formation</b>	<b>Top</b>
------------------	------------

Were open hole logs run? No  
Date last log run:  
  
Were unusual drilling circumstances encountered? No  
Explanation:

<b>Other Remarks</b>
THE JOHNSON TRUST 3205 3H WAS DRILLED BY EOG RESOURCES, INC. (EOG) TO A TOTAL DEPTH OF 1,055'. THE WELL WAS NEVER COMPLETED. 9-5/8" SURFACE CASING HAS BEEN SET AT 1,054'. EOG FEELS THE WELLBORE RETAINS FUTURE UTILITY FOR HORIZONTAL DEVELOPMENT AND PLANS TO RE-ENTER THE WELL AT A LATER DATE. EOG IS IN THE PROCESS OF FILING FOR TEMPORARY EXEMPTION FROM PLUGGING THROUGH A HEARING WITH AN ALJ. PD NUMBER 202100069.

<b>FOR COMMISSION USE ONLY</b>	
Status: Accepted	1146413

API NO. 35-045-23773  
OTC PROD. N/A  
UNIT NO.

Oil and Gas Conservation Division  
P.O. Box 52000  
Oklahoma City, OK 73152-2000  
405-522-0577  
OCCentralProcessing@OCC.OK.GOV



OKLAHOMA  
Corporation  
Commission

Form 1002A  
Rev. 2020

ORIGINAL  
AMENDED (Reason)

Rule 165:10-3-25

COMPLETION REPORT

TYPE OF DRILLING OPERATION

☒ STRAIGHT HOLE ☐ DIRECTIONAL HOLE ☒ HORIZONTAL HOLE  
SERVICE WELL

If directional or horizontal, see reverse for bottom hole location.

COUNTY	ELLIS	SEC	32	TWP	18N	RGE	24W	SPUD DATE	11/21/18	
LEASE NAME	JOHNSON TRUST 3205							DRLG FINISHED DATE	11/22/18	
NE 1/4 NE 1/4 NW 1/4 NE 1/4 (FNL) 188 (FEL) 1629								DATE OF WELL COMPLETION	N/A 11-22-2018	
ELEVATION Derrick FL	Ground	2364	Latitude						1st PROD DATE	N/A
OPERATOR NAME	EOG RESOURCES, INC.							OTC / OCC OPERATOR NO.	16231	
ADDRESS	14701 HERTZ QUAIL SPRINGS PKWY									
CITY	OKLAHOMA CITY			STATE	OK		ZIP	73134		

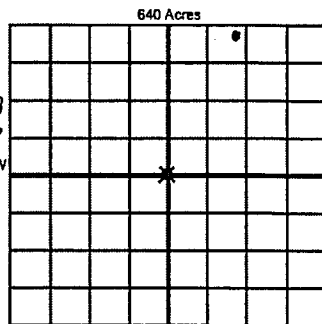

COMPLETION TYPE

<input checked="" type="radio"/> SINGLE ZONE	
<input type="radio"/> MULTIPLE ZONE	
Application Date	
<input type="radio"/> COMMINGLED	
Application Date	
LOCATION EXCEPTION ORDER NO.	694928, 708473
MULTIUNIT ORDER NO.	604927, 708472
INCREASED DENSITY ORDER NO.	673879, 661845, 673880, 691846

CASING & CEMENT (Attach Form 1002C)

TYPE	SIZE	WEIGHT	GRADE	FEET	PSI	SAX	TOP OF CMT
CONDUCTOR							
SURFACE	9-5/8	36	J-55	1054		555	SURFACE
INTERMEDIATE							
PRODUCTION							
LINER							1055

PACKER @ \_\_\_\_\_ BRAND & TYPE \_\_\_\_\_ PLUG @ \_\_\_\_\_ TYPE \_\_\_\_\_ PLUG @ \_\_\_\_\_ TYPE \_\_\_\_\_ TOTAL DEPTH 1055

COMPLETION & TEST DATA BY PRODUCING FORMATION

FORMATION	MARMATON					
SPACING & SPACING ORDER NUMBER	640/577799, 604003					
CLASS: Oil, Gas, Dry, Inj, Disp, Comm Disp, Svc	Dry					
PERFORATED INTERVALS	N/A					
ACID/VOLUME						
FRACTURE TREATMENT (Fluids/Prop Amounts)	N/A					

Min Gas Allowable (165:10-17-7)

Purchaser/Measurer

N/A



Oil Allowable (165:10-13-3)

First Sales Date

N/A

INITIAL TEST DATA

INITIAL TEST DATE	N/A					
OIL-BBL/DAY						
OIL-GRAVITY (API)						
GAS-MCF/DAY						
GAS-OIL RATIO CU FT/BBL						
WATER-BBL/DAY						
PUMPING OR FLOWING						
INITIAL SHUT-IN PRESSURE						
CHOKE SIZE						
FLOW TUBING PRESSURE						

RECEIVED

MAY 03 2021

OKLAHOMA CORPORATION  
COMMISSION

A record of the formations drilled through, and pertinent remarks are presented on the reverse. I declare that I have knowledge of the contents of this report and am authorized by my organization to make this report, which was prepared by me or under my supervision and direction, with the data and facts stated herein to be true, correct, and complete to the best of my knowledge and belief.

SIGNATURE Joni Reeder NAME (PRINT OR TYPE) JONI REEDER DATE 4/29/21 PHONE NUMBER 405-246-3100  
14701 HERTZ QUAIL SPRINGS PKWY OKLAHOMA CITY OK 73134  
ADDRESS CITY STATE ZIP EMAIL ADDRESS joni\_reeder@eogresources.com

PLEASE TYPE OR USE BLACK INK ONLY  
FORMATION RECORD

Give formation names and tops, if available, or descriptions and thickness of formations drilled through. Show intervals cored or drillstem tested.

NAMES OF FORMATIONS	TOP
<del>MARMATON</del>	<del>9450</del>

LEASE NAME JOHNSON TRUST 3205

WELL NO. 3H

FOR COMMISSION USE ONLY	
ITD on file	<input type="checkbox"/> YES <input type="checkbox"/> NO
APPROVED	DISAPPROVED
2) Reject Codes	

Were open hole logs run?	<input type="radio"/> yes <input checked="" type="radio"/> no
Date Last log was run	
Was CO <sub>2</sub> encountered?	<input type="radio"/> yes <input checked="" type="radio"/> no at what depths? _____
Was H <sub>2</sub> S encountered?	<input type="radio"/> yes <input checked="" type="radio"/> no at what depths? _____
Were unusual drilling circumstances encountered?	<input type="radio"/> yes <input checked="" type="radio"/> no
If yes, briefly explain below	

Other remarks: The Johnson Trust 3205 3H was drilled by EOG Resources, Inc. (EOG) to a TD of 1055'. The well was never completed. 9-5/8" surface casing has been set at 1054'. EOG feels the wellbore retains future utility for horizontal development and plans to re-enter the well at a later date. EOG is in the process of filing for Temporary Exemption from Plugging through a hearing with an ALJ. PD #202100069.

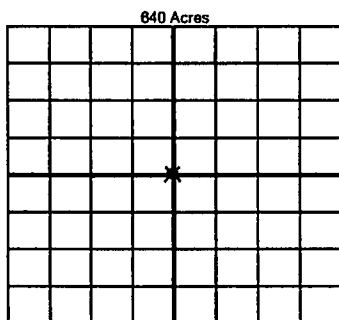

If more than three drainholes are proposed, attach a separate sheet indicating the necessary information.

Direction must be stated in degree azimuth. Please note, the horizontal drainhole and its end point must be located within the boundaries of the lease or spacing unit.

Directional surveys are required for all drainholes and directional wells

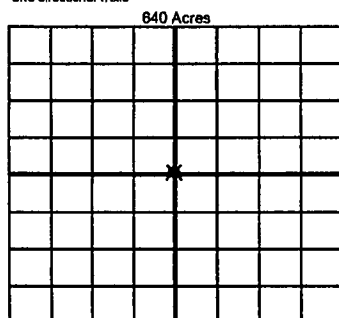

BOTTOM HOLE LOCATION FOR DIRECTIONAL HOLE

SEC	TWP	RGE	COUNTY
1/4	1/4	1/4	1/4
Measured Total Depth		True Vertical Depth	
		BHL From Lease, Unit, or Property Line:	

BOTTOM HOLE LOCATION FOR HORIZONTAL HOLE: (LATERALS)

LATERAL #1			
SEC	TWP	RGE	COUNTY
1/4	1/4	1/4	1/4
Depth of Deviation		Radius of Turn	Direction
Measured Total Depth		True Vertical Depth	Total Length
		BHL From Lease, Unit, or Property Line:	

LATERAL #2			
SEC	TWP	RGE	COUNTY
1/4	1/4	1/4	1/4
Depth of Deviation		Radius of Turn	Direction
Measured Total Depth		True Vertical Depth	Total Length
		BHL From Lease, Unit, or Property Line:	

LATERAL #3			
SEC	TWP	RGE	COUNTY
1/4	1/4	1/4	1/4
Depth of Deviation		Radius of Turn	Direction
Measured Total Depth		True Vertical Depth	Total Length
		BHL From Lease, Unit, or Property Line:	