

Oklahoma Corporation Commission
Oil & Gas Conservation Division
Post Office Box 52000
Oklahoma City, Oklahoma 73152-2000
Rule 165: 10-3-25

Form 1002A

API No.: 35065203140001

Completion Report

Spud Date: November 28, 2020

OTC Prod. Unit No.: 065-227139-0-0000

Drilling Finished Date: December 01, 2020

1st Prod Date: April 08, 2021

Completion Date: March 12, 2021

Drill Type: STRAIGHT HOLE

Well Name: SOUTHALL 5

Purchaser/Measurer:

Location: JACKSON 2 1N 20W
NE SE SW SW
358 FSL 1220 FWL of 1/4 SEC
Latitude: 34.580691 Longitude: -99.27721
Derrick Elevation: 1323 Ground Elevation: 1317

First Sales Date:

Operator: FULCRUM EXPLORATION LLC 22183

1401 SHOAL CREEK STE 290
HIGHLAND VILLAGE, TX 75077-3249

Completion Type		Location Exception		Increased Density	
X	Single Zone	Order No		Order No	
	Multiple Zone	716547		716415	
	Commingled				

Casing and Cement							
Type	Size	Weight	Grade	Feet	PSI	SAX	Top of CMT
SURFACE	8 5/8	24	J-55	294		190	SURFACE
PRODUCTION	5 1/2	17		1745		150	680

Liner								
Type	Size	Weight	Grade	Length	PSI	SAX	Top Depth	Bottom Depth
There are no Liner records to display.								

Total Depth: 1761

Packer	
Depth	Brand & Type
There are no Packer records to display.	

Plug	
Depth	Plug Type
There are no Plug records to display.	

Initial Test Data										
Test Date	Formation	Oil BBL/Day	Oil-Gravity (API)	Gas MCF/Day	Gas-Oil Ratio Cu FT/BBL	Water BBL/Day	Pumpin or Flowing	Initial Shut-In Pressure	Choke Size	Flow Tubing Pressure
Apr 08, 2021	PONTOTOC	12	40			5	PUMPING	435		

Completion and Test Data by Producing Formation			
Formation Name: PONTOTOC		Code: 419PNTC	Class: OIL
Spacing Orders		Perforated Intervals	
Order No	Unit Size	From	To
518513	160	1429	1444
Acid Volumes		Fracture Treatments	
750 GALLONS 15%		563 BARRELS SLICK WATER & 5,000 POUNDS 20/40 SAND, 10,000 POUNDS 40/70 SAND	

Formation	Top
PONTOTOC	1060
CISCO	1575
CANYON	1630

Were open hole logs run? Yes
Date last log run: December 01, 2020

Were unusual drilling circumstances encountered? No
Explanation:

Other Remarks
There are no Other Remarks.

FOR COMMISSION USE ONLY	
Status: Accepted	1146421

API NO. 065-20314
OTC PROD. UNIT NO. 652271390

Oil and Gas Conservation Division
P.O. Box 52000
Oklahoma City, OK 73152-2000
405-522-0577
OCCentralProcessing@OCC.OK.GOV



OKLAHOMA
Corporation
Commission

Form 1002A
Rev. 2020



ORIGINAL
AMENDED (Reason)

Rule 165:10-3-25

COMPLETION REPORT

TYPE OF DRILLING OPERATION

☒ STRAIGHT HOLE ☐ DIRECTIONAL HOLE ☐ HORIZONTAL HOLE
☐ SERVICE WELL

If directional or horizontal, see reverse for bottom hole location.

COUNTY	JACKSON	SEC	2	TWP	IN	RGE	20W	SPUD DATE	11-28-2020
LEASE NAME	SOUTHALL			WELL NO.	5	DATE OF WELL COMPLETION	3-12-2021	DRLG FINISHED DATE	12-1-2020
NE 1/4 SE 1/4 SW 1/4 SW 1/4	E3L 358			I-WL	1220	1st PROD DATE	4-8-2021	RECOMP DATE	
ELEVATION	1323	Ground	1317	Latitude	34.580691N	Longitude	-99.277210W	OTC/OCC OPERATOR NO.	22183
OPERATOR NAME	FULCRUM EXPLORATION, LLC.								
ADDRESS	1401 SHOAL CREEK Suite 290								
CITY	HIGHLAND VILLAGE			STATE	TEXAS	ZIP	75077		

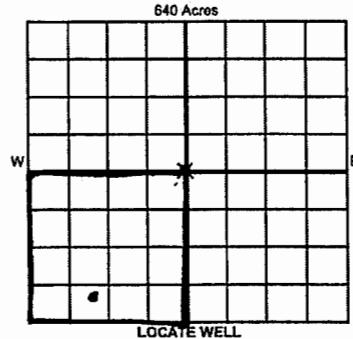

COMPLETION TYPE

<input checked="" type="radio"/> SINGLE ZONE	
<input type="radio"/> MULTIPLE ZONE	
<input type="radio"/> COMMINGLED	
LOCATION EXCEPTION ORDER NO.	716547
MULTIUNIT ORDER NO.	716546
INCREASED DENSITY ORDER NO.	716415

CASING & CEMENT (Attach Form 1002C)

TYPE	SIZE	WEIGHT	GRADE	FEET	PSI	SAX	TOP OF CMT
CONDUCTOR							
SURFACE	8 5/8	24lb	J55	294		190	Surface
INTERMEDIATE							
PRODUCTION	5 1/2	17lb		1745		150	680
LINER							

PACKER @ _____ BRAND & TYPE _____ PLUG @ _____ TYPE _____ PLUG @ _____ TYPE _____ TOTAL DEPTH 1761

COMPLETION & TEST DATA BY PRODUCING FORMATION

FORMATION	PERMIAN	Pontotoc	Reported to Frac Focus
SPACING & SPACING ORDER NUMBER	518513 (160)		
CLASS: Oil, Gas, Dry, Inj, Disp, Comm Disp, Svc	Oil		
PERFORATED INTERVALS	1429-1444		
ACID/VOLUME	750 Gals 15%		
FRACTURE TREATMENT (Fluids/Prop Amounts)	15,000 pound All sand together Slick Water 563 PZLs Frac 20/40 Sand 5000 pounds 40/70 Sand 10,000 pounds		

RECEIVED

MAY 07 2021

OKLAHOMA CORPORATION
COMMISSION

Min Gas Allowable (165:10-17-7)



OR

Oil Allowable (165:10-13-3)

Purchaser/Measurer

First Sales Date

INITIAL TEST DATA

INITIAL TEST DATE	4-8-2021				
OIL-BBL/DAY	12				
OIL-GRAVITY (API)	40				
GAS-MCF/DAY	N/A				
GAS-OIL RATIO CU FT/BBL	nan				
WATER-BBL/DAY	5				
PUMPING OR FLOWING	Pumping				
INITIAL SHUT-IN PRESSURE	435 lbs				
CHOKE SIZE	N/A				
FLOW TUBING PRESSURE	N/A				

A record of the operations drilled through, and pertinent remarks are presented on the reverse. I declare that I have knowledge of the contents of this report and am authorized by my organization to make this report, which was prepared by me or under my supervision and direction, with the data and facts stated herein to be true, correct, and complete to the best of my knowledge and belief.

SIGNATURE	Derek Jensen	DATE	4/26/2021	PHONE NUMBER	972-898-6044
ADDRESS	1401 Shoal Creek Suite 290	CITY	Highland Village	STATE	TX
		ZIP	75077	EMAIL ADDRESS	djensen@fulcrumexploration.com

PLEASE TYPE OR USE BLACK INK ONLY
FORMATION RECORD

Give formation names and tops, if available, or descriptions and thickness of formations drilled through. Show intervals cored or drillstem tested.

NAMES OF FORMATIONS	TOP
PONTOTOC	1060
CISCO	1575
CANYON	1630

LEASE NAME SOUTHALL WELL NO. 5

FOR COMMISSION USE ONLY	
ITD on file <input type="checkbox"/> YES <input type="checkbox"/> NO	
APPROVED _____	DISAPPROVED _____
2) Reject Codes	

Were open hole logs run?	<input checked="" type="radio"/> yes <input type="radio"/> no
Date Last log was run	12/1/2020
Was CO ₂ encountered?	<input type="radio"/> yes <input checked="" type="radio"/> no at what depths? _____
Was H ₂ S encountered?	<input type="radio"/> yes <input checked="" type="radio"/> no at what depths? _____
Were unusual drilling circumstances encountered?	<input type="radio"/> yes <input checked="" type="radio"/> no
If yes, briefly explain below	

Other remarks:

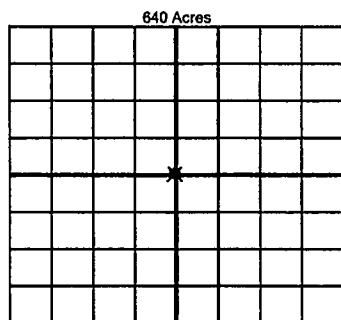

If more than three drainholes are proposed, attach a separate sheet indicating the necessary information.

Direction must be stated in degrees azimuth. Please note, the horizontal drainhole and its end point must be located within the boundaries of the lease or spacing unit.

Directional surveys are required for all drainholes and directional wells

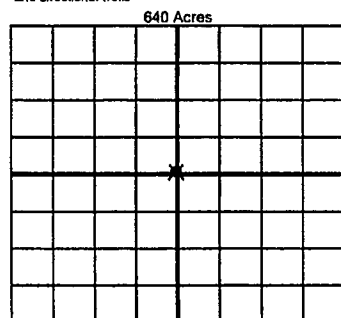

BOTTOM HOLE LOCATION FOR DIRECTIONAL HOLE

SEC	TWP	RGE	COUNTY
1/4	1/4	1/4	1/4
Measured Total Depth		True Vertical Depth	BHL From Lease, Unit, or Property Line:

BOTTOM HOLE LOCATION FOR HORIZONTAL HOLE: (LATERALS)

LATERAL #1

SEC	TWP	RGE	COUNTY
1/4	1/4	1/4	1/4
Depth of Deviation		Radius of Turn	Direction
Measured Total Depth		True Vertical Depth	BHL From Lease, Unit, or Property Line:

LATERAL #2

SEC	TWP	RGE	COUNTY
1/4	1/4	1/4	1/4
Depth of Deviation		Radius of Turn	Direction
Measured Total Depth		True Vertical Depth	BHL From Lease, Unit, or Property Line:

LATERAL #3

SEC	TWP	RGE	COUNTY
1/4	1/4	1/4	1/4
Depth of Deviation		Radius of Turn	Direction
Measured Total Depth		True Vertical Depth	BHL From Lease, Unit, or Property Line: