

Oklahoma Corporation Commission
Oil & Gas Conservation Division
Post Office Box 52000
Oklahoma City, Oklahoma 73152-2000
Rule 165: 10-3-25

Form 1002A

API No.: 35051355570002

Completion Report

Spud Date: July 14, 1956

OTC Prod. Unit No.: 051-08389-0-0000

Drilling Finished Date: November 09, 1956

1st Prod Date: November 26, 1956

Amended

Completion Date: November 26, 1956

Amend Reason: RECOMPLETION

Recomplete Date: August 27, 2020

Drill Type: STRAIGHT HOLE

Min Gas Allowable: Yes

Well Name: LODGE UNIT 1-4R

Purchaser/Measurer:

Location: GRADY 4 4N 5W
C NE SE
660 FNL 660 FEL of 1/4 SEC
Derrick Elevation: 1145 Ground Elevation: 1129

First Sales Date:

Operator: RED ROCKS OIL & GAS OPERATING LLC 22649

1321 N ROBINSON AVE STE A
OKLAHOMA CITY, OK 73103-4821

| Completion Type | | Location Exception | | Increased Density | |
|-----------------|---------------|---|--|--|--|
| X | Single Zone | Order No | | Order No | |
| | Multiple Zone | There are no Location Exception records to display. | | There are no Increased Density records to display. | |
| | Commingled | | | | |

| Casing and Cement | | | | | | | |
|-------------------|--------|---------|-------|-------|-----|------|------------|
| Type | Size | Weight | Grade | Feet | PSI | SAX | Top of CMT |
| CONDUCTOR | 16 | | | 120 | | 140 | |
| SURFACE | 10 3/4 | 40.5 | J-55 | 3117 | | 3500 | SURFACE |
| PRODUCTION | 7 | 26 - 35 | N-80 | 14034 | | 1100 | 8150 |

| Liner | | | | | | | | |
|-------|-------|--------|-------|--------|-----|-----|-----------|--------------|
| Type | Size | Weight | Grade | Length | PSI | SAX | Top Depth | Bottom Depth |
| LINER | 4 1/2 | | P-110 | 3769 | 0 | 0 | 9200 | 12969 |

Total Depth: 14179

| Packer | |
|---|--------------|
| Depth | Brand & Type |
| There are no Packer records to display. | |

| Plug | |
|-------|-----------------|
| Depth | Plug Type |
| 9200 | CEMENT RETAINER |
| 9234 | CIBP |

| Initial Test Data |
|-------------------|
|-------------------|

| Test Date | Formation | Oil BBL/Day | Oil-Gravity (API) | Gas MCF/Day | Gas-Oil Ratio Cu FT/BBL | Water BBL/Day | Pumpin or Flowing | Initial Shut-In Pressure | Choke Size | Flow Tubing Pressure |
|--------------|-----------|-------------|-------------------|-------------|-------------------------|---------------|-------------------|--------------------------|------------|----------------------|
| Oct 12, 2020 | HART | 6 | 39 | 13 | 2167 | 40 | PUMPING | 400 | W/O | 300 |

Completion and Test Data by Producing Formation

Formation Name: HART

Code: 404HART

Class: OIL

Spacing Orders

| Order No | Unit Size |
|----------|-----------|
| 711265 | 80 |

Perforated Intervals

| From | To |
|------|------|
| 9014 | 9178 |

Acid Volumes

There are no Acid Volume records to display.

Fracture Treatments

FRAC STAGE 1: 9,896 BARRELS SLICKWATER _
274,577 POUNDS 40/70 WHITE SAND

| Formation | Top |
|--------------------|-----|
| SEE ORIGINAL 1002A | 0 |

Were open hole logs run? No
Date last log run:

Were unusual drilling circumstances encountered? No
Explanation:

| Other Remarks |
|--|
| THERE IS A PLUG OVER THE PREVIOUS COMMINGLE ZONES (COMMINGLE ORDER NUMBER 524099). THE ONLY ZONE PRODUCING AT THIS TIME IS THE HART. OCC - PRESENT OPERATOR SAYS LINER RUN BACK IN 1966 , NO RECORDS, UNKNOWN IF CEMENTED. |

| FOR COMMISSION USE ONLY |
|-------------------------|
| Status: Accepted |
| 1146391 |

API NO. 35-051-35557
OTC PROD. UNIT NO. 051-08389-0-0000

Oil and Gas Conservation Division
P.O. Box 52000
Oklahoma City, OK 73152-2000
405-522-0577
OCCCentralProcessing@OCC.OK.GOV



OKLAHOMA
Corporation
Commission

Form 1002A
Rev. 2020

ORIGINAL AMENDED (Reason) HART Recompletion/Update Operator

Rule 165:10-3-25

COMPLETION REPORT

TYPE OF DRILLING OPERATION

☒ STRAIGHT HOLE ☐ DIRECTIONAL HOLE ☐ HORIZONTAL HOLE
☐ SERVICE WELL

If directional or horizontal, see reverse for bottom hole location.

| | | | | | | | |
|---------------|------------------------------------|--------|------|------------------------|-----------|-----|-------|
| COUNTY | Grady | SEC | 04 | TWP | 04N | RGE | 05W |
| LEASE NAME | LODGE UNIT | | | WELL NO. | 1-4R | | |
| 1/4 | C | 1/4 | NE | 1/4 | SE | 1/4 | FNL |
| ELEVATION | 1145 | Ground | 1129 | Latitude | Longitude | | |
| OPERATOR NAME | RED ROCKS OIL & GAS OPERATING, LLC | | | OTC / OCC OPERATOR NO. | 22649 | | |
| ADDRESS | 1321 N. ROBINSON AVE, STE A | | | | | | |
| CITY | OKLAHOMA CITY | | | STATE | OK | ZIP | 22649 |

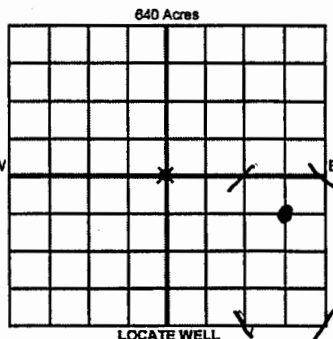

COMPLETION TYPE

| | |
|--|--|
| <input checked="" type="radio"/> SINGLE ZONE | |
| <input type="radio"/> MULTIPLE ZONE | |
| <input type="radio"/> Application Date | |
| <input type="radio"/> COMMINGLED | |
| <input type="radio"/> Application Date | |
| LOCATION EXCEPTION ORDER NO. | |
| MULTIUNIT ORDER NO. | |
| INCREASED DENSITY ORDER NO. | |

CASING & CEMENT (Attach Form 1002C)

| TYPE | SIZE | WEIGHT | GRADE | FEET | PSI | SAX | TOP OF CMT |
|--------------|--------|--------|-------|-------|-----|------|------------|
| CONDUCTOR | 16 | | | 120 | | 140 | |
| SURFACE | 10 3/4 | 40.5 | J-55 | 3117 | | 3500 | SURFACE |
| INTERMEDIATE | | | | | | | |
| PRODUCTION | 7 | 26-35 | N-80 | 14034 | | 1100 | 8150 |
| LINER | 4 1/2 | | P-110 | 12969 | | | |

PACKER @ _____ BRAND & TYPE _____ PLUG @ 9234' TYPE CBP PLUG @ _____ TYPE _____ TOTAL DEPTH 14179
PACKER @ _____ BRAND & TYPE _____ PLUG @ 9200 TYPE CMT RETAINER PLUG @ _____ TYPE _____

COMPLETION & TEST DATA BY PRODUCING FORMATION

| FORMATION | HART | HUNTON | WOODFORD | SYCAMORE | SPRINGER |
|---|---|---------------|---------------|-------------|---------------|
| SPACING & SPACING ORDER NUMBER | 711265/80 | 382317/80 | 382317/80 | 382317/80 | |
| CLASS: Oil, Gas, Dry, Inj, Disp, Comm Disp, Svc | Oil | Gas | Gas | Gas | Oil |
| | 9014-9178 | 12465-12830 | 12230-12290 | 12040-12130 | 9706-9762 |
| PERFORATED INTERVALS | | | | | 10261 - 10357 |
| ACID VOLUME | | | | | |
| FRACTURE TREATMENT (Fluids/Prop Amounts) | FRAC STAGE 1: SLICKWATER 9896 BBLs + 274577 LBS OF 40/70 WHITE SAND | YES 5919 BBLs | YES 6184 BBLs | | |

Recomplete Reported to Fractures

RECEIVED

APR 23 2021

OKLAHOMA CORPORATION COMMISSION

☒ Min Gas Allowable (165:10-17-7) OR ☐ Oil Allowable (165:10-13-3)

Purchaser/Measurer
First Sales Date

INITIAL TEST DATA

| | | | |
|--------------------------|------------|----------|----------|
| INITIAL TEST DATE | 10/12/2020 | 10/31/05 | 3/7/1981 |
| OIL-BBL/DAY | 6 | 27 | 63 |
| OIL-GRAVITY (API) | 39 | 51.2 | 39 |
| GAS-MCF/DAY | 13 | 1021 | 315 |
| GAS-OIL RATIO CU FT/BBL | 2167 | 37815 | 5000 |
| WATER-BBL/DAY | 40 | 10 | TRACE |
| PUMPING OR FLOWING | PUMPING | FLOWING | PUMPING |
| INITIAL SHUT-IN PRESSURE | 400 | 2800 | |
| CHOKE SIZE | W/O | 10/64 | |
| FLOW TUBING PRESSURE | 300 | 650 | |

A record of the formations drilled through, and pertinent remarks are presented on the reverse. I declare that I have knowledge of the contents of this report and am authorized by my organization to make this report, which was prepared by me or under my supervision and direction, with the data and facts stated herein to be true, correct, and complete to the best of my knowledge and belief.

Melanie Crawford

MELANIE CRAWFORD

04/19/2021 405-594-3412

SIGNATURE

NAME (PRINT OR TYPE)

DATE

PHONE NUMBER

1321 N ROBINSON AVE, STE A

OKLAHOMA CITY

OK

73103

MCRAWFORD@REDROCKSRESOURCES.COM

ADDRESS

CITY

STATE

ZIP

EMAIL ADDRESS

PLEASE TYPE OR USE BLACK INK ONLY
FORMATION RECORD

Give formation names and tops, if available, or descriptions and thickness of formations drilled through. Show intervals cored or drillstem tested.

| NAMES OF FORMATIONS | TOP |
|---------------------|-----|
| SEE ORIGINAL 1002A | |

LEASE NAME LODGE UNIT WELL NO. 1-4R

| FOR COMMISSION USE ONLY | |
|--|-----------------|
| ITD on file <input type="checkbox"/> YES <input type="checkbox"/> NO | |
| APPROVED <input type="checkbox"/> DISAPPROVED <input type="checkbox"/> | 2) Reject Codes |
| | |
| | |
| | |
| | |

| | |
|---|--|
| Were open hole logs run? | <input type="radio"/> yes <input checked="" type="radio"/> no |
| Date Last log was run | |
| Was CO ₂ encountered? | <input type="radio"/> yes <input type="radio"/> no at what depths? _____ |
| Was H ₂ S encountered? | <input type="radio"/> yes <input type="radio"/> no at what depths? _____ |
| Were unusual drilling circumstances encountered? If yes, briefly explain below | <input type="radio"/> yes <input type="radio"/> no |

Other remarks: PREVIOUSLY WAS TOLD TO FILE HARDCOPY WHEN THE OPERATOR IS DIFFERENT THAN THE LAST 1002A FILED:
THERE IS A PLUG OVER THE PREVIOUS COMMINGLE ZONES (COMMINGLE ORDER NO. 524099).
THE ONLY ZONE PRODUCING AT THIS TIME IS THE HART.

DCC - Present operator says liner run back in 1966 no records unknown if cemented

640 Acres

| | | | | | | | | | |
|--|--|--|--|--|--|--|--|--|--|
| | | | | | | | | | |
| | | | | | | | | | |
| | | | | | | | | | |
| | | | | | | | | | |
| | | | | | | | | | |
| | | | | | | | | | |
| | | | | | | | | | |
| | | | | | | | | | |
| | | | | | | | | | |
| | | | | | | | | | |

If more than three drainholes are proposed, attach a separate sheet indicating the necessary information.

Direction must be stated in degrees azimuth. Please note, the horizontal drainhole and its end point must be located within the boundaries of the lease or spacing unit.

Directional surveys are required for all drainholes and directional wells

640 Acres

| | | | | | | | | | |
|--|--|--|--|--|--|--|--|--|--|
| | | | | | | | | | |
| | | | | | | | | | |
| | | | | | | | | | |
| | | | | | | | | | |
| | | | | | | | | | |
| | | | | | | | | | |
| | | | | | | | | | |
| | | | | | | | | | |
| | | | | | | | | | |
| | | | | | | | | | |

BOTTOM HOLE LOCATION FOR DIRECTIONAL HOLE

| SEC | TWP | RGE | COUNTY |
|---|-----|---------------------|--------|
| 1/4 | 1/4 | 1/4 | 1/4 |
| Measured Total Depth | | True Vertical Depth | |
| Feet From 1/4 Sec Lines | | | |
| BHL From Lease, Unit, or Property Line: | | | |

BOTTOM HOLE LOCATION FOR HORIZONTAL HOLE: (LATERALS)

LATERAL #1

| SEC | TWP | RGE | COUNTY |
|---|-----|---------------------|--------|
| 1/4 | 1/4 | 1/4 | 1/4 |
| Depth of Deviation | | Radius of Turn | |
| Measured Total Depth | | True Vertical Depth | |
| Direction | | Total Length | |
| BHL From Lease, Unit, or Property Line: | | | |

LATERAL #2

| SEC | TWP | RGE | COUNTY |
|---|-----|---------------------|--------|
| 1/4 | 1/4 | 1/4 | 1/4 |
| Depth of Deviation | | Radius of Turn | |
| Measured Total Depth | | True Vertical Depth | |
| Direction | | Total Length | |
| BHL From Lease, Unit, or Property Line: | | | |

LATERAL #3

| SEC | TWP | RGE | COUNTY |
|---|-----|---------------------|--------|
| 1/4 | 1/4 | 1/4 | 1/4 |
| Depth of Deviation | | Radius of Turn | |
| Measured Total Depth | | True Vertical Depth | |
| Direction | | Total Length | |
| BHL From Lease, Unit, or Property Line: | | | |