

Oklahoma Corporation Commission
Oil & Gas Conservation Division
Post Office Box 52000
Oklahoma City, Oklahoma 73152-2000
Rule 165: 10-3-25

Form 1002A

API No.: 35005204580001

Completion Report

Spud Date: January 05, 2015

OTC Prod. Unit No.: 005-226116-0-0000

Drilling Finished Date: March 14, 2015

Amended

1st Prod Date: November 25, 2019

Amend Reason: COMPLETION OF PIPELINE / WELL NOW PRODUCING

Completion Date: July 17, 2015

Recomplete Date: November 25, 2019

Drill Type: HORIZONTAL HOLE

Min Gas Allowable: Yes

Well Name: BLOOMFIELD 1H-21

Purchaser/Measurer: ENABLE MIDSTREAM

Location: ATOKA 21 2S 12E
E2 NE NE NW
2310 FSL 2390 FWL of 1/4 SEC
Latitude: 34.3736 Longitude: -96.0497
Derrick Elevation: 719 Ground Elevation: 689

First Sales Date: 11/25/2019

Operator: G & S ENERGY INC 22818

4201 FM 1960 RD W STE 400
HOUSTON, TX 77068-3447

Completion Type		Location Exception		Increased Density	
X	Single Zone	Order No		Order No	
	Multiple Zone	645825		There are no Increased Density records to display.	
	Commingled				

Casing and Cement							
Type	Size	Weight	Grade	Feet	PSI	SAX	Top of CMT
CONDUCTOR	20	90		32			SURFACE
SURFACE	9.623	40	J-55	1516		540	SURFACE
PRODUCTION	5.5	23	P-110	12380		1650	7606

Liner								
Type	Size	Weight	Grade	Length	PSI	SAX	Top Depth	Bottom Depth
There are no Liner records to display.								

Total Depth: 12396

Packer		Plug	
Depth	Brand & Type	Depth	Plug Type
9350	WFD A51-X	There are no Plug records to display.	

Initial Test Data

Test Date	Formation	Oil BBL/Day	Oil-Gravity (API)	Gas MCF/Day	Gas-Oil Ratio Cu FT/BBL	Water BBL/Day	Pumpin or Flowing	Initial Shut-In Pressure	Choke Size	Flow Tubing Pressure
Aug 10, 2015	BIG FORK			1176		540	FLOWING	1500	48/64	190
Nov 27, 2019	BIG FORK			225		130	FLOWING	2900	18/64	1100

Completion and Test Data by Producing Formation

Formation Name: BIG FORK

Code: 202BGFK

Class: GAS

Spacing Orders

Order No	Unit Size
634342	640

Perforated Intervals

From	To
9854	12188

Acid Volumes

12,000 GALLONS

Fracture Treatments

57,416 BARRELS FLUID, 2,087,798 POUNDS PROPPANT

Formation	Top
ARKANSAS NOVACULITE	8485
POLK CREEK	9096
BIG FORK	9230
WOMBLE	10029

Were open hole logs run? Yes

Date last log run: February 05, 2015

Were unusual drilling circumstances encountered? No

Explanation:

Other Remarks

OCC - THIS WELL'S 640 ACRE UNIT IS AN IRREGULAR 640 COMPRISING E/2 SEC 21 AND W/2 SECTION 22 OF 2S-12E.

Lateral Holes

Sec: 21 TWP: 2S RGE: 12E County: ATOKA

SE NE NE NE

449 FNL 2663 FWL of 1/4 SEC

Depth of Deviation: 9063 Radius of Turn: 881 Direction: 96 Total Length: 2452

Measured Total Depth: 12396 True Vertical Depth: 10206 End Pt. Location From Release, Unit or Property Line: 449

FOR COMMISSION USE ONLY

1144480

Status: Accepted

API NO. 3500520458
OTC PROD. UNIT NO. 005-226116-0-0000

(PLEASE TYPE OR USE BLACK INK ONLY)

OKLAHOMA CORPORATION COMMISSION
Oil & Gas Conservation Division
Post Office Box 52000
Oklahoma City, Oklahoma 73152-2000
Rule 165-10-3-25

RECEIVED
DEC 11 2019
Form 1002A
Rev. 2009

☐ ORIGINAL
☒ AMENDED (Reason)

completion of pipeline to connect

TYPE OF DRILLING OPERATION

☐ STRAIGHT HOLE ☐ DIRECTIONAL HOLE ☒ HORIZONTAL HOLE

If directional or horizontal, see reverse for bottom hole location.

COUNTY	Atoka	SEC	21	TWP	2S	RGE	12E
LEASE NAME	Bloomfield			WELL NO.	1H-21		
NE 1/4 NE 1/4 NE 1/4 NW 1/4	FSL OF 1/4 SEC 2310			FWL OF 1/4 SEC	2390		
ELEVATION	719	Ground	689	Latitude (if known)	34.3736		Longitude (if known)
OPERATOR NAME	G&S Energy, Inc.			OTC / OCC OPERATOR NO.	22818		
ADDRESS	4201 Cypress Creek Pkwy., Ste. 400						
CITY	Houston		STATE	TX	ZIP	77068	

COMPLETION TYPE

<input checked="" type="checkbox"/> SINGLE ZONE	
<input type="checkbox"/> MULTIPLE ZONE	
Application Date	
COMINGLED	
Application Date	
LOCATION EXCEPTION ORDER NO.	645825
INCREASED DENSITY ORDER NO.	

CASING & CEMENT (Attach Form 1002C)

TYPE	SIZE	WEIGHT	GRADE	FEET	PSI	SAX	TOP OF CMT
CONDUCTOR	20	90		32		pour	surface
SURFACE	9.623	40	J55	1516		540	surface
INTERMEDIATE							
PRODUCTION	5.5	23	P110	12380		1650	7606
LINER							
							TOTAL DEPTH 12,398

PACKER @ 9,350 BRAND & TYPE wfd. A51-X

PACKER @ BRAND & TYPE

PLUG @ TYPE PLUG @ TYPE PLUG @ TYPE

COMPLETION & TEST DATA BY PRODUCING FORMATION

FORMATION	Big Fork
SPACING & SPACING ORDER NUMBER	640 Acres, 634342
CLASS: Oil, Gas, Dry, Inj, Disp, Comm Disp, Svc	GAS
PERFORATED INTERVALS	9,854 - 12,188 / 2251
ACID/VOLUME	12,000 gal.
FRACTURE TREATMENT (Fluids/Prop Amounts)	57,416 bbls Fluid 2,087,798 lbs Prop



Min Gas Allowable (165-10-17-7)
OR
Oil Allowable (165-10-13-3)

Gas Purchaser/Measurer
First Sales Date

Enable Midstream
11/25/2019

INITIAL TEST DATA

INITIAL TEST DATE	8/10/2015	11-27-219
OIL-BBL/DAY	-	-
OIL-GRAVITY (API)	-	-
GAS-MCF/DAY	1176	225
GAS-OIL RATIO CU FT/BBL	-	-
WATER-BBL/DAY	540	130
PUMPING OR FLOWING	Flow	Flowing
INITIAL SHUT-IN PRESSURE	1500	2900
CHOKE SIZE	48/64	18/64
FLOW TUBING PRESSURE	190	1100

AS SUBMITTED

A record of the formations drilled through, and pertinent remarks are presented on the reverse. I declare that I have knowledge of the contents of this report and am authorized by my organization to make this report, which was prepared by me or under my supervision and direction, with the data and facts stated herein to be true, correct, and complete to the best of my knowledge and belief.

SIGNATURE

David Padgett

12/11/2019 281-537-2035

4201 Cypress Creek Pkwy., Ste. 400

Houston

TX

77068

ADDRESS

CITY

STATE

ZIP

DATE

PHONE NUMBER

dpadge@sbcglobal.net

EMAIL ADDRESS

PLEASE TYPE OR USE BLACK INK ONLY
FORMATION RECORD

Give formation names and tops, if available, or descriptions and thickness of formations drilled through. Show intervals cored or drillstem tested.

NAMES OF FORMATIONS	TOP
Arkansas Novaculite	8,485
Polk Creek	9,096
Big Fork	9,230
Womble	10,029

LEASE NAME Bloomfield

WELL NO. 1H-21

FOR COMMISSION USE ONLY

ITD on file ☐ YES ☐ NO

APPROVED ☐ DISAPPROVED ☐

2) Reject Codes

Were open hole logs run? ☒ yes ☐ no

Date Last log was run 2/5/2015

Was CO₂ encountered? ☐ yes ☒ no at what depths? _____

Was H₂S encountered? ☐ yes ☒ no at what depths? _____

Were unusual drilling circumstances encountered? ☐ yes ☒ no

If yes, briefly explain below _____

Other remarks:

OCC-This well's 640 acre unit is an irregular 640 comprising E1/2 Sec 21 and W1/2 Section 22 of 25-12E

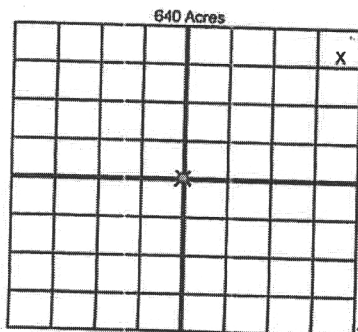

If more than three drainholes are proposed, attach a separate sheet indicating the necessary information.

Direction must be stated in degrees azimuth. Please note, the horizontal drainhole and its end point must be located within the boundaries of the lease or spacing unit.

Directional surveys are required for all drainholes and directional wells.

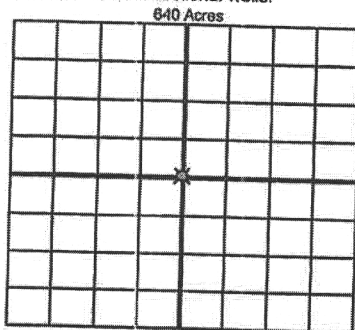

BOTTOM HOLE LOCATION FOR DIRECTIONAL HOLE

SEC	TWP	RGE	COUNTY
Spot Location	1/4	1/4	1/4
Measured Total Depth	True Vertical Depth	BHL From Lease, Unit, or Property Line:	

BOTTOM HOLE LOCATION FOR HORIZONTAL HOLE: (LATERALS)

LATERAL #1

SEC	TWP	RGE	COUNTY
SEC 21	2S	12E	Atoka
Spot Location	NE 1/4	NE 1/4	NE 1/4
Depth of Deviation	9,063'	Radius of Turn	98' 98'
Measured Total Depth	12,366	True Vertical Depth	10,206
BHL From Lease, Unit, or Property Line:		FSL 4834' FWL 2663'	

4,834' FSL, 2,663' FWL 449

LATERAL #2

SEC	TWP	RGE	COUNTY
Spot Location	1/4	1/4	1/4
Depth of Deviation	Radius of Turn	Direction	Total Length
Measured Total Depth	True Vertical Depth	BHL From Lease, Unit, or Property Line:	

LATERAL #3

SEC	TWP	RGE	COUNTY
Spot Location	1/4	1/4	1/4
Depth of Deviation	Radius of Turn	Direction	Total Length
Measured Total Depth	True Vertical Depth	BHL From Lease, Unit, or Property Line:	

11/25/19
Oklahoma Corporation Commission
Oil & Gas Conservation Division
Post Office Box 52000
Oklahoma City, Oklahoma 73152-2000
Rule 165: 10-3-25

Form 1002A

1002A
Addendum

API No.: 0005204580001

Completion Report

Spud Date: January 05, 2015

OTC Prod. Unit No.: 005-226116-0-0000

Drilling Finished Date: March 14, 2015

Amended

1st Prod Date: November 25, 2019

Amend Reason: COMPLETION OF PIPELINE / WELL NOW PRODUCING

Completion Date: July 17, 2015

Recomplete Date: November 25, 2019

Drill Type: HORIZONTAL HOLE

Min Gas Allowable: Yes

Well Name: BLOOMFIELD 1H-21

Purchaser/Measurer: ENABLE MIDSTREAM

Location: ATOKA 21 2S 12E
E2 NE NE NW
2310 FSL 2390 FWL of 1/4 SEC
Latitude: 34.3736 Longitude: -96.0497
Derrick Elevation: 719 Ground Elevation: 689

First Sales Date: 11/25/2019

Operator: G & S ENERGY INC 22818

4201 FM 1960 RD W STE 400
HOUSTON, TX 77068-3447

Completion Type	
X	Single Zone
	Multiple Zone
	Commingled

Location Exception	
Order No	
645825	

Increased Density	
Order No	
There are no Increased Density records to display.	

SP: 634342
inreg E2 21 x W2 22

Casing and Cement							
Type	Size	Weight	Grade	Feet	PSI	SAX	Top of CMT
CONDUCTOR	20	90		32			SURFACE
SURFACE	9.623	40	J-55	1516		540	SURFACE
PRODUCTION	5.5	23	P-110	12380		1650	7606

Liner								
Type	Size	Weight	Grade	Length	PSI	SAX	Top Depth	Bottom Depth
There are no Liner records to display.								

Total Depth: 12396

Packer	
Depth	Brand & Type
9350	WFD A51-X

Plug	
Depth	Plug Type
There are no Plug records to display.	

Initial Test Data

January 17, 2020

11/27/19 202 BGFK 2900