

Oklahoma Corporation Commission
Oil & Gas Conservation Division
Post Office Box 52000
Oklahoma City, Oklahoma 73152-2000
Rule 165: 10-3-25

Form 1002A

API No.: 35005204560001

Completion Report

Spud Date: October 12, 2014

OTC Prod. Unit No.: 005-226112-0-0000

Drilling Finished Date: December 28, 2014

Amended

1st Prod Date: November 19, 2019

Amend Reason: COMPLETION OF PIPELINE / WELL NOW PRODUCING

Completion Date: April 28, 2015

Recomplete Date: November 19, 2019

Drill Type: HORIZONTAL HOLE

Min Gas Allowable: Yes

Well Name: COCHRAN 1H-20

Purchaser/Measurer: ENABLE MIDSTREAM

Location: ATOKA 20 2S 12E
SW NE SW NE
967 FSL 820 FWL of 1/4 SEC
Latitude: 34.36995 Longitude: -96.0637
Derrick Elevation: 570 Ground Elevation: 540

First Sales Date: 11/19/2019

Operator: G & S ENERGY INC 22818

4201 FM 1960 RD W STE 400
HOUSTON, TX 77068-3447

Completion Type		Location Exception		Increased Density	
X	Single Zone	Order No		Order No	
	Multiple Zone	656312		There are no Increased Density records to display.	
	Commingled				

Casing and Cement							
Type	Size	Weight	Grade	Feet	PSI	SAX	Top of CMT
CONDUCTOR	20	90		80			SURFACE
SURFACE	13.375	54.5	J-55	1500		1190	SURFACE
PRODUCTION	5.5	23	P-110	11456		1460	6510

Liner								
Type	Size	Weight	Grade	Length	PSI	SAX	Top Depth	Bottom Depth
There are no Liner records to display.								

Total Depth: 11456

Packer		Plug	
Depth	Brand & Type	Depth	Plug Type
8212	WFD A51-X	There are no Plug records to display.	

Initial Test Data

Test Date	Formation	Oil BBL/Day	Oil-Gravity (API)	Gas MCF/Day	Gas-Oil Ratio Cu FT/BBL	Water BBL/Day	Pumpin or Flowing	Initial Shut-In Pressure	Choke Size	Flow Tubing Pressure
Jun 29, 2015	BIG FORK			1866		900	FLOWING	1500	48	251
Nov 27, 2019	BIG FORK			874		486	FLOWING	2500	18/64	1100

Completion and Test Data by Producing Formation									
Formation Name: BIG FORK				Code: 202BGFK			Class: GAS		
Spacing Orders				Perforated Intervals					
Order No		Unit Size		From			To		
633114		640		8328			11266		
Acid Volumes				Fracture Treatments					
21,000 GALLONS				1,041,591 GALLONS, SBM DELTA FRAC 200, 3,393,320 POUNDS PROPPANT					

Formation	Top
ARKANSAS NOVACULITE	7414
MISSOURI MOUNTAIN	7794
POLK CREEK	7960
BIG FORK	8160
WOMBLE	8610

Were open hole logs run? Yes
 Date last log run: November 24, 2014

 Were unusual drilling circumstances encountered? No
 Explanation:

Other Remarks
OCC - THIS WELL'S 640 ACRE UNIT IS IRREGULAR COMPRISING E/2 SEC 20 AND W/2 SEC 21 OF 2S-12E.

Lateral Holes
Sec: 21 TWP: 2S RGE: 12E County: ATOKA NE SE SW NW 2063 FNL 1514 FEL of 1/4 SEC Depth of Deviation: 7825 Radius of Turn: 693 Direction: 102 Total Length: 2938 Measured Total Depth: 11456 True Vertical Depth: 9194 End Pt. Location From Release, Unit or Property Line: 1514

FOR COMMISSION USE ONLY
<div>Status: Accepted</div> <div>1144478</div>

API NO. 3500520456
OTC PROD. UNIT NO. 005-226112

(PLEASE TYPE OR USE BLACK INK ONLY)

OKLAHOMA CORPORATION COMMISSION
Oil & Gas Conservation Division
Post Office Box 52000
Oklahoma City, Oklahoma 73152-2000
Rule 165-10-3-25

RECEIVED
DEC 11 2019
Form 1002A
Rev. 2009

☐ ORIGINAL
☒ AMENDED (Reason)

completion of pipeline to connect

TYPE OF DRILLING OPERATION

☐ STRAIGHT HOLE ☐ DIRECTIONAL HOLE ☒ HORIZONTAL HOLE

If directional or horizontal, see reverse for bottom hole location.

COUNTY	Atoka	SEC	20	TWP	2S	RGE	12E	SPUD DATE	10-12-14
LEASE NAME	Cochran			WELL NO.	1H-20			DRLG FINISHED DATE	12-28-14
SW 1/4 NE 1/4 SW 1/4 NE 1/4	FSL OF 1/4 SEC 967			FWL OF 1/4 SEC 820			DATE OF WELL COMPLETION	4-28-15	
ELEVATION Denick FL	570	Ground	540	Latitude (if known) 34.36995			1st PROD DATE	11-19-19	
OPERATOR NAME G&S Energy, Inc.				OTC / OCC OPERATOR NO.			22818	RECOMP DATE	11-19-19
ADDRESS 4201 Cypress Creek Pkwy., Ste. 400									
CITY Houston			STATE	TX	ZIP	77068			

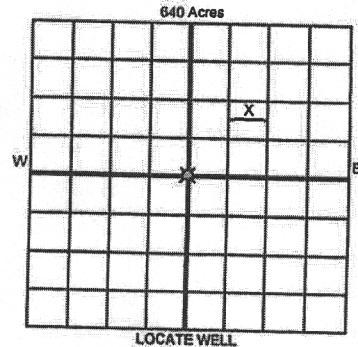

COMPLETION TYPE

<input checked="" type="checkbox"/> SINGLE ZONE	
<input type="checkbox"/> MULTIPLE ZONE	
<input type="checkbox"/> Application Date	
<input type="checkbox"/> COMINGLED	
<input type="checkbox"/> Application Date	
LOCATION EXCEPTION ORDER NO.	656312
INCREASED DENSITY ORDER NO.	

CASING & CEMENT (Attach Form 1002C)

TYPE	SIZE	WEIGHT	GRADE	FEET	PSI	SAX	TOP OF CMT
CONDUCTOR	20	90		80		pour	surface
SURFACE	13.375	54.5	J55	1500		1190	surface
INTERMEDIATE							
PRODUCTION	5.5	23	P110	11456		1460	6510
LINER							
						TOTAL DEPTH	11,456

PACKER @ 8,212 BRAND & TYPE wfd. A51-X

PACKER @ BRAND & TYPE

PLUG @ TYPE PLUG @ TYPE
PLUG @ TYPE PLUG @ TYPE

COMPLETION & TEST DATA BY PRODUCING FORMATION

FORMATION	Big Fork					
SPACING & SPACING ORDER NUMBER	640 Acres, 633114					
CLASS: Oil, Gas, Dry, Inj, Disp, Comm Disp, Svc	GAS					
PERFORATED INTERVALS	11,266' - 8,328'					
ACID/VOLUME	21,000 gal.					
FRACTURE TREATMENT (Fluids/Prop Amounts)	1,041,591 gal. SBM Delta frac 200 3,393,320 lbs prop					



Min Gas Allowable (165-10-17-7)
OR
Oil Allowable (165-10-13-3)

Gas Purchaser/Measurer
First Sales Date

Enable Midstream
11/19/2019

INITIAL TEST DATA

INITIAL TEST DATE	6/29/2015	11-27-2019			
OIL-BBL/DAY	-	-			
OIL-GRAVITY (API)	-	-			
GAS-MCF/DAY	1866	874			
GAS-OIL RATIO CU FT/BBL	-	-			
WATER-BBL/DAY	900	486			
PUMPING OR FLOWING	Flow	Flowing			
INITIAL SHUT-IN PRESSURE	1500	2500			
CHOKE SIZE	48	10/64			
FLOW TUBING PRESSURE	251	1100			

AS SUBMITTED

A record of the formations drilled through, and pertinent remarks are presented on the reverse. I declare that I have knowledge of the contents of this report and am authorized by my organization to make this report, which was prepared by me or under my supervision and direction, with the data and facts stated herein to be true, correct, and complete to the best of my knowledge and belief.

SIGNATURE

David Padgett

12/11/2019 281-537-2035

4201 Cypress Creek Pkwy., Ste. 400

Houston

NAME (PRINT OR TYPE)

TX 77068

DATE

PHONE NUMBER

ADDRESS

CITY

STATE

ZIP

dpadge@sbcglobal.net

EMAIL ADDRESS

PLEASE TYPE OR USE BLACK INK ONLY
FORMATION RECORD

Give formation names and tops, if available, or descriptions and thickness of formations drilled through. Show intervals cored or drillstem tested.

NAMES OF FORMATIONS	TOP
Arkansas Novaculite	7,414
Missouri Mountain	7,794
Polk Creek	7,960
Big Fork	8,160
Womble	8,610

LEASE NAME Cochran

WELL NO. 1H-20

FOR COMMISSION USE ONLY

ITD on file ☐ YES ☐ NO

APPROVED _____ DISAPPROVED _____

2) Reject Codes

Were open hole logs run? ☒ yes ☐ no

Date Last log was run 11/24/2014

Was CO₂ encountered? ☐ yes ☒ no at what depths? _____

Was H₂S encountered? ☐ yes ☒ no at what depths? _____

Were unusual drilling circumstances encountered? ☐ yes ☒ no
If yes, briefly explain below

Other remarks:

DCC-This well's 640 acre unit is irregular comprising E/2 Sec 20 and W/2 Sec 21 of T2S-12E.

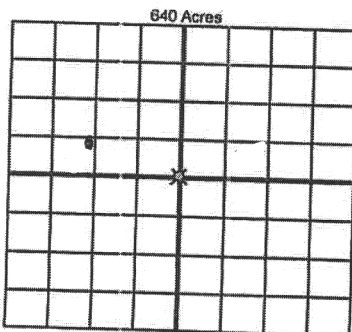

If more than three drainholes are proposed, attach a separate sheet indicating the necessary information.

Direction must be stated in degrees azimuth. Please note, the horizontal drainhole and its end point must be located within the boundaries of the lease or spacing unit.

Directional surveys are required for all drainholes and directional wells.

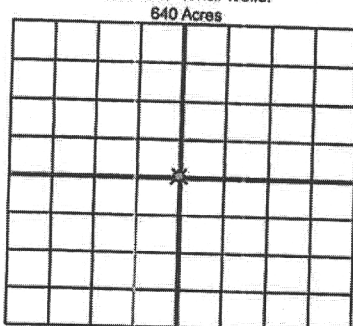

BOTTOM HOLE LOCATION FOR DIRECTIONAL HOLE

SEC	TWP	RGE	COUNTY
Spot Location			
1/4	1/4	1/4	1/4
Measured Total Depth		True Vertical Depth	BHL From Lease, Unit, or Property Line:

BOTTOM HOLE LOCATION FOR HORIZONTAL HOLE: (LATERALS)

LATERAL #1

SEC	TWP	RGE	COUNTY
21	2S	12E	Atoka
Spot Location			
NW 1/4	SE 1/4	SW 1/4	NE 1/4
Depth of Deviation	7825'	Radius of Turn	102.100'
Measured Total Depth	11,456	True Vertical Depth	9,194
BHL From Lease, Unit, or Property Line:		2063' FNL, 1514' FEL	

LATERAL #2

SEC	TWP	RGE	COUNTY
Spot Location			
1/4	1/4	1/4	1/4
Depth of Deviation	Radius of Turn	Direction	Total Length
Measured Total Depth	True Vertical Depth	BHL From Lease, Unit, or Property Line:	

LATERAL #3

SEC	TWP	RGE	COUNTY
Spot Location			
1/4	1/4	1/4	1/4
Depth of Deviation	Radius of Turn	Direction	Total Length
Measured Total Depth	True Vertical Depth	BHL From Lease, Unit, or Property Line:	

11/27/19
Oklahoma Corporation Commission
Oil & Gas Conservation Division
Post Office Box 52000
Oklahoma City, Oklahoma 73152-2000
Rule 165: 10-3-25

Form 1002A

1002A
Addendum

API No.: 0005204560001

Completion Report

Spud Date: October 12, 2014

OTC Prod. Unit No.: 005-226112-0-0000

Drilling Finished Date: December 28, 2014

Amended

A: 226112 I

1st Prod Date: November 19, 2019

Amend Reason: COMPLETION OF PIPELINE / WELL NOW PRODUCING

Completion Date: April 28, 2015

Recomplete Date: November 19, 2019

Drill Type: HORIZONTAL HOLE

Min Gas Allowable: Yes

Well Name: COCHRAN 1H-20

Purchaser/Measurer: ENABLE MIDSTREAM

Location: ATOKA 20 2S 12E (54) BHL: 21-02S-12E
SW NE SW NE
967 FSL 820 FWL of 1/4 SEC
Latitude: 34.36995 Longitude: -96.0637
Derrick Elevation: 570 Ground Elevation: 540
NE SE SW NW

First Sales Date: 11/19/2019

Operator: G & S ENERGY INC 22818

4201 FM 1960 RD W STE 400
HOUSTON, TX 77068-3447

Completion Type		Location Exception		Increased Density	
X	Single Zone	Order No		Order No	
	Multiple Zone	656312		There are no Increased Density records to display.	
	Commingled				

SP: 633114
(Ineq. E220 &
W2 21)

Casing and Cement							
Type	Size	Weight	Grade	Feet	PSI	SAX	Top of CMT
CONDUCTOR	20	90		80			SURFACE
SURFACE	13.375	54.5	J-55	1500		1190	SURFACE
PRODUCTION	5.5	23	P-110	11456		1460	6510

Liner								
Type	Size	Weight	Grade	Length	PSI	SAX	Top Depth	Bottom Depth
There are no Liner records to display.								

Total Depth: 11456

Packer		Plug	
Depth	Brand & Type	Depth	Plug Type
8212	WFD A51-X	There are no Plug records to display.	

Initial Test Data

January 17, 2020

202 BGFK

2500