

Oklahoma Corporation Commission
Oil & Gas Conservation Division
Post Office Box 52000
Oklahoma City, Oklahoma 73152-2000
Rule 165: 10-3-25

Form 1002A

API No.: 35071244410002

Completion Report

Spud Date: October 05, 2011

OTC Prod. Unit No.: 071-206471-0-0000

Drilling Finished Date: October 13, 2011

Amended

1st Prod Date: June 11, 2012

Amend Reason: ADD PERFORATIONS / ACIDIZE AND FRAC CLEVELAND / SET CIBP AT 3,456'

Completion Date: June 08, 2021

Recomplete Date: July 23, 2021

Drill Type: STRAIGHT HOLE

Well Name: DENNIS 1-27

Purchaser/Measurer:

Location: KAY 27 29N 1W
C SW SE
660 FSL 660 FWL of 1/4 SEC
Derrick Elevation: 1115 Ground Elevation: 1105

First Sales Date:

Operator: BARBER OIL LLC 24363

8801 S YALE AVE STE 150
TULSA, OK 74137-3575

Completion Type		Location Exception		Increased Density	
	Single Zone	Order No		Order No	
	Multiple Zone	There are no Location Exception records to display.		There are no Increased Density records to display.	
X	Commingled				

Casing and Cement							
Type	Size	Weight	Grade	Feet	PSI	SAX	Top of CMT
SURFACE	8 5/8	24	J	308		250	SURFACE
PRODUCTION	5 1/2	15.5	J-55	3710		275	2100

Liner								
Type	Size	Weight	Grade	Length	PSI	SAX	Top Depth	Bottom Depth
There are no Liner records to display.								

Total Depth: 3710

Packer		Plug	
Depth	Brand & Type	Depth	Plug Type
There are no Packer records to display.		3456	CIBP

Initial Test Data

Test Date	Formation	Oil BBL/Day	Oil-Gravity (API)	Gas MCF/Day	Gas-Oil Ratio Cu FT/BBL	Water BBL/Day	Pumpin or Flowing	Initial Shut-In Pressure	Choke Size	Flow Tubing Pressure
May 01, 2012	BIG LIME-OSWEGO	5	40	80	16000	5	FLOWING	500	1/4	40
Jun 08, 2012	CLEVELAND	18	41	300	16667	2	FLOWING	650	1/4	130
Jul 23, 2021	CLEVELAND	0.25	41			27	PUMPING			

Completion and Test Data by Producing Formation

Formation Name: CLEVELAND

Code: 405CLVD

Class: OIL

Spacing Orders

Order No	Unit Size
NONE	

Perforated Intervals

From	To
3185	3232

Acid Volumes

2,500 GALLONS

Fracture Treatments

NONE

Formation Name: CLEVELAND

Code: 405CLVD

Class: OIL

Spacing Orders

Order No	Unit Size
NONE	

Perforated Intervals

From	To
3185	3207

Acid Volumes

2,000 GALLONS

Fracture Treatments

663 BARRELS, 41,125 POUNDS SAND - ORIGINAL TREATMENT
--

Formation Name: BIG LIME-OSWEGO

Code: 404BGLO

Class: OIL

Spacing Orders

Order No	Unit Size
NONE	

Perforated Intervals

From	To
3314	3354

Acid Volumes

2,500 GALLONS

Fracture Treatments

NONE

Formation	Top
CLEVELAND	3184
BIG LIME-OSWEGO	3262
MISSISSIPPI	33456
WILCOX	3650

Were open hole logs run? Yes

Date last log run: October 11, 2011

Were unusual drilling circumstances encountered? No

Explanation:

Other Remarks

There are no Other Remarks.

FOR COMMISSION USE ONLY

1146999

Status: Accepted

API NO. 35-071-24441
OTC PROD. UNIT NO. 071-206471

Oil and Gas Conservation Division
P.O. Box 52000
Oklahoma City, OK 73152-2000
405-522-0577
OCCCentralProcessing@OCC.OK.GOV



OKLAHOMA RECEIVED
Corporation Commission
OCT 08 2021

Form 1002A
Rev. 2020

ORIGINAL AMENDED (Reason) add perfs, acidize and frac Cleveland / set CIBP 3456 Rule 165:10-3-25 COMPLETION REPORT

TYPE OF DRILLING OPERATION

☒ STRAIGHT HOLE ☐ DIRECTIONAL HOLE ☐ HORIZONTAL HOLE
☐ SERVICE WELL

If directional or horizontal, see reverse for bottom hole location.

COUNTY	Key	SEC	27	TWP	29N	RGE	1W
LEASE NAME	Dennis			WELL NO.	1-27		
1/4 C 1/4 SW 1/4 SE 1/4	FEL	660'	PWL	660'	DATE OF WELL COMPLETION	6/8/2012	
ELEVATION Derrick FL	1115	Ground	1105	Latitude	Longitude		
OPERATOR NAME	Barber Oil, LC			OTC / OCC OPERATOR NO.	24363		
ADDRESS	8801 South Yale Avenue, Suite 150						
CITY	Tulsa	STATE	OK	ZIP	74137		

OKLAHOMA CORPORATION COMMISSION

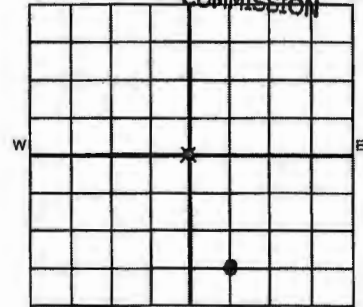

LOCATE WELL

COMPLETION TYPE

<input type="radio"/> SINGLE ZONE	
<input type="radio"/> MULTIPLE ZONE	
<input type="radio"/> COMMINGLED	
LOCATION EXCEPTION ORDER NO.	
MULTIUNIT ORDER NO.	
INCREASED DENSITY ORDER NO.	

CASING & CEMENT (Attach Form 1002C)

TYPE	SIZE	WEIGHT	GRADE	FEET	PSI	SAX	TOP OF CMT
CONDUCTOR							
SURFACE	8 5/8"	24#	J	308		250	Surface
INTERMEDIATE							
PRODUCTION	5 1/2"	15.5#	J-55	3710		275	2100'
LINER							

PACKER @ BRAND & TYPE CIBP → PLUG @ 3456' TYPE CIBP PLUG @ TYPE TOTAL DEPTH 3710'
PACKER @ BRAND & TYPE PLUG @ TYPE PLUG @ TYPE
COMPLETION & TEST DATA BY PRODUCING FORMATION 405 CLVD 351 MISS 405 CLVD 404 BGL 351 MISS

FORMATION	Cleveland		Mississippi	Cleveland	Big Lime-Oswego	Mississippi
SPACING & SPACING ORDER NUMBER	None		None	None	None	None
CLASS: Oil, Gas, Dry, Inj, Disp, Comm Disp, Svo	Oil		Oil Dry	Gas oil	Gas oil	Gas Dry
PERFORATED INTERVALS	3207'-3232'	3185'-3190'	3461'-3466'	3185'-3190'	3314'-3324'	3480'-3486'
	3194'-3197'		3476'-3480'	3197'-3207'	3350'-3354'	3585'-3600'
	3190'-3192'					
ACID/VOLUME	2500 gal		1500 gal	2000 gal	2500 gal	2500 ga
FRACTURE TREATMENT (Fluids/Prop Amounts)	no		no new treatment	663 bbls 41125 # sand original treatment	no	no

No New Frac's

Zones X out below CIBP plug

Min Gas Allowable (165:10-17-7) OR Oil Allowable (165:10-13-3) Purchaser/Measurer First Sales Date

INITIAL TEST DATA

INITIAL TEST DATE	7/23/2021	6/4/2021	6/8/2012	5/1/2012	4/27/2012
OIL-BBL/DAY	.25	5.83	18	5	8.5
OIL-GRAVITY (API)	41	40	41	40	40
GAS-MCF/DAY	0	0	300	80	220
GAS-OIL RATIO CU FT/BBL	0	0	16667	16000	25882
WATER-BBL/DAY	27	47	2	5	13
PUMPING OR FLOWING	pumping	Pumping	Flowing	Flowing	Flowing
INITIAL SHUT-IN PRESSURE			650	500	500
CHOKE SIZE			1/4"	1/4"	1/4"
FLOW TUBING PRESSURE			130	40	75

A record of the formations drilled through, and pertinent remarks are presented on the reverse. I declare that I have knowledge of the contents of this report and am authorized by my organization to make this report, which was prepared by me or under my supervision and direction, with the data and facts stated herein to be true, correct, and complete to the best of my knowledge and belief.

Barbara Courtney
SIGNATURE
8801 South Yale Ave, Suite 150
ADDRESS
Tulsa
CITY
OK
STATE
74137
ZIP
10/6/2021
DATE
918-838-5951
PHONE NUMBER
bcourtney@barberoilco.com
EMAIL ADDRESS

API NO. 35-071-24441
OTC PROD. UNIT NO. 071-206471

Oil and Gas Conservation Division
P.O. Box 52000
Oklahoma City, OK 73152-2000
405-522-0577
OCCCentralProcessing@OCC.OK.GOV

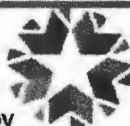

OKLAHOMA
Corporation
Commission

Page 203

Form 1002A
Rev. 2020

☒ ORIGINAL
☐ AMENDED (Reason) add parts, acidize and frac Cleveland

Rule 165:10-3-25

COMPLETION REPORT

TYPE OF DRILLING OPERATION

☒ STRAIGHT HOLE ☐ DIRECTIONAL HOLE ☐ HORIZONTAL HOLE
☐ SERVICE WELL

If directional or horizontal, see reverse for bottom hole location.

COUNTY	Kay	SEC	27	TWP	29N	RGE	1W	SPUD DATE	10/5/2011
LEASE NAME	Dennis	WELL NO.	1-27	DRLG FINISHED DATE	10/13/2011	DATE OF WELL COMPLETION	6/8/2012	1st PROD DATE	6/11/2012
1/4 C 1/4 SW 1/4 SE 1/4	FSL	660'	FWL	660'	RECOMP DATE	6/4/2021			
ELEVATION	1115	Ground	1105	Latitude	Longitude				
Derrick FL									
OPERATOR NAME	Barber Oil, LC				OTC / OCC OPERATOR NO.	24363			
ADDRESS	8801 South Yale Avenue, Suite 150								
CITY	Tulsa			STATE	OK	ZIP	74137		

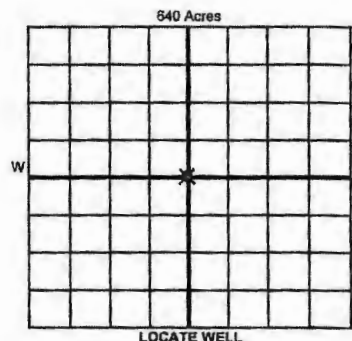

LOCATE WELL

COMPLETION TYPE

<input type="radio"/> SINGLE ZONE	
<input type="radio"/> MULTIPLE ZONE	
Application Date	
<input checked="" type="radio"/> COMMINOLED	
Application Date	
LOCATION EXCEPTION ORDER NO.	
MULTIUNIT ORDER NO.	
INCREASED DENSITY ORDER NO.	

CASING & CEMENT (Attach Form 1002C)

TYPE	SIZE	WEIGHT	GRADE	FEET	PSI	SAX	TOP OF CMT
CONDUCTOR							
SURFACE	8 5/8"	24#	J	308		250	Surface
INTERMEDIATE							
PRODUCTION	5 1/2"	15.5#	J-55	3710		275	2100'
LINER							

PACKER @ BRAND & TYPE PLUG @ TYPE PLUG @ TYPE PLUG @ TYPE TOTAL DEPTH 3710'

COMPLETION & TEST DATA BY PRODUCING FORMATION

FORMATION	Wilcox						
SPACING & SPACING ORDER NUMBER	None						
CLASS: Oil, Gas, Dry, Inj, Disp, Comm Disp, Svc	Gas Dry						
	3650'-3652'						
PERFORATED INTERVALS							
ACID/VOLUME	2500 gals						
FRACTURE TREATMENT (Fluids/Prop Amounts)	no						

Min Gas Allowable (165:10-17-7)

OR

Oil Allowable (165:10-13-3)

Purchaser/Measurer

First Sales Date

INITIAL TEST DATA

INITIAL TEST DATE	4/23/2012						
OIL-BBL/DAY	.5						
OIL-GRAVITY (API)	36						
GAS-MCF/DAY	15						
GAS-OIL RATIO CU FT/BBL	30000						
WATER-BBL/DAY	3						
PUMPING OR FLOWING	Flowing						
INITIAL SHUT-IN PRESSURE	120						
CHOKE SIZE	1/4"						
FLOW TUBING PRESSURE	25						

A record of the formations drilled through, and pertinent remarks are presented on the reverse. I declare that I have knowledge of the contents of this report and am authorized by my organization to make this report, which was prepared by me or under my supervision and direction, with the data and facts stated herein to be true, correct, and complete to the best of my knowledge and belief.

Barbara Courtney

SIGNATURE

Barbara Courtney

NAME (PRINT OR TYPE)

10/4/2021

DATE

918-638-5951

PHONE NUMBER

8801 South Yale Ave, Suite 150

Tulsa

OK

74137

bcourtney@barberoilo.com

ADDRESS

CITY

STATE

ZIP

EMAIL ADDRESS

PLEASE TYPE OR USE BLACK INK ONLY
FORMATION RECORD

Give formation names and tops, if available, or descriptions and thickness of formations drilled through. Show intervals cored or drillstem tested.

NAMES OF FORMATIONS	TOP
Cleveland	3184'
Big Lime-Oswego	3262'
Mississippi	3456'
Wilcox	3650'

LEASE NAME _____

WELL NO. _____

FOR COMMISSION USE ONLY	
ITD on file <input type="checkbox"/> YES <input type="checkbox"/> NO	
APPROVED _____	DISAPPROVED _____
2) Reject Codes	

Were open hole logs run?	<input checked="" type="radio"/> yes <input type="radio"/> no
Date Last log was run	10/11/2011
Was CO ₂ encountered?	<input type="radio"/> yes <input checked="" type="radio"/> no at what depths? _____
Was H ₂ S encountered?	<input type="radio"/> yes <input checked="" type="radio"/> no at what depths? _____
Were unusual drilling circumstances encountered?	<input type="radio"/> yes <input checked="" type="radio"/> no
If yes, briefly explain below	

Other remarks:

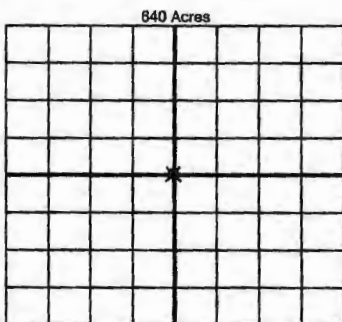

If more than three drainholes are proposed, attach a separate sheet indicating the necessary information.

Direction must be stated in degrees azimuth. Please note, the horizontal drainhole and its end point must be located within the boundaries of the lease or spacing unit.

Directional surveys are required for all drainholes and directional wells

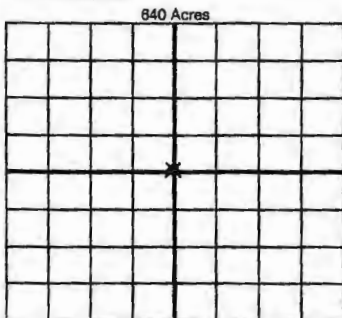

BOTTOM HOLE LOCATION FOR DIRECTIONAL HOLE

SEC	TWP	RGE	COUNTY
1/4	1/4	1/4	1/4
Measured Total Depth		True Vertical Depth	BHL From Lease, Unit, or Property Line:

BOTTOM HOLE LOCATION FOR HORIZONTAL HOLE: (LATERALS)

LATERAL #1			
SEC	TWP	RGE	COUNTY
1/4	1/4	1/4	1/4
Depth of Deviation		Radius of Turn	Direction
Measured Total Depth		True Vertical Depth	BHL From Lease, Unit, or Property Line:

LATERAL #2			
SEC	TWP	RGE	COUNTY
1/4	1/4	1/4	1/4
Depth of Deviation		Radius of Turn	Direction
Measured Total Depth		True Vertical Depth	BHL From Lease, Unit, or Property Line:

LATERAL #3			
SEC	TWP	RGE	COUNTY
1/4	1/4	1/4	1/4
Depth of Deviation		Radius of Turn	Direction
Measured Total Depth		True Vertical Depth	BHL From Lease, Unit, or Property Line: