

Oklahoma Corporation Commission  
Oil & Gas Conservation Division  
Post Office Box 52000  
Oklahoma City, Oklahoma 73152-2000  
Rule 165: 10-3-25

Form 1002A

API No.: 35019264170001

**Completion Report**

Spud Date: December 05, 2020

OTC Prod. Unit No.: 019-109942-0-5383

Drilling Finished Date: December 11, 2020

1st Prod Date: June 05, 2021

Completion Date: June 04, 2021

**Drill Type: DIRECTIONAL HOLE**

Well Name: SW WILDCAT JIM DEESE UNIT 9-2

Purchaser/Measurer:

Location: CARTER 7 2S 2W  
NW NW NW NW  
269 FNL 118 FWL of 1/4 SEC  
Latitude: 34.40457 Longitude: -97.457051  
Derrick Elevation: 1046 Ground Elevation: 1035

First Sales Date:

Operator: MACK ENERGY CO 11739

4700 GAILLARDIA PKWY STE 102  
OKLAHOMA CITY, OK 73142-1839

Completion Type		Location Exception		Increased Density	
X	Single Zone	Order No		Order No	
	Multiple Zone	There are no Location Exception records to display.		There are no Increased Density records to display.	
	Commingled				

Casing and Cement							
Type	Size	Weight	Grade	Feet	PSI	SAX	Top of CMT
SURFACE	9 5/8	36	K-55	1333		685	SURFACE
PRODUCTION	7	23	K-55	4337		360	790

Liner								
Type	Size	Weight	Grade	Length	PSI	SAX	Top Depth	Bottom Depth
There are no Liner records to display.								

**Total Depth: 4400**

Packer	
Depth	Brand & Type
There are no Packer records to display.	

Plug	
Depth	Plug Type
There are no Plug records to display.	

Initial Test Data										
Test Date	Formation	Oil BBL/Day	Oil-Gravity (API)	Gas MCF/Day	Gas-Oil Ratio Cu FT/BBL	Water BBL/Day	Pumpin or Flowing	Initial Shut-In Pressure	Choke Size	Flow Tubing Pressure
Jun 18, 2021	DEESE	1	22			321	PUMPING	725	N/A	

**Completion and Test Data by Producing Formation**

Formation Name: DEESE

Code: 404DEESS

Class: OIL

**Spacing Orders**

Order No	Unit Size
701901	UNIT

**Perforated Intervals**

From	To
3834	4148

**Acid Volumes**

There are no Acid Volume records to display.

**Fracture Treatments**

3,834' - 4,005' - 515 BARRELS, 11,570 POUNDS 16/30 SAND; 4,050' - 4,148' - 1,026 BARRELS, 31,216 POUNDS 16/30 SAND

Formation Name: DEESE

Code: 404DEESS

Class: OIL

**Spacing Orders**

Order No	Unit Size
701901	UNIT

**Perforated Intervals**

From	To
3483	3654

**Acid Volumes**

There are no Acid Volume records to display.

**Fracture Treatments**

792 BARRELS, 22,946 POUNDS 16/30 SAND

Formation Name: DEESE

Code: 404DEESS

Class: OIL

**Spacing Orders**

Order No	Unit Size
701901	UNIT

**Perforated Intervals**

From	To
3233	3430

**Acid Volumes**

There are no Acid Volume records to display.

**Fracture Treatments**

963 BARRELS, 31,807 POUNDS 16/30 SAND

Formation Name: DEESE

Code: 404DEESS

Class: OIL

**Spacing Orders**

Order No	Unit Size
701901	UNIT

**Perforated Intervals**

From	To
2950	3175

**Acid Volumes**

There are no Acid Volume records to display.

**Fracture Treatments**

625 BARRELS, 17,356 POUNDS 16/30 SAND

Formation	Top
CISCO	1574
HOXBAR	2008
COUNTY LINE LIME	2208
COUNTY LINE SAND	2290
TATUMS	2574

Were open hole logs run? Yes

Date last log run: December 09, 2020

Were unusual drilling circumstances encountered? No

Explanation:

DEESE GROUP	3010
FUSULINID	3026
EASON	3164
TUSSY	3227
TUSSY LIME	3266
CARPENTER SANDS	3510
MORRIS	3856

<b>Other Remarks</b>
THIS WELL IS A PART OF THE NEWLY FORMED SW WILDCAT JIM DEESE UNIT.

<b>Bottom Holes</b>
Sec: 12 TWP: 2S RGE: 3W County: CARTER  SE   NE   NE   NE  386 FNL   177 FEL of 1/4 SEC  Depth of Deviation: 0 Radius of Turn: 0 Direction: 0 Total Length: 0  Measured Total Depth: 4400 True Vertical Depth: 4381   End Pt. Location From Release, Unit or Property Line: 1405

<b>FOR COMMISSION USE ONLY</b>
<div>Status: Accepted</div> <div>1146763</div>

RECEIVED

Form 1002A  
Rev. 2009

AUG 06 2021

OKLAHOMA CORPORATION  
COMMISSIONAPI NO. 019-26417  
OTC PROD. 019-109942  
UNIT NO. 00-5383

(PLEASE TYPE OR USE BLACK INK ONLY)

OKLAHOMA CORPORATION COMMISSION  
Oil & Gas Conservation Division  
Post Office Box 52000  
Oklahoma City, Oklahoma 73152-2000  
Rule 165:10-3-25☒ ORIGINAL  
☐ AMENDED (Reason) \_\_\_\_\_

## COMPLETION REPORT

## TYPE OF DRILLING OPERATION

☐ STRAIGHT HOLE ☒ DIRECTIONAL HOLE ☐ HORIZONTAL HOLE  
SERVICE WELL

If directional or horizontal, see reverse for bottom hole location.

COUNTY	Carter	SEC	7	TWP	2S	RGE	2W	SPUD DATE	12-5-20
LEASE NAME	SW Wildcat Jim	SW WJDU	Deese Unit	WELL NO.	9-2	DATE OF WELL COMPLETION	6-4-21	DRLG FINISHED DATE	12-11-20
NW 1/4 NW 1/4 NW 1/4 NW 1/4	E8T OF FNL 1/4 SEC 269		FWL OF 1/4 SEC 118		1st PROD DATE		6-5-21	RECOMP DATE	
ELEVATION Derrick FL	1045.5' Ground	1035'	Latitude (if known)	34.40457	Longitude (if known)	97.457051			
OPERATOR NAME	Mack Energy Co.				OTC / OCC OPERATOR NO.	11739			
ADDRESS	P.O. Box 400								
CITY	Duncan	STATE	OK	ZIP	73534				

640 Acres									
W									E

LOCATE WELL

## COMPLETION TYPE

<input checked="" type="checkbox"/> SINGLE ZONE	
<input type="checkbox"/> MULTIPLE ZONE	
<input type="checkbox"/> COMMINGLED	
<input type="checkbox"/> LOCATION EXCEPTION	
<input type="checkbox"/> ORDER NO.	
<input type="checkbox"/> INCREASED DENSITY	
<input type="checkbox"/> ORDER NO.	

## CASING &amp; CEMENT (Attach Form 1002C)

TYPE	SIZE	WEIGHT	GRADE	FEET	PSI	SAX	TOP OF CMT
CONDUCTOR							
SURFACE	9 5/8	36#	K-55	1333'		685	Surface
INTERMEDIATE							
PRODUCTION	7"	23#	K-55	4337'		360	790'
LINER							
						TOTAL DEPTH	4400'

PACKER @ \_\_\_\_\_ BRAND &amp; TYPE \_\_\_\_\_

PLUG @ \_\_\_\_\_ TYPE \_\_\_\_\_

PLUG @ \_\_\_\_\_ TYPE \_\_\_\_\_

TOTAL DEPTH

4400'

PACKER @ \_\_\_\_\_ BRAND &amp; TYPE \_\_\_\_\_

PLUG @ \_\_\_\_\_ TYPE \_\_\_\_\_

PLUG @ \_\_\_\_\_ TYPE \_\_\_\_\_

## COMPLETION &amp; TEST DATA BY PRODUCING FORMATION

FORMATION	(Lower Morris)	(Carpenter)	(Tussy)	(Fusulinid/Eason)	← All Deese
SPACING & SPACING	40-acre	40-acre	10-acre	2950-3175'	← 701901 (unit)
ORDER NUMBER	701901 (unit)	701901 (unit)	701901 (unit)	2950-3175'	← 701901 (unit)
CLASS: Oil, Gas, Dry, Inj, Disp, Comm Disp, Svc	Oil	Oil	Oil	Oil	Reported to Frac Focus
PERFORATED INTERVALS	3834-4005'	3483-3654'	3233-3430'	2950-3175'	
ACID/VOLUME	4050-4148'				
FRACTURE TREATMENT (Fluids/Prop Amounts)	3834-4005 515 bbls 11570# 16/30 sd 4050-4148' 1026 bbls 31216# 16/30 sd	792 bbls, 22946# 16/30 sd	963 bbls, 31807#, 16/30	625 bbls, 17356# 16/30 sd	

Min Gas Allowable (165:10-17-7)

Gas Purchaser/Measurer



OR

First Sales Date

Oil Allowable (165:10-13-3)

## INITIAL TEST DATA

INITIAL TEST DATE	6/18/2021				
OIL-BBL/DAY	1				
OIL-GRAVITY (API)	22				
GAS-MCF/DAY	0				
GAS-OIL RATIO CU FT/BBL	0				
WATER-BBL/DAY	321				
PUMPING OR FLOWING	Pumping				
INITIAL SHUT-IN PRESSURE	725 psig				
CHOKE SIZE	N/A				
FLOW TUBING PRESSURE	N/A				

A record of the formations drilled through, and pertinent remarks are presented on the reverse. I declare that I have knowledge of the contents of this report and am authorized by my organization to make this report, which was prepared by me or under my supervision and direction, with the data and facts stated herein to be true, correct, and complete to the best of my knowledge and belief.

SIGNATURE	Dinah Mayes	DATE	8-5-21	PHONE NUMBER	580-856-3705
ADDRESS	3730 Samedan Rd	CITY	Ratliff City	STATE	OK
		ZIP	73481	EMAIL ADDRESS	dmayes@mackenergy.com

PLEASE TYPE OR USE BLACK INK ONLY

FORMATION RECORD

Give formation names and tops, if available, or descriptions and thickness of formations drilled through. Show intervals cored or drillstem tested.

NAMES OF FORMATIONS	TOP
Cisco	1574'
Hoxbar	2008'
County Line Lime	2208'
County Line Sand	2290'
Tatums	2574'
Deese Group	3010'
Fussulinid	3026'
Eason	3164'
Tussy	3227'
Tussy Lime	3266'
Carpenter Sands	3510'
Morris	3856'

LEASE NAME SW WJDU WELL NO. 9-2

FOR COMMISSION USE ONLY	
ITD on file <input type="checkbox"/> YES <input type="checkbox"/> NO	
APPROVED _____	DISAPPROVED _____
2) Reject Codes	
_____	
_____	
_____	
_____	
_____	

Were open hole logs run?	<input checked="" type="checkbox"/> yes <input type="checkbox"/> no
Date Last log was run	<u>12/9/2020</u>
Was CO <sub>2</sub> encountered?	<input type="checkbox"/> yes <input checked="" type="checkbox"/> no at what depths? _____
Was H <sub>2</sub> S encountered?	<input type="checkbox"/> yes <input checked="" type="checkbox"/> no at what depths? _____
Were unusual drilling circumstances encountered?	<input type="checkbox"/> yes <input checked="" type="checkbox"/> no
If yes, briefly explain below	

Other remarks: This well is a part of the newly formed SW WJDU Unit. sw Wildcat Jim Deese Unit

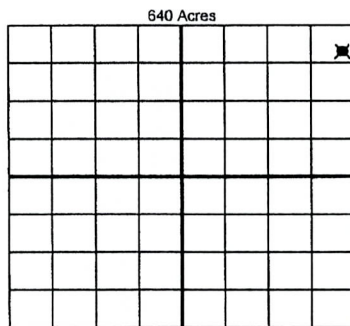

If more than three drainholes are proposed, attach a separate sheet indicating the necessary information.

Direction must be stated in degrees azimuth. Please note, the horizontal drainhole and its end point must be located within the boundaries of the lease or spacing unit.

Directional surveys are required for all drainholes and directional wells.

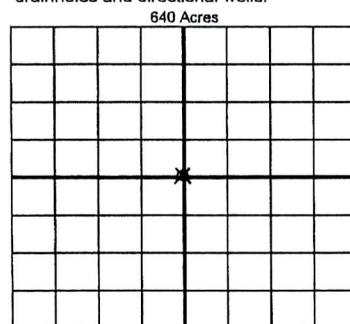

BOTTOM HOLE LOCATION FOR DIRECTIONAL HOLE

SEC 12	TWP 2S	RGE 3W	COUNTY	Carter <u>FWL 386</u> <u>FEL 177</u>	
Spot Location			SE 1/4	NE 1/4	NE 1/4
Measured Total Depth			4400'	True Vertical Depth	4381'
BHL From Lease, Unit, or Property Line:			1405'		

BOTTOM HOLE LOCATION FOR HORIZONTAL HOLE: (LATERALS)

LATERAL #1					
SEC	TWP	RGE	COUNTY		
Spot Location			1/4	1/4	1/4
Feet From 1/4 Sec Lines			FSL		FWL
Depth of Deviation			Radius of Turn	Direction	Total Length
Measured Total Depth			True Vertical Depth	BHL From Lease, Unit, or Property Line:	

LATERAL #2					
SEC	TWP	RGE	COUNTY		
Spot Location			1/4	1/4	1/4
Feet From 1/4 Sec Lines			FSL		FWL
Depth of Deviation			Radius of Turn	Direction	Total Length
Measured Total Depth			True Vertical Depth	BHL From Lease, Unit, or Property Line:	

LATERAL #3					
SEC	TWP	RGE	COUNTY		
Spot Location			1/4	1/4	1/4
Feet From 1/4 Sec Lines			FSL		FWL
Depth of Deviation			Radius of Turn	Direction	Total Length
Measured Total Depth			True Vertical Depth	BHL From Lease, Unit, or Property Line:	