

Oklahoma Corporation Commission
Oil & Gas Conservation Division
Post Office Box 52000
Oklahoma City, Oklahoma 73152-2000
Rule 165: 10-3-25

Form 1002A

API No.: 35125239150001

Completion Report

Spud Date: October 27, 2016

OTC Prod. Unit No.:

Drilling Finished Date: November 09, 2016

1st Prod Date: March 29, 2020

Completion Date: March 29, 2020

Drill Type: HORIZONTAL HOLE

Min Gas Allowable: Yes

Well Name: SOUTH HOTULKE UNIT 27-1

Purchaser/Measurer: ENERFIN

Location: POTTAWATOMIE 19 9N 5E
SE SW SW SW
225 FSL 490 FWL of 1/4 SEC
Derrick Elevation: 926 Ground Elevation: 910

First Sales Date: 03/29/2020

Operator: TCINA INC 11432
PO BOX 470
201 N 2ND ST
SEMINOLE, OK 74818-0470

Completion Type		Location Exception		Increased Density	
X	Single Zone	Order No		Order No	
	Multiple Zone	There are no Location Exception records to display.		There are no Increased Density records to display.	
	Commingled				

Casing and Cement							
Type	Size	Weight	Grade	Feet	PSI	SAX	Top of CMT
SURFACE	9 5/8	36	J-55	739	500	360	SURFACE
PRODUCTION	7	26	K-55	4673	1200	175	3500

Liner								
Type	Size	Weight	Grade	Length	PSI	SAX	Top Depth	Bottom Depth
There are no Liner records to display.								

Total Depth: 6427

Packer		Plug	
Depth	Brand & Type	Depth	Plug Type
There are no Packer records to display.		There are no Plug records to display.	

Initial Test Data										
Test Date	Formation	Oil BBL/Day	Oil-Gravity (API)	Gas MCF/Day	Gas-Oil Ratio Cu FT/BBL	Water BBL/Day	Pumpin or Flowing	Initial Shut-In Pressure	Choke Size	Flow Tubing Pressure
Mar 29, 2020	HUNTON	9	40	28	3111	989	PUMPING			

Completion and Test Data by Producing Formation			
Formation Name: HUNTON		Code: 269HNTN	Class: OIL
Spacing Orders		Perforated Intervals	
Order No	Unit Size	From	To
313834	UNIT	There are no Perf. Intervals records to display.	
Acid Volumes		Fracture Treatments	
25,000 GALLONS 15% HCL		NONE	

Formation	Top
HENRIETTA COAL	3452
EARLSBORO SAND	3646
WOODFORD SHALE	3995
HUNTON LIME	4116

Were open hole logs run? No
Date last log run:

Were unusual drilling circumstances encountered? No
Explanation:

Other Remarks
COMPLETION DELAYED BY LACK OF SALT WATER DISPOSAL. DRILLED SOUTH HOTULKE UNIT 27-3 SALT WATER DISPOSAL TO TEST. OCC - THIS WELL IS AN OPEN HOLE COMPLETION FROM BOTTOM OF THE 7" CASING AT 4,673' TO TERMINUS AT 6,427'.

Lateral Holes
Sec: 24 TWP: 9N RGE: 4E County: POTTAWATOMIE SE SW SW SE 171 FSL 2227 FEL of 1/4 SEC Depth of Deviation: 3200 Radius of Turn: 900 Direction: 270 Total Length: 1754 Measured Total Depth: 6427 True Vertical Depth: 4145 End Pt. Location From Release, Unit or Property Line: 2408

FOR COMMISSION USE ONLY	
Status: Accepted	1145099

API NO. 12523915
OTC PROD. UNIT NO.

(PLEASE TYPE OR USE BLACK INK ONLY)

OKLAHOMA CORPORATION COMMISSION

Oil & Gas Conservation Division

Post Office Box 52000

Oklahoma City, Oklahoma 73152-2000

Rule 165:10-3-25

Form 1002A

Rev. 2009

☒ ORIGINAL
☐ AMENDED (Reason)

COMPLETION REPORT

TYPE OF DRILLING OPERATION

☐ STRAIGHT HOLE ☐ DIRECTIONAL HOLE ☒ HORIZONTAL HOLE
☐ SERVICE WELL

If directional or horizontal, see reverse for bottom hole location.

COUNTY	Pottawatomie	SEC	19	TWP	9N	RGE	5E	SPUD DATE	10-27-16
LEASE NAME	South Hotulke Unit				WELL NO.	27-1	DATE OF WELL COMPLETION	3-29-20	
SE 1/4 SW 1/4 SW 1/4 SW 1/4	FSL OF 1/4 SEC	225	FWL OF 1/4 SEC	490	1st PROD DATE	3-29-20			
ELEVATION	926	Ground	910	Latitude (if known)	15 13'56.3760				
Derrick FL					Longitude (if known)	149° 23.42403			
OPERATOR NAME	Tcina, Inc				OTC / OCC OPERATOR NO.	11432 0			
ADDRESS	PO Box 470								
CITY	Seminole				STATE	OK	ZIP	74818	

640 Acres

W E

x

LOCATE WELL

COMPLETION TYPE

<input checked="" type="checkbox"/> SINGLE ZONE	
<input type="checkbox"/> MULTIPLE ZONE	
<input type="checkbox"/> COMMINGLED	
<input type="checkbox"/> LOCATION EXCEPTION ORDER NO.	
<input type="checkbox"/> INCREASED DENSITY ORDER NO.	

CASING & CEMENT (Attach Form 1002C)

TYPE	SIZE	WEIGHT	GRADE	FEET	PSI	SAX	TOP OF CMT
CONDUCTOR							
SURFACE	9 5/8	36	J55	739	500	360	Surf
INTERMEDIATE							
PRODUCTION	7	26	K55	4673	1200	175	3500
LINER							

PACKER @ none BRAND & TYPE

PLUG @ TYPE PLUG @ TYPE

TOTAL DEPTH 6427

COMPLETION & TEST DATA BY PRODUCING FORMATION

FORMATION	Hunton						No Frac
SPACING & SPACING ORDER NUMBER	313834 (unit)						
CLASS: Oil, Gas, Dry, Inj, Disp, Comm Disp, Svc	Oil						
PERFORATED INTERVALS	OH-4673 6427 open Hole						
ACID/VOLUME	15% HCL 25,000gal						
FRACTURE TREATMENT (Fluids/Prop Amounts)	None						

☒ Min Gas Allowable (165:10-17-7)
OR
☐ Oil Allowable (165:10-13-3)

Gas Purchaser/Measurer
First Sales Date

Enerfin

3/29/2020

INITIAL TEST DATA

INITIAL TEST DATE	3/29/2020					
OIL-BBL/DAY	9					
OIL-GRAVITY (API)	40					
GAS-MCF/DAY	28					
GAS-OIL RATIO CU FT/BBL	3111					
WATER-BBL/DAY	989					
PUMPING OR FLOWING	pump					
INITIAL SHUT-IN PRESSURE						
CHOKE SIZE						
FLOW TUBING PRESSURE						

A record of the formations drilled through, and pertinent remarks are presented on the reverse. I declare that I have knowledge of the contents of this report and am authorized by my organization to make this report, which was prepared by me or under my supervision and direction, with the data and facts stated herein to be true, correct, and complete to the best of my knowledge and belief.

SIGNATURE	Berry Doyal	DATE	4/15/2020	PHONE NUMBER	405-380-7500
ADDRESS	PO Box 470	CITY	Seminole	STATE	OK
		ZIP	74818	EMAIL ADDRESS	tcina1@outlook.com

PLEASE TYPE OR USE BLACK INK ONLY
FORMATION RECORD

Give formation names and tops, if available, or descriptions and thickness of formations drilled through. Show intervals cored or drillstem tested.

LEASE NAME _____ WELL NO. _____

NAMES OF FORMATIONS	TOP
Henrietta Coal MD 3461	TVD 3452
Earlsboro sd MD 3862	TVD 3646
Woodford sh MD 4215	TVD 3995
Hunton lm MD 4626	TVD 4116
TD MD 6427	

FOR COMMISSION USE ONLY	
ITD on file <input type="checkbox"/> YES <input type="checkbox"/> NO	
APPROVED _____	DISAPPROVED _____
2) Reject Codes	

Were open hole logs run?	yes <input type="checkbox"/> no <input checked="" type="checkbox"/>
Date Last log was run	_____
Was CO ₂ encountered?	yes <input type="checkbox"/> no <input checked="" type="checkbox"/> at what depths? _____
Was H ₂ S encountered?	yes <input type="checkbox"/> no <input checked="" type="checkbox"/> at what depths? _____
Were unusual drilling circumstances encountered?	yes <input type="checkbox"/> no <input checked="" type="checkbox"/>
If yes, briefly explain below	

Other remarks: Completion delayed by lack of salt water disposal. Drilled South Hotulke Unit 27-3 swd to test

OCC - This well is an open hole completion from bottom of the 7" casing at 4673' to + terminus at 6427'.

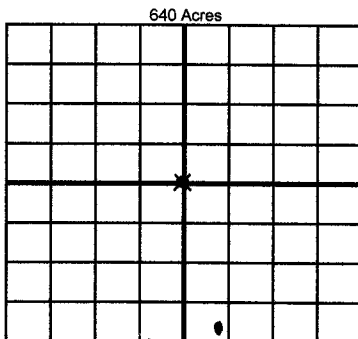

If more than three drainholes are proposed, attach a separate sheet indicating the necessary information.

Direction must be stated in degrees azimuth.
Please note, the horizontal drainhole and its end point must be located within the boundaries of the lease or spacing unit.

Directional surveys are required for all drainholes and directional wells.

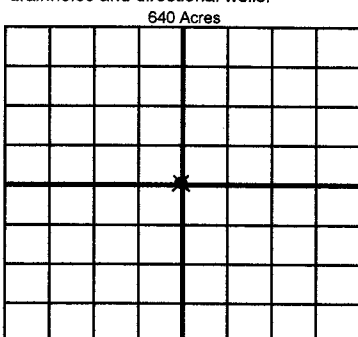

BOTTOM HOLE LOCATION FOR DIRECTIONAL HOLE

SEC	TWP	RGE	COUNTY
Spot Location	1/4	1/4	1/4
Measured Total Depth	True Vertical Depth	BHL From Lease, Unit, or Property Line:	

BOTTOM HOLE LOCATION FOR HORIZONTAL HOLE: (LATERALS)

LATERAL #1			
SEC	TWP	RGE	COUNTY
24	9N	4E	Pottawatomie
Spot Location	SE 1/4 SW 1/4 SW 1/4 SE 1/4	Feet From 1/4 Sec Lines	FSL
Depth of Deviation	3,200	Radius of Turn	900
Measured Total Depth	6,427	True Vertical Depth	4,145
		Direction	270
		Total Length	1,754
		BHL From Lease, Unit, or Property Line:	2408

LATERAL #2			
SEC	TWP	RGE	COUNTY
Spot Location	1/4	1/4	1/4
Depth of Deviation	Radius of Turn	Direction	Total Length
Measured Total Depth	True Vertical Depth	BHL From Lease, Unit, or Property Line:	

LATERAL #3			
SEC	TWP	RGE	COUNTY
Spot Location	1/4	1/4	1/4
Depth of Deviation	Radius of Turn	Direction	Total Length
Measured Total Depth	True Vertical Depth	BHL From Lease, Unit, or Property Line:	