

Oklahoma Corporation Commission
Oil & Gas Conservation Division
Post Office Box 52000
Oklahoma City, Oklahoma 73152-2000
Rule 165: 10-3-25

Form 1002A

API No.: 35137204600001

Completion Report

Spud Date: June 10, 1969

OTC Prod. Unit No.: 137-12122

Drilling Finished Date: June 13, 1969

Amended

1st Prod Date: November 01, 1969

Amend Reason: CONVERT INTO PRODUCER

Completion Date: November 01, 1969

Recomplete Date: May 15, 2021

Drill Type: STRAIGHT HOLE

Well Name: SVPU WI-8

Purchaser/Measurer:

Location: STEPHENS 1 2S 5W
SW NW NW SE
2010 FSL 30 FWL of 1/4 SEC
Derrick Elevation: 1096 Ground Elevation: 1091

First Sales Date:

Operator: BUTKIN OIL COMPANY LLC 21023
PO BOX 2090
16 S 9TH ST STE 306
DUNCAN, OK 73534-2090

Completion Type		Location Exception		Increased Density	
X	Single Zone	Order No		Order No	
	Multiple Zone	There are no Location Exception records to display.		There are no Increased Density records to display.	
	Commingled				

Casing and Cement							
Type	Size	Weight	Grade	Feet	PSI	SAX	Top of CMT
PRODUCTION	4 1/2	9.5	B	886	1000	225	SURFACE

Liner								
Type	Size	Weight	Grade	Length	PSI	SAX	Top Depth	Bottom Depth
There are no Liner records to display.								

Total Depth: 892

Packer		Plug	
Depth	Brand & Type	Depth	Plug Type
There are no Packer records to display.		There are no Plug records to display.	

Initial Test Data										
Test Date	Formation	Oil BBL/Day	Oil-Gravity (API)	Gas MCF/Day	Gas-Oil Ratio Cu FT/BBL	Water BBL/Day	Pumpin or Flowing	Initial Shut-In Pressure	Choke Size	Flow Tubing Pressure
May 15, 2021	PERMIAN SAND	1					PUMPING			

Completion and Test Data by Producing Formation										
---	--	--	--	--	--	--	--	--	--	--

Formation Name: PERMIAN SAND		Code: 459PMSD	Class: OIL
Spacing Orders		Perforated Intervals	
Order No	Unit Size	From	To
73629	UNIT	582	652
Acid Volumes		Fracture Treatments	
NONE		NONE	

Formation	Top
SEE ORIGINAL	0

Were open hole logs run? No
Date last log run:

Were unusual drilling circumstances encountered? No
Explanation:

Other Remarks
CONVERTING INJECTOR INTO PRODUCER

FOR COMMISSION USE ONLY	
Status: Accepted	1146462

API NO. 137-20460
OTC PROD. 1332
UNIT NO. 12122

Oil and Gas Conservation Division
P.O. Box 52000
Oklahoma City, OK 73152-2000
405-522-0577
OCCCentralProcessing@OCC.OK.GOV



OKLAHOMA
Corporation
Commission

Received
5/17/21
DHT

Form 1002A
Rev. 2020

ORIGINAL
AMENDED (Reason) CONVERT INTO PRODUCER

Rule 165:10-3-25

COMPLETION REPORT

TYPE OF DRILLING OPERATION

☒ STRAIGHT HOLE ☐ DIRECTIONAL HOLE ☐ HORIZONTAL HOLE
☐ SERVICE WELL

If directional or horizontal, see reverse for bottom hole location.

COUNTY STEPHENS SEC 1 TWP 25 RGE 5W
LEASE NAME SVPU WELL NO. WI-8 1st PROD DATE 11/1/69
SW 1/4 NW 1/4 SE 1/4 2010 FSL 30' FWL RECOMP DATE 5/15/21
ELEVATION 1096 Ground 1091 Latitude Longitude
OPERATOR NAME BUTKIN OIL CO., LLC. OTC / OCC OPERATOR NO. 21023-0
ADDRESS P.O. BOX 2090
CITY DUNCAN STATE OK ZIP 73534

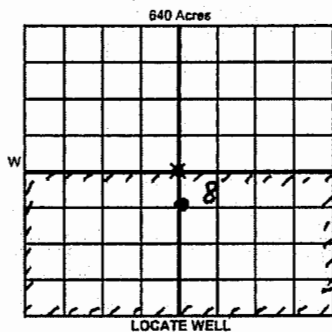

COMPLETION TYPE

☒ SINGLE ZONE
☐ MULTIPLE ZONE
Application Date
☐ COMMINGLED
Application Date
LOCATION EXCEPTION
ORDER NO.
MULTIUNIT ORDER NO.
INCREASED DENSITY
ORDER NO.

CASING & CEMENT (Attach Form 1002C)

TYPE	SIZE	WEIGHT	GRADE	FEET	PSI	SAX	TOP OF CMT
CONDUCTOR							
SURFACE							
INTERMEDIATE							
PRODUCTION	<u>4 1/2</u>	<u>9.5</u>	<u>B</u>	<u>886</u>	<u>1000</u>	<u>225</u>	<u>SURF</u>
LINER							

PACKER @ _____ BRAND & TYPE _____ PLUG @ _____ TYPE _____ PLUG @ _____ TYPE _____ TOTAL DEPTH 892
PACKER @ _____ BRAND & TYPE _____ PLUG @ _____ TYPE _____ PLUG @ _____ TYPE _____

COMPLETION & TEST DATA BY PRODUCING FORMATION 459 PMSD

FORMATION	<u>PERMIAN Sand</u>					
SPACING & SPACING ORDER NUMBER	<u>SOUTH VELMA PERMIAN (UNIT)</u>	<u>73629</u>				
CLASS: Oil, Gas, Dry, Inf, Disp, Comm Disp, Svc	<u>OIL</u>					
PERFORATED INTERVALS	<u>582-652 (OA)</u>					
ACID/VOLUME	<u>NONE</u>					
FRACTURE TREATMENT (Fluids/Prop Amounts)	<u>NONE</u>					

☐ Min Gas Allowable (165:10-17-7)
OR
☐ Oil Allowable (165:10-13-3)

Purchaser/Messurer
First Sales Date

INITIAL TEST DATA

INITIAL TEST DATE	<u>5/15/21</u>					
OIL-BBL/DAY	<u>1.0</u>					
OIL-GRAVITY (API)						
GAS-MCF/DAY						
GAS-OIL RATIO CU FT/BBL						
WATER-BBL/DAY						
PUMPING OR FLOWING	<u>Pumping</u>					
INITIAL SHUT-IN PRESSURE						
CHOKE SIZE						
FLOW TUBING PRESSURE						

A record of the formations drilled through and pertinent remarks are presented on the reverse. I declare that I have knowledge of the contents of this report and am authorized by my organization to make this report, which was prepared by me or under my supervision and direction, with the data and facts stated herein to be true, correct, and complete to the best of my knowledge and belief.

JOHN R. LAWS SIGNATURE JOHN R. LAWS NAME (PRINT OR TYPE) 5/3/21 DATE 580-220-8455 PHONE NUMBER
1515 WARD RD ADDRESS ARMORE OK 73401 CITY JRLAWS@HOTMAIL.COM EMAIL ADDRESS
STATE ZIP

PLEASE TYPE OR USE BLACK INK ONLY
FORMATION RECORD

Give formation names and tops, if available, or descriptions and thickness of formations drilled through. Show intervals cored or drillstem tested.

NAMES OF FORMATIONS	TOP
SEE ORIGINAL	

LEASE NAME SVPU

WELL NO. W1-8

FOR COMMISSION USE ONLY	
ITD on file <input type="checkbox"/> YES <input type="checkbox"/> NO	
APPROVED _____	DISAPPROVED _____
2) Reject Codes	

Were open hole logs run?	<input type="radio"/> yes <input checked="" type="radio"/> no
Date Last log was run	_____
Was CO ₂ encountered?	<input type="radio"/> yes <input checked="" type="radio"/> no at what depths? _____
Was H ₂ S encountered?	<input type="radio"/> yes <input checked="" type="radio"/> no at what depths? _____
Were unusual drilling circumstances encountered?	<input type="radio"/> yes <input checked="" type="radio"/> no
If yes, briefly explain below.	

Other remarks: CONVERTING INJECTOR INTO PRODUCER

640 Acres

If more than three drainholes are proposed, attach a separate sheet indicating the necessary information.

Direction must be stated in degrees azimuth. Please note, the horizontal drainhole and its end point must be located within the boundaries of the lease or spacing unit.

Directional surveys are required for all drainholes and directional wells.

640 Acres

BOTTOM HOLE LOCATION FOR DIRECTIONAL HOLE

SEC	TWP	RGE	COUNTY
1/4	1/4	1/4	1/4
Measured Total Depth		True Vertical Depth	
		BHL From Lease, Unit, or Property Line:	

BOTTOM HOLE LOCATION FOR HORIZONTAL HOLE: (LATERALS)

LATERAL #1			
SEC	TWP	RGE	COUNTY
1/4	1/4	1/4	1/4
Depth of Deviation		Radius of Turn	Direction
Measured Total Depth		True Vertical Depth	Total Length
		BHL From Lease, Unit, or Property Line:	

LATERAL #2			
SEC	TWP	RGE	COUNTY
1/4	1/4	1/4	1/4
Depth of Deviation		Radius of Turn	Direction
Measured Total Depth		True Vertical Depth	Total Length
		BHL From Lease, Unit, or Property Line:	

LATERAL #3			
SEC	TWP	RGE	COUNTY
1/4	1/4	1/4	1/4
Depth of Deviation		Radius of Turn	Direction
Measured Total Depth		True Vertical Depth	Total Length
		BHL From Lease, Unit, or Property Line:	