

Oklahoma Corporation Commission  
Oil & Gas Conservation Division  
Post Office Box 52000  
Oklahoma City, Oklahoma 73152-2000  
Rule 165: 10-3-25

Form 1002A

API No.: 35073267560000

**Completion Report**

Spud Date: June 19, 2021

OTC Prod. Unit No.: 073-227284-0-0424

Drilling Finished Date: June 29, 2021

1st Prod Date: July 18, 2021

Completion Date: July 16, 2021

**Drill Type: HORIZONTAL HOLE**

Well Name: LINCOLN SOUTHEAST OSWEGO UNIT 48-3HO

Purchaser/Measurer:

Location: KINGFISHER 19 17N 5W  
NW NW NE NE  
185 FNL 1266 FEL of 1/4 SEC  
Latitude: 35.941092 Longitude: -97.768952  
Derrick Elevation: 0 Ground Elevation: 1035

First Sales Date:

Operator: HINKLE OIL & GAS INC 21639

5600 N MAY AVE STE 295  
OKLAHOMA CITY, OK 73112-4275

Completion Type	
X	Single Zone
	Multiple Zone
	Commingle

Location Exception	
Order No	
There are no Location Exception records to display.	

Increased Density	
Order No	
There are no Increased Density records to display.	

Casing and Cement							
Type	Size	Weight	Grade	Feet	PSI	SAX	Top of CMT
CONDUCTOR	20			80			SURFACE
SURFACE	9 5/8	36	LTC	351		135	SURFACE
PRODUCTION	7	26	P-110	6705		230	4124

Liner								
Type	Size	Weight	Grade	Length	PSI	SAX	Top Depth	Bottom Depth
LINER	4 1/2	13.5	P-110	4907	0	425	6323	11230

**Total Depth: 11233**

Packer	
Depth	Brand & Type
There are no Packer records to display.	

Plug	
Depth	Plug Type
There are no Plug records to display.	

Initial Test Data
-------------------

Test Date	Formation	Oil BBL/Day	Oil-Gravity (API)	Gas MCF/Day	Gas-Oil Ratio Cu FT/BBL	Water BBL/Day	Pumpin or Flowing	Initial Shut-In Pressure	Choke Size	Flow Tubing Pressure
Jul 22, 2021	OSWEGO	603	47.2	388	640	2708	PUMPING		OPEN	

Completion and Test Data by Producing Formation

Formation Name: OSWEGO

Code: 404OSWG

Class: OIL

Spacing Orders

Order No

Unit Size

52793

UNIT

Perforated Intervals

From

To

6650

11160

Acid Volumes

201,054 GALLONS 15% HCL, 58,597 BSW

Fracture Treatments

There are no Fracture Treatments records to display.

Formation	Top
OSWEGO TVD	6196
OSWEGO MTD	6330

Were open hole logs run? No

Date last log run:

Were unusual drilling circumstances encountered? No

Explanation:

Other Remarks

There are no Other Remarks.

Lateral Holes

Sec: 19 TWP: 17N RGE: 5W County: KINGFISHER

SW SW SE SE

1 FSL 1131 FEL of 1/4 SEC

Depth of Deviation: 5528 Radius of Turn: 1202 Direction: 179 Total Length: 4481

Measured Total Depth: 11233 True Vertical Depth: 6387 End Pt. Location From Release, Unit or Property Line: 1

FOR COMMISSION USE ONLY

Status: Accepted

1146780

API NO. 35-073-26756  
OTC PROD.  
UNIT NO. 073-227291  
-D-0424

Oil and Gas Conservation Division  
P.O. Box 52000  
Oklahoma City, OK 73152-2000  
405-521-2331  
OCCCentralProcessing@OCC.OK.GOV



**OKLAHOMA**  
Corporation  
Commission

Form 1002A  
Rev. 2020

8 ORIGINAL  
AMENDED (Reason)

Rule 165:10-3-25

COMPLETION REPORT

TYPE OF DRILLING OPERATION

☐ STRAIGHT HOLE ☐ DIRECTIONAL HOLE ☒ HORIZONTAL HOLE  
☐ SERVICE WELL

If directional or horizontal, see reverse for bottom hole location.

COUNTY	Kingfisher	SEC	19	TWP	17N	RGE	05W	SPUD DATE	06/19/2021
LEASE NAME	Lincoln Southeast Oswego Unit			WELL NO.	48-3HO			DRLG FINISHED DATE	06/29/2021
NW 1/4 NW 1/4 NE 1/4 NE 1/4	FNL 142'			FEL 1142'				DATE OF WELL COMPLETION	07/16/2021
ELEVATION	Ground 1035'			Latitude	35.941092			1st PROD DATE	07/18/2021
OPERATOR NAME	Hinkle Oil & Gas, Inc.			OTC / OCC OPERATOR NO.	21639				
ADDRESS	5600 N. May Avenue, Suite 295								
CITY	Oklahoma City			STATE	OK		ZIP	73112	

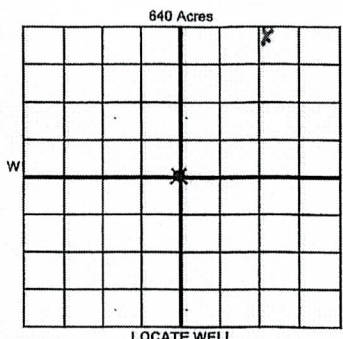

COMPLETION TYPE

<input checked="" type="radio"/> SINGLE ZONE	
<input type="radio"/> MULTIPLE ZONE	
<input type="radio"/> COMMINGLED	
LOCATION EXCEPTION ORDER NO.	
MULTIUNIT ORDER NO.	
INCREASED DENSITY ORDER NO.	

CASING & CEMENT (Attach Form 1002C)

TYPE	SIZE	WEIGHT	GRADE	FEET	PSI	SAX	TOP OF CMT
CONDUCTOR	20"			80'			Surface
SURFACE	9 5/8"	36#	LTC	351'		135	Surface
INTERMEDIATE							
PRODUCTION	7"	26#	P110	6705'		230	4124'
LINER	4 1/2"	13.5#	P110	6323'-11,230'		425	6323'

PACKER @ BRAND & TYPE PLUG @ TYPE PLUG @ TYPE TOTAL DEPTH 41,230' 11233

COMPLETION & TEST DATA BY PRODUCING FORMATION

FORMATION	Oswego								
SPACING & SPACING ORDER NUMBER	52793 (unit)								
CLASS: Oil, Gas, Dry, Inj, Disp, Comm Disp, Svc	Oil								
PERFORATED INTERVALS	6650'-11,160'								
ACID/VOLUME									
FRACTURE TREATMENT (Fluids/Prop Amounts)	201054 Gal. 15% HCL 58597 BSW								

RECEIVED

AUG 09 2021

OKLAHOMA CORPORATION  
COMMISSION

Min Gas Allowable (165:10-17-7)

OR

Oil Allowable (165:10-13-3)

Purchaser/Measurer

First Sales Date

INITIAL TEST DATA

INITIAL TEST DATE	07/22/2021					
OIL-BBL/DAY	603					
OIL-GRAVITY ( API)	47.2					
GAS-MCF/DAY	386					
GAS-OIL RATIO CU FT/BBL	640					
WATER-BBL/DAY	2708					
PUMPING OR FLOWING	Pumping					
INITIAL SHUT-IN PRESSURE	N/A					
CHOKE SIZE	Open					
FLOW TUBING PRESSURE	N/A					

A record of the formations drilled through, and pertinent remarks are presented on the reverse. I declare that I have knowledge of the contents of this report and am authorized by my organization to make this report, which was prepared by me or under my supervision and direction, with the data and facts stated herein to be true, correct, and complete to the best of my knowledge and belief.

*B. Hinkle*

SIGNATURE

Bruce A. Hinkle

NAME (PRINT OR TYPE)

08/06/2021

DATE

405-848-0924

PHONE NUMBER

5600 N. May Avenue, Suite 295

Oklahoma City

OK

73112

ADDRESS

CITY

STATE

ZIP

Laurahinkle@hoagi.com

EMAIL ADDRESS



PLEASE TYPE OR USE BLACK INK ONLY

FORMATION RECORD

Give formation names and tops, if available, or descriptions and thickness of formations drilled through. Show intervals cored or drillstem tested.

NAMES OF FORMATIONS	TOP
Oswego TVD	6196'
MTD	6330'

LEASE NAME Lincoln Southeast Oswego Unit

WELL NO. 48-3HO

FOR COMMISSION USE ONLY	
ITD on file <input type="checkbox"/> YES <input type="checkbox"/> NO	
APPROVED _____	DISAPPROVED _____
2) Reject Codes	

Were open hole logs run?	<input type="radio"/> yes <input checked="" type="radio"/> no
Date Last log was run	_____
Was CO <sub>2</sub> encountered?	<input type="radio"/> yes <input checked="" type="radio"/> no at what depths? _____
Was H <sub>2</sub> S encountered?	<input type="radio"/> yes <input checked="" type="radio"/> no at what depths? _____
Were unusual drilling circumstances encountered?	<input type="radio"/> yes <input checked="" type="radio"/> no
If yes, briefly explain below	

Other remarks:

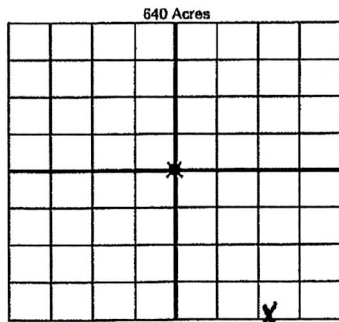

If more than three drainholes are proposed, attach a separate sheet indicating the necessary information.

Direction must be stated in degrees azimuth. Please note, the horizontal drainhole and its end point must be located within the boundaries of the lease or spacing unit.

Directional surveys are required for all drainholes and directional wells

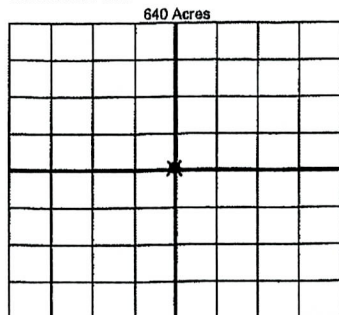

BOTTOM HOLE LOCATION FOR DIRECTIONAL HOLE

SEC	TWP	RGE	COUNTY
1/4	1/4	1/4	1/4
Measured Total Depth		True Vertical Depth	Feet From 1/4 Sec Lines
BHL From Lease, Unit, or Property Line:			

BOTTOM HOLE LOCATION FOR HORIZONTAL HOLE: (LATERALS)

LATERAL #1

SEC	TWP	RGE	COUNTY
19	17N	05W	Kingfisher
SW 1/4	SW 1/4	SE 1/4	SE 1/4
Depth of Deviation		Radius of Turn	Direction
Measured Total Depth		True Vertical Depth	Total Length
BHL From Lease, Unit, or Property Line:			

LATERAL #2

SEC	TWP	RGE	COUNTY
1/4	1/4	1/4	1/4
Depth of Deviation		Radius of Turn	Direction
Measured Total Depth		True Vertical Depth	Total Length
BHL From Lease, Unit, or Property Line:			

LATERAL #3

SEC	TWP	RGE	COUNTY
1/4	1/4	1/4	1/4
Depth of Deviation		Radius of Turn	Direction
Measured Total Depth		True Vertical Depth	Total Length
BHL From Lease, Unit, or Property Line:			