

Oklahoma Corporation Commission  
Oil & Gas Conservation Division  
Post Office Box 52000  
Oklahoma City, Oklahoma 73152-2000  
Rule 165: 10-3-25

Form 1002A

API No.: 35103247560000

**Completion Report**

Spud Date: August 06, 2019

OTC Prod. Unit No.:

Drilling Finished Date: August 09, 2019

1st Prod Date:

Completion Date: September 17, 2019

**Drill Type: STRAIGHT HOLE**

Well Name: GRACE 51

Purchaser/Measurer:

Location: NOBLE 16 24N 1W  
C W2 SW NE  
660 FSL 330 FWL of 1/4 SEC  
Derrick Elevation: 1082 Ground Elevation: 1069

First Sales Date:

Operator: DONRAY PETROLEUM LLC 21690

2525 NW EXPRESSWAY STE 640  
OKLAHOMA CITY, OK 73112-7230

Completion Type		Location Exception		Increased Density	
X	Single Zone	Order No		Order No	
	Multiple Zone	There are no Location Exception records to display.		There are no Increased Density records to display.	
	Commingled				

Casing and Cement								
Type		Size	Weight	Grade	Feet	PSI	SAX	Top of CMT
SURFACE		8 5/8	23		230		120	SURFACE
PRODUCTION		5.5	17		2808		250	1500

Liner								
Type	Size	Weight	Grade	Length	PSI	SAX	Top Depth	Bottom Depth
There are no Liner records to display.								

**Total Depth: 2808**

Packer		Plug	
Depth	Brand & Type	Depth	Plug Type
There are no Packer records to display.		2808	CIBP

Initial Test Data										
Test Date	Formation	Oil BBL/Day	Oil-Gravity (API)	Gas MCF/Day	Gas-Oil Ratio Cu FT/BBL	Water BBL/Day	Pumpin or Flowing	Initial Shut-In Pressure	Choke Size	Flow Tubing Pressure
Sep 17, 2019	TONKAWA	60	40	100	1667	600	SWAB	50		

Completion and Test Data by Producing Formation			
Formation Name: TONKAWA		Code: 406TNKW	Class: OIL
<b>Spacing Orders</b>		<b>Perforated Intervals</b>	
<b>Order No</b>	<b>Unit Size</b>	<b>From</b>	<b>To</b>
NONE		2680	2690
<b>Acid Volumes</b>		<b>Fracture Treatments</b>	
1,000 GALLONS 10% HCL		NONE	

Formation	Top
HOOVER	1950
ELGIN	2150
ENDICOTT	2300
TONKAWA	2600

Were open hole logs run? Yes  
Date last log run: August 09, 2019  
  
Were unusual drilling circumstances encountered? No  
Explanation:

Other Remarks
WAITING ON INJECTION WELL

FOR COMMISSION USE ONLY	
Status: Accepted	1143933

API NO.	10324756
OTC PROD. UNIT NO.	<del>21690</del>

(PLEASE TYPE OR USE BLACK INK ONLY)

OKLAHOMA CORPORATION COMMISSION

Oil &amp; Gas Conservation Division

Post Office Box 52000

Oklahoma City, Oklahoma 73152-2000

Rule 165:10-3-25

RECEIVED

OCT 07 2019

OKLAHOMA CORPORATION  
COMMISSION

640 Acres

<input checked="" type="checkbox"/>	ORIGINAL
<input type="checkbox"/>	AMENDED (Reason)

## TYPE OF DRILLING OPERATION

☒ STRAIGHT HOLE ☐ DIRECTIONAL HOLE ☐ HORIZONTAL HOLE

If directional or horizontal, see reverse for bottom hole location.

COUNTY	NOBLE	SEC	16	TWP	24N	RGE	1W	DATE OF WELL COMPLETION	9/17/19
LEASE NAME	GRACE					WELL NO.	51	1st PROD DATE	W/ON/DISP
C	1/4	W2	1/4	SW	1/4	NE	1/4	FSL OF 1/4 SEC	660
						FWL OF 1/4 SEC	330	RECOMP DATE	
ELEVATION Derrick FL	1082	Ground	1069	Latitude (if known)				Longitude (if known)	
OPERATOR NAME	DONRAY PETROLEUM LLC.						OTC / OCC OPERATOR NO.	21690	
ADDRESS		2525 NW EXPRESSWAY #640							
CITY	OKC					STATE	OK	ZIP	73112

## COMPLETION REPORT

SPUD DATE	8/6/19
DRLG FINISHED DATE	8/9/19
DATE OF WELL COMPLETION	9/17/19
1st PROD DATE	W/ON/DISP
RECOMP DATE	
Longitude (if known)	
W/ OCC RATOR NO.	21690
640	
OK	ZIP 73112

### COMPLETION TYPE

X	SINGLE ZONE	
	MULTIPLE ZONE	
	Application Date	
	COMMINGLED	
	Application Date	
LOCATION EXCEPTION		
ORDER NO.		
INCREASED DENSITY		
ORDER NO.		

**CASING & CEMENT (Attach Form 1002C)**

TYPE	SIZE	WEIGHT	GRADE	FEET	PSI	SAX	TOP OF CMT
CONDUCTOR							
SURFACE	8 5/8	23#		230		120	SURF.
INTERMEDIATE							
PRODUCTION	5.5	17#		2808		250	1500
LINER							
PLUG @	2808	TYPE	CIBP	PLUG @	TYPE	TOTAL DEPTH	2,808

PACKER @ _____	BRAND & TYPE _____	PLUG @ _____	2808	TYPE CIBP	PLUG @ _____	TYPE _____
PACKER @ _____	BRAND & TYPE _____	PLUG @ _____	_____	TYPE _____	PLUG @ _____	TYPE _____

### COMPLETION & TEST DATA BY PRODUCING FORMATION

FORMATION	TONKAWA						No Frac
SPACING & SPACING ORDER NUMBER	NONE						
CLASS: Oil, Gas, Dry, Inj, Disp, Comm Disp, Svc	OIL						
PERFORATED INTERVALS							
	2680/90						
ACID/VOLUME	1000 GAL 10% HCL						
FRACTURE TREATMENT (Fluids/Prop Amounts)	NO						

INITIAL TEST DATA	<input type="checkbox"/>	Min Gas Allowable	(165:10-17-7)	Gas Purchaser/Measurer	_____
		OR		First Sales Date	_____
		Oil Allowable	(165:10-13-3)		_____

### INITIAL TEST DATA

INITIAL TEST DATE	9/17/2019				
OIL-BBL/DAY	60 BPD				
OIL-GRAVITY ( API)	40				
GAS-MCF/DAY	100 MCFPD				
GAS-OIL RATIO CU FT/BBL	1667				
WATER-BBL/DAY	600 BPD				
PUMPING OR FLOWING	SWAB				
INITIAL SHUT-IN PRESSURE	50#				
CHOKE SIZE					
FLOW TUBING PRESSURE					

**AS SUBMITTED**

A record of the formations drilled through, and pertinent remarks are presented on the reverse. I declare that I have knowledge of the contents of this report and am authorized by my organization to make this report, which was prepared by me or under my supervision and direction, with the data and facts stated herein to be true, correct, and complete to the best of my knowledge and belief.

**RAY CORBITT JR**

10/2/2019

405 418 4348

~~SIGNATURE~~

NAME (PRINT OR TYPE)

DATE \_\_\_\_\_

PHONE NUMBER \_\_\_\_\_

2525 NW EXPRESSWAY #640

OKC

OK

73112

RAY@DONRAYPETROLEUM.COM

ADDRESS

CITY

STATE

ZIP

EMAIL ADDRESS

PLEASE TYPE OR USE BLACK INK ONLY  
FORMATION RECORD

Give formation names and tops, if available, or descriptions and thickness of formations drilled through. Show intervals cored or drillstem tested.

NAMES OF FORMATIONS	TOP
HOOVER	1,950
ELGIN	2,150
ENDICOTT	2300
TOKAWA	2,600

LEASE NAME GRACE WELL NO. 51

FOR COMMISSION USE ONLY	
ITD on file <input type="checkbox"/> YES <input type="checkbox"/> NO	
APPROVED <input type="checkbox"/> DISAPPROVED <input type="checkbox"/>	2) Reject Codes

Were open hole logs run? ☒ yes ☐ no

Date Last log was run 8/9/2019

Was CO<sub>2</sub> encountered? ☐ yes ☒ no at what depths?                     

Was H<sub>2</sub>S encountered? ☐ yes ☒ no at what depths?                     

Were unusual drilling circumstances encountered? ☐ yes ☒ no

If yes, briefly explain below

Other remarks: WAITING ON INJECTION WELL

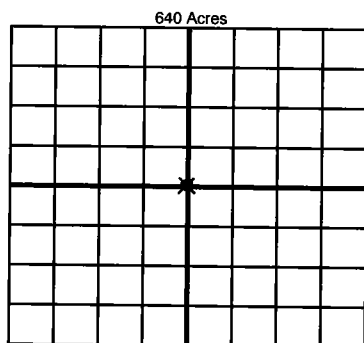

If more than three drainholes are proposed, attach a separate sheet indicating the necessary information.

Direction must be stated in degrees azimuth.  
Please note, the horizontal drainhole and its end point must be located within the boundaries of the lease or spacing unit.

Directional surveys are required for all drainholes and directional wells.

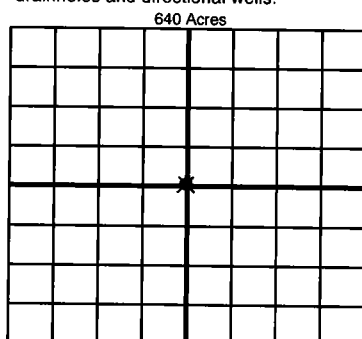

BOTTOM HOLE LOCATION FOR DIRECTIONAL HOLE

SEC	TWP	RGE	COUNTY
Spot Location			
1/4	1/4	1/4	1/4
Measured Total Depth		True Vertical Depth	Feet From 1/4 Sec Lines FSL FWL
BHL From Lease, Unit, or Property Line:			

BOTTOM HOLE LOCATION FOR HORIZONTAL HOLE: (LATERALS)

LATERAL #1

SEC	TWP	RGE	COUNTY
Spot Location			
1/4	1/4	1/4	1/4
Depth of Deviation		Radius of Turn	Direction
Measured Total Depth		True Vertical Depth	Total Length
BHL From Lease, Unit, or Property Line:			

LATERAL #2

SEC	TWP	RGE	COUNTY
Spot Location			
1/4	1/4	1/4	1/4
Depth of Deviation		Radius of Turn	Direction
Measured Total Depth		True Vertical Depth	Total Length
BHL From Lease, Unit, or Property Line:			

LATERAL #3

SEC	TWP	RGE	COUNTY
Spot Location			
1/4	1/4	1/4	1/4
Depth of Deviation		Radius of Turn	Direction
Measured Total Depth		True Vertical Depth	Total Length
BHL From Lease, Unit, or Property Line:			