

Oklahoma Corporation Commission  
Oil & Gas Conservation Division  
Post Office Box 52000  
Oklahoma City, Oklahoma 73152-2000  
Rule 165: 10-3-25

Form 1002A

API No.: 35103247570000

**Completion Report**

Spud Date: July 30, 2019

OTC Prod. Unit No.:

Drilling Finished Date: August 02, 2019

1st Prod Date:

Completion Date: September 30, 2019

**Drill Type: STRAIGHT HOLE**

Well Name: GRACE 50

Purchaser/Measurer:

Location: NOBLE 16 24N 1W  
W2 NW NE NE  
2310 FSL 1420 FWL of 1/4 SEC  
Derrick Elevation: 1084 Ground Elevation: 1071

First Sales Date:

Operator: DONRAY PETROLEUM LLC 21690

2525 NW EXPRESSWAY STE 640  
OKLAHOMA CITY, OK 73112-7230

Completion Type		Location Exception		Increased Density	
X	Single Zone	Order No		Order No	
	Multiple Zone	There are no Location Exception records to display.		There are no Increased Density records to display.	
	Commingled				

Casing and Cement							
Type	Size	Weight	Grade	Feet	PSI	SAX	Top of CMT
SURFACE	8 5/8	23		183		120	SURFACE
PRODUCTION	5.5	17		2836		120	1500

Liner								
Type	Size	Weight	Grade	Length	PSI	SAX	Top Depth	Bottom Depth
There are no Liner records to display.								

**Total Depth: 2849**

Packer		Plug	
Depth	Brand & Type	Depth	Plug Type
There are no Packer records to display.		2836	CIBP

Initial Test Data										
Test Date	Formation	Oil BBL/Day	Oil-Gravity (API)	Gas MCF/Day	Gas-Oil Ratio Cu FT/BBL	Water BBL/Day	Pumpin or Flowing	Initial Shut-In Pressure	Choke Size	Flow Tubing Pressure
Sep 30, 2019	TONKAWA	80	40	100	1250	800	SWAB	50		

Completion and Test Data by Producing Formation			
Formation Name: TONKAWA		Code: 406TNKW	Class: OIL
<b>Spacing Orders</b>		<b>Perforated Intervals</b>	
<b>Order No</b>	<b>Unit Size</b>	<b>From</b>	<b>To</b>
NONE		2678	2688
<b>Acid Volumes</b>		<b>Fracture Treatments</b>	
1,000 GALLONS 10% HCL		NONE	

Formation	Top
HOOVER	1950
ELGIN	2150
ENDICOTT	2300
TONKAWA	2600

Were open hole logs run? Yes  
Date last log run: August 02, 2019  
  
Were unusual drilling circumstances encountered? No  
Explanation:

Other Remarks
WAITING ON INJECTION WELL

FOR COMMISSION USE ONLY	
Status: Accepted	1143932

API NO. 10324757  
 OTC PROD. UNIT NO. 21090

(PLEASE TYPE OR USE BLACK INK ONLY)

OKLAHOMA CORPORATION COMMISSION  
 Oil & Gas Conservation Division  
 Post Office Box 52000  
 Oklahoma City, Oklahoma 73152-2000  
 Rule 165:10-3-25

RECEIVED  
 OCT 07 2019  
 OKLAHOMA CORPORATION COMMISSION

Form 1002A  
 Rev. 2009

☒ ORIGINAL  
☐ AMENDED (Reason) \_\_\_\_\_

COMPLETION REPORT

TYPE OF DRILLING OPERATION

☒ STRAIGHT HOLE ☐ DIRECTIONAL HOLE ☐ HORIZONTAL HOLE  
☐ SERVICE WELL

If directional or horizontal, see reverse for bottom hole location.

COUNTY NOBLE SEC 16 TWP 24N RGE 1W  
 LEASE NAME GRACE WELL NO. 50  
 W2 1/4 NW 1/4 NE 1/4 NE 1/4 FSL OF 1/4 SEC 2310 FWL OF 1/4 SEC 1420  
 ELEVATION Derrick FL 1084 Ground 1071 Latitude (if known) Longitude (if known)  
 OPERATOR NAME DONRAY PETROLEUM LLC. OTC / OCC OPERATOR NO. 21690  
 ADDRESS 2525 NW EXPRESSWAY #640  
 CITY OKC STATE OK ZIP 73112

SPUD DATE 7/30/19  
 DRG FINISHED DATE 8/2/19  
 DATE OF WELL COMPLETION 9/30/19  
 1st PROD DATE W/ON/DISP  
 RECOMP DATE

640 Acres  
 LOCATE WELL

COMPLETION TYPE

☒ SINGLE ZONE  
☐ MULTIPLE ZONE  
 Application Date  
 COMMINGLED  
 Application Date  
 LOCATION EXCEPTION ORDER NO.  
 INCREASED DENSITY ORDER NO.

CASING & CEMENT (Attach Form 1002C)

TYPE	SIZE	WEIGHT	GRADE	FEET	PSI	SAX	TOP OF CMT
CONDUCTOR							
SURFACE	8 5/8	23#		183		120	SURF
INTERMEDIATE							
PRODUCTION	5.5	17#		2836		300 120	1500
LINER							
						TOTAL DEPTH	2,849

PACKER @ \_\_\_\_\_ BRAND & TYPE \_\_\_\_\_ PLUG @ 2836 TYPE CIBP PLUG @ \_\_\_\_\_ TYPE \_\_\_\_\_  
 PACKER @ \_\_\_\_\_ BRAND & TYPE \_\_\_\_\_ PLUG @ \_\_\_\_\_ TYPE \_\_\_\_\_ PLUG @ \_\_\_\_\_ TYPE \_\_\_\_\_

COMPLETION & TEST DATA BY PRODUCING FORMATION

FORMATION	TONKAWA						No Frac
SPACING & SPACING ORDER NUMBER	NONE						
CLASS: Oil, Gas, Dry, Inj, Disp, Comm Disp, Svc	OIL						
PERFORATED INTERVALS	2678/86						
ACID/VOLUME	1000 GAL 10% HCL						
FRACTURE TREATMENT (Fluids/Prop Amounts)	NO						

Min Gas Allowable (165:10-17-7) OR Gas Purchaser/Measurer  
 Oil Allowable (165:10-13-3) First Sales Date

INITIAL TEST DATA

INITIAL TEST DATE	9/30/2019					
OIL-BBL/DAY	80BPD					
OIL-GRAVITY ( API)	40					
GAS-MCF/DAY	100MCFPD					
GAS-OIL RATIO CU FT/BBL	1250					
WATER-BBL/DAY	800BPD					
PUMPING OR FLOWING	SWAB					
INITIAL SHUT-IN PRESSURE	50#					
CHOKE SIZE						
FLOW TUBING PRESSURE						

AS SUBMITTED

A record of the formations drilled through, and pertinent remarks are presented on the reverse. I declare that I have knowledge of the contents of this report and am authorized by my organization to make this report, which was prepared by me or under my supervision and direction, with the data and facts stated herein to be true, correct, and complete to the best of my knowledge and belief.

SIGNATURE RAY CORBITT JR 10/2/2019 405 418 4348  
 ADDRESS 2525 NW EXPRESSWAY #640 CITY OKC STATE OK ZIP 73112  
 EMAIL ADDRESS RAY@DONRAYPETROLEUM.COM

PLEASE TYPE OR USE BLACK INK ONLY  
FORMATION RECORD

Give formation names and tops, if available, or descriptions and thickness of formations drilled through. Show intervals cored or drillstem tested.

LEASE NAME GRACE WELL NO. 50

NAMES OF FORMATIONS	TOP
HOOVER	1,950
ELGIN	2,150
ENDICOTT	2300
TONKAWA	2,600

FOR COMMISSION USE ONLY

ITD on file ☐ YES ☐ NO

APPROVED \_\_\_\_\_ DISAPPROVED \_\_\_\_\_

2) Reject Codes

\_\_\_\_\_

\_\_\_\_\_

\_\_\_\_\_

\_\_\_\_\_

Were open hole logs run? X yes \_\_\_ no

Date Last log was run 8/2/2019

Was CO<sub>2</sub> encountered? \_\_\_ yes X no at what depths? \_\_\_\_\_

Was H<sub>2</sub>S encountered? \_\_\_ yes X no at what depths? \_\_\_\_\_

Were unusual drilling circumstances encountered? \_\_\_ yes X no

If yes, briefly explain below

Other remarks: WAITING ON INJECTION WELL

\_\_\_\_\_

\_\_\_\_\_

\_\_\_\_\_

\_\_\_\_\_

\_\_\_\_\_

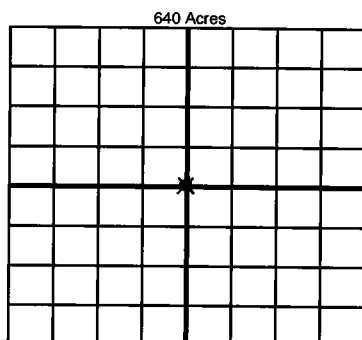

If more than three drainholes are proposed, attach a separate sheet indicating the necessary information.

Direction must be stated in degrees azimuth. Please note, the horizontal drainhole and its end point must be located within the boundaries of the lease or spacing unit.

Directional surveys are required for all drainholes and directional wells.

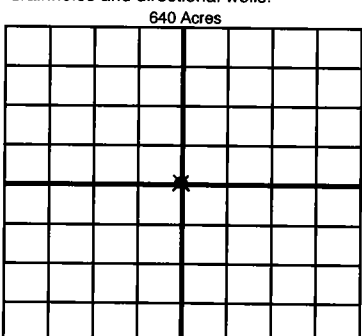

BOTTOM HOLE LOCATION FOR DIRECTIONAL HOLE

SEC	TWP	RGE	COUNTY
Spot Location		Feet From 1/4 Sec Lines	FSL
1/4	1/4	1/4	1/4
Measured Total Depth		True Vertical Depth	BHL From Lease, Unit, or Property Line:

BOTTOM HOLE LOCATION FOR HORIZONTAL HOLE: (LATERALS)

**LATERAL #1**

SEC	TWP	RGE	COUNTY
Spot Location		Feet From 1/4 Sec Lines	FSL
1/4	1/4	1/4	1/4
Depth of Deviation	Radius of Turn	Direction	Total Length
Measured Total Depth	True Vertical Depth	BHL From Lease, Unit, or Property Line:	

**LATERAL #2**

SEC	TWP	RGE	COUNTY
Spot Location		Feet From 1/4 Sec Lines	FSL
1/4	1/4	1/4	1/4
Depth of Deviation	Radius of Turn	Direction	Total Length
Measured Total Depth	True Vertical Depth	BHL From Lease, Unit, or Property Line:	

**LATERAL #3**

SEC	TWP	RGE	COUNTY
Spot Location		Feet From 1/4 Sec Lines	FSL
1/4	1/4	1/4	1/4
Depth of Deviation	Radius of Turn	Direction	Total Length
Measured Total Depth	True Vertical Depth	BHL From Lease, Unit, or Property Line:	