

Oklahoma Corporation Commission
Oil & Gas Conservation Division
Post Office Box 52000
Oklahoma City, Oklahoma 73152-2000
Rule 165: 10-3-25

Form 1002A

API No.: 35109224700000

Completion Report

Spud Date: July 11, 2019

OTC Prod. Unit No.: 109-226199-0-0000

Drilling Finished Date: July 26, 2019

1st Prod Date: August 28, 2019

Completion Date: August 19, 2019

Drill Type: HORIZONTAL HOLE

Min Gas Allowable: Yes

Well Name: BRONN 1404 32-09 1BH

Purchaser/Measurer: SUPERIOR PIPELINE

Location: OKLAHOMA 32 14N 4W
NE NE NW SE
2395 FSL 1574 FEL of 1/4 SEC
Latitude: 35.6450651 Longitude: -97.6434885
Derrick Elevation: 1089 Ground Elevation: 1071

First Sales Date: 10/08/2019

Operator: REVOLUTION RESOURCES LLC 24162

14301 CALIBER DR STE 110
OKLAHOMA CITY, OK 73134-1016

Completion Type		Location Exception		Increased Density	
X	Single Zone	Order No		Order No	
	Multiple Zone	There are no Location Exception records to display.		There are no Increased Density records to display.	
	Commingled				

Casing and Cement							
Type	Size	Weight	Grade	Feet	PSI	SAX	Top of CMT
CONDUCTOR	20	94	J-55	98			SURFACE
SURFACE	9.625	36	J-55	800		360	SURFACE
PRODUCTION	7	29	P-110	7463		395	2948

Liner								
Type	Size	Weight	Grade	Length	PSI	SAX	Top Depth	Bottom Depth
LINER	4.5	13.5	P-110	11926	0	0	7399	19325

Total Depth: 20009

Packer	
Depth	Brand & Type
There are no Packer records to display.	

Plug	
Depth	Plug Type
There are no Plug records to display.	

Initial Test Data

Test Date	Formation	Oil BBL/Day	Oil-Gravity (API)	Gas MCF/Day	Gas-Oil Ratio Cu FT/BBL	Water BBL/Day	Pumpin or Flowing	Initial Shut-In Pressure	Choke Size	Flow Tubing Pressure
Sep 18, 2019	HUNTON	564	38	480	851	805	PUMPING			

Completion and Test Data by Producing Formation									
Formation Name: HUNTON				Code: 269HNTN			Class: OIL		
Spacing Orders				Perforated Intervals					
Order No		Unit Size		From			To		
20212		UNIT		There are no Perf. Intervals records to display.					
Acid Volumes				Fracture Treatments					
254,730 GALLONS ACID				74,574 BARRELS WATER					

Formation	Top
OSWEGO	6398
BARTLESVILLE	6648
WOODFORD	6735
HUNTON	6751

Were open hole logs run? No
Date last log run:

Were unusual drilling circumstances encountered? No
Explanation:

Other Remarks
THIS WELL IS AN OPEN HOLE COMPLETION FROM THE BOTTOM OF THE 7" CASING AT 7,463' TO TOTAL DEPTH AT 20,009'. THE 4-1/2" LINER IS NOT CEMENTED.

Lateral Holes
Sec: 9 TWP: 13N RGE: 4W County: OKLAHOMA NE SW SW SW 453 FSL 534 FWL of 1/4 SEC Depth of Deviation: 6347 Radius of Turn: 1277 Direction: 171 Total Length: 12675 Measured Total Depth: 20009 True Vertical Depth: 6935 End Pt. Location From Release, Unit or Property Line: 4444

FOR COMMISSION USE ONLY
<div>Status: Accepted</div> <div>1143936</div>

API NO. 109-22470
OTC PROD. UNIT NO. 24162

(PLEASE TYPE OR USE BLACK INK ONLY)

OKLAHOMA CORPORATION COMMISSION

Oil & Gas Conservation Division

Post Office Box 52000

Oklahoma City, Oklahoma 73152-2000

Rule 165:10-3-25

COMPLETION REPORT

RECEIVED

OCT 10 2019

OKLAHOMA CORPORATION COMMISSION

☒ ORIGINAL
☐ AMENDED (Reason)

TYPE OF DRILLING OPERATION

☐ STRAIGHT HOLE ☐ DIRECTIONAL HOLE ☒ HORIZONTAL HOLE
☐ SERVICE WELL

If directional or horizontal, see reverse for bottom hole location.

COUNTY OKLAHOMA SEC 32 TWP 14N RGE 4W
LEASE NAME BRONN 1404 32-09
WELL NO. 1BH
NE 1/4 NE 1/4 NW 1/4 SE 1/4 FSL OF 2395' 1/4 SEC 1066'
ELEVATION 1089' Ground 1071' Latitude (if known) 35.6450651 Longitude (if known) -97.6434885
OPERATOR NAME REVOLUTION RESOURCES LLC OTC/OCC OPERATOR NO. 24162
ADDRESS 14301 CALIBER DR SUITE 110
CITY OKLAHOMA CITY STATE OK ZIP 73134

SPUD DATE 7/11/2019
DRLG FINISHED DATE 7/26/2019
DATE OF WELL COMPLETION 8/19/2019
1st PROD DATE 8/28/2019
RECOMP DATE
Longitude (if known) -97.6434885

640 Acres
LOCATE WELL

COMPLETION TYPE

☒ SINGLE ZONE
☐ MULTIPLE ZONE
Application Date
COMINGLED
Application Date
LOCATION EXCEPTION
ORDER NO.
INCREASED DENSITY
ORDER NO.

CASING & CEMENT (Form 1002C must be attached)

TYPE	SIZE	WEIGHT	GRADE	FEET	PSI	SAX	TOP OF CMT
CONDUCTOR	20	94	J-55	98'			SURF
SURFACE	9.625	36	J-55	800'		360	SURF
INTERMEDIATE	7	29	P-110	7463'		395	2948 CALC
PRODUCTION							
LINER	4.5	13.5	P-110	7399'-19325'	OPEN	HOLE	NA
TOTAL DEPTH							20009'

PACKER @ BRAND & TYPE PLUG @ TYPE PLUG @ TYPE
PACKER @ BRAND & TYPE PLUG @ TYPE PLUG @ TYPE

COMPLETION & TEST DATA BY PRODUCING FORMATION

FORMATION HUNTON
SPACING & SPACING ORDER NUMBER 2012 (unit)
CLASS: Oil, Gas, Dry, Inj, Disp, Comm Disp, Svc
OPENHOLE
PERFORATED INTERVALS COMPLETION
ACID/VOLUME 254,730 GAL ACID
74,574 BBLS WATER
FRACTURE TREATMENT (Fluids/Prop Amounts)

Reported to Frac Focus

☒ Min Gas Allowable (165:10-17-7)
OR
Oil Allowable (165:10-13-3)

Gas Purchaser/Measurer
First Sales Date

Superior Pipeline
10/8/2019

INITIAL TEST DATA

INITIAL TEST DATE 9/18/2019
OIL-BBL/DAY 564
OIL-GRAVITY (API) 38
GAS-MCF/DAY 480
GAS-OIL RATIO CU FT/BBLS 851
WATER-BBL/DAY 805
PUMPING OR FLOWING PUMPING
INITIAL SHUT-IN PRESSURE
CHOKE SIZE
FLOW TUBING PRESSURE

AS SUBMITTED

A record of the formations drilled through, and pertinent remarks are presented on the reverse. I declare that I have knowledge of the contents of this report and am authorized by my organization to make this report, which was prepared by me or under my supervision and direction, with the data and facts stated herein to be true, correct, and complete to the best of my knowledge and belief.

SIGNATURE JUSTIN LUNDQUIST 10/8/2019 405-256-4393
14301 Caliber Dr. Suite 110 Oklahoma City OK 73134
ADDRESS CITY STATE ZIP
EMAIL ADDRESS JustinL@revolutionresources.com

FORMATION RECORD

LEASE NAME BRONN 1404 WELL NO. 32-09 1BH

NAMES OF FORMATIONS	TOP
OSWEGO	6398'
BARTLESVILLE	6648'
WOODFORD	6735'
HUNTON	6751'

FOR COMMISSION USE ONLY	
ITD on file	<input type="checkbox"/> YES <input type="checkbox"/> NO
APPROVED	DISAPPROVED
<div style="border-bottom: 1px solid black; margin-bottom: 5px;"></div>	2) Reject Codes <div style="border-bottom: 1px solid black; margin-bottom: 5px;"></div> <div style="border-bottom: 1px solid black; margin-bottom: 5px;"></div> <div style="border-bottom: 1px solid black; margin-bottom: 5px;"></div> <div style="border-bottom: 1px solid black; margin-bottom: 5px;"></div> <div style="border-bottom: 1px solid black; margin-bottom: 5px;"></div>

Were open hole logs run? yes X no

Date Last log was run _____

Was CO₂ encountered? yes X no at what depths? _____

Was H₂S encountered? yes X no at what depths? _____

Were unusual drilling circumstances encountered? yes X no

If yes, briefly explain below

Other remarks: This well is an openhole completion from the bottom of the 7" casing at 7463' to TD at 20,009'. The 4-1/2" liner is not cemented.

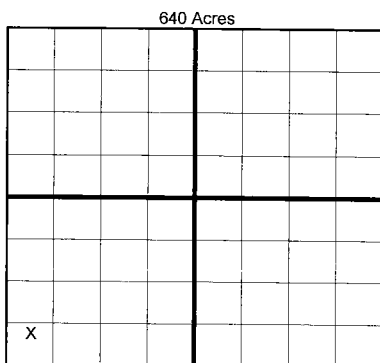

If more than three drainholes are proposed, attach a separate sheet indicating the necessary information.

Direction must be stated in degrees azimuth.
Please note, the horizontal drainhole and its end point must be located within the boundaries of the lease or spacing unit.

Directional surveys are required for all drainholes and directional wells.

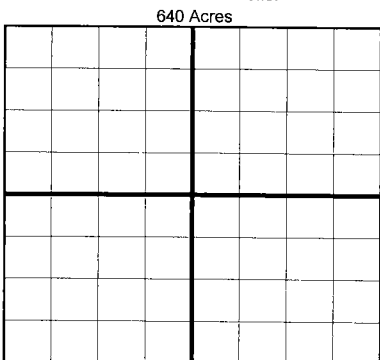

BOTTOM HOLE LOCATION FOR DIRECTIONAL HOLE

SEC	TWP	RGE	COUNTY
Spot Location			
1/4	1/4	1/4	1/4
Measured Total Depth		True Vertical Depth	Feet From 1/4 Sec Lines
			FSL
		FWL	
BHL From Lease, Unit, or Property Line:			

BOTTOM HOLE LOCATION FOR HORIZONTAL HOLE: (LATERALS)

LATERAL #1

SEC 9	TWP 13N	RGE 04W	COUNTY OKLAHOMA		
Spot Location			Feet From 1/4 Sec Lines		
NE 1/4	SW 1/4	SW 1/4	SW 1/4	FSL 453'	FWL 534'
Depth of Deviation 6347'		Radius of Turn 1277'		Direction 171 170 AZM	
Measured Total Depth 20,009'		True Vertical Depth 6935'		Total Length 12,675'	
		BHL From Lease, Unit, or Property Line: 4,444' FROM UNIT BOUNDARY			

LATERAL #2

SEC	TWP	RGE	COUNTY			
Spot Location						
1/4	1/4	1/4	1/4	Feet From 1/4 Sec Lines	FSL	FWL
Depth of Deviation		Radius of Turn		Direction	Total Length	
Measured Total Depth		True Vertical Depth		BHL From Lease, Unit, or Property Line:		

LATERAL #3

SEC	TWP	RGE	COUNTY			
Spot Location						
1/4	1/4	1/4	1/4	Feet From 1/4 Sec Lines	FSL	FWL
Depth of Deviation		Radius of Turn		Direction	Total Length	
Measured Total Depth		True Vertical Depth		BHL From Lease, Unit, or Property Line:		