

Oklahoma Corporation Commission
Oil & Gas Conservation Division
Post Office Box 52000
Oklahoma City, Oklahoma 73152-2000
Rule 165: 10-3-25

Form 1002A

API No.: 35071244320001

Completion Report

Spud Date: April 26, 2011

OTC Prod. Unit No.:

Drilling Finished Date: May 22, 2011

Amended

1st Prod Date:

Amend Reason: RECOMPLETE / CHANGE WELL NAME

Completion Date: July 08, 2011

Recomplete Date: August 05, 2019

Drill Type: STRAIGHT HOLE

Well Name: BOWLING RANCH (BOWLING 2-32) 2-32

Purchaser/Measurer:

Location: KAY 32 29N 4E
NW NW NE NE
230 FNL 1185 FEL of 1/4 SEC
Latitude: 36.57184 Longitude: -96.53211
Derrick Elevation: 0 Ground Elevation: 1211

First Sales Date:

Operator: K3 OIL & GAS OPERATING COMPANY 24093

24900 PITKIN RD STE 305
THE WOODLANDS, TX 77386-1973

Completion Type		Location Exception		Increased Density	
X	Single Zone	Order No		Order No	
	Multiple Zone	688050		There are no Increased Density records to display.	
	Commingled				

Casing and Cement							
Type	Size	Weight	Grade	Feet	PSI	SAX	Top of CMT
CONDUCTOR	16			40		7	SURFACE
SURFACE	9.625	36	J-55	278		100	SURFACE
PRODUCTION	7	23	N-80	3555		525	SURFACE

Liner								
Type	Size	Weight	Grade	Length	PSI	SAX	Top Depth	Bottom Depth
There are no Liner records to display.								

Total Depth: 4633

Packer		Plug	
Depth	Brand & Type	Depth	Plug Type
There are no Packer records to display.		3650	CIBP + 15' CEMENT

Initial Test Data

Test Date	Formation	Oil BBL/Day	Oil-Gravity (API)	Gas MCF/Day	Gas-Oil Ratio Cu FT/BBL	Water BBL/Day	Pumpin or Flowing	Initial Shut-In Pressure	Choke Size	Flow Tubing Pressure
Aug 05, 2019	MISSISSIPPIAN	101	38			216	PUMPING			

Completion and Test Data by Producing Formation	
Formation Name: MISSISSIPPIAN	Code: 359MSSP
Class: OIL	

Spacing Orders	
Order No	Unit Size
680149	40

Perforated Intervals	
From	To
3248	3281

Acid Volumes	
There are no Acid Volume records to display.	

Fracture Treatments	
1,962 BARRELS WATER	

Formation	Top
BIG LIME	2717
CLEVELAND	2730
SKINNER	3045
MISSISSIPPI CHERT	3231
SIMPSON	3576
ARBUCKLE	3604

Were open hole logs run? No

Date last log run:

Were unusual drilling circumstances encountered? No

Explanation:

Other Remarks
There are no Other Remarks.

FOR COMMISSION USE ONLY	
Status: Accepted	1143934

API
NO. 071 24432
OTC PROD.
UNIT NO.

(PLEASE TYPE OR USE BLACK INK ONLY)

OKLAHOMA CORPORATION COMMISSION
Oil & Gas Conservation Division
Post Office Box 52000
Oklahoma City, Oklahoma 73152-2000
Rule 165:10-3-25

RECEIVED

Form 1002A
Rev. 2009

OCT 07 2019

☐ ORIGINAL
☒ AMENDED (Reason)

Recomplete
Fracs of well

COMPLETION REPORT

TYPE OF DRILLING OPERATION
☒ STRAIGHT HOLE ☐ DIRECTIONAL HOLE ☐ HORIZONTAL HOLE
☐ SERVICE WELL
If directional or horizontal, see reverse for bottom hole location.

SPUD DATE 4-26-2011
DRLG FINISHED DATE 5-22-2011
DATE OF WELL COMPLETION 7-8-2011
1st PROD DATE
RECOMP DATE 8/5/2019
Longitude (if known) -96.53211

COUNTY KAY SEC 32 TWP 29N RGE 4E
LEASE NAME BOWLING RANCH
NW 1/4 NW 1/4 NE 1/4 NE 1/4 1/4 SEC 230 1/4 SEC 1185
ELEVATION Ground 1211 Latitude (if known) 36.57184
OPERATOR NAME K3 OIL & GAS DPCO OTC/OCC OPERATOR NO. 24093
ADDRESS 24900 PITKIN RD # 305
CITY THE WOODLANDS STATE TX ZIP 77386

OKLAHOMA CORPORATION COMMISSION

LOCATE WELL

COMPLETION TYPE

☒ SINGLE ZONE
☐ MULTIPLE ZONE
Application Date
COMINGLED
Application Date
LOCATION EXCEPTION
ORDER NO. 688050
INCREASED DENSITY
ORDER NO.

CASING & CEMENT (Attach Form 1002C)

TYPE	SIZE	WEIGHT	GRADE	FEET	PSI	SAX	TOP OF CMT
CONDUCTOR	16			40		7	SURFACE
SURFACE	9.625	36	7.55	278		100	SURFACE
INTERMEDIATE	7	23	N80	3555	525.215		2000 SURFACE
PRODUCTION							
LINER	4.5	11.6	N80	3367			

PACKER @ BRAND & TYPE No Record PLUG @ 3650 TYPE CFBP+15' cement
PACKER @ BRAND & TYPE No Record PLUG @ TYPE PLUG @ TYPE

TOTAL DEPTH 4633

Per operator

COMPLETION & TEST DATA BY PRODUCING FORMATION

359 MSSP

FORMATION	MISSISSIPPIAN					No Frac (No Proppant used)
SPACING & SPACING						
ORDER NUMBER	680149(40)					
CLASS: Oil, Gas, Dry, Inj, Disp, Comm Disp, Svc	Oil					
PERFORATED INTERVALS	3248-3281					
ACID/VOLUME						
FRACTURE TREATMENT (Fluids/Prop Amounts)	1962 BBLs water					

Min Gas Allowable (165:10-17-7)

Gas Purchaser/Measurer

First Sales Date

INITIAL TEST DATA

Oil Allowable (165:10-13-3)

INITIAL TEST DATE	3/5/2019				
OIL-BBL/DAY	101				
OIL-GRAVITY (API)	38°				
GAS-MCF/DAY	0				
GAS-OIL RATIO CU FT/BBL					
WATER-BBL/DAY	216				
PUMPING OR FLOWING	PUMPING				
INITIAL SHUT-IN PRESSURE	N/A				
CHOKE SIZE	N/A				
FLOW TUBING PRESSURE	N/A				

AS SUBMITTED

A record of the formations drilled through, and pertinent remarks are presented on the reverse. I declare that I have knowledge of the contents of this report and am authorized by my organization to make this report, which was prepared by me or under my supervision and direction, with the data and facts stated herein to be true, correct, and complete to the best of my knowledge and belief.

SIGNATURE [Signature] NAME (PRINT OR TYPE) JOHN A. RICAR DATE 9/27/2019 PHONE NUMBER 832.813.8858
ADDRESS 24900 PITKIN RD #305 CITY WOODLANDS STATE TX ZIP 77386 EMAIL ADDRESS JOHN.A.RICAR@K3OIL.COM

PLEASE TYPE OR USE BLACK INK ONLY
FORMATION RECORD

Give formation names and tops, if available, or descriptions and thickness of formations drilled through. Show intervals cored or drillstem tested.

LEASE NAME BOWLING RANCH

WELL NO. 2-32

NAMES OF FORMATIONS	BOTTOM	TOP
CLEVELAND	<15027	2730
BIG LIME	<15897	2717
SKINNER	<18177	3045
MISS CHEST	<20037	3231
SIMPSON	<23487	3576
ALBUQUERQUE	<23707	3604

FOR COMMISSION USE ONLY

ITD on file ☐ YES ☐ NO

APPROVED _____ DISAPPROVED _____

2) Reject Codes _____

Were open hole logs run? _____ yes ☒ no

Date Last log was run _____ N/A

Was CO₂ encountered? _____ yes ☒ no at what depths? _____

Was H₂S encountered? _____ yes ☒ no at what depths? _____

Were unusual drilling circumstances encountered? _____ yes _____ no
If yes, briefly explain below _____

Other remarks:

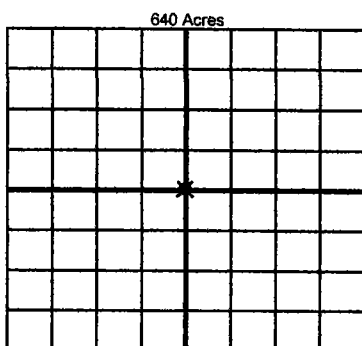

If more than three drainholes are proposed, attach a separate sheet indicating the necessary information.

Direction must be stated in degrees azimuth. Please note, the horizontal drainhole and its end point must be located within the boundaries of the lease or spacing unit.

Directional surveys are required for all drainholes and directional wells.

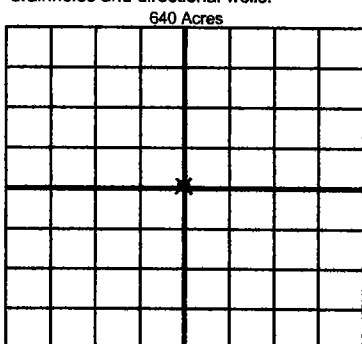

BOTTOM HOLE LOCATION FOR DIRECTIONAL HOLE

SEC 32 TWP 29 N RGE 04 E COUNTY KAY

Spot Location NW 1/4 NW 1/4 NE 1/4 NE 1/4 Feet From 1/4 Sec Lines FSL 230 FEL 1185

Measured Total Depth 4633 True Vertical Depth _____ BHL From Lease, Unit, or Property Line: _____

BOTTOM HOLE LOCATION FOR HORIZONTAL HOLE: (LATERALS)

LATERAL #1

SEC _____ TWP _____ RGE _____ COUNTY _____

Spot Location _____ 1/4 _____ 1/4 _____ 1/4 Feet From 1/4 Sec Lines _____ FSL _____ FWL _____

Depth of Deviation _____ Radius of Turn _____ Direction _____ Total Length _____

Measured Total Depth _____ True Vertical Depth _____ BHL From Lease, Unit, or Property Line: _____

LATERAL #2

SEC _____ TWP _____ RGE _____ COUNTY _____

Spot Location _____ 1/4 _____ 1/4 _____ 1/4 Feet From 1/4 Sec Lines _____ FSL _____ FWL _____

Depth of Deviation _____ Radius of Turn _____ Direction _____ Total Length _____

Measured Total Depth _____ True Vertical Depth _____ BHL From Lease, Unit, or Property Line: _____

LATERAL #3

SEC _____ TWP _____ RGE _____ COUNTY _____

Spot Location _____ 1/4 _____ 1/4 _____ 1/4 Feet From 1/4 Sec Lines _____ FSL _____ FWL _____

Depth of Deviation _____ Radius of Turn _____ Direction _____ Total Length _____

Measured Total Depth _____ True Vertical Depth _____ BHL From Lease, Unit, or Property Line: _____

straight hole (DRA)