

Oklahoma Corporation Commission
Oil & Gas Conservation Division
Post Office Box 52000
Oklahoma City, Oklahoma 73152-2000
Rule 165: 10-3-25

Form 1002A

API No.: 35085212930000

Completion Report

Spud Date: November 23, 2018

OTC Prod. Unit No.:

Drilling Finished Date: December 05, 2018

1st Prod Date: March 20, 2019

Completion Date: January 02, 2019

Drill Type: STRAIGHT HOLE

Well Name: STAHLER 1-24

Purchaser/Measurer:

Location: LOVE 24 6S 1W
SE NE NE NW
2270 FSL 2525 FWL of 1/4 SEC
Latitude: 34.026543 Longitude: -97.25688
Derrick Elevation: 0 Ground Elevation: 785

First Sales Date:

Operator: E2 OPERATING LLC 23901

1560 E 21ST ST STE 215
TULSA, OK 74114-1345

Completion Type	
X	Single Zone
	Multiple Zone
	Commingle

Location Exception
Order No
There are no Location Exception records to display.

Increased Density
Order No
There are no Increased Density records to display.

Casing and Cement							
Type	Size	Weight	Grade	Feet	PSI	SAX	Top of CMT
CONDUCTOR				45		110	SURFACE
SURFACE	8 5/8			1109		550	3
PRODUCTION	5 1/2			8983		350	6470

Liner								
Type	Size	Weight	Grade	Length	PSI	SAX	Top Depth	Bottom Depth
There are no Liner records to display.								

Total Depth: 9100

Packer	
Depth	Brand & Type
There are no Packer records to display.	

Plug	
Depth	Plug Type
There are no Plug records to display.	

Initial Test Data

Test Date	Formation	Oil BBL/Day	Oil-Gravity (API)	Gas MCF/Day	Gas-Oil Ratio Cu FT/BBL	Water BBL/Day	Pumpin or Flowing	Initial Shut-In Pressure	Choke Size	Flow Tubing Pressure
Mar 20, 2019	DEESE	10				50	PUMPING			

Completion and Test Data by Producing Formation	
Formation Name: DEESE	Code: 404DEESS
Class: OIL	

Spacing Orders	
Order No	Unit Size
532907	UNIT

Perforated Intervals	
From	To
8744	8767

Acid Volumes
700 GALLONS 7 1/2% HCL

Fracture Treatments
X-LINK GEL FRAC, 988 BARRELS, 30,000 POUNDS 20/40 WHITE SAND

Formation	Top
------------------	------------

Were open hole logs run? Yes

Date last log run: December 06, 2018

Were unusual drilling circumstances encountered? No

Explanation:

Other Remarks
There are no Other Remarks.

FOR COMMISSION USE ONLY	
Status: Accepted	1143937

API NO. 085-21293
OTC PROD. UNIT NO. 085

(PLEASE TYPE OR USE BLACK INK ONLY)

OKLAHOMA CORPORATION COMMISSION
Oil & Gas Conservation Division
Post Office Box 52000
Oklahoma City, Oklahoma 73152-2000
Rule 165:10-3-25

RECEIVED

Form 1002A
Rev. 2009

OCT 15 2019

OKLAHOMA CORPORATION
COMMISSION
640 Acres

☒ ORIGINAL
☐ AMENDED (Reason)

TYPE OF DRILLING OPERATION

☒ STRAIGHT HOLE ☐ DIRECTIONAL HOLE ☐ HORIZONTAL HOLE
☐ SERVICE WELL

If directional or horizontal, see reverse for bottom hole location.

COUNTY	LOVE	SEC	24	TWP	6S	RGE	1W	SPUD DATE	11-23-18
LEASE NAME	STAHLER			WELL NO.	1-24	DRLG FINISHED DATE	12-5-18	DATE OF WELL COMPLETION	1-2-19
SE 1/4 NE 1/4 NE 1/4 NW 1/4	FSL OF 1/4 SEC	2270	FWL OF 1/4 SEC	2525	1st PROD DATE	3-20-19			RECOMP DATE
ELEVATION Derrick FL	Ground	785	Latitude (if known)	34.026543"	Longitude (if known)	-97.256880"			
OPERATOR NAME	E2 OPERATING LLC			OTC / OCC OPERATOR NO.	23901				
ADDRESS	1560 E 21ST STE 215								
CITY	TULSA		STATE	OK	ZIP	74114			

LOCATE WELL

COMPLETION TYPE

<input checked="" type="checkbox"/> SINGLE ZONE	
<input type="checkbox"/> MULTIPLE ZONE	
Application Date	
COMINGLED	
Application Date	
LOCATION EXCEPTION ORDER NO.	
INCREASED DENSITY ORDER NO.	

CASING & CEMENT (Attach Form 1002C)

TYPE	SIZE	WEIGHT	GRADE	FEET	PSI	SAX	TOP OF CMT
CONDUCTOR				45		110	SURF.
SURFACE	8 5/8			1109	550	300	3
INTERMEDIATE							
PRODUCTION	5 1/2			8983		350	6470
LINER							
							9100

PACKER @ BRAND & TYPE

PLUG @ TYPE PLUG @ TYPE PLUG @ TYPE

TOTAL DEPTH 9100

COMPLETION & TEST DATA BY PRODUCING FORMATION

FORMATION	DEESE								
SPACING & SPACING ORDER NUMBER	532907 (unit)								
CLASS: Oil, Gas, Dry, Inj, Disp, Comm Disp, Svc	OIL								
PERFORATED INTERVALS	8757-67								
	8744-48								
ACID/VOLUME	700 GAL 7 1/2 HCL								
FRACTURE TREATMENT (Fluids/Prop Amounts)	X-LINK GEL FRAC								
	988 BBLS								
	30000# 20/40 WHITE SAND								

Min Gas Allowable (165:10-17-7)

Gas Purchaser/Measurer

☐

OR

First Sales Date

Oil Allowable (165:10-13-3)

INITIAL TEST DATA

INITIAL TEST DATE	3/20/2019								
OIL-BBL/DAY	10								
OIL-GRAVITY (API)									
GAS-MCF/DAY									
GAS-OIL RATIO CU FT/BBL									
WATER-BBL/DAY	50								
PUMPING OR FLOWING	PUMPING								
INITIAL SHUT-IN PRESSURE									
CHOKE SIZE									
FLOW TUBING PRESSURE									

AS SUBMITTED

A record of the formations drilled through and pertinent remarks are presented on the reverse. I declare that I have knowledge of the contents of this report and am authorized by my organization to make this report, which was prepared by me or under my supervision and direction, with the data and facts stated herein to be true, correct, and complete to the best of my knowledge and belief.

SIGNATURE	VICKIE HARTER	DATE	5/9/2019	PHONE NUMBER	918-281-5274
ADDRESS	1560 E. 21ST STE 215	CITY	TULSA	STATE	OK
		ZIP	74114	EMAIL ADDRESS	VHARTER@EXPONENT-ENERGY.COM

PLEASE TYPE OR USE BLACK INK ONLY

FORMATION RECORD

Give formation names and tops, if available, or descriptions and thickness of formations drilled through. Show intervals cored or drillstem tested.

NAMES OF FORMATIONS	TOP
T.D.	9100'

LEASE NAME STAHLER WELL NO. 24-Jan

FOR COMMISSION USE ONLY	
ITD on file <input type="checkbox"/> YES <input type="checkbox"/> NO	
APPROVED _____	DISAPPROVED _____
2) Reject Codes	

Were open hole logs run?	<input checked="" type="checkbox"/> yes <input type="checkbox"/> no
Date Last log was run	<u>12/6/2018</u>
Was CO ₂ encountered?	<input type="checkbox"/> yes <input checked="" type="checkbox"/> no at what depths? _____
Was H ₂ S encountered?	<input type="checkbox"/> yes <input checked="" type="checkbox"/> no at what depths? _____
Were unusual drilling circumstances encountered?	<input type="checkbox"/> yes <input checked="" type="checkbox"/> no
If yes, briefly explain below	

Other remarks:

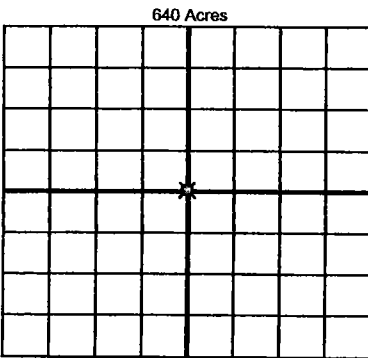

If more than three drainholes are proposed, attach a separate sheet indicating the necessary information.

Direction must be stated in degrees azimuth. Please note, the horizontal drainhole and its end point must be located within the boundaries of the lease or spacing unit.

Directional surveys are required for all drainholes and directional wells.

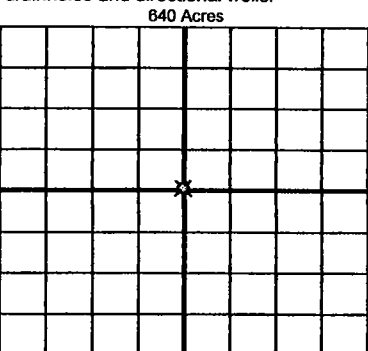

BOTTOM HOLE LOCATION FOR DIRECTIONAL HOLE

SEC	TWP	RGE	COUNTY
Spot Location	1/4	1/4	1/4
Measured Total Depth	True Vertical Depth	BHL From Lease, Unit, or Property Line:	

BOTTOM HOLE LOCATION FOR HORIZONTAL HOLE: (LATERALS)

LATERAL #1			
SEC	TWP	RGE	COUNTY
Spot Location	1/4	1/4	1/4
Depth of Deviation	Radius of Turn	Direction	Total Length
Measured Total Depth	True Vertical Depth	BHL From Lease, Unit, or Property Line:	

LATERAL #2			
SEC	TWP	RGE	COUNTY
Spot Location	1/4	1/4	1/4
Depth of Deviation	Radius of Turn	Direction	Total Length
Measured Total Depth	True Vertical Depth	BHL From Lease, Unit, or Property Line:	

LATERAL #3			
SEC	TWP	RGE	COUNTY
Spot Location	1/4	1/4	1/4
Depth of Deviation	Radius of Turn	Direction	Total Length
Measured Total Depth	True Vertical Depth	BHL From Lease, Unit, or Property Line:	