

Oklahoma Corporation Commission
Oil & Gas Conservation Division
Post Office Box 52000
Oklahoma City, Oklahoma 73152-2000
Rule 165: 10-3-25

Form 1002A

API No.: 35071243300001

Completion Report

Spud Date: October 27, 2009

OTC Prod. Unit No.: 071-125496-0-0000

Drilling Finished Date: October 30, 2009

Amended

1st Prod Date: December 29, 2009

Amend Reason: ACIDIZE EXISTING ZONE

Completion Date: November 18, 2009

Recomplete Date: July 15, 2021

Drill Type: STRAIGHT HOLE

Well Name: REDBUD 2-33

Purchaser/Measurer:

Location: KAY 33 29N 1W
C N2 N2 SW
2310 FSL 1320 FWL of 1/4 SEC
Derrick Elevation: 1104 Ground Elevation: 1091

First Sales Date:

Operator: BARBER OIL LLC 24363

8801 S YALE AVE STE 150
TULSA, OK 74137-3575

| Completion Type | |
|-----------------|---------------|
| X | Single Zone |
| | Multiple Zone |
| | Commingled |

| Location Exception | |
|-----------------------------------------------------|--|
| Order No | |
| There are no Location Exception records to display. | |

| Increased Density | |
|----------------------------------------------------|--|
| Order No | |
| There are no Increased Density records to display. | |

| Casing and Cement | | | | | | | |
|-------------------|-------|--------|-------|------|-----|-----|------------|
| Type | Size | Weight | Grade | Feet | PSI | SAX | Top of CMT |
| SURFACE | 8 5/8 | 24 | | 252 | | 160 | SURFACE |
| PRODUCTION | 5 1/2 | 15.5 | | 3278 | | 175 | 2278 |

| Liner | | | | | | | | |
|----------------------------------------|------|--------|-------|--------|-----|-----|-----------|--------------|
| Type | Size | Weight | Grade | Length | PSI | SAX | Top Depth | Bottom Depth |
| There are no Liner records to display. | | | | | | | | |

Total Depth: 3280

| Packer | |
|-----------------------------------------|--------------|
| Depth | Brand & Type |
| There are no Packer records to display. | |

| Plug | |
|---------------------------------------|-----------|
| Depth | Plug Type |
| There are no Plug records to display. | |

| Initial Test Data |
|-------------------|
|-------------------|

| Test Date | Formation | Oil BBL/Day | Oil-Gravity (API) | Gas MCF/Day | Gas-Oil Ratio Cu FT/BBL | Water BBL/Day | Pumpin or Flowing | Initial Shut- In Pressure | Choke Size | Flow Tubing Pressure |
|--------------|-----------|----------------|----------------------|----------------|----------------------------|------------------|----------------------|---------------------------------|---------------|-------------------------|
| Dec 29, 2009 | CLEVELAND | 13.47 | 40 | | | 3 | PUMPING | 680 | 16/64 | 78 |
| Jul 15, 2021 | CLEVELAND | 0.83 | 40 | | | 41 | PUMPING | | | |

| Completion and Test Data by Producing Formation | | | | | | | | | |
|--------------------------------------------------|--|-----------|--|------------------------------------------------------|--|--|------------|--|--|
| Formation Name: CLEVELAND | | | | Code: 405CLVD | | | Class: OIL | | |
| Spacing Orders | | | | Perforated Intervals | | | | | |
| Order No | | Unit Size | | From | | | To | | |
| 553295 | | 640 | | 3190 | | | 3206 | | |
| Acid Volumes | | | | Fracture Treatments | | | | | |
| ORIGINAL TREATMENT 1,000 GALLONS, 650 BARRELS | | | | There are no Fracture Treatments records to display. | | | | | |

| | | | | | |
|--------------------------------|-----------|----------------------|------|------------|--|
| Formation Name: CLEVELAND | | Code: 405CLVD | | Class: OIL | |
| Spacing Orders | | Perforated Intervals | | | |
| Order No | Unit Size | From | To | | |
| 553295 | 640 | 3190 | 3206 | | |
| Acid Volumes | | Fracture Treatments | | | |
| NEW TREATMENT 1,000 GALLONS | | NONE | | | |

| Formation | Top |
|-------------------|------|
| TONKAWA | 2450 |
| LAYTON | 2905 |
| CLEVELAND | 3190 |
| BIG LIME / OSWEGO | 3274 |

Were open hole logs run? Yes
Date last log run:

Were unusual drilling circumstances encountered? No
Explanation:

| Other Remarks |
|-----------------------------|
| There are no Other Remarks. |

| FOR COMMISSION USE ONLY | | | | | | | | | | |
|-------------------------|--|--|--|--|--|--|--|--|--|---------|
| Status: Accepted | | | | | | | | | | 1146869 |

API NO. 071-24330
OTC PROD. UNIT NO. 071-125496

Oil and Gas Conservation Division
P.O. Box 52000
Oklahoma City, OK 73152-2000
405-522-0577
OCCCentralProcessing@OCC.OK.GOV



Form 1002A
Rev. 2020

ORIGINAL
AMENDED (Reason) acidize existing zone

Rule 165:10-3-25

COMPLETION REPORT

TYPE OF DRILLING OPERATION

☒ STRAIGHT HOLE ☐ DIRECTIONAL HOLE ☐ HORIZONTAL HOLE
☐ SERVICE WELL

If directional or horizontal, see reverse for bottom hole location.

| | | | | | | | | |
|---------------|-----------------------------------|-----|--------|------|-------|----------|------------------------|-------|
| COUNTY | Kay | SEC | 33 | TWP | 29N | RGE | 1W | |
| LEASE NAME | Red Bud | | | | | | WELL NO. | 2-33 |
| C | 1/4 | N/2 | 1/4 | N/2 | 1/4 | SW | 1/4 | |
| FSL | 2310' | | | FWL | 1320' | | | |
| ELEVATION | Derrick FL 1104 | | Ground | 1091 | | Latitude | Longitude | |
| OPERATOR NAME | Barber Oil, LC | | | | | | OTC / OCC OPERATOR NO. | 24363 |
| ADDRESS | 8801 South Yale Avenue, Suite 150 | | | | | | | |
| CITY | Tulsa | | STATE | OK | | ZIP | 74137 | |

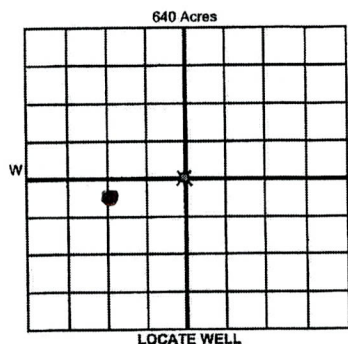

LOCATE WELL

COMPLETION TYPE

| | |
|----------------------------------------------|--|
| <input checked="" type="radio"/> SINGLE ZONE | |
| <input type="radio"/> MULTIPLE ZONE | |
| <input type="radio"/> COMMINGLED | |
| LOCATION EXCEPTION ORDER NO. | |
| MULTIUNIT ORDER NO. | |
| INCREASED DENSITY ORDER NO. | |

CASING & CEMENT (Attach Form 1002C)

| TYPE | SIZE | WEIGHT | GRADE | FEET | PSI | SAX | TOP OF CMT |
|--------------|-------|--------|-------|------|-----|-----|------------|
| CONDUCTOR | | | | | | | |
| SURFACE | 8 5/8 | 24# | | 252 | | 160 | Surface |
| INTERMEDIATE | | | | | | | |
| PRODUCTION | 5 1/2 | 15.5# | | 3278 | | 175 | 2278 |
| LINER | | | | | | | |

PACKER @ _____ BRAND & TYPE _____ PLUG @ _____ TYPE _____ PLUG @ _____ TYPE _____
PACKER @ _____ BRAND & TYPE _____ PLUG @ _____ TYPE _____ PLUG @ _____ TYPE _____
COMPLETION & TEST DATA BY PRODUCING FORMATION 405 CLVD

| | | | | | |
|-------------------------------------------------|-----------------|-----------------|--|--|---------|
| FORMATION | Cleveland | Cleveland | | | No Frac |
| SPACING & SPACING ORDER NUMBER | 553295 - 640 ac | 553295 - 640 ac | | | |
| CLASS: Oil, Gas, Dry, Inj, Disp, Comm Disp, Svc | Oil | Oil | | | |
| | 3190'-3206' | 3190'-3206' | | | |
| PERFORATED INTERVALS | | | | | |
| ACID/VOLUME | 1000 gals | 1000 gals | | | |
| FRACTURE TREATMENT (Fluids/Prop Amounts) | yes 650 bbls | no | | | |

RECEIVED

SEP 03 2021

OKLAHOMA CORPORATION COMMISSION

Min Gas Allowable (165:10-17-7)

Purchaser/Measurer



OR

First Sales Date

Oil Allowable (165:10-13-3)

INITIAL TEST DATA

| | | | | | |
|--------------------------|------------|-----------|--|--|--|
| INITIAL TEST DATE | 12/29/2009 | 7/15/2021 | | | |
| OIL-BBL/DAY | 13.47 | .83 | | | |
| OIL-GRAVITY (API) | 40 | 40 | | | |
| GAS-MCF/DAY | 0 | 0 | | | |
| GAS-OIL RATIO CU FT/BBL | 0 | 0 | | | |
| WATER-BBL/DAY | 3.37 | 41 | | | |
| PUMPING OR FLOWING | pump | pump | | | |
| INITIAL SHUT-IN PRESSURE | 680 | | | | |
| CHOKE SIZE | 16/64 | | | | |
| FLOW TUBING PRESSURE | 78 | | | | |

A record of the formations drilled through, and pertinent remarks are presented on the reverse. I declare that I have knowledge of the contents of this report and am authorized by my organization to make this report, which was prepared by me or under my supervision and direction, with the data and facts stated herein to be true, correct, and complete to the best of my knowledge and belief.

Barbara Courtney

Barbara Courtney

9/1/2021

918-638-5951

SIGNATURE

NAME (PRINT OR TYPE)

DATE

PHONE NUMBER

8801 South Yale Ave, Suite 150

Tulsa

OK

74137

bcourtney@barberoilo.com

ADDRESS

CITY

STATE

ZIP

EMAIL ADDRESS

PLEASE TYPE OR USE BLACK INK ONLY
FORMATION RECORD

Give formation names and tops, if available, or descriptions and thickness of formations drilled through. Show intervals cored or drillstem tested.

| NAMES OF FORMATIONS | TOP |
|---------------------|------|
| Tonkawa | 2450 |
| Layton | 2905 |
| Cleveland | 3190 |
| Big Lime/Oswego | 3274 |

LEASE NAME _____

WELL NO. _____

| FOR COMMISSION USE ONLY | | |
|-------------------------|------------------------------|-----------------------------|
| ITD on file | <input type="checkbox"/> YES | <input type="checkbox"/> NO |
| APPROVED | DISAPPROVED | 2) Reject Codes |
| | | |
| | | |
| | | |
| | | |
| | | |

Were open hole logs run? ☒ yes ☐ no

Date Last log was run _____

Was CO₂ encountered? ☐ yes ☒ no at what depths? _____

Was H₂S encountered? ☐ yes ☒ no at what depths? _____

Were unusual drilling circumstances encountered? ☐ yes ☒ no

If yes, briefly explain below _____

Other remarks: _____

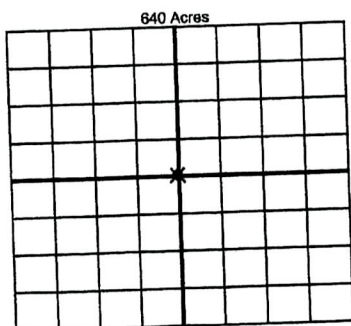

If more than three drainholes are proposed, attach a separate sheet indicating the necessary information.

Direction must be stated in degrees azimuth.
Please note, the horizontal drainhole and its end point must be located within the boundaries of the lease or spacing unit.

Directional surveys are required for all drainholes and directional wells

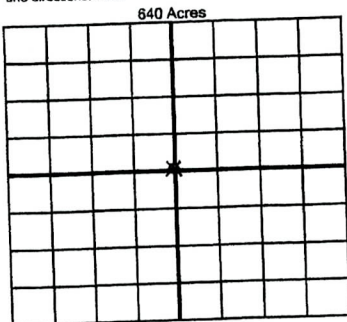

BOTTOM HOLE LOCATION FOR DIRECTIONAL HOLE

| SEC | TWP | RGE | COUNTY |
|----------------------|-----|---------------------|--------------------------------------------------------------------|
| 1/4 | 1/4 | 1/4 | 1/4 |
| Measured Total Depth | | True Vertical Depth | Feet From 1/4 Sec Lines BHL From Lease, Unit, or Property Line: |

BOTTOM HOLE LOCATION FOR HORIZONTAL HOLE: (LATERALS)

| LATERAL #1 | | | |
|----------------------|-----|---------------------|-----------------------------------------|
| SEC | TWP | RGE | COUNTY |
| 1/4 | 1/4 | 1/4 | 1/4 |
| Depth of Deviation | | Radius of Turn | Feet From 1/4 Sec Lines Total Length |
| Measured Total Depth | | True Vertical Depth | BHL From Lease, Unit, or Property Line: |

| LATERAL #2 | | | |
|----------------------|-----|---------------------|-----------------------------------------|
| SEC | TWP | RGE | COUNTY |
| 1/4 | 1/4 | 1/4 | 1/4 |
| Depth of Deviation | | Radius of Turn | Feet From 1/4 Sec Lines Total Length |
| Measured Total Depth | | True Vertical Depth | BHL From Lease, Unit, or Property Line: |

| LATERAL #3 | | | |
|----------------------|-----|---------------------|-----------------------------------------|
| SEC | TWP | RGE | COUNTY |
| 1/4 | 1/4 | 1/4 | 1/4 |
| Depth of Deviation | | Radius of Turn | Feet From 1/4 Sec Lines Total Length |
| Measured Total Depth | | True Vertical Depth | BHL From Lease, Unit, or Property Line: |