

Oklahoma Corporation Commission
Oil & Gas Conservation Division
Post Office Box 52000
Oklahoma City, Oklahoma 73152-2000
Rule 165: 10-3-25

Form 1002A

API No.: 35051219740002

Completion Report

Spud Date: April 06, 1988

OTC Prod. Unit No.: 051-019670-0-0000

Drilling Finished Date: May 27, 1988

1st Prod Date: July 07, 1988

Amended

Completion Date: July 07, 1988

Amend Reason: PLUG OFF OLD PERFORATIONS / ADD NEW PERFORATIONS SAME ZONE

Recomplete Date: August 01, 2019

Drill Type: STRAIGHT HOLE

Min Gas Allowable: Yes

Well Name: BRAY 3-25

Purchaser/Measurer: DCP OPERATING CO LP

Location: GRADY 25 4N 6W
C W2 SW SE
660 FSL 330 FWL of 1/4 SEC
Derrick Elevation: 1261 Ground Elevation: 1245

First Sales Date:

Operator: GULF EXPLORATION LLC 20983

9701 N BROADWAY EXT
OKLAHOMA CITY, OK 73114-6316

Completion Type	
X	Single Zone
	Multiple Zone
	Commingled

Location Exception
Order No
322980

Increased Density
Order No
There are no Increased Density records to display.

Casing and Cement							
Type	Size	Weight	Grade	Feet	PSI	SAX	Top of CMT
CONDUCTOR	16	43	A	41		4	
SURFACE	9.625	53	N-80	1220		300	SURFACE
PRODUCTION	5.50	17	N-80	8306		600	5600

Liner								
Type	Size	Weight	Grade	Length	PSI	SAX	Top Depth	Bottom Depth
There are no Liner records to display.								

Total Depth: 10015

Packer	
Depth	Brand & Type
6472	ARROW

Plug	
Depth	Plug Type
6740	CIBP

Initial Test Data

Test Date	Formation	Oil BBL/Day	Oil-Gravity (API)	Gas MCF/Day	Gas-Oil Ratio Cu FT/BBL	Water BBL/Day	Pumpin or Flowing	Initial Shut- In Pressure	Choke Size	Flow Tubing Pressure
Aug 28, 2019	MORROW-SPRINGER	21	40	219	10429	7	FLOWING	1250	44/64	45

Completion and Test Data by Producing Formation

Formation Name: MORROW-SPRINGERCode: 402MWSPRClass: OIL

Spacing Orders

Order No	Unit Size
126280	80

Perforated Intervals

From	To
6434	6606

Acid Volumes

2,000 GALLONS 7.5% NEFE

Fracture Treatments

38,750 POUNDS 20/40 SAND, 33,700 GALLONS GEL, 45 GALLONS 4% KCL

Formation	Top
HOXBAR	4500
MORROW-SPRINGER	6000

Were open hole logs run? Yes
Date last log run: May 24, 1988

Were unusual drilling circumstances encountered? No
Explanation:

Other Remarks
There are no Other Remarks.

FOR COMMISSION USE ONLY

Status: Accepted

1143823

October 28, 2019

2 of 2

API NO. 051 21974
OTC PROD. 051 091670
UNIT NO. - 0-0000

PLEASE TYPE OR USE BLACK INK ONLY
NOTE:

Attach copy of original 1002A
if recompletion or reentry.

OKLAHOMA CORPORATION COMMISSION
Oil & Gas Conservation Division
Post Office Box 52000
Oklahoma City, Oklahoma 73152-2000
Rule 165:10-3-25

RECEIVED
SEP 27 2019
OKLAHOMA CORPORATION
COMMISSION
Form 1002A
Rev. 2009

☒ ORIGINAL
☒ AMENDED (Reason)

TYPE OF DRILLING OPERATION

☒ STRAIGHT HOLE ☐ DIRECTIONAL HOLE ☐ HORIZONTAL HOLE
☐ SERVICE WELL

If directional or horizontal, see reverse for bottom hole location.

COUNTY GRADY SEC 25 TWP 4N RGE 6W
LEASE NAME BRAY
C 1/4 W2 1/4 SW 1/4 SE 1/4 FSL OF 1/4 SEC 660 FWL OF 1/4 SEC 330
ELEVATION Derrick FL 1261' Ground 1245' Latitude (if known)
OPERATOR NAME GULF EXPLORATION, L.L.C. OTC/OCC OPERATOR NO. 20983-0
ADDRESS 9701 N. Broadway Extension
CITY Oklahoma City STATE Oklahoma ZIP 73114

COMPLETION REPORT

SPUD DATE 4/6/1988
DRLG FINISHED DATE 5/27/1988
DATE OF WELL COMPLETION 7/7/1988
1st PROD DATE 7/7/1988
RECOMP DATE 8/1/2019
Longitude (if known)

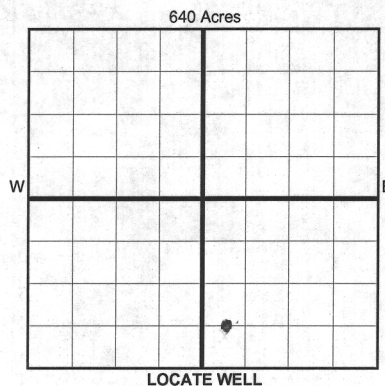

COMPLETION TYPE

☒ SINGLE ZONE
☐ MULTIPLE ZONE
Application Date
☐ COMMINGLED
Application Date
LOCATION 322980
EXCEPTION ORDER
INCREASED DENSITY
ORDER NO.

CASING & CEMENT (Form 1002C must be attached)

TYPE	SIZE	WEIGHT	GRADE	FEET	PSI	SAX	TOP OF CMT
CONDUCTOR	16"	43#	A	41'		4.5 yds	
SURFACE	9.625"	53#	N80	1220'		300	Surface
INTERMEDIATE							
PRODUCTION	5.50"	17#	N80	8306'		600	5600'
LINER							

PACKER @ 6,472 BRAND & TYPE Arrow PLUG @ TYPE PLUG @ 6740' TYPE CIBP TOTAL DEPTH 10015'
PACKER @ BRAND & TYPE PLUG @ TYPE PLUG @ TYPE

COMPLETION & TEST DATA BY PRODUCING FORMATION

402 MW 5 PR

FORMATION	Morrow-Springer								
SPACING & SPACING ORDER NUMBER	#126280 (80 ac)								
CLASS: Oil, Gas, Dry, Inj, Disp, Comm Disp, Svc	oil	per 60R							
PERFORATED INTERVALS	6434-40, 6516-20								
	6536-44,								
	6594-6606								
ACID/VOLUME	2000 Gal 7.5% NeFe								
FRACTURE TREATMENT (Fluids/Prop Amounts)	38750# 20/40 Sand								
	33700 Gal Gel								
	45 Gal 4% KCl								

Reported
To Frac Focus

☒ Min Gas Allowable (165:10-17-7)
OR
☐ Oil Allowable (165:10-13-3)

Gas Purchaser/Measurer
First Sales Date

DCP Operating Co, LP

INITIAL TEST DATA

INITIAL TEST DATE	8/28/2019								
OIL-BBL/DAY	21								
OIL-GRAVITY (API)	40 API								
GAS-MCF/DAY	219								
GAS-OIL RATIO CU FT/BBL	10429: 1								
WATER-BBL/DAY	7								
PUMPING OR FLOWING	FLOWING								
INITIAL SHUT-IN PRESSURE	1250								
CHOKE SIZE	44/64								
FLOW TUBING PRESSURE	45								

AS SUBMITTED

A record of the formations drilled through, and pertinent remarks are presented on the reverse. I declare that I have knowledge of the contents of this report and am authorized by my organization to make this report, which was prepared by me or under my supervision and direction, with the data and facts stated herein to be true, correct, and complete to the best of my knowledge and belief.

SIGNATURE JJ Simonsen 9/27/2019 405-840-3371
9701 N. Broadway Extension Oklahoma City OK 73114
ADDRESS CITY STATE ZIP jsimonsen@gulfexploration.com
EMAIL ADDRESS

PLEASE TYPE OR USE BLACK INK ONLY

FORMATION RECORD

Give formation names and tops, if available, or descriptions and thickness of formations drilled through. Show intervals cored or drillstem tested.

NAMES OF FORMATIONS	TOP
Hoxbar	4500'
Morrow-Springer	6000'
TD	10015'

LEASE NAME BRAY WELL NO. #3-25

FOR COMMISSION USE ONLY	
ITD on file <input type="checkbox"/> YES <input type="checkbox"/> NO	
APPROVED _____	DISAPPROVED _____
2) Reject Codes	

Were open hole logs run?	<input checked="" type="checkbox"/> yes <input type="checkbox"/> no
Date Last log was run	<u>5/24/1988</u>
Was CO ₂ encountered?	<input type="checkbox"/> yes <input checked="" type="checkbox"/> no at what depths? _____
Was H ₂ S encountered?	<input type="checkbox"/> yes <input checked="" type="checkbox"/> no at what depths? _____
Were unusual drilling circumstances encountered?	<input type="checkbox"/> yes <input checked="" type="checkbox"/> no
If yes, briefly explain below	

Other remarks:

640 Acres

If more than three drainholes are proposed, attach a separate sheet indicating the necessary information.

Direction must be stated in degrees azimuth. Please note, the horizontal drainhole and its end point must be located within the boundaries of the lease or spacing unit.

Directional surveys are required for all drainholes and directional wells.

640 Acres

BOTTOM HOLE LOCATION FOR DIRECTIONAL HOLE

SEC	TWP	RGE	COUNTY		
Spot Location			1/4	1/4	1/4
Measured Total Depth			True Vertical Depth		
			BHL From Lease, Unit, or Property Line:		

BOTTOM HOLE LOCATION FOR HORIZONTAL HOLE: (LATERALS)

LATERAL #1

SEC	TWP	RGE	COUNTY		
Spot Location			1/4	1/4	1/4
Depth of Deviation			Radius of Turn		Direction
Measured Total Depth			True Vertical Depth		Total Length
			BHL From Lease, Unit, or Property Line:		

LATERAL #2

SEC	TWP	RGE	COUNTY		
Spot Location			1/4	1/4	1/4
Depth of Deviation			Radius of Turn		Direction
Measured Total Depth			True Vertical Depth		Total Length
			BHL From Lease, Unit, or Property Line:		

LATERAL #3

SEC	TWP	RGE	COUNTY		
Spot Location			1/4	1/4	1/4
Depth of Deviation			Radius of Turn		Direction
Measured Total Depth			True Vertical Depth		Total Length
			BHL From Lease, Unit, or Property Line:		