

Oklahoma Corporation Commission
Oil & Gas Conservation Division
Post Office Box 52000
Oklahoma City, Oklahoma 73152-2000
Rule 165: 10-3-25

Form 1002A

API No.: 35109224570000

Completion Report

Spud Date: November 05, 2018

OTC Prod. Unit No.: 19113-0

Drilling Finished Date: November 16, 2018

1st Prod Date: February 18, 2019

Completion Date: December 11, 2018

Drill Type: DIRECTIONAL HOLE

Well Name: HOLMES 1

Purchaser/Measurer:

Location: OKLAHOMA 10 11N 3W
NW NW NE SE
2341 FSL 1419 FWL of 1/4 SEC
Derrick Elevation: 1240 Ground Elevation: 1225

First Sales Date:

Operator: WHITE OPERATING COMPANY 8891

1627 SW 96TH ST
OKLAHOMA CITY, OK 73159-7136

Completion Type		Location Exception		Increased Density	
X	Single Zone	Order No		Order No	
	Multiple Zone	There are no Location Exception records to display.		There are no Increased Density records to display.	
	Commingled				

Casing and Cement							
Type	Size	Weight	Grade	Feet	PSI	SAX	Top of CMT
SURFACE	8 5/8	24	J-55	1137		550	SURFACE
PRODUCTION	5 1/2	17	N-80	6844		1200	760

Liner								
Type	Size	Weight	Grade	Length	PSI	SAX	Top Depth	Bottom Depth
There are no Liner records to display.								

Total Depth: 6845

Packer		Plug	
Depth	Brand & Type	Depth	Plug Type
There are no Packer records to display.		There are no Plug records to display.	

Initial Test Data										
Test Date	Formation	Oil BBL/Day	Oil-Gravity (API)	Gas MCF/Day	Gas-Oil Ratio Cu FT/BBL	Water BBL/Day	Pumpin or Flowing	Initial Shut-In Pressure	Choke Size	Flow Tubing Pressure
Feb 20, 2019	WILCOX	13				1400	PUMPING			

Completion and Test Data by Producing Formation			
Formation Name: WILCOX		Code: 202WLCX	Class: OIL
Spacing Orders		Perforated Intervals	
Order No	Unit Size	From	To
681790	40	6344	6404
Acid Volumes		Fracture Treatments	
0		0	

Formation	Top
OSWEGO	6200
WILCOX	6340

Were open hole logs run? Yes
Date last log run: November 16, 2018

Were unusual drilling circumstances encountered? No
Explanation:

Other Remarks
OCC - IRREGULAR 40 ACRE UNIT - E/2 W/2 NW SE AND E/2 NW SE AND W/2 W/2 NE SE. THE DIRECTIONAL SURVEY ATTACHED ENDS AT 6,306'. THE ADDITIONAL SURVEY TO 6,845' IS ON OPEN HOLE LOG TRIPLE COMBO. FOR THAT PART OF SURVEY SEE OPEN HOLE LOGS. IT IS RUN BY SCHLUMBERGER.

Bottom Holes
Sec: 10 TWP: 11N RGE: 3W County: OKLAHOMA NE SE NW SE 1897 FSL 1194 FWL of 1/4 SEC Depth of Deviation: 0 Radius of Turn: 0 Direction: 0 Total Length: 0 Measured Total Depth: 6845 True Vertical Depth: 6786 End Pt. Location From Release, Unit or Property Line: 456

FOR COMMISSION USE ONLY	
Status: Accepted	1142159

original operator moved to 1419 because of surface issues

API NO.	109-22457
OTC PROD.	19113-0
UNIT NO.	

(PLEASE TYPE OR USE BLACK INK ONLY)

OKLAHOMA CORPORATION COMMISSION
Oil & Gas Conservation Division
Post Office Box 52000
Oklahoma City, Oklahoma 73152-2000
Rule 165:10-3-25

RECEIVED

FEB 21 2019

Oklahoma Corporation
Commission

Form 1002A
Rev. 2009

<input checked="" type="checkbox"/> ORIGINAL
<input type="checkbox"/> AMENDED (Reason) _____

COMPLETION REPORT

TYPE OF DRILLING OPERATION

<input type="checkbox"/> STRAIGHT HOLE	<input checked="" type="checkbox"/> DIRECTIONAL HOLE	<input type="checkbox"/> HORIZONTAL HOLE
<input type="checkbox"/> SERVICE WELL		

If directional or horizontal, see reverse for bottom hole location.

COUNTY	Oklahoma	SEC	10	TWP	11N	RGE	3W
LEASE NAME	Holmes			WELL NO.	1419		
NW 1/4 NW 1/4 NE 1/4 SE 1/4	FSL OF 1/4 SEC 2341			FWL OF 1/4 SEC	1482		
ELEVATION Derrick FL	1240	Ground	1225	Latitude (if known)	35°26'30.055"N		
OPERATOR NAME	White Operating Co.			OTC / OCC OPERATOR NO.	08891		
ADDRESS	1627 SW 96th Street						
CITY	Oklahoma City	STATE	OK	ZIP	73159		

SPUD DATE	11/05/18
DRG FINISHED DATE	11/16/18
DATE OF WELL COMPLETION	12/11/18
1st PROD DATE	02/18/19
RECOMP DATE	

640 Acres

LOCATE WELL

COMPLETION TYPE

<input checked="" type="checkbox"/> SINGLE ZONE	
<input type="checkbox"/> MULTIPLE ZONE	
<input type="checkbox"/> COMMINGLED	
<input type="checkbox"/> LOCATION EXCEPTION	
<input type="checkbox"/> ORDER NO.	
<input type="checkbox"/> INCREASED DENSITY	
<input type="checkbox"/> ORDER NO.	

CASING & CEMENT (Attach Form 1002C)

TYPE	SIZE	WEIGHT	GRADE	FEET	PSI	SAX	TOP OF CMT
CONDUCTOR							
SURFACE	8-5/8"	24	J55	1137		550	Surface
INTERMEDIATE							
PRODUCTION	5-1/2"	17	N80	6844		1200	760
LINER							

TOTAL DEPTH 6,845

PACKER @ _____ BRAND & TYPE _____	PLUG @ _____ TYPE _____	PLUG @ _____ TYPE _____
PACKER @ _____ BRAND & TYPE _____	PLUG @ _____ TYPE _____	PLUG @ _____ TYPE _____

COMPLETION & TEST DATA BY PRODUCING FORMATION

FORMATION	Wilcox					
SPACING & SPACING ORDER NUMBER	40A / 681790					
CLASS: Oil, Gas, Dry, Inj, Disp, Comm Disp, Svc	Oil					
	6344-6404					
PERFORATED INTERVALS						
ACID/VOLUME	0					
FRACTURE TREATMENT (Fluids/Prop Amounts)	0					

Min Gas Allowable (165:10-17-7)

Gas Purchaser/Measurer

OR

First Sales Date

Oil Allowable (165:10-13-3)

INITIAL TEST DATA

INITIAL TEST DATE	2/20/2019				
OIL-BBL/DAY	13				
OIL-GRAVITY (API)					
GAS-MCF/DAY	0				
GAS-OIL RATIO CU FT/BBL					
WATER-BBL/DAY	1400				
PUMPING OR FLOWING	Pump				
INITIAL SHUT-IN PRESSURE	0				
CHOKE SIZE					
FLOW TUBING PRESSURE					

AS SUBMITTED

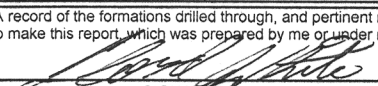
A record of the formations drilled through, and pertinent remarks are presented on the reverse. I declare that I have knowledge of the contents of this report and am authorized by my organization to make this report which was prepared by me or under my supervision and direction, with the data and facts stated herein to be true, correct, and complete to the best of my knowledge and belief.	
	Lloyd White
SIGNATURE	NAME (PRINT OR TYPE)
1627 SW 96th Street	Oklahoma City OK 73159
ADDRESS	CITY STATE ZIP
	2/20/2019 (405) 239-6001
	DATE PHONE NUMBER
	lrw@wocokc.com
	EMAIL ADDRESS

PLEASE TYPE OR USE BLACK INK ONLY
FORMATION RECORD

Give formation names and tops, if available, or descriptions and thickness of formations drilled through. Show intervals cored or drillstem tested.

NAMES OF FORMATIONS	TOP
Oswego	6200
Wilcox	6340

LEASE NAME Holmes

WELL NO. 1

FOR COMMISSION USE ONLY	
ITD on file <input type="checkbox"/> YES <input type="checkbox"/> NO	
APPROVED _____	DISAPPROVED _____
2) Reject Codes	

Were open hole logs run?	<input checked="" type="checkbox"/> yes <input type="checkbox"/> no
Date Last log was run	<u>11/16/2018</u>
Was CO ₂ encountered?	<input type="checkbox"/> yes <input checked="" type="checkbox"/> no at what depths? _____
Was H ₂ S encountered?	<input type="checkbox"/> yes <input checked="" type="checkbox"/> no at what depths? _____
Were unusual drilling circumstances encountered?	<input type="checkbox"/> yes <input checked="" type="checkbox"/> no
If yes, briefly explain below	

Other remarks: DCC - Irregular 40 acre unit E $\frac{1}{2}$ W $\frac{1}{2}$ NWSE + E $\frac{1}{2}$ NWSE + W $\frac{1}{2}$ W $\frac{1}{2}$ NESE
DCC - The directional Survey attached ends at 6306' the additional survey
to 6845 is on open hole log Triple Combo for that part of survey see
open hole logs it is run by Schlumberger

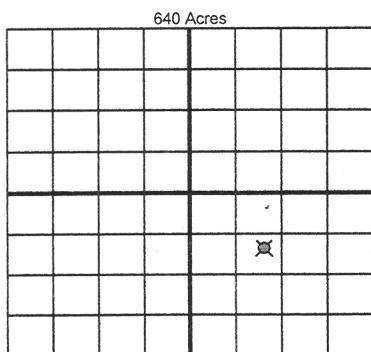

If more than three drainholes are proposed, attach a separate sheet indicating the necessary information.

Direction must be stated in degrees azimuth.
Please note, the horizontal drainhole and its end point must be located within the boundaries of the lease or spacing unit.

Directional surveys are required for all drainholes and directional wells.

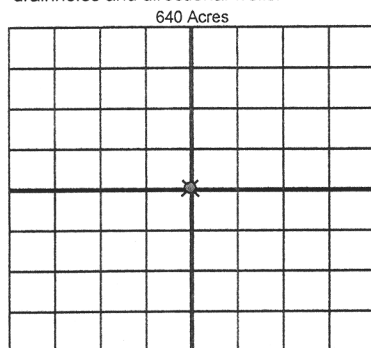

BOTTOM HOLE LOCATION FOR DIRECTIONAL HOLE

SEC 10	TWP 11N	RGE 3W	COUNTY Oklahoma
Spot Location NE 1/4	SE 1/4	NW 1/4	SE 1/4
Measured Total Depth <u>6845</u>	True Vertical Depth <u>6306</u>	BHL From Lease, Unit, or Property Line: <u>723' FNL, 456' FEL</u>	

see Schlumberger open hole log

BOTTOM HOLE LOCATION FOR HORIZONTAL HOLE: (LATERALS)

LATERAL #1			
SEC	TWP	RGE	COUNTY
Spot Location 1/4	1/4	1/4	1/4
Depth of Deviation	Radius of Turn	Direction	Total Length
Measured Total Depth	True Vertical Depth	BHL From Lease, Unit, or Property Line:	

LATERAL #2			
SEC	TWP	RGE	COUNTY
Spot Location 1/4	1/4	1/4	1/4
Depth of Deviation	Radius of Turn	Direction	Total Length
Measured Total Depth	True Vertical Depth	BHL From Lease, Unit, or Property Line:	

LATERAL #3			
SEC	TWP	RGE	COUNTY
Spot Location 1/4	1/4	1/4	1/4
Depth of Deviation	Radius of Turn	Direction	Total Length
Measured Total Depth	True Vertical Depth	BHL From Lease, Unit, or Property Line:	