

Oklahoma Corporation Commission
Oil & Gas Conservation Division
Post Office Box 52000
Oklahoma City, Oklahoma 73152-2000
Rule 165: 10-3-25

Form 1002A

API No.: 35019216140001

Completion Report

Spud Date: June 25, 1976

OTC Prod. Unit No.: 019-06407

Drilling Finished Date: July 09, 1976

Amended

1st Prod Date: July 22, 1976

Amend Reason: RECOMPLETE (ADDED PERFORATIONS) / CHANGE WELL NUMBER

Completion Date: July 22, 1976

Recomplete Date: December 13, 2021

Drill Type: STRAIGHT HOLE

Min Gas Allowable: Yes

Well Name: HEWITT UNIT 22-2003

Purchaser/Measurer:

Location: CARTER 22 4S 2W
NE NW SW NE
1040 FSL 450 FWL of 1/4 SEC
Latitude: 34.19786 Longitude: -97.39463
Derrick Elevation: 840 Ground Elevation: 836

First Sales Date:

Operator: XTO ENERGY INC 21003

22777 SPRINGWOODS VILLAGE PARKWAY
SPRING, TX 77389-1425

Completion Type		Location Exception		Increased Density	
X	Single Zone	Order No		Order No	
	Multiple Zone	There are no Location Exception records to display.		There are no Increased Density records to display.	
	Commingled				

Casing and Cement							
Type	Size	Weight	Grade	Feet	PSI	SAX	Top of CMT
SURFACE	10 3/4	40.5	A	393		225	SURFACE
PRODUCTION	7	20 / 23	J-55	2512		750	820

Liner								
Type	Size	Weight	Grade	Length	PSI	SAX	Top Depth	Bottom Depth
There are no Liner records to display.								

Total Depth: 2530

Packer		Plug	
Depth	Brand & Type	Depth	Plug Type
There are no Packer records to display.		1890	CIBP

Initial Test Data

Test Date	Formation	Oil BBL/Day	Oil-Gravity (API)	Gas MCF/Day	Gas-Oil Ratio Cu FT/BBL	Water BBL/Day	Pumpin or Flowing	Initial Shut-In Pressure	Choke Size	Flow Tubing Pressure
Dec 14, 2021	HEWITT	192	35			172	PUMPING			

Completion and Test Data by Producing Formation

Formation Name: HEWITT		Code: 405HWTT		Class: OIL	
Spacing Orders		Perforated Intervals			
Order No	Unit Size	From	To		
67990	UNIT	1014	1084		
		1141	1196		
		1235	1254		
		1414	1502		
		1546	1578		
		1792	1820		
Acid Volumes		Fracture Treatments			
12,500 GALLONS 15% HCL		5,195 BARRELS X-LINK, 241,800 POUNDS 12/20 AND 16/30 SAND			

Formation Name: HEWITT		Code: 405HWTT		Class: OIL	
Spacing Orders		Perforated Intervals			
Order No	Unit Size	From	To		
67990	UNIT	1292	2453		
Acid Volumes		Fracture Treatments			
There are no Acid Volume records to display.		There are no Fracture Treatments records to display.			

Formation	Top
BAYOU LOWER	1014
STEARNS /OKLA/	1235
CHUBBEE	1292

Were open hole logs run? Yes
Date last log run: September 04, 1976

Were unusual drilling circumstances encountered? No
Explanation:

Other Remarks
SHOT SQUEEZE HOLES @ 970'. SQUEEZED WITH 285 SACKS CLASS C CEMENT. RAN RCBL. RAISED CEMENT TO 820'. ADDITIONAL CEMENT FOUND FROM 300' - 460'. ADDED PERFORATIONS 1,014' - 1,084', 1,141' - 1,196', 1,235' - 1,254', 1,414' - 1,460', 1,460' - 1,502', 1,546' - 1,578', 1,792' - 1,820' (2SPF). SET CIBP @ 1,890'. ADDED 2 SACKS CEMENT ON TOP OF PLUG. SQUEEZED OFF CHUBBEE (1,292' - 1,296' AND 1,300' - 1,332'). 45 SACKS CLASS C CEMENT. OCC - ORIGINAL PERFORATIONS FROM 1292' TO 2453'.

Status: Accepted

API NO. 35-019-21614
OTC PROD. UNIT NO. 019-06407

Oil and Gas Conservation Division
P.O. Box 52000
Oklahoma City, OK 73152-2000
405-522-0577
OCCCentralProcessing@OCC.OK.GOV

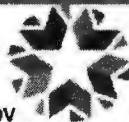

OKLAHOMA
Corporation
Commission

Form 1002A
Rev. 2020

ORIGINAL
☒ AMENDED (Reason) Change Well number Rule 165:10-3-25
Recomplete - Added Perfs

TYPE OF DRILLING OPERATION

☒ STRAIGHT HOLE ☐ DIRECTIONAL HOLE ☐ HORIZONTAL HOLE
☐ SERVICE WELL

If directional or horizontal, see reverse for bottom hole location.

COUNTY	Carter	SEC	22	TWP	4S	RGE	2W	SPUD DATE	6/25/1976
LEASE NAME	Hewitt Unit	WELL NO.	22-8892	DRLG FINISHED DATE	7/9/1976	DATE OF WELL COMPLETION	7/22/1976	1st PROD DATE	7/22/1976
NE 1/4 NW 1/4 SW 1/4 NE 1/4	FSL	1040	FWL	405	RECOMP DATE	12/13/2021			
ELEVATION Derrick FL	840	Ground	836	Latitude	34.19786	Longitude	-97.39463		
OPERATOR NAME	XTO Energy Inc				OTC / OCC OPERATOR NO.	21003			
ADDRESS	210 Park Ave, Suite 2350								
CITY	Oklahoma City	STATE	OK	ZIP	73102				

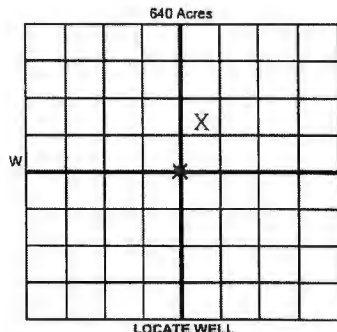

COMPLETION TYPE

<input checked="" type="checkbox"/> SINGLE ZONE	
<input type="checkbox"/> MULTIPLE ZONE	
Application Date	
<input type="checkbox"/> COMINGLED	
Application Date	
LOCATION EXCEPTION ORDER NO.	
MULTIUNIT ORDER NO.	
INCREASED DENSITY ORDER NO.	

CASING & CEMENT (Attach Form 1002C)

TYPE	SIZE	WEIGHT	GRADE	FEET	PSI	SAX	TOP OF CMT
CONDUCTOR							
SURFACE	10 3/4"	40.5#	A	393'		225	Surface
INTERMEDIATE							
PRODUCTION	7"	20#, 23#	J-55	2512'		750	820'
LINER							

PACKER @ _____ BRAND & TYPE _____ PLUG @ _____ TYPE _____ CIP PLUG @ _____ TYPE _____ TOTAL DEPTH 2530'
PACKER @ _____ BRAND & TYPE _____ PLUG @ _____ TYPE _____ PLUG @ _____ TYPE _____

COMPLETION & TEST DATA BY PRODUCING FORMATION

FORMATION	Hewitt Sands	Hewitt Sands				
SPACING & SPACING ORDER NUMBER	67990 (Unit)	67990 (Unit)				
CLASS: Oil, Gas, Dry, Inj, Disp, Comm Disp, Svc	Oil	Oil				
PERFORATED INTERVALS	1014' - 1084'; 1141' - 1196'	1292' - 2453'				
	1235' - 1254'; 1414' - 1502'	(original perfs)				
	1546' - 1578'; 1792' - 1820'					
ACID/VOLUME	12,500 gal 15% HCl					
FRACTURE TREATMENT (Fluids/Prop Amounts)	5195 bbls X-Link & 241.8k# 12/20 & 16/30 Snd					



Min Gas Allowable (165:10-17-7)

OR

Oil Allowable (165:10-13-3)

Purchaser/Measurer

First Sales Date

INITIAL TEST DATA

INITIAL TEST DATE	12/14/21	7-22-76			
OIL-BBL/DAY	192	399			
OIL-GRAVITY (API)	35	35.3			
GAS-MCF/DAY					
GAS-OIL RATIO CU FT/BBL	0	0			
WATER-BBL/DAY	172	2058			
PUMPING OR FLOWING	Pumping	Pumping			
INITIAL SHUT-IN PRESSURE					
CHOKE SIZE					
FLOW TUBING PRESSURE					

A record of the formations drilled through, and pertinent remarks are presented on the reverse. I declare that I have knowledge of the contents of this report and am authorized by my organization to make this report, which was prepared by me or under my supervision and direction, with the data and facts stated herein to be true, correct, and complete to the best of my knowledge and belief.

SIGNATURE	NAME (PRINT OR TYPE)	DATE	PHONE NUMBER
210 Park Ave, Suite 2350	Oklahoma City OK 73102	2/16/22	405-594-9453
ADDRESS	CITY STATE ZIP	EMAIL ADDRESS	

PLEASE TYPE OR USE BLACK INK ONLY
FORMATION RECORD

Give formation names and tops, if available, or descriptions and thickness of formations drilled through. Show intervals cored or drillstem tested.

NAMES OF FORMATIONS	TOP
Lower Bayou	1014
Stearns	1235
Chubbee	1292
2C	1627
3A	1914
3C	1998
3D	2137
3E	2200
4A	2351
4B	2421

LEASE NAME _____ Hwell Unit _____ WELL NO. 22-2003

FOR COMMISSION USE ONLY	
ITD on file <input type="checkbox"/> YES <input type="checkbox"/> NO	
APPROVED _____	DISAPPROVED _____
2) Reject Codes _____	

Were open hole logs run?	<input checked="" type="radio"/> yes <input type="radio"/> no
Date last log was run	07/04/78
Was CO ₂ encountered?	<input type="radio"/> yes <input type="radio"/> no at what depths? _____
Was H ₂ S encountered?	<input type="radio"/> yes <input type="radio"/> no at what depths? _____
Were unusual drilling circumstances encountered?	<input type="radio"/> yes <input type="radio"/> no
If yes, briefly explain below _____	

Other remarks: Shot sqz holes @ 970'. Sqz'd w/ 285 sx class C cmt. Ran RCBL. Raised cmt to 820'. Additional cmt found from 300'-460'.
Added perfs 1014'-1084', 1141'-1196', 1235'-1254', 1414'-1460', 1460'-1502', 1546'-1578', 1792'-1820'. (2SPF)
Set CIBP @ 1890'. Added 2 sx cmt on top of plug
Sqz'd off Chubbee (1292' - 1296' & 1300'-1332'). 45 sx Class C cmt

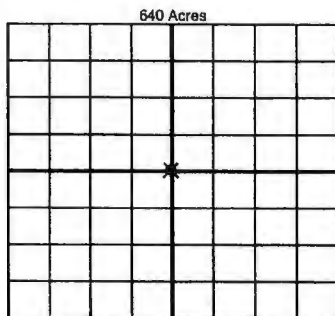

If more than three drainholes are proposed, attach a separate sheet indicating the necessary information.

Direction must be stated in degrees azimuth.
Please note, the horizontal drainhole and its end point must be located within the boundaries of the lease or spacing unit.

Directional surveys are required for all drainholes and directional wells

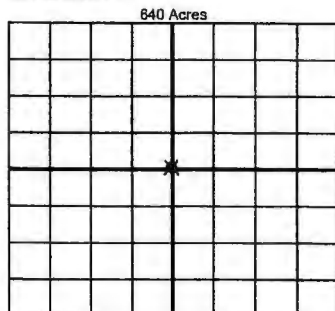

BOTTOM HOLE LOCATION FOR DIRECTIONAL HOLE

SEC	TWP	RGE	COUNTY
1/4	1/4	1/4	1/4
Measured Total Depth		True Vertical Depth	Feet From 1/4 Sec Lines _____ BHL From Lease, Unit, or Property Line: _____

BOTTOM HOLE LOCATION FOR HORIZONTAL HOLE: (LATERALS)

LATERAL #1			
SEC	TWP	RGE	COUNTY
1/4	1/4	1/4	1/4
Depth of Deviation	Radius of Turn	Direction	Total Length
Measured Total Depth	True Vertical Depth	BHL From Lease, Unit, or Property Line: _____	

LATERAL #2			
SEC	TWP	RGE	COUNTY
1/4	1/4	1/4	1/4
Depth of Deviation	Radius of Turn	Direction	Total Length
Measured Total Depth	True Vertical Depth	BHL From Lease, Unit, or Property Line: _____	

LATERAL #3			
SEC	TWP	RGE	COUNTY
1/4	1/4	1/4	1/4
Depth of Deviation	Radius of Turn	Direction	Total Length
Measured Total Depth	True Vertical Depth	BHL From Lease, Unit, or Property Line: _____	