

Oklahoma Corporation Commission
Oil & Gas Conservation Division
Post Office Box 52000
Oklahoma City, Oklahoma 73152-2000
Rule 165: 10-3-25

Form 1002A

API No.: 35019204110001

Completion Report

Spud Date: October 01, 1968

OTC Prod. Unit No.: 019-06407

Drilling Finished Date: October 04, 1968

1st Prod Date: October 12, 1968

Amended

Completion Date: November 07, 1968

Amend Reason: RECOMPLETE (ADDED PERFORATIONS)

Recomplete Date: December 02, 2021

Drill Type: STRAIGHT HOLE

Min Gas Allowable: Yes

Well Name: HEWITT UNIT 22-3601

Purchaser/Measurer:

Location: CARTER 22 4S 2W
C NW NW SE
2310 FSL 330 FWL of 1/4 SEC
Latitude: 34.19352 Longitude: -97.39471
Derrick Elevation: 865 Ground Elevation: 859

First Sales Date:

Operator: XTO ENERGY INC 21003

22777 SPRINGWOODS VILLAGE PARKWAY
SPRING, TX 77389-1425

Completion Type		Location Exception		Increased Density	
X	Single Zone	Order No		Order No	
	Multiple Zone	There are no Location Exception records to display.		There are no Increased Density records to display.	
	Commingled				

Casing and Cement							
Type	Size	Weight	Grade	Feet	PSI	SAX	Top of CMT
PRODUCTION	7	20 / 23	J-55	2407		650	SURFACE

Liner								
Type	Size	Weight	Grade	Length	PSI	SAX	Top Depth	Bottom Depth
There are no Liner records to display.								

Total Depth: 2407

Packer	
Depth	Brand & Type
There are no Packer records to display.	

Plug	
Depth	Plug Type
There are no Plug records to display.	

Initial Test Data										
Test Date	Formation	Oil BBL/Day	Oil-Gravity (API)	Gas MCF/Day	Gas-Oil Ratio Cu FT/BBL	Water BBL/Day	Pumpin or Flowing	Initial Shut-In Pressure	Choke Size	Flow Tubing Pressure
Dec 29, 2021	HEWITT	83	35			812	PUMPING			

Completion and Test Data by Producing Formation

Formation Name: HEWITT

Code: 405HWTT

Class: OIL

Spacing Orders

Order No	Unit Size
67990	UNIT

Perforated Intervals

From	To
1230	1357
1454	1491

Acid Volumes

5,000 GALLONS 15% HCL

Fracture Treatments

2,821 BARRELS X-LINK, 138,300 POUNDS 12/20 AND 16/30 SAND

Formation Name: HEWITT

Code: 405HWTT

Class: OIL

Spacing Orders

Order No	Unit Size
67990	UNIT

Perforated Intervals

From	To
1050	2368

Acid Volumes

There are no Acid Volume records to display.

Fracture Treatments

There are no Fracture Treatments records to display.

Formation	Top
BAYOU UPPER	1050
BAYOU LOWER	1230
STEARNS /OKLA/	1454
CHUBBEE	1522

Were open hole logs run? Yes

Date last log run: October 04, 1968

Were unusual drilling circumstances encountered? No

Explanation:

Other Remarks

ADDED PERFORATIONS: 1,230' - 1,357'; 1,454' - 1,491'. SQUEEZED OFF CHUBBEE WITH 75 SACKS CLASS C CEMENT
OCC - THE ORIGINAL PERFORATIONS WERE FROM 1050' TO 2368'.

FOR COMMISSION USE ONLY

1147594

Status: Accepted

API NO. 35-019-20411
OTC PROD. UNIT NO. 019-06407

Oil and Gas Conservation Division
P.O. Box 52000
Oklahoma City, OK 73152-2000
405-522-0577
OCCCentralProcessing@OCC.OK.GOV



Form 1002A
Rev. 2020

ORIGINAL
AMENDED (Reason) _____
Recomplete - Added Perls

Rule 165:10-3-25

COMPLETION REPORT

TYPE OF DRILLING OPERATION

☒ STRAIGHT HOLE ☐ DIRECTIONAL HOLE ☐ HORIZONTAL HOLE
☐ SERVICE WELL

If directional or horizontal, see reverse for bottom hole location.

COUNTY	Carter	SEC	22	TWP	4S	RGE	2W	
LEASE NAME	Hewitt Unit			WELL NO.	22-3601			
1/4 NW 1/4 NW 1/4 SE 1/4 FSL	2310			FWL	330			
ELEVATION	865	Ground	859	Latitude	34.19352		Longitude	-97.39471
OPERATOR NAME	XTO Energy Inc			OTC / OCC OPERATOR NO.	21003			
ADDRESS	210 Park Ave, Suite 2350							
CITY	Oklahoma City	STATE	OK	ZIP	73102			

SPUD DATE 10/1/1968

DRLG FINISHED DATE 10/4/1968

DATE OF WELL COMPLETION 11/7/1968

1st PROD DATE 10/12/1968

RECOMP DATE 12/02/2021

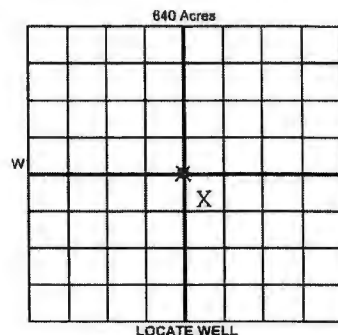

COMPLETION TYPE

<input checked="" type="radio"/> SINGLE ZONE	
<input type="radio"/> MULTIPLE ZONE	
Application Date	
<input type="radio"/> COMMINGLED	
Application Date	
LOCATION EXCEPTION ORDER NO.	
MULTIUNIT ORDER NO.	
INCREASED DENSITY ORDER NO.	

CASING & CEMENT (Attach Form 1002C)

TYPE	SIZE	WEIGHT	GRADE	FEET	PSI	SAX	TOP OF CMT
CONDUCTOR							
SURFACE							
INTERMEDIATE							
PRODUCTION	7"	20#, 23#	J-55	2407'		650	Surface
LINER							

PACKER @ _____ BRAND & TYPE _____ PLUG @ _____ TYPE _____ PLUG @ _____ TYPE _____ TOTAL DEPTH 2407'

COMPLETION & TEST DATA BY PRODUCING FORMATION 405 HWTT

FORMATION	Hewitt Sands	Hewitt Sands			Reported to Frac Foods
SPACING & SPACING ORDER NUMBER	67990 (Unit)	67990 (Unit)			
CLASS: Oil, Gas, Dry, Inj, Disp, Comm Disp, Svc	Oil	Oil			
PERFORATED INTERVALS	1230' - 1357'	1050' - 2368'			
	1454' - 1491'	(original perfs)			
	(New perfs)				
ACID/VOLUME	5k gal 15% HCL				
FRACTURE TREATMENT (Fluids/Prop Amounts)	2821 bbls X-Link & 138.3k# 12/20 & 16/30 Snd				



Min Gas Allowable (165:10-17-7)

OR

Oil Allowable (165:10-13-3)

Purchaser/Measurer

First Sales Date

INITIAL TEST DATA

INITIAL TEST DATE	12/29/21	11/7/68			
OIL-BBL/DAY	83	8			
OIL-GRAVITY (API)	35	31.2			
GAS-MCF/DAY					
GAS-OIL RATIO CU FT/BBL	0	0			
WATER-BBL/DAY	812	0			
PUMPING OR FLOWING	Pumping	Pumping			
INITIAL SHUT-IN PRESSURE					
CHOKE SIZE					
FLOW TUBING PRESSURE					

A record of the formations drilled through, and pertinent remarks are presented on the reverse. I declare that I have knowledge of the contents of this report and am authorized by my organization to make this report, which was prepared by me or under my supervision and direction, with the data and facts stated herein to be true, correct, and complete to the best of my knowledge and belief.

SIGNATURE	NAME (PRINT OR TYPE)	DATE	PHONE NUMBER
210 Park Ave, Suite 2350	Oklahoma City OK 73102	2/16/22	405-594-9453
ADDRESS	CITY STATE ZIP	EMAIL ADDRESS	

PLEASE TYPE OR USE BLACK INK ONLY
FORMATION RECORD

Give formation names and tops, if available, or descriptions and thickness of formations drilled through. Show intervals cored or drilitem tested.

NAMES OF FORMATIONS	TOP
Upper Bayou	1050
Lower Bayou	1230
Stearns	1454
Chubbee	1522
1B	1640
1C	1724
2A	1774
2C	1844
3A	2131
3C	2235

LEASE NAME _____ HOURS UNIT _____ WELL NO. 22-3801

FOR COMMISSION USE ONLY	
ITD on file <input type="checkbox"/> YES <input type="checkbox"/> NO	
APPROVED _____ DISAPPROVED _____	2) Reject Codes _____

Were open hole logs run? <input checked="" type="radio"/> yes <input type="radio"/> no	
Date Last log was run _____ 10/04/66	
Was CO ₂ encountered? <input type="radio"/> yes <input type="radio"/> no at what depths? _____	
Was H ₂ S encountered? <input type="radio"/> yes <input type="radio"/> no at what depths? _____	
Were unusual drilling circumstances encountered? <input type="radio"/> yes <input type="radio"/> no	
If yes, briefly explain below _____	

Other remarks: Added perfs; 1230'-1357', 1454'-1491'.

Sqz'd off Chubbee w/ 75 sx Class C cmt.

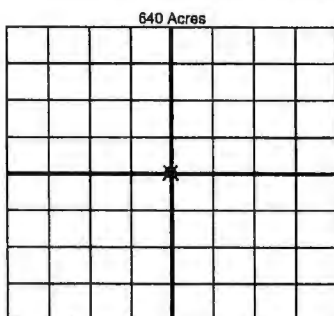

If more than three drainholes are proposed, attach a separate sheet indicating the necessary information.

Direction must be stated in degrees azimuth. Please note, the horizontal drainhole and its end point must be located within the boundaries of the lease or spacing unit.

Directional surveys are required for all drainholes and directional wells

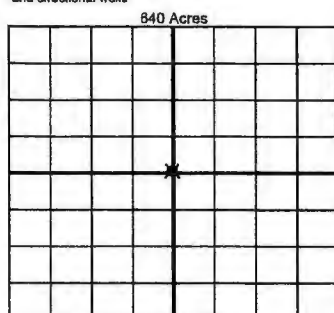

BOTTOM HOLE LOCATION FOR DIRECTIONAL HOLE

SEC	TWP	RGE	COUNTY
1/4	1/4	1/4	1/4
Feet From 1/4 Sec Lines _____			
Measured Total Depth _____		True Vertical Depth _____	
BHL From Lease, Unit, or Property Line: _____			

BOTTOM HOLE LOCATION FOR HORIZONTAL HOLE: (LATERALS)

LATERAL #1			
SEC	TWP	RGE	COUNTY
1/4	1/4	1/4	1/4
Feet From 1/4 Sec Lines _____			
Depth of Deviation _____		Radius of Turn _____	
Measured Total Depth _____		True Vertical Depth _____	
Direction _____		Total Length _____	
BHL From Lease, Unit, or Property Line: _____			

LATERAL #2			
SEC	TWP	RGE	COUNTY
1/4	1/4	1/4	1/4
Feet From 1/4 Sec Lines _____			
Depth of Deviation _____		Radius of Turn _____	
Measured Total Depth _____		True Vertical Depth _____	
Direction _____		Total Length _____	
BHL From Lease, Unit, or Property Line: _____			

LATERAL #3			
SEC	TWP	RGE	COUNTY
1/4	1/4	1/4	1/4
Feet From 1/4 Sec Lines _____			
Depth of Deviation _____		Radius of Turn _____	
Measured Total Depth _____		True Vertical Depth _____	
Direction _____		Total Length _____	
BHL From Lease, Unit, or Property Line: _____			