

Oklahoma Corporation Commission  
Oil & Gas Conservation Division  
Post Office Box 52000  
Oklahoma City, Oklahoma 73152-2000  
Rule 165: 10-3-25

Form 1002A

API No.: 35007249310002

**Completion Report**

Spud Date: August 26, 2003

OTC Prod. Unit No.: 007-019868-0-0000

Drilling Finished Date: September 12, 2003

**Amended**

1st Prod Date: November 11, 2003

Amend Reason: RECOMPLETE AND COMMINGLED

Completion Date: September 23, 2003

Recomplete Date: January 17, 2022

**Drill Type: STRAIGHT HOLE**

Min Gas Allowable: Yes

Well Name: HODGES 11-1

Purchaser/Measurer: DCP MIDSTREAM

Location: BEAVER 1 5N 24E CM  
S2 N2 NE SE  
2160 FSL 660 FEL of 1/4 SEC  
Latitude: 36.927208 Longitude: -100.4062093  
Derrick Elevation: 2580 Ground Elevation: 2569

First Sales Date: 11/11/2003

Operator: LATIGO OIL AND GAS INC 10027  
PO BOX 1208  
5815 OKLAHOMA AVE  
WOODWARD, OK 73802-1208

Completion Type		Location Exception		Increased Density			
	Single Zone	Order No		Order No			
	Multiple Zone	482610		482611			
X	Commingled	718724		718724			

Casing and Cement							
Type	Size	Weight	Grade	Feet	PSI	SAX	Top of CMT
SURFACE	8 5/8	24 / 32	J-55 ST&C	1507		725	SURFACE
PRODUCTION	5 1/2	17 / 15.5	MAV 80 / J-55 I	8291		505	7200 / 5400

Liner								
Type	Size	Weight	Grade	Length	PSI	SAX	Top Depth	Bottom Depth
There are no Liner records to display.								

**Total Depth: 8291**

Packer	
Depth	Brand & Type
There are no Packer records to display.	

Plug	
Depth	Plug Type
6560	BP
7510	CIBP
7700	CIBP

Initial Test Data
-------------------

Test Date	Formation	Oil BBL/Day	Oil-Gravity (API)	Gas MCF/Day	Gas-Oil Ratio Cu FT/BBL	Water BBL/Day	Pumpin or Flowing	Initial Shut-In Pressure	Choke Size	Flow Tubing Pressure
Jan 31, 2022	COMMINGLED			58			FLOWING	150		55

#### Completion and Test Data by Producing Formation

Formation Name: MORROW SAND

Code: 402MWSD

Class: GAS

##### Spacing Orders

Order No	Unit Size
29573	640

##### Perforated Intervals

From	To
6094	6104
6117	6120
6123	6126

##### Acid Volumes

2,000 GALLONS 10%
-------------------

##### Fracture Treatments

34,143 GALLONS X-LINK, 40,000 POUNDS 20/40 SAND
---

Formation Name: CHESTER LIME

Code: 354CRLM

Class: GAS

##### Spacing Orders

Order No	Unit Size
29958	640

##### Perforated Intervals

From	To
6224	6234
6276	6282

##### Acid Volumes

There are no Acid Volume records to display.
--

##### Fracture Treatments

PAD ACID STAGES WITH 24Q N2 WITH 1,134 BARRELS
--

Formation Name: ST GENEVIEVE

Code: 353STGV

Class: GAS

##### Spacing Orders

Order No	Unit Size
74429	640

##### Perforated Intervals

From	To
6490	6500

##### Acid Volumes

There are no Acid Volume records to display.
--

##### Fracture Treatments

There are no Fracture Treatments records to display.
--

Formation	Top
MORROW SAND	6094
CHESTER LIME	6224
ST. GENEVIEVE	6490

Were open hole logs run? Yes

Date last log run: June 23, 2003

Were unusual drilling circumstances encountered? No

Explanation:

#### Other Remarks

There are no Other Remarks.

**FOR COMMISSION USE ONLY**

1147590

Status: Accepted

API NO. 35-00724931  
OTC PROD. UNIT NO. 007-019868

Oil and Gas Conservation Division  
P.O. Box 52000  
Oklahoma City, OK 73152-2000  
405-522-0577  
OCCCentralProcessing@OCC.OK.GOV



OKLAHOMA  
Corporation  
Commission

Form 1002A  
Rev. 2020

ORIGINAL  
AMENDED (Reason)

Recomplete and Commingle

Rule 165:10-3-25

COMPLETION REPORT

TYPE OF DRILLING OPERATION

☒ STRAIGHT HOLE ☐ DIRECTIONAL HOLE ☐ HORIZONTAL HOLE  
☐ SERVICE WELL

If directional or horizontal, see reverse for bottom hole location.

COUNTY	Beaver	SEC	1	TWP	5N	RGE	24ECM	SPUD DATE	8/26/2003
LEASE NAME	Hodges	WELL NO.	11-1	DRLG FINISHED DATE	9/12/2003	DATE OF WELL COMPLETION	9/23/2003	1st PROD DATE	11/11/2003
S/2 1/4 N/2 1/4 NE 1/4 SE 1/4	FSL	2160	FEL	660	RECOMP DATE	1/17/2022			
ELEVATION	Derrick FL	2580'	Ground	2569'	Latitude	Longitude			
OPERATOR NAME	Latigo Oil & Gas, Inc.				OTC / OCC OPERATOR NO.	10027			
ADDRESS	P.O. Box 1208								
CITY	Woodward	STATE	OK	ZIP	73802				

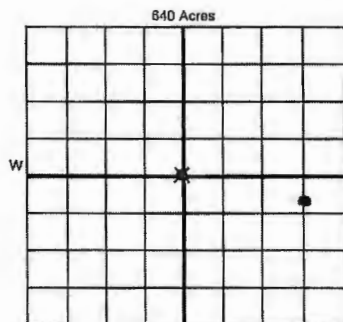

COMPLETION TYPE

<input type="radio"/> SINGLE ZONE	
<input type="radio"/> MULTIPLE ZONE	
<input checked="" type="radio"/> COMMINGLED	11/23/2021
LOCATION EXCEPTION ORDER NO.	482610 & 718724
MULTIUNIT ORDER NO.	
INCREASED DENSITY ORDER NO.	482611 & 718724

CASING & CEMENT (Attach Form 1002C)

TYPE	SIZE	WEIGHT	GRADE	FEET	PSI	SAX	TOP OF CMT
CONDUCTOR							
SURFACE	8-5/8"	24# 32#	J-55 ST&C	1507'		725	Surface
INTERMEDIATE							
PRODUCTION	5-1/2"	17# 15.5#	MAW-40 J55 L	8291'		225 & 280	7200' & 5400'
LINER							

PACKER @ BRAND & TYPE PLUG @ 6560 TYPE BP PLUG @ 7512 TYPE CIBP  
PACKER @ BRAND & TYPE PLUG @ TYPE PLUG @ 7120 TYPE CIBP  
TOTAL DEPTH 8291'

COMPLETION & TEST DATA BY PRODUCING FORMATION

402 MWSD 354 CRUM 358 STGV

FORMATION	Morrow Sand	Chester Lime	St. Genevieve		Reported to Frac Fluids
SPACING & SPACING ORDER NUMBER	29573 (640)	29958 (640)	74429 (640)		
CLASS: Oil, Gas, Dry, Inj, Disp, Comm Disp, Svc	Gas	Gas	Gas		RECEIVED FEB 10 2022 OKLAHOMA CORPORATION COMMISSION
PERFORATED INTERVALS	6094 - 6104'	6224-6234'	6490'-6500'		
	6117 - 6120'	6276-6282'			
	6123 - 6126'				
ACID/VOLUME	2000 gal 10%				
FRACTURE TREATMENT (Fluids/Prop Amounts)	34143 gal x-link, 40,000# 20/40 sd	Pad acid stages w/ 24Q N2 with 1134 Bbls			

☒ Min Gas Allowable (165:10-17-7)  
OR  
☐ Oil Allowable (165:10-13-3)

Purchaser/Mesaurer  
First Sales Date

DCP Midstream  
11/11/2003

INITIAL TEST DATA

INITIAL TEST DATE	1/31/2022	(Commingled)			
OIL-BBL/DAY	0				
OIL-GRAVITY ( API)					
GAS-MCF/DAY	58				
GAS-OIL RATIO CU FT/BBL					
WATER-BBL/DAY	0				
PUMPING OR FLOWING	Flowing				
INITIAL SHUT-IN PRESSURE	150#				
CHOKE SIZE	NA				
FLOW TUBING PRESSURE	55#				

A record of the formations drilled through, and pertinent remarks are presented on the reverse. I declare that I have knowledge of the contents of this report and am authorized by my organization to make this report, which was prepared by me or under my supervision and direction, with the data and facts stated herein to be true, correct, and complete to the best of my knowledge and belief.

SIGNATURE Ryan Barby  
P.O. Box 1208 Woodward OK 73802  
ADDRESS CITY STATE ZIP  
DATE 2/16/2022 PHONE NUMBER 580-256-1416  
EMAIL ADDRESS ryanb@latigooil.com

PLEASE TYPE OR USE BLACK INK ONLY  
FORMATION RECORD

Give formation names and tops, if available, or descriptions and thickness of formations drilled through. Show intervals cored or drillstem tested.

NAMES OF FORMATIONS	TOP
Morrow Sand	6094'
Chester Lime	6224'
St. Genevieve	6490'

LEASE NAME Hodges WELL NO. 11-1

FOR COMMISSION USE ONLY	
ITD on file <input type="checkbox"/> YES <input type="checkbox"/> NO	
APPROVED <input type="checkbox"/> DISAPPROVED <input type="checkbox"/>	2) Reject Codes
<div style="border-bottom: 1px solid black; height: 15px; width: 100%;"></div> <div style="border-bottom: 1px solid black; height: 15px; width: 100%;"></div> <div style="border-bottom: 1px solid black; height: 15px; width: 100%;"></div> <div style="border-bottom: 1px solid black; height: 15px; width: 100%;"></div>	

Were open hole logs run? ☒ yes ☐ no

Date Last log was run 6/23/2003

Was CO<sub>2</sub> encountered? ☐ yes ☒ no at what depths? \_\_\_\_\_

Was H<sub>2</sub>S encountered? ☐ yes ☒ no at what depths? \_\_\_\_\_

Were unusual drilling circumstances encountered? ☐ yes ☒ no

If yes, briefly explain below \_\_\_\_\_

Other remarks: \_\_\_\_\_

\_\_\_\_\_

\_\_\_\_\_

\_\_\_\_\_

\_\_\_\_\_

\_\_\_\_\_

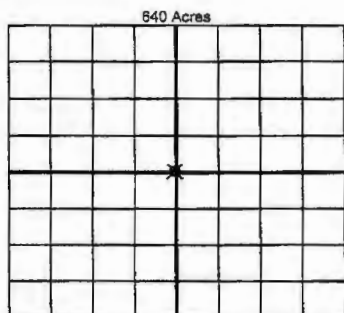

If more than three drainholes are proposed, attach a separate sheet indicating the necessary information.

Direction must be stated in degrees azimuth. Please note, the horizontal drainhole and its end point must be located within the boundaries of the lease or spacing unit.

Directional surveys are required for all drainholes and directional wells

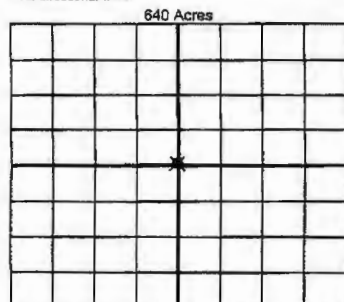

BOTTOM HOLE LOCATION FOR DIRECTIONAL HOLE

SEC	TWP	RGE	COUNTY
1/4	1/4	1/4	1/4
Measured Total Depth		True Vertical Depth	BHL From Lease, Unit, or Property Line:

BOTTOM HOLE LOCATION FOR HORIZONTAL HOLE: (LATERALS)

LATERAL #1

SEC	TWP	RGE	COUNTY
1/4	1/4	1/4	1/4
Depth of Deviation		Radius of Turn	Direction
Measured Total Depth		True Vertical Depth	BHL From Lease, Unit, or Property Line:

LATERAL #2

SEC	TWP	RGE	COUNTY
1/4	1/4	1/4	1/4
Depth of Deviation		Radius of Turn	Direction
Measured Total Depth		True Vertical Depth	BHL From Lease, Unit, or Property Line:

LATERAL #3

SEC	TWP	RGE	COUNTY
1/4	1/4	1/4	1/4
Depth of Deviation		Radius of Turn	Direction
Measured Total Depth		True Vertical Depth	BHL From Lease, Unit, or Property Line: