

Oklahoma Corporation Commission  
Oil & Gas Conservation Division  
Post Office Box 52000  
Oklahoma City, Oklahoma 73152-2000  
Rule 165: 10-3-25

Form 1002A

API No.: 35019226050001

**Completion Report**

Spud Date: September 22, 1983

OTC Prod. Unit No.: 019-06407

Drilling Finished Date: September 29, 1983

**Amended**

1st Prod Date: October 20, 1983

Amend Reason: RECOMPLETE (ADDED PERFORATIONS) / CHANGE WELL NUMBER

Completion Date: October 22, 1983

Recomplete Date: January 04, 2022

**Drill Type: STRAIGHT HOLE**

Min Gas Allowable: Yes

Well Name: HEWITT UNIT 16-0303

Purchaser/Measurer:

Location: CARTER 16 4S 2W  
SW NE NW NE  
2030 FSL 810 FWL of 1/4 SEC  
Latitude: 34.21469 Longitude: -97.41074  
Derrick Elevation: 876 Ground Elevation: 860

First Sales Date:

Operator: XTO ENERGY INC 21003

22777 SPRINGWOODS VILLAGE PARKWAY  
SPRING, TX 77389-1425

Completion Type		Location Exception		Increased Density	
X	Single Zone	Order No		Order No	
	Multiple Zone	There are no Location Exception records to display.		There are no Increased Density records to display.	
	Commingled				

Casing and Cement							
Type	Size	Weight	Grade	Feet	PSI	SAX	Top of CMT
SURFACE	10 3/4	40.5	L-80	612		900	SURFACE
PRODUCTION	7	20	K-55	2624	1500	1650	SURFACE

Liner								
Type	Size	Weight	Grade	Length	PSI	SAX	Top Depth	Bottom Depth
There are no Liner records to display.								

**Total Depth: 2634**

Packer		Plug	
Depth	Brand & Type	Depth	Plug Type
There are no Packer records to display.		There are no Plug records to display.	

Initial Test Data
-------------------

Test Date	Formation	Oil BBL/Day	Oil-Gravity (API)	Gas MCF/Day	Gas-Oil Ratio Cu FT/BBL	Water BBL/Day	Pumpin or Flowing	Initial Shut-In Pressure	Choke Size	Flow Tubing Pressure
Jan 12, 2022	HEWITT	12	35			1677	PUMPING			

Completion and Test Data by Producing Formation

Formation Name: HEWITT		Code: 405HWTT		Class: OIL	
Spacing Orders		Perforated Intervals			
Order No	Unit Size	From	To		
67990	UNIT	1136	1244		
		1291	1369		
		2193	2238		
Acid Volumes		Fracture Treatments			
7,500 GALLONS 15% HCL		3,800 BARRELS X-LINK, 183,600 POUNDS SAND			

Formation Name: HEWITT		Code: 405HWTT		Class: OIL	
Spacing Orders		Perforated Intervals			
Order No	Unit Size	From	To		
67990	UNIT	1476	2370		
Acid Volumes		Fracture Treatments			
1,250 GALLONS 15% HCL (ORIGINAL ACID WORK)		25,000 GALLONS K-1 POLYMULSON, 44,000 POUNDS SAND, (ORIGINAL FRAC)			

Formation	Top
BAYOU UPPER	1136
BAYOU LOWER	1291
STEARNS /OKLA/	1476
CHUBBEE	1542

Were open hole logs run? Yes  
 Date last log run: September 28, 1983

Were unusual drilling circumstances encountered? No  
 Explanation:

Other Remarks
ADDED PERFORATIONS: 1,136' - 1,145', 1,156' - 1,170', 1,184' - 1,244', 1,291' - 1,369', 2,193' - 2,238'. ALL AT 2 SHOTS PER FOOT. OCC - THE ORIGINAL PERFORATIONS WERE FROM 1476' TO 2370'.

FOR COMMISSION USE ONLY
<div>Status: Accepted</div> <div>1147597</div>

API NO. 35-019-22605  
OTC PROD. UNIT NO. 019-06407

Oil and Gas Conservation Division  
P.O. Box 52000  
Oklahoma City, OK 73152-2000  
405-522-0577  
OCCentralProcessing@OCC.OK.GOV



OKLAHOMA  
Corporation  
Commission

Form 1002A  
Rev. 2020

ORIGINAL AMENDED (Reason) Change Well number Rule 165:10-3-25 COMPLETION REPORT

TYPE OF DRILLING OPERATION

☒ STRAIGHT HOLE ☐ DIRECTIONAL HOLE ☐ HORIZONTAL HOLE  
☐ SERVICE WELL

If directional or horizontal, see reverse for bottom hole location.

COUNTY Carter SEC 16 TWP 4S RGE 2W SPUD DATE 9/22/1983

LEASE NAME Hewitt Unit WELL NO. 16-0303 DATE OF WELL COMPLETION 10/22/1983

SW 1/4 NE 1/4 NW 1/4 NE 1/4 FSL 2030 FWL 810 1st PROD DATE 10/20/1983

ELEVATION Derrick FL 876 Ground 860 Latitude 34.21469 Longitude -97.41074

OPERATOR NAME XTO Energy Inc OTC / OCC OPERATOR NO. 21003

ADDRESS 210 Park Ave, Suite 2350

CITY Oklahoma City STATE OK ZIP 73102

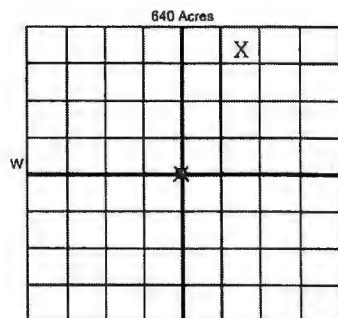

LOCATE WELL

COMPLETION TYPE

<input checked="" type="radio"/> SINGLE ZONE	
<input type="radio"/> MULTIPLE ZONE	
Application Date	
<input type="radio"/> COMMINGLED	
Application Date	
LOCATION EXCEPTION ORDER NO.	
MULTIUNIT ORDER NO.	
INCREASED DENSITY ORDER NO.	

CASING & CEMENT (Attach Form 1002C)

TYPE	SIZE	WEIGHT	GRADE	FEET	PSI	SAX	TOP OF CMT
CONDUCTOR							
SURFACE	10 3/4"	40.5#	L-80	612'		900	Surface
INTERMEDIATE							
PRODUCTION	7"	20#	K-55	2624'	1500	1650	Surface
LINER							

PACKER @ \_\_\_\_\_ BRAND & TYPE \_\_\_\_\_ PLUG @ \_\_\_\_\_ TYPE \_\_\_\_\_ PLUG @ \_\_\_\_\_ TYPE \_\_\_\_\_ TOTAL DEPTH 2634'

COMPLETION & TEST DATA BY PRODUCING FORMATION 405 HWTT

FORMATION	Hewitt Sands	Hewitt Sands				Reported to Fractures
SPACING & SPACING ORDER NUMBER	67990 (Unit)	67990 (Unit)				
CLASS: Oil, Gas, Dry, Inj, Disp, Comm Disp, Svc	Oil	Oil				
PERFORATED INTERVALS	1136' - 1244'	1476' - 2370'				
	1291' - 1369'	(original posts)				
	2193' - 2238'					
ACID/VOLUME	7.5k gal 15% HCl	1250 gal 15% HCl (original acid work)				
FRACTURE TREATMENT (Fluids/Prop Amounts)	3.8k bbls X-Link. 183.6k# sand	25k gal K-1 Polymulson 44k# sand (original frac.)				

RECEIVED

FEB 17 2022

OKLAHOMA CORPORATION COMMISSION

Min Gas Allowable (165:10-17-7)



OR

Oil Allowable (165:10-13-3)

Purchaser/Measurer

First Sales Date

INITIAL TEST DATA

INITIAL TEST DATE	01/12/22	10/22/23				
OIL-BBL/DAY	12	52				
OIL-GRAVITY (API)	35	35.1				
GAS-MCF/DAY						
GAS-OIL RATIO CU FT/BBL	0	0				
WATER-BBL/DAY	1677	494				
PUMPING OR FLOWING	Pumping	Pumping				
INITIAL SHUT-IN PRESSURE						
CHOKE SIZE						
FLOW TUBING PRESSURE						

A record of the formations drilled through, and pertinent remarks are presented on the reverse. I declare that I have knowledge of the contents of this report and am authorized by my organization to make this report, which was prepared by me or under my supervision and direction, with the data and facts stated herein to be true, correct, and complete to the best of my knowledge and belief.

SIGNATURE

210 Park Ave, Suite 2350

ADDRESS

NAME (PRINT OR TYPE)

Oklahoma City OK 73102

CITY STATE ZIP

DATE

2/16/22 405-694-9453

liv.adams@exxonmobil.com

EMAIL ADDRESS

PLEASE TYPE OR USE BLACK INK ONLY  
FORMATION RECORD

Give formation names and tops, if available, or descriptions and thickness of formations drilled through. Show intervals cored or drillstem tested.

NAMES OF FORMATIONS	TOP
Upper Bayou	1136
Lower Bayou	1291
Stearns	1476
Chubbee	1542
1B	1645
1C	1772
2A	1788
2B	1824
3A	1858
3B	2193

LEASE NAME \_\_\_\_\_ Hewitt Unit WELL NO. 16-0303

FOR COMMISSION USE ONLY	
ITD on file <input type="checkbox"/> YES <input type="checkbox"/> NO	
APPROVED _____ DISAPPROVED _____	2) Reject Codes _____
_____	
_____	
_____	
_____	

Were open hole logs run?	<input checked="" type="radio"/> yes <input type="radio"/> no
Date Last log was run	08/28/83
Was CO <sub>2</sub> encountered?	<input type="radio"/> yes <input type="radio"/> no at what depths? _____
Was H <sub>2</sub> S encountered?	<input type="radio"/> yes <input type="radio"/> no at what depths? _____
Were unusual drilling circumstances encountered?	<input type="radio"/> yes <input type="radio"/> no
If yes, briefly explain below _____	

Other remarks: Added perms; 1136'-1145', 1156'-1170', 1184'-1244', 1291'-1369', 2193'-2238'. All 2SPF.

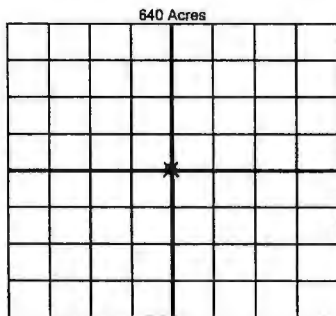

If more than three drainholes are proposed, attach a separate sheet indicating the necessary information.

Direction must be stated in degrees azimuth. Please note, the horizontal drainhole and its end point must be located within the boundaries of the lease or spacing unit.

Directional surveys are required for all drainholes and directional wells

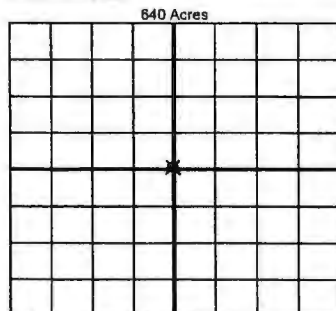

BOTTOM HOLE LOCATION FOR DIRECTIONAL HOLE

SEC	TWP	RGE	COUNTY
1/4	1/4	1/4	1/4
Measured Total Depth		True Vertical Depth	Feet From 1/4 Sec Lines BHL From Lease, Unit, or Property Line:

BOTTOM HOLE LOCATION FOR HORIZONTAL HOLE: (LATERALS)

LATERAL #1			
SEC	TWP	RGE	COUNTY
1/4	1/4	1/4	1/4
Depth of Deviation		Radius of Turn	Direction Total Length
Measured Total Depth		True Vertical Depth	BHL From Lease, Unit, or Property Line:

LATERAL #2			
SEC	TWP	RGE	COUNTY
1/4	1/4	1/4	1/4
Depth of Deviation		Radius of Turn	Direction Total Length
Measured Total Depth		True Vertical Depth	BHL From Lease, Unit, or Property Line:

LATERAL #3			
SEC	TWP	RGE	COUNTY
1/4	1/4	1/4	1/4
Depth of Deviation		Radius of Turn	Direction Total Length
Measured Total Depth		True Vertical Depth	BHL From Lease, Unit, or Property Line: