

Oklahoma Corporation Commission  
Oil & Gas Conservation Division  
Post Office Box 52000  
Oklahoma City, Oklahoma 73152-2000  
Rule 165: 10-3-25

Form 1002A

API No.: 35019211760001

**Completion Report**

Spud Date: May 14, 1973

OTC Prod. Unit No.: 019-06407

Drilling Finished Date: May 19, 1973

1st Prod Date: May 30, 1973

**Amended**

Completion Date: May 31, 1973

Amend Reason: RECOMPLETE (ADDED PERFORATIONS) / CHANGE WELL NUMBER

Recomplete Date: November 01, 2021

**Drill Type: STRAIGHT HOLE**

Min Gas Allowable: Yes

Well Name: HEWITT UNIT 22-2082

Purchaser/Measurer:

Location: CARTER 22 4S 2W  
E2 NW NW NW  
2310 FSL 405 FWL of 1/4 SEC  
Latitude: 34.20094 Longitude: -97.40336  
Derrick Elevation: 877 Ground Elevation: 871

First Sales Date:

Operator: XTO ENERGY INC 21003

22777 SPRINGWOODS VILLAGE PARKWAY  
SPRING, TX 77389-1425

Completion Type		Location Exception		Increased Density	
X	Single Zone	Order No		Order No	
	Multiple Zone	There are no Location Exception records to display.		There are no Increased Density records to display.	
	Commingled				

Casing and Cement							
Type	Size	Weight	Grade	Feet	PSI	SAX	Top of CMT
CONDUCTOR	10 3/4	40.5	K-55	28			SURFACE
PRODUCTION	7	23	K-55	2448		600	SURFACE

Liner								
Type	Size	Weight	Grade	Length	PSI	SAX	Top Depth	Bottom Depth
There are no Liner records to display.								

**Total Depth: 2450**

Packer	
Depth	Brand & Type
There are no Packer records to display.	

Plug	
Depth	Plug Type
There are no Plug records to display.	

Initial Test Data
-------------------

Test Date	Formation	Oil BBL/Day	Oil-Gravity (API)	Gas MCF/Day	Gas-Oil Ratio Cu FT/BBL	Water BBL/Day	Pumpin or Flowing	Initial Shut-In Pressure	Choke Size	Flow Tubing Pressure
Nov 03, 2021	HEWITT	49	35			423	PUMPING			

Completion and Test Data by Producing Formation									
Formation Name: HEWITT				Code: 405HWTT			Class: OIL		
Spacing Orders				Perforated Intervals					
Order No		Unit Size		From			To		
67990		UNIT		946			1266		
				1794			1846		
Acid Volumes				Fracture Treatments					
6,000 GALLONS 15% HCL				1,469 BARRELS X-LINK, 72,100 POUNDS SAND					

Formation Name: HEWITT		Code: 405HWTT		Class: OIL	
Spacing Orders		Perforated Intervals			
Order No	Unit Size	From	To		
67990	UNIT	1308	2383		
Acid Volumes		Fracture Treatments			
There are no Acid Volume records to display.		There are no Fracture Treatments records to display.			

Formation	Top
HOXBAR	946
DEESE	2364

Were open hole logs run? Yes  
 Date last log run: May 19, 1973  
  
 Were unusual drilling circumstances encountered? No  
 Explanation:

Other Remarks
ADDED PERFORATIONS: 946' - 956', 979' - 1,038, 1,111' - 1,192', 1,226' - 1,266', 1,794' - 1,846'. ALL AT 2 SHOTS PER FOOT. OCC - THE ORIGINAL PERFORATIONS WERE FROM 1308' TO 2383'.

FOR COMMISSION USE ONLY
<div>Status: Accepted</div> <div>1147596</div>

API NO. 35-019-21176  
OTC PROD. UNIT NO. 019-06407

Oil and Gas Conservation Division  
P.O. Box 52000  
Oklahoma City, OK 73152-2000  
405-522-0577  
OCCCentralProcessing@OCC.OK.GOV



OKLAHOMA  
Corporation  
Commission

Form 1002A  
Rev. 2020

ORIGINAL  
AMENDED (Reason) change well number Rule 165:10-3-25  
Recomplete - Attach Parts

TYPE OF DRILLING OPERATION

☒ STRAIGHT HOLE ☐ DIRECTIONAL HOLE ☐ HORIZONTAL HOLE  
☐ SERVICE WELL

If directional or horizontal, see reverse for bottom hole location.

COUNTY	Carter	SEC	22	TWP	4S	RGE	2W	SPUD DATE	5/14/1973
LEASE NAME	Hewitt Unit	WELL NO.	22-9802	DATE OF WELL COMPLETION	5/31/1973	1st PROD DATE	5/30/1973	RECOMP DATE	11/01/2021
ELEVATION	877	Ground	871	Latitude	34.20094	Longitude	-97.40336		
OPERATOR NAME	XTO Energy Inc			OTC / OCC OPERATOR NO.	21003				
ADDRESS	210 Park Ave, Suite 2350								
CITY	Oklahoma City	STATE	OK	ZIP	73102				

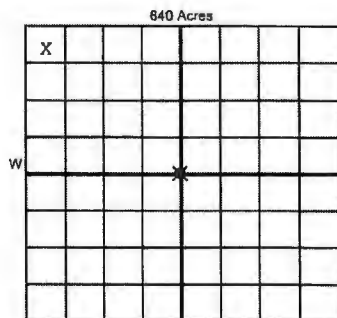

COMPLETION TYPE

<input checked="" type="radio"/> SINGLE ZONE	
<input type="radio"/> MULTIPLE ZONE	
Application Date	
<input type="radio"/> COMINGLED	
Application Date	
LOCATION EXCEPTION ORDER NO.	
MULTIUNIT ORDER NO.	
INCREASED DENSITY ORDER NO.	

CASING & CEMENT (Attach Form 1002C)

TYPE	SIZE	WEIGHT	GRADE	FEET	PSI	SAX	TOP OF CMT
CONDUCTOR							
SURFACE	10 3/4"	40.5#	K-55	28'			Surface
INTERMEDIATE							
PRODUCTION	7"	23#	K-55	2448'		600	Surface
LINER							

PACKER @ \_\_\_\_\_ BRAND & TYPE \_\_\_\_\_ PLUG @ \_\_\_\_\_ TYPE \_\_\_\_\_ PLUG @ \_\_\_\_\_ TYPE \_\_\_\_\_ TOTAL DEPTH 2450'

COMPLETION & TEST DATA BY PRODUCING FORMATION

FORMATION	Hewitt Sands	Hewitt Sands					Reported to Frac Focus
SPACING & SPACING ORDER NUMBER	67990 (Unit)	67990 (Unit)					
CLASS: Oil, Gas, Dry, Inj, Disp, Comm Disp, Svc	Oil	Oil					
PERFORATED INTERVALS	946' - 1266'	1308' - 2383'					
	1794' - 1846'	(original perfor)					
ACID/VOLUME	6000 gal 15% HCl						
FRACTURE TREATMENT (Fluids/Prop Amounts)	1469 bbls X-link 72.1k# snd						



Min Gas Allowable (165:10-17-7)

OR

Oil Allowable (165:10-13-3)

Purchaser/Messurer

First Sales Date

INITIAL TEST DATA

INITIAL TEST DATE	11-03-21	5-30-78				
OIL-BBL/DAY	49	94				
OIL-GRAVITY ( API)	35					
GAS-MCF/DAY						
GAS-OIL RATIO CU FT/BBL	0	0				
WATER-BBL/DAY	423	295				
PUMPING OR FLOWING	Pumping	Pumping				
INITIAL SHUT-IN PRESSURE						
CHOKE SIZE						
FLOW TUBING PRESSURE						

A record of the formations drilled through, and pertinent remarks are presented on the reverse. I declare that I have knowledge of the contents of this report and am authorized by my organization to make this report, which was prepared by me or under my supervision and direction, with the data and facts stated herein to be true, correct, and complete to the best of my knowledge and belief.

SIGNATURE	NAME (PRINT OR TYPE)	DATE	PHONE NUMBER
210 Park Ave, Suite 2350	Oklahoma City OK 73102	2/16/22	405-594-9453
ADDRESS	CITY STATE ZIP	EMAIL ADDRESS	

PLEASE TYPE OR USE BLACK INK ONLY  
FORMATION RECORD

Give formation names and tops, if available, or descriptions and thickness of formations drilled through. Show intervals cored or drillstem tested.

NAMES OF FORMATIONS	TOP
Hoxbar	946
Deese	2364

LEASE NAME \_\_\_\_\_ Hensley Unit WELL NO. 22-0802

FOR COMMISSION USE ONLY	
ITD on file <input type="checkbox"/> YES <input type="checkbox"/> NO	
APPROVED _____	DISAPPROVED _____
2) Reject Codes	
_____	
_____	
_____	
_____	

Were open hole logs run?	<input checked="" type="radio"/> yes <input type="radio"/> no
Date Last log was run	5/12/73
Was CO <sub>2</sub> encountered?	<input type="radio"/> yes <input type="radio"/> no at what depths? _____
Was H <sub>2</sub> S encountered?	<input type="radio"/> yes <input type="radio"/> no at what depths? _____
Were unusual drilling circumstances encountered?	<input type="radio"/> yes <input type="radio"/> no
If yes, briefly explain below.	

Other remarks: Added perfs; 946'-956', 979'-1038', 1111'-1192', 1228'-1266'; 1794' - 1846'. All 2SPF

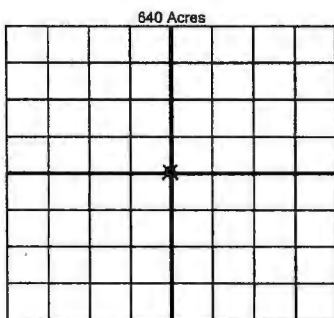

If more than three drainholes are proposed, attach a separate sheet indicating the necessary information.

Direction must be stated in degrees azimuth.  
Please note, the horizontal drainhole and its end point must be located within the boundaries of the lease or spacing unit.

Directional surveys are required for all drainholes and directional wells

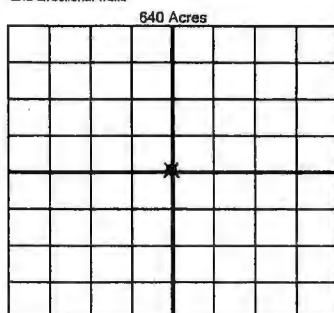

BOTTOM HOLE LOCATION FOR DIRECTIONAL HOLE

SEC	TWP	RGE	COUNTY
1/4	1/4	1/4	1/4
Measured Total Depth		True Vertical Depth	Feet From 1/4 Sec Lines BHL From Lease, Unit, or Property Line:

BOTTOM HOLE LOCATION FOR HORIZONTAL HOLE: (LATERALS)

LATERAL #1			
SEC	TWP	RGE	COUNTY
1/4	1/4	1/4	1/4
Depth of Deviation		Radius of Turn	Direction Total Length
Measured Total Depth		True Vertical Depth	BHL From Lease, Unit, or Property Line:

LATERAL #2			
SEC	TWP	RGE	COUNTY
1/4	1/4	1/4	1/4
Depth of Deviation		Radius of Turn	Direction Total Length
Measured Total Depth		True Vertical Depth	BHL From Lease, Unit, or Property Line:

LATERAL #3			
SEC	TWP	RGE	COUNTY
1/4	1/4	1/4	1/4
Depth of Deviation		Radius of Turn	Direction Total Length
Measured Total Depth		True Vertical Depth	BHL From Lease, Unit, or Property Line: