

Oklahoma Corporation Commission  
Oil & Gas Conservation Division  
Post Office Box 52000  
Oklahoma City, Oklahoma 73152-2000  
Rule 165: 10-3-25

Form 1002A

API No.: 35059202400001

**Completion Report**

Spud Date: February 20, 1971

OTC Prod. Unit No.: 059-044181-0-0000

Drilling Finished Date: March 22, 1971

**Amended**

1st Prod Date: October 01, 1971

Amend Reason: RECOMPLETION

Completion Date: March 22, 1971

Recomplete Date: December 06, 2021

**Drill Type: STRAIGHT HOLE**

Well Name: HICKMAN 1

Purchaser/Measurer:

Location: HARPER 20 27N 25W  
C SW NE  
1980 FNL 1980 FEL of 1/4 SEC  
Latitude: 36.8065965 Longitude: -99.9153975  
Derrick Elevation: 2133 Ground Elevation: 2124

First Sales Date:

Operator: LATIGO OIL AND GAS INC 10027  
PO BOX 1208  
5815 OKLAHOMA AVE  
WOODWARD, OK 73802-1208

Completion Type		Location Exception		Increased Density	
X	Single Zone	Order No		Order No	
	Multiple Zone	There are no Location Exception records to display.		There are no Increased Density records to display.	
	Commingled				

Casing and Cement							
Type	Size	Weight	Grade	Feet	PSI	SAX	Top of CMT
CONDUCTOR	16			50			
SURFACE	8 5/8	24		758		775	SURFACE
PRODUCTION	4 1/2	9.5 & 10.5		6800		200	6006

Liner								
Type	Size	Weight	Grade	Length	PSI	SAX	Top Depth	Bottom Depth
There are no Liner records to display.								

**Total Depth: 6794**

Packer		Plug	
Depth	Brand & Type	Depth	Plug Type
There are no Packer records to display.		6668	BP

Initial Test Data
-------------------

Test Date	Formation	Oil BBL/Day	Oil-Gravity (API)	Gas MCF/Day	Gas-Oil Ratio Cu FT/BBL	Water BBL/Day	Pumpin or Flowing	Initial Shut-In Pressure	Choke Size	Flow Tubing Pressure
Feb 06, 2022	MORROW			34	34		FLOWING	650	FULL	60

<b>Completion and Test Data by Producing Formation</b>	
Formation Name: MORROW	Code: 402MRRW
Class: GAS	

Spacing Orders	
Order No	Unit Size
92008	640

Perforated Intervals	
From	To
6632	6658

Acid Volumes
1,000 GALLONS 7.5%

Fracture Treatments
23,300 GALLONS 30Q N2 FOAM, 25,000 POUNDS 20/40 SAND

Formation	Top
MORROW	6515
CHESTER	6678

Were open hole logs run? Yes

Date last log run: March 22, 1971

Were unusual drilling circumstances encountered? No

Explanation:

<b>Other Remarks</b>
There are no Other Remarks.

FOR COMMISSION USE ONLY	
Status: Accepted	1147593

API NO. 35-05920240  
OTC PROD. UNIT NO. 059044181

Oil and Gas Conservation Division  
P.O. Box 52000  
Oklahoma City, OK 73152-2000  
405-522-0577  
OCCentralProcessing@OCC.OK.GOV



OKLAHOMA  
Corporation  
Commission

Form 1002A  
Rev. 2020

ORIGINAL  
AMENDED (Reason) Recompletion

Rule 165:10-3-25

COMPLETION REPORT

TYPE OF DRILLING OPERATION

☒ STRAIGHT HOLE ☐ DIRECTIONAL HOLE ☐ HORIZONTAL HOLE  
☐ SERVICE WELL

If directional or horizontal, see reverse for bottom hole location.

COUNTY Harper SEC 20 TWP 27N RGE 25W

LEASE NAME Hickman WELL NO. 1

1/4 C 1/4 SW 1/4 NE 1/4 FNL 1980' FEL 1980'

ELEVATION 2133' Ground 2124' Latitude

OPERATOR NAME Latigo Oil & Gas, Inc.

ADDRESS P.O. Box 1208

CITY Woodward STATE OK ZIP 73802

SPUD DATE 02/20/1971

DRLG FINISHED DATE 03/22/1971

DATE OF WELL COMPLETION 03/22/1971

1st PROD DATE 10/1/1971

RECOMP DATE 12/6/2021

OTC / OCC OPERATOR NO. 10027

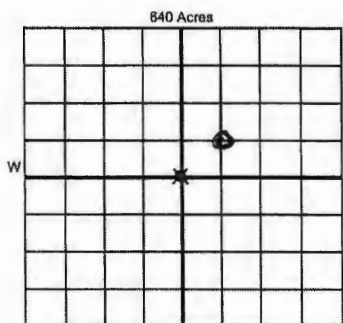

COMPLETION TYPE

☒ SINGLE ZONE  
☐ MULTIPLE ZONE  
☐ COMMINGLED  
LOCATION EXCEPTION ORDER NO.  
MULTIUNIT ORDER NO.  
INCREASED DENSITY ORDER NO.

CASING & CEMENT (Attach Form 1002C)

TYPE	SIZE	WEIGHT	GRADE	FEET	PSI	SAX	TOP OF CMT
CONDUCTOR	16"			50'			
SURFACE	8-5/8"	24#		758		775	Surface
INTERMEDIATE							
PRODUCTION	4-1/2"	9.5 & 10.5#		6800		200	6006'
LINER							

PACKER @ BRAND & TYPE

PLUG @ 6668' TYPE BP

PLUG @ TYPE

TOTAL DEPTH 6794'

PACKER @ BRAND & TYPE

PLUG @ TYPE

PLUG @ TYPE

COMPLETION & TEST DATA BY PRODUCING FORMATION

402 MBRW

FORMATION	<u>Morrow</u>						
SPACING & SPACING ORDER NUMBER	<u>92008 (640)</u>	<u>92008 (640) OK</u>					
CLASS: Oil, Gas, Dry, Inj, Disp, Comm Disp, Svc	<u>Gas</u>						
PERFORATED INTERVALS	<u>6654-6658'</u> <u>6632-6637'</u>						
ACID/VOLUME	<u>1000 gal 7.5%</u>						
FRACTURE TREATMENT (Fluids/Prop Amounts)	<u>23,300 gal 30Q N2 foam, 25k 20/40 sd</u>						

Alcanto Report to FracFuels

RECEIVED

FEB 18 2022

OKLAHOMA CORPORATION COMMISSION

Min Gas Allowable (165:10-17-7)

OR

Oil Allowable (165:10-13-3)

Purchaser/Measurer

First Sales Date

INITIAL TEST DATA

INITIAL TEST DATE	<u>2/6/2022</u>					
OIL-BBL/DAY	<u>0</u>					
OIL-GRAVITY (API)						
GAS-MCF/DAY	<u>34</u>					
GAS-OIL RATIO CU FT/BBL	<u>34</u>					
WATER-BBL/DAY	<u>0</u>					
PUMPING OR FLOWING	<u>Flowing</u>					
INITIAL SHUT-IN PRESSURE	<u>650#</u>					
CHOKE SIZE	<u>Full</u>					
FLOW TUBING PRESSURE	<u>60#</u>					

A record of the formations drilled through, and pertinent remarks are presented on the reverse. I declare that I have knowledge of the contents of this report and am authorized by my organization to make this report, which was prepared by me or under my supervision and direction, with the data and facts stated herein to be true, correct, and complete to the best of my knowledge and belief.

SIGNATURE

P.O. Box 1208

ADDRESS

Ryan Barby

NAME (PRINT OR TYPE)

Woodward

CITY

OK

STATE

73802

ZIP

2/16/2022

DATE

580-256-1416

PHONE NUMBER

ryanb@latigooil.com

EMAIL ADDRESS

PLEASE TYPE OR USE BLACK INK ONLY  
FORMATION RECORD

Give formation names and tops, if available, or descriptions and thickness of formations drilled through. Show intervals cored or drillstem tested.

NAMES OF FORMATIONS	TOP
Morrow	6515'
Chester	6678'

LEASE NAME Hickman WELL NO. 1

FOR COMMISSION USE ONLY	
ITD on file <input type="checkbox"/> YES <input type="checkbox"/> NO	
APPROVED _____	DISAPPROVED _____
2) Reject Codes	
_____	
_____	
_____	
_____	

Were open hole logs run?	<input checked="" type="radio"/> yes <input type="radio"/> no
Date Last log was run	3/22/1971
Was CO <sub>2</sub> encountered?	<input type="radio"/> yes <input checked="" type="radio"/> no at what depths? _____
Was H <sub>2</sub> S encountered?	<input type="radio"/> yes <input checked="" type="radio"/> no at what depths? _____
Were unusual drilling circumstances encountered? If yes, briefly explain below	<input type="radio"/> yes <input checked="" type="radio"/> no

Other remarks:

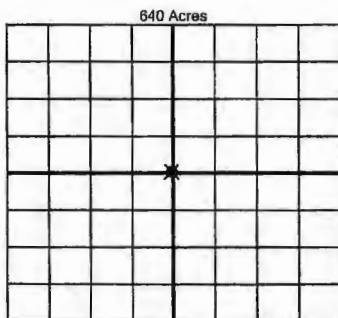
If more than three drainholes are proposed, attach a separate sheet indicating the necessary information.

Direction must be stated in degrees azimuth. Please note, the horizontal drainhole and its end point must be located within the boundaries of the lease or spacing unit.

Directional surveys are required for all drainholes and directional wells

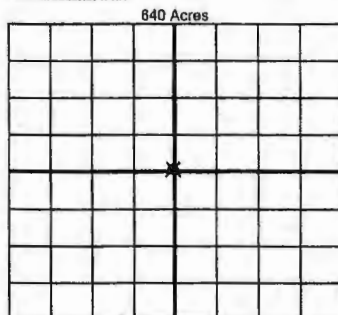

BOTTOM HOLE LOCATION FOR DIRECTIONAL HOLE

SEC	TWP	RGE	COUNTY
1/4	1/4	1/4	1/4
Measured Total Depth		True Vertical Depth	BHL From Lease, Unit, or Property Line:

BOTTOM HOLE LOCATION FOR HORIZONTAL HOLE: (LATERALS)

LATERAL #1			
SEC	TWP	RGE	COUNTY
1/4	1/4	1/4	1/4
Depth of Deviation		Radius of Turn	Direction
Measured Total Depth		True Vertical Depth	BHL From Lease, Unit, or Property Line:

LATERAL #2			
SEC	TWP	RGE	COUNTY
1/4	1/4	1/4	1/4
Depth of Deviation		Radius of Turn	Direction
Measured Total Depth		True Vertical Depth	BHL From Lease, Unit, or Property Line:

LATERAL #3			
SEC	TWP	RGE	COUNTY
1/4	1/4	1/4	1/4
Depth of Deviation		Radius of Turn	Direction
Measured Total Depth		True Vertical Depth	BHL From Lease, Unit, or Property Line: