

Oklahoma Corporation Commission
Oil & Gas Conservation Division
Post Office Box 52000
Oklahoma City, Oklahoma 73152-2000
Rule 165: 10-3-25

Form 1002A

API No.: 35043236920000

Completion Report

Spud Date: February 28, 2019

OTC Prod. Unit No.: 043-226018-0-0000

Drilling Finished Date: June 06, 2019

1st Prod Date: July 18, 2019

Completion Date: June 12, 2019

Drill Type: HORIZONTAL HOLE

Min Gas Allowable: Yes

Well Name: LANCELOT 1-31-30XH

Purchaser/Measurer: TALL OAK

Location: DEWEY 31 17N 14W
SE SE SW SW
258 FSL 1060 FWL of 1/4 SEC
Latitude: 35.8995674 Longitude: -98.7393183
Derrick Elevation: 25 Ground Elevation: 1747

First Sales Date: 07/26/2019

Operator: EXCALIBUR RESOURCES LLC 23349

1100 LOUISIANA ST STE 5100
HOUSTON, TX 77002-5220

Completion Type	
X	Single Zone
	Multiple Zone
	Commingled

Location Exception	
Order No	
705172	

Increased Density	
Order No	
There are no Increased Density records to display.	

Casing and Cement							
Type	Size	Weight	Grade	Feet	PSI	SAX	Top of CMT
CONDUCTOR	20	94	H-40	80			SURFACE
SURFACE	13.375	54.5	J-55	1500		1228	SURFACE
INTERMEDIATE	9.625	40	P-110EC	9473		598	6513
PRODUCTION	5.5	23	P-110EC	15612		1924	2541

Liner								
Type	Size	Weight	Grade	Length	PSI	SAX	Top Depth	Bottom Depth
There are no Liner records to display.								

Total Depth: 19790

Packer	
Depth	Brand & Type
11516	5.5" VERSASET

Plug	
Depth	Plug Type
There are no Plug records to display.	

Initial Test Data

Test Date	Formation	Oil BBL/Day	Oil-Gravity (API)	Gas MCF/Day	Gas-Oil Ratio Cu FT/BBL	Water BBL/Day	Pumpin or Flowing	Initial Shut-In Pressure	Choke Size	Flow Tubing Pressure
Jul 21, 2019	WOODFORD			1054		755	FLOWING	470	14/64	2300

Completion and Test Data by Producing Formation

Formation Name: WOODFORD

Code: 319WDFD

Class: GAS

Spacing Orders

Order No	Unit Size
687580	640
689492	640
705171	MULTIUNIT

Perforated Intervals

From	To
12500	15552

Acid Volumes

714 BARRELS

Fracture Treatments

134,977 BARRELS SLICKWATER, 76,212 BARRELS LINEAR GEL, 6,474,350 POUNDS PROPPANT
--

Formation	Top
DOUGLAS	6710
TONKAWA	7212
COTTAGE GROVE	7901
CHECKERBOARD	8437
PINK LIME	9141
RED FORK	9230
INOLA	9357
ATOKA	9382
MORROW	9607
CHESTER	10258
MISSISSIPPIAN	11361
WOODFORD	12180

Were open hole logs run? Yes

Date last log run: April 04, 2019

Were unusual drilling circumstances encountered? No

Explanation:

Other Remarks

OCC - THIS WELL IS BOTH PERFORATED FROM 12,500' TO 15,552' AND OPEN HOLE COMPLETED FROM END OF 5 1/2" CASING AT 15,612' TO TERMINUS AT 19,790'.

Lateral Holes

Sec: 30 TWP: 17N RGE: 14W County: DEWEY

SW SE SW NW

2340 FNL 759 FWL of 1/4 SEC

Depth of Deviation: 11566 Radius of Turn: 690 Direction: 358 Total Length: 7924

Measured Total Depth: 19790 True Vertical Depth: 12158 End Pt. Location From Release, Unit or Property Line: 759

Status: Accepted

NO. 35-043-23692
OTC PROD. UNIT NO. 43226018

(PLEASE TYPE OR USE BLACK INK ONLY)

OKLAHOMA CORPORATION COMMISSION
Oil & Gas Conservation Division
Post Office Box 52000
Oklahoma City, Oklahoma 73152-2000
Rule 165:10-3-25

RECEIVED

Form 1002A
Rev. 2009

NOV 14 2019

☒ ORIGINAL
☐ AMENDED (Reason)

COMPLETION REPORT

TYPE OF DRILLING OPERATION

☐ STRAIGHT HOLE ☐ DIRECTIONAL HOLE ☒ HORIZONTAL HOLE
☐ SERVICE WELL

If directional or horizontal, see reverse for bottom hole location.

COUNTY	DEWEY	SEC	31	TWP	17N	RGE	14W	SPUD DATE	2/28/2019
LEASE NAME	LANCELOT			WELL NO.	1-31-30XH			DRLG FINISHED DATE	6/6/2019
SE 1/4	SE 1/4	SW 1/4	SW 1/4	FSL OF 1/4 SEC	258'	FWL OF 1/4 SEC	1060'	DATE OF WELL COMPLETION	6/12/2019
ELEVATION Derrick FL	25'	Ground	1747'	Latitude (if known)	35.8995674			1st PROD DATE	7/18/19
OPERATOR NAME	EXCALIBUR RESOURCES, LLC			OTC / OCC OPERATOR NO.	23349				
ADDRESS	12222 MERIT DR SUITE 1150								
CITY	DALLAS			STATE	TX		ZIP	75251	

OKLAHOMA CORPORATION COMMISSION

LOCATE WELL

COMPLETION TYPE

<input checked="" type="checkbox"/> SINGLE ZONE	
<input type="checkbox"/> MULTIPLE ZONE	
<input type="checkbox"/> COMMINGLED	
LOCATION EXCEPTION ORDER NO.	705172
INCREASED DENSITY ORDER NO.	

CASING & CEMENT (Attach Form 1002C)

TYPE	SIZE	WEIGHT	GRADE	FEET	PSI	SAX	TOP OF CMT
CONDUCTOR	20	94	H40	80'			Surface
SURFACE	13.375	54.5	J55	1,500'		1228.3	Surface
INTERMEDIATE	9.625	40	P110E	9,473'		598	6,513'
PRODUCTION	5.5	23	P110E	15,612'		1924	2,541'
LINER							
TOTAL DEPTH							19,790'

PACKER @ 1151V BRAND & TYPE 5.5" Versaset
PACKER @ BRAND & TYPE

PLUG @ TYPE PLUG @ TYPE
PLUG @ TYPE PLUG @ TYPE

COMPLETION & TEST DATA BY PRODUCING FORMATION

FORMATION	Woodford	Woodford		
SPACING & SPACING ORDER NUMBER	640/687580	640/689492	705171 (Multiunit)	Reported to Frac Focus
CLASS: Oil, Gas, Dry, Inj, Disp, Comm Disp, Svc	Gas	Gas		
PERFORATED INTERVALS	12,500' - 15,612'			
ACID/VOLUME	714 bbl			
FRACTURE TREATMENT (Fluids/Prop Amounts)	134,977 bbl	Slickwater		
	76,212 bbl	Linear Gel		
	6,474,350 #	Proppant		

Min Gas Allowable (165:10-17-7)

Gas Purchaser/Measurer

TALL OAK

INITIAL TEST DATA

Oil Allowable (165:10-13-3)

First Sales Date

7/26/2019

INITIAL TEST DATE	7/21/2019			
OIL-BBL/DAY	0			
OIL-GRAVITY (API)	-			
GAS-MCF/DAY	1,054			
GAS-OIL RATIO CU FT/BBL	-			
WATER-BBL/DAY	755			
PUMPING OR FLOWING	flowing			
INITIAL SHUT-IN PRESSURE	470 psi			
CHOKE SIZE	14/64"			
FLOW TUBING PRESSURE	2300 psi			

AS SUBMITTED

A record of the formations drilled through, and pertinent remarks are presented on the reverse. I declare that I have knowledge of the contents of this report and am authorized by my organization to make this report, which was prepared by me or under my supervision and direction, with the data and facts stated herein to be true, correct, and complete to the best of my knowledge and belief.

SIGNATURE
12222 MERIT DR SUITE 1150

THOMAS BODDY

NAME (PRINT OR TYPE)

DALLAS

TX

75251

11/5/2019

DATE

469-317-2200

PHONE NUMBER

THOMAS.BODDY@EXCALIBURRES.COM

PLEASE TYPE OR USE BLACK INK ONLY

FORMATION RECORD

Give formation names and tops, if available, or descriptions and thickness of formations drilled through. Show intervals cored or drillstem tested.

LEASE NAME

LANCELOT

WELL NO. 1-31-30XH

NAMES OF FORMATIONS	TOP
DOUGLAS	6,710
TONKAWA	7,212
COTTAGE GROVE	7,901
CHECKERBOARD	8,437
PINK LIME	9,141
RED FORK	9,230
INOLA	9,357
ATOKA	9,382
MORROW	9,607
CHESTER	10,258
MISSISSIPPIAN	11,361
WOODFORD	12,180

FOR COMMISSION USE ONLY	
ITD on file <input type="checkbox"/> YES <input type="checkbox"/> NO	
APPROVED _____ DISAPPROVED _____	2) Reject Codes

Were open hole logs run?	<input checked="" type="checkbox"/> yes <input type="checkbox"/> no
Date Last log was run	4/4/2019
Was CO ₂ encountered?	<input type="checkbox"/> yes <input checked="" type="checkbox"/> no at what depths? _____
Was H ₂ S encountered?	<input type="checkbox"/> yes <input checked="" type="checkbox"/> no at what depths? _____
Were unusual drilling circumstances encountered?	<input type="checkbox"/> yes <input checked="" type="checkbox"/> no
If yes, briefly explain below	

Other remarks:

OCC - This well is both perforated from 12500' to 15552' and open hole completed from end of 5 1/2" casing at 15612' to terminus at 19790'.

640 Acres

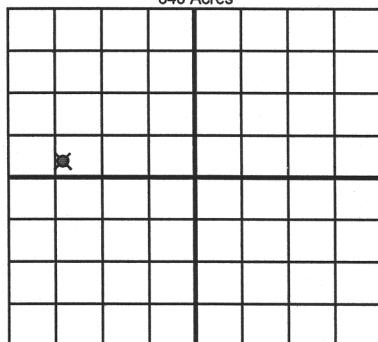

If more than three drainholes are proposed, attach a separate sheet indicating the necessary information.

Direction must be stated in degrees azimuth. Please note, the horizontal drainhole and its end point must be located within the boundaries of the lease or spacing unit.

Directional surveys are required for all drainholes and directional wells.

640 Acres

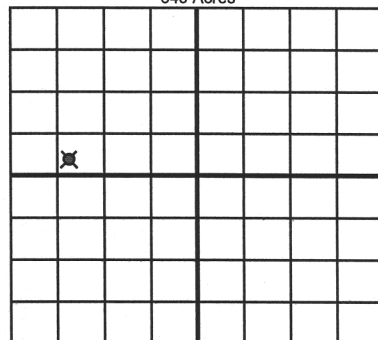

BOTTOM HOLE LOCATION FOR DIRECTIONAL HOLE

SEC	TWP	RGE	COUNTY
Spot Location			
1/4	1/4	1/4	1/4
Measured Total Depth		True Vertical Depth	BHL From Lease, Unit, or Property Line:

BOTTOM HOLE LOCATION FOR HORIZONTAL HOLE: (LATERALS)

LATERAL #1			
SEC	TWP	RGE	COUNTY
30	17N	14W	DEWEY
Spot Location			
SE 1/4	SE 1/4	SW 1/4	NW 1/4
Depth of Deviation		Radius of Turn	Direction
11,566'		690'	358 369°
Measured Total Depth		True Vertical Depth	BHL From Lease, Unit, or Property Line:
19,790'		12,158'	287° 759'

LATERAL #2

SEC	TWP	RGE	COUNTY
Spot Location			
1/4	1/4	1/4	1/4
Depth of Deviation		Radius of Turn	Direction
Measured Total Depth		True Vertical Depth	BHL From Lease, Unit, or Property Line:

LATERAL #3

SEC	TWP	RGE	COUNTY
Spot Location			
1/4	1/4	1/4	1/4
Depth of Deviation		Radius of Turn	Direction
Measured Total Depth		True Vertical Depth	BHL From Lease, Unit, or Property Line: