

Oklahoma Corporation Commission
Oil & Gas Conservation Division
Post Office Box 52000
Oklahoma City, Oklahoma 73152-2000
Rule 165: 10-3-25

Form 1002A

API No.: 35083244510000

Completion Report

Spud Date: August 24, 2019

OTC Prod. Unit No.:

Drilling Finished Date: August 29, 2019

1st Prod Date: October 10, 2019

Completion Date: September 12, 2019

Drill Type: STRAIGHT HOLE

Well Name: RHODES 4

Purchaser/Measurer:

Location: LOGAN 22 17N 3W
SE NW SE SE
882 FSL 970 FEL of 1/4 SEC
Latitude: 35.929998 Longitude: -97.500484
Derrick Elevation: 1099 Ground Elevation: 1086

First Sales Date:

Operator: NEWKUMET EXPLORATION INC 19935
PO BOX 11330
310 WEST WALL ST STE 500
MIDLAND, TX 79702-1330

Completion Type		Location Exception		Increased Density	
X	Single Zone	Order No		Order No	
	Multiple Zone	There are no Location Exception records to display.		There are no Increased Density records to display.	
	Commingled				

Casing and Cement							
Type	Size	Weight	Grade	Feet	PSI	SAX	Top of CMT
SURFACE	8.625	23	J-55	420		230	SURFACE
PRODUCTION	5.500	15.5	J-55	4954		100	4500

Liner								
Type	Size	Weight	Grade	Length	PSI	SAX	Top Depth	Bottom Depth
There are no Liner records to display.								

Total Depth: 5000

Packer	
Depth	Brand & Type
There are no Packer records to display.	

Plug	
Depth	Plug Type
There are no Plug records to display.	

Initial Test Data										
Test Date	Formation	Oil BBL/Day	Oil-Gravity (API)	Gas MCF/Day	Gas-Oil Ratio Cu FT/BBL	Water BBL/Day	Pumpin or Flowing	Initial Shut-In Pressure	Choke Size	Flow Tubing Pressure
Oct 10, 2019	LAYTON LOW	8	35			2	PUMPING	20	N/A	

Completion and Test Data by Producing Formation			
Formation Name: LAYTON LOW		Code: 405LYTNL	Class: OIL
Spacing Orders		Perforated Intervals	
Order No	Unit Size	From	To
450003	UNIT	4804	4814
Acid Volumes		Fracture Treatments	
1,500 GALLONS 7.5%		30 POUNDS C L BORATE GEL, 160 BARRELS WATER, 6,000 POUNDS SAND	

Formation	Top
LOWER LAYTON	4800

Were open hole logs run? Yes
Date last log run: August 29, 2019

Were unusual drilling circumstances encountered? No
Explanation:

Other Remarks
There are no Other Remarks.

FOR COMMISSION USE ONLY	
Status: Accepted	1144264

API NO. 35-083-124451
OTC PROD. UNIT NO.

(PLEASE TYPE OR USE BLACK INK ONLY)

OKLAHOMA CORPORATION COMMISSION
Oil & Gas Conservation Division
Post Office Box 52000
Oklahoma City, Oklahoma 73152-2000
Rule 165-10-3-25

RECEIVED
NOV 14 2019
Form 1002A
Rev. 2009

☒ ORIGINAL
☐ AMENDED (Reason)

COMPLETION REPORT

TYPE OF DRILLING OPERATION
☒ STRAIGHT HOLE ☐ DIRECTIONAL HOLE ☐ HORIZONTAL HOLE
☐ SERVICE WELL

If directional or horizontal, see reverse for bottom hole location.

COUNTY LOGAN SEC 22 TWP 11N RGE 3W
LEASE NAME Rhodes WELL NO. 4
SE 1/4 NW 1/4 SE 1/4 SE 1/4 FSL OF 1/4 SEC 882 FWR OF 1/4 SEC 990
ELEVATION 1099' Ground 1086' Latitude (if known) 35.929498 Longitude (if known) -97.500484
OPERATOR NAME Newkomet Exploration, Inc OTC/OCC OPERATOR NO. 19935
ADDRESS P.O. Box 11330
CITY MIDLAND STATE TX ZIP 79702

SPUD DATE 8-24-19

DRLG FINISHED DATE 8-29-19

DATE OF WELL COMPLETION 9-12-19

1st PROD DATE 10-10-19

RECOMP DATE

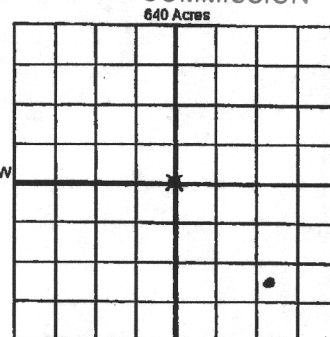

COMPLETION TYPE

☒ SINGLE ZONE
☐ MULTIPLE ZONE
☐ COMMINGLED
☐ LOCATION EXCEPTION
☐ ORDER NO.
☐ INCREASED DENSITY
☐ ORDER NO.

CASING & CEMENT (Attach Form 1002C)

TYPE	SIZE	WEIGHT	GRADE	FEET	PSI	SAX	TOP OF CMT
CONDUCTOR	N/A						
SURFACE	8.625"	23#	J-55	420'		230	Surface
INTERMEDIATE	N/A						
PRODUCTION	5.500"	15.5	J-55	4954'		100	4500'
LINER	N/A						

PACKER @ BRAND & TYPE

PACKER @ BRAND & TYPE

PLUG @

TYPE

PLUG @

TYPE

TOTAL

DEPTH

COMPLETION & TEST DATA BY PRODUCING FORMATION

FORMATION	<u>Lower Layton Sand</u>						
SPACING & SPACING	<u>450003 (unit)</u>						
ORDER NUMBER	<u>01</u>						
CLASS: Oil, Gas, Dry, Inj, Disp, Comm Disp, Svc	<u>Oil</u>						
PERFORATED INTERVALS	<u>4804' to 4814'</u>						
ACID/VOLUME	<u>7.5% / 1500gal</u>						
FRACTURE TREATMENT (Fluids/Prop Amounts)	<u>30# CL Borate Gel</u> <u>1100 Bbl / 6000# sand</u> <u>water</u>						

Min Gas Allowable

(165-10-17-7)

Gas Purchaser/Measurer

First Sales Date

INITIAL TEST DATA

Oil Allowable

(165-10-13-3)

INITIAL TEST DATE	<u>10-10-19</u>						
OIL-BBL/DAY	<u>8</u>						
OIL-GRAVITY (API)	<u>35</u>						
GAS-MCF/DAY	<u>0</u>						
GAS-OIL RATIO CU FT/BBL	<u>0</u>						
WATER-BBL/DAY	<u>2</u>						
PUMPING OR FLOWING	<u>Pumping</u>						
INITIAL SHUT-IN PRESSURE	<u>20</u>						
CHOKE SIZE	<u>N/A</u>						
FLOW TUBING PRESSURE	<u>N/A</u>						

AS SUBMITTED

A record of the formations drilled through, and pertinent remarks are presented on the reverse. I declare that I have knowledge of the contents of this report and am authorized by my organization to make this report, which was prepared by me or under my supervision and direction, with the data and facts stated herein to be true, correct, and complete to the best of my knowledge and belief.

SIGNATURE

P.O. Box 11330

ADDRESS

MIDLAND

CITY

NAME (PRINT OR TYPE)

Wayne Newkomet

STATE

ZIP

11-7-19

DATE

(432) 687-1101

PHONE NUMBER

Give formation names and tops, if available, or descriptions and thickness of formations drilled through. Show intervals cored or drillstem tested.

WELL NO.

UNITED THROUGH. SHOW INTERVALS CORRECTION UNIFORM TESTED.	
NAMES OF FORMATIONS	TOP
Lower Layton	4800

FOR COMMISSION USE ONLY	
ITD on file	<input type="checkbox"/> YES <input type="checkbox"/> NO
APPROVED	DISAPPROVED
2) Reject Codes	

Were open hole logs run? ☒ yes ☐ no

Date Last log was run 8-29-19

Was CO₂ encountered? ☐ yes ☒ no at what depths? _____

Was H₂S encountered? ☐ yes ☒ no at what depths? _____

Were unusual drilling circumstances encountered? ☐ yes ☒ no

If yes, briefly explain below _____

Other remarks:

If more than three drainholes are proposed, attach a separate sheet indicating the necessary information.

Direction must be stated in degrees azimuth.
Please note, the horizontal drainhole and its end
point must be located within the boundaries of the
lease or spacing unit.

Directional surveys are required for all drainholes and directional wells.

SEC	TWP	RGE	COUNTY
Spot Location			
1/4	1/4	1/4	1/4
Measured Total Depth		True Vertical Depth	BHL From Lease, Unit, or Property Line:

LATERAL #1						
SEC	TWP	RGE	COUNTY			
Spot Location			Feet From 1/4 Sec Lines		FSL	FWL
1/4	1/4	1/4				
Depth of Deviation		Radius of Turn	Direction		Total Length	
Measured Total Depth		True Vertical Depth	BHL From Lease, Unit, or Property Line:			

SEC	TWP	RGE	COUNTY
Spot Location		Feet From 1/4 Sec Lines	
1/4	1/4	1/4	1/4
Depth of Deviation		Radius of Turn	Direction
Measured Total Depth		True Vertical Depth	BHL From Lease, Unit, or Property Line:

CATERGORIES										
SEC		TWP		RGE		COUNTY				
Spot Location						Feet From 1/4 Sec Lines		FSL		FWL
1/4		1/4		1/4		1/4				
Depth of Deviation				Radius of Turn		Direction		Total Length		
Measured Total Depth				True Vertical Depth		BHL From Lease, Unit, or Property Line:				